



Wisconsin Department of Transportation

Division of Transportation Systems Development

Bureau of Project Development
4802 Sheboygan Avenue, Rm 601
P O Box 7916
Madison, WI 53707-7916

Telephone: (608) 266-1631
Facsimile (FAX): (608) 266-8459

March 3, 2017

NOTICE TO ALL CONTRACTORS:

<p>Proposal #05: 3050-02-72, WISC 2017 095 Sun Prairie – Watertown McKay Way – Structure B-28-077 STH 19 Jefferson County</p>	<p>3050-02-73 Sun Prairie – Watertown McKay Way – Structure B-28-077 Sanitary Sewer & Water STH 19 Jefferson County</p>
--	--

Letting of March 14, 2017

This is Addendum No. 01, which provides for the following:

Special Provisions:

Revised Special Provisions	
Article No.	Description
83	Concrete Sidewalk HES 4-Inch, Item SPV.0165.02

Plan Sheets:

Revised Plan Sheets	
Plan Sheet	Plan Sheet Title (brief description of changes to sheet)
38	Added colored crosswalk locations to paving detail sheet.
134	Added comments to Coloring Concrete WisDOT Red quantity table to specify they are for the crosswalks at STH 19/89 intersection.

The responsibility for notifying potential subcontractors and suppliers of these changes remains with the prime contractor.

Sincerely,

Mike Coleman

Proposal Development Specialist
Proposal Management Section

ADDENDUM NO.01
3050-02-72 & 3050-02-73
March 3, 2017

Special Provisions

Revise Special Provisions

83. Concrete Sidewalk HES 4-Inch, Item SPV.0165.02.

A Description

This special provision describes constructing concrete sidewalk according to the requirements of standard spec 602, at locations approved by the engineer, and as hereinafter provided.

B Materials.

Provide concrete that conforms to the requirements for high early strength concrete according to standard spec 501.

C Construction

Perform this work at locations directed by the engineer in accordance with the requirements of section 416 of the standard specifications for concrete driveway high early strength.

D Measurement

The department will measure Concrete Sidewalk HES 4-Inch by square foot, acceptably completed.

E Payment

The department will pay for measured quantities at the contract unit price under the following bid item(s):

ITEM NUMBER	DESCRIPTION	UNIT
SPV.0165.02	Concrete Sidewalk HES 4-Inch	SF

Payment is full compensation for furnishing all foundation excavation and preparation; providing all materials, including concrete, expansion joints, and reinforcement tie bars unless specified otherwise; placing, finishing, protecting, and curing; sawing joints; disposing of surplus excavation material, and for restoring the work site.

The department will adjust pay for crack repairs on concrete built under standard spec 602 as specified in standard spec 416.5.2 for ancillary concrete.

Plan Sheets

The following 8½ x 11-inch sheets are attached and made part of the plans for this proposal:
Revised: 38, 134.

END OF ADDENDUM



Addendum No. 01
 ID 3050-02-72
 Revised Sheet 38
 March 3, 2017

- DRIVEWAY TYPE
- ① CONCRETE DRIVEWAY
 - ② ASPHALT SURFACE COMMERCIAL
 - ③ ASPHALT SURFACE RESIDENTIAL
 - ④ BASE AGGREGATE DENSE 3/4-INCH

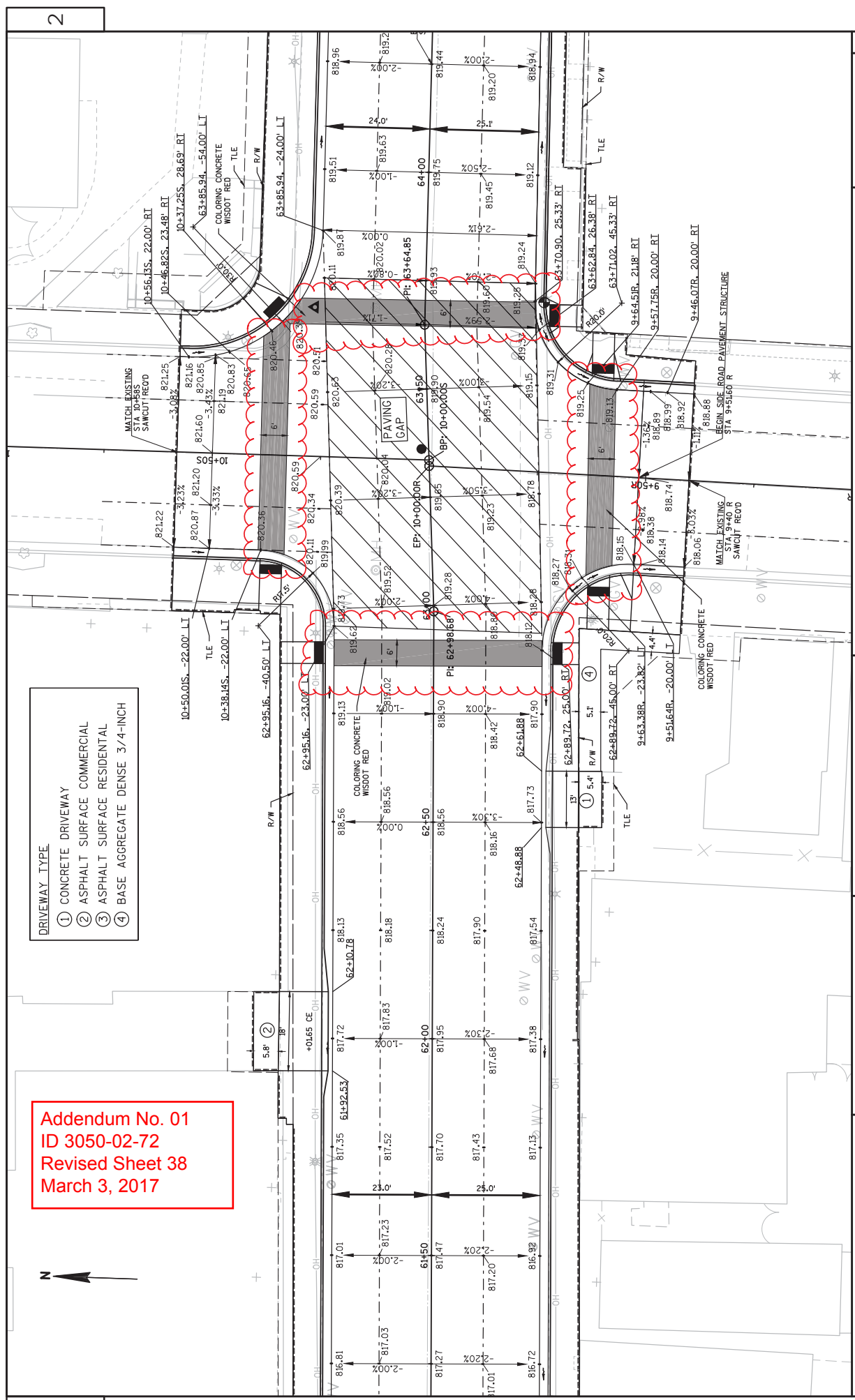

Addendum No. 01
 ID 3050-02-72
 Revised Sheet 134
 March 3, 2017

COLORING CONCRETE WISDOT RED

405.0100
 COLORING
 CONCRETE
 WISDOT RED

CATEGORY	STATION	LOCATION	REMARKS
0040	27+07	27+69	STH 19
0040	46+90	47+05	STH 19
0040	47+85	48+00	STH 19
0040	57+00	59+62	STH 19
0040	59+62	59+76	STH 19
0040	60+38	60+56	STH 19
0040	60+38	65+74	STH 19
0040	65+74	65+89	STH 19
0040	9+60 'J'	9+79 'J'	S. JACKSON ST
0040	9+46 'R'	9+75 'R'	S. MONROE ST
0040	10+23 'S'	10+58 'S'	N. MONROE ST
0040			UNDISTRIBUTED
			TOTAL:

CROSSWALKS

 CROSSWALK
 CROSSWALK

FINISHING ROADWAY

213.0100
 FINISHING ROADWAY (3050-02-72)

CATEGORY	LOCATION	QUANTITY
0010	3050-02-72	1
	TOTAL:	1

BASE AGGREGATE ITEMS

305.0120
 BASE AGGREGATE
 DENSE 1 1/4-INCH
 CRUSHED MATERIAL

CATEGORY	STATION	LOCATION	TON	312.0110 SELECT CRUSHED MATERIAL
0010	27+30	32+50	1653	1377
0010	32+60	37+00	1435	1196
0010	37+00	42+00	1595	1329
0010	42+00	47+05	1611	1348
0010	47+85	53+25	1723	1441
0010	53+25	57+00	1326	1105
0010	57+00	59+76	589	981
0010	60+38	65+89	1221	2035
0010	10+20 'C'	10+62 'C'	170	141
0010	10+20 'M'	10+59 'M'	132	110
0010	10+59 'M'	10+75 'M'	48	-
0010	9+35 'V'	9+51 'V'	39	-
0010	9+51 'V'	9+80 'V'	77	65
0010	9+20 'H'	9+52 'H'	96	-
0010	9+62 'H'	9+79 'H'	93	78
0010	9+50 'J'	9+75 'J'	37	61
0010	9+46 'R'	9+75 'R'	51	84
0010	10+25 'S'	10+58 'S'	71	118
		UNDISTRIBUTED	598	573
		TOTAL:	12565	12042

* ADDITIONAL QUANTITIES SHOWN ELSEWHERE

CONCRETE PAVEMENT

CATEGORY	STATION	LOCATION	SY	415.0080 CONCRETE PAVEMENT 8-INCH	415.0210 CONCRETE PAVEMENT GAPS	415.0410 CONCRETE PAVEMENT APPROACH SLAB	415.1080 CONCRETE PAVEMENT HES 8-INCH	660.7000 CONSTRUCTION PAVEMENT	SRP/0105.01 CONCRETE PAVEMENT JOINT LAYOUT
0010	27+07	27+69	-	-	135	-	-	-	-
0010	46+90	47+05	-	-	54	-	-	-	-
0010	47+85	48+00	-	-	54	-	-	-	-
0010	57+00	59+62	1339	-	-	-	-	262	-
0010	59+62	59+76	-	-	65	-	-	-	-
0010	60+38	60+56	-	-	78	-	-	-	-
0010	60+56	65+74	2786	-	-	-	-	518	-
0010	65+74	65+89	-	-	73	-	-	-	-
0010	9+50 'J'	9+79 'J'	98	-	-	-	-	29	-
0010	9+46 'R'	9+75 'R'	147	-	-	-	-	29	-
0010	10+23 'S'	10+58 'S'	203	1	-	-	-	35	-
0010		UNDISTRIBUTED	-	2	-	-	229	-	-
0010		PROJECT	-	-	-	-	-	-	1
		TOTAL:	4573	4	459	229	873	873	1