



# Wisconsin Department of Transportation

## Division of Transportation Systems Development

Bureau of Project Development  
 4802 Sheboygan Avenue, Rm 601  
 P O Box 7916  
 Madison, WI 53707-7916

Telephone: (608) 266-1631  
 Facsimile (FAX): (608) 266-8459

March 28, 2017

### NOTICE TO ALL CONTRACTORS:

**Proposal #23 1009-33-30, WISC 2017 169**  
**Epoxy Pavement Marking-STH/USH**  
**Various STH/USH Region Wide**  
**Various Highways**  
**Northeast Region Wide**

### Letting of April 11, 2017

This is Addendum No. 01, which provides for the following:

#### Schedule of Items:

Revised Bid Item Quantities					
Bid Item	Item Description	Unit	Old Quantity	Revised Quantity	Proposal Total
646.0106	Epoxy 4-Inch	L.F.	2,240,715	16,430	2,257,145
646.0126	Epoxy 8-Inch	L.F.	51,175	-17,165	34,010
647.0803	Aerial Enforcement Epoxy 24-Inch	L.F.	312	-120	192

#### Plan Sheets:

Revised Plan Sheets	
Plan Sheet	Plan Sheet Title (brief description of changes to sheet)
1	Number of miles per County. Total number of Miles
20	Removal of plan location/quantities
23	Additional map location.

Added Plan Sheets	
Plan Sheet	Plan Sheet Title (brief description of why sheet was added)
20A	New locations. Additional quantities.
28A	Additional map location.

<b>Deleted Plan Sheets</b>	
<b>Plan Sheet</b>	<b>Plan Sheet Title (brief description of why sheet was deleted)</b>
26	Location deleted from plan. Map not needed.

**Schedule of Items**

Attached, dated March 28, 2017, are the revised Schedule of Items Pages 1 and 2.

**Plan Sheets**

The following 8½ x 11-inch sheets are attached and made part of the plans for this proposal:

Revised: 1, 20 and 23.

Added: 20A, and 28A.

The responsibility for notifying potential subcontractors and suppliers of these changes remains with the prime contractor.

Sincerely,

*Mike Coleman*

Proposal Development Specialist  
Proposal Management Section

END OF ADDENDUM

**STATE OF WISCONSIN  
DEPARTMENT OF TRANSPORTATION**

PLAN OF PROPOSED IMPROVEMENT

**EPOXY PAVEMENT MARKING-STH/USH**

VARIOUS STH/USH REGION WIDE

VAR HWY

NORTHEAST REGION WIDE

**ORDER OF SHEETS**

Section No.	Title
1	Typical Sections and Details
2	Estimate of Quantities
3	Miscellaneous Quantities
4	Right of Way Plat
5	Plan and Profile
6	Standard Detail Drawings
7	Sign Plates
8	Structure Plans
9	Computer Estimation Data
9	Cross Sections

TOTAL SHEETS =

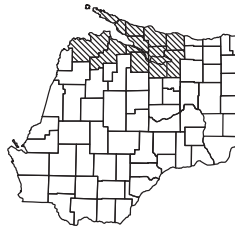

STATE PROJECT NUMBER
<b>1009-33-30</b>

BROWN CO	24.5 MILES
CALUMET CO	28.85 MILES
DOOR CO	15.3 MILES
FOND DU LAC CO	20.1 MILES
KEWAUNEE CO	8.6 MILES
MANITOWOC CO	48.7 MILES
MARINETTE CO	30.3 MILES
OCONTO CO	35.1 MILES
OUTAGAMIE CO	38.5 MILES
SHEBOYGAN CO	11.6 MILES
WINNEBAGO CO	23.0 MILES
<b>TOTAL</b>	<b>273.55 MILES</b>

**CONVENTIONAL SYMBOLS**

	CORPORATE LIMITS
	PROPERTY LINE
	LOT LINE
	LIMITED HIGHWAY EASEMENT
	EXISTING RIGHT OF WAY
	PROPOSED OR NEW R/W LINE
	SLOPE INTERCEPT
	REFERENCE LINE
	EXISTING CULVERT
	PROPOSED CULVERT (Box or Pipe)
	COMBUSTIBLE FLUIDS
	MARSH AREA
	WOODED OR SHRUB AREA

	PROFILE GRADE LINE
	ORIGINAL GROUND
	MARSH OR ROCK PROFILE (To be noted as such)
	SPECIAL DITCH
	GRADE ELEVATION
	CULVERT (Profile View)
	UTILITIES
	ELECTRIC
	FIBER OPTIC
	GAS
	SANITARY SEWER
	STORM SEWER
	TELEPHONE
	WATER
	UTILITY PEDESTAL
	POWER POLE
	TELEPHONE POLE

SCALE 0 30 ML LAYOUT  
TOTAL NET LENGTH OF CENTERLINE = 0.000

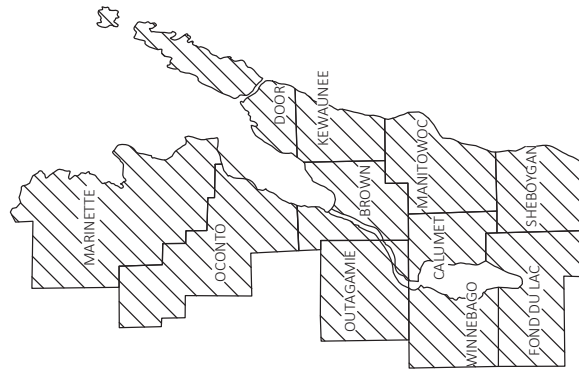

STATE PROJECT	FEDERAL PROJECT
1009-33-30	

STATE OF WISCONSIN DEPARTMENT OF TRANSPORTATION	
PREPARED BY	_____ Surveyor
DESIGNED BY	_____ S. HERIACH
PROJECT MANAGER	_____ Project Manager
REGIONAL ENGINEER	_____ Regional Engineer
REGIONAL SUPERVISOR	_____ M. HERBERG
APPROVED FOR THE DEPARTMENT	_____ (Signature)
DATE:	_____

**Addendum No. 01  
ID 1009-33-30  
Revised Sheet 1  
March 28, 2017**

Addendum No. 01  
ID 1009-33-30  
Revised Sheet 20  
March 28, 2017

PAVEMENT MARKING

LOCATION	LOG MILE	Mile		646.0106 EPOXY 4-INCH		646.0126 EPOXY 8-INCH		647.0803 Aerial Enforcement Epoxy 24-inch		REMARKS
		LF	LF	SOLID WHITE	DASHED WHITE	SOLID YELLOW	LF	LF	LF	
USH 151	9.50									
From: Calumet/FDL Co Line	33.65									Pavement Change 3 850 L.F. North of CTH B
To: Chilton	45.00									Pavement Change 950 L.F. North of Oak Orchard Overpass
North Bound										
Jefferson Rd										
CTH C										
E Harlow Rd										
South Bound										
CTH C										
Wayside										
Jct 5th 55										
Jefferson Rd										
Harbor Rd										
SUB-TOTALS		118,800	30	193,830	75,000	1,370				
<b>TOTALS</b>										

TOTALS 213,555 17,165 120

PAVEMENT MARKING

LOCATION	LOG MILE	Mile	646.0106 EPOXY 4-INCH		646.0126 EPOXY 8-INCH		REMARKS
			SOLID WHITE	DASHED WHITE	SOLID YELLOW	LF	
USH 151	11.00						
From: Calumet/FDL Co Line	33.65						
To: Chilton	45.00						
North Bound							
Jefferson Rd							
CTH C							
E Harlow Rd							
South Bound							
CTH C							
Wayside							
Jct 5th 55							
Jefferson Rd							
Harbor Rd							
SUB-TOTALS			118,800	30	193,830	75,000	
<b>TOTALS</b>							

MISCELLANEOUS QUANTITIES 1,370

COUNTY: REGION WIDE

SHEET: 20

PROJECT NO: 1009-33-30

HWY: VARIOUS

FILE NAME: PLOT DATE: PLOT BY: PLOT NAME: PLOT SCALE: 1:1

PAVEMENT MARKING

PAVEMENT MARKING

PAVEMENT MARKING

PAVEMENT MARKING

PAVEMENT MARKING

Addendum No. 01  
 ID 1009-33-30  
 Added Sheet 20A  
 March 28, 2017

**PAVEMENT MARKING**

LOCATION	LOG MILE	MiTe	646.0106 EPOXY 4-INCH			REMARKS
			SOLID WHITE LF	DASHED WHITE LF	SOLID YELLOW LF	
IH 41		3.60				
From: Fond Du Lac SCL	0.00					Fond Du Lac South County Line
To: USH 151	3.60					Pavement Change South of US 151
North Bound Edge Lines			64,775		71,250	Right/Left Edge Lines
CTH B Exit Ramp			2,450	35	1,950	Exit Ramp Dashes/Edge Lines
CTH B On Ramp South Bound			3,200		1,500	On Ramp Edge Lines
CTH B Exit Ramp			1,800	35	1,300	Right/Left Edge Lines
CTH B On Ramp			3,145		1,545	Exit Ramp Dashes/Edge Lines
<b>SUB-TOTALS</b>			<b>75,370</b>	<b>70</b>	<b>77,545</b>	<b>On Ramp Edge Lines</b>
<b>TOTALS</b>			<b>152,985</b>			

**PAVEMENT MARKING**

LOCATION	LOG MILE	MiTe	646.0106 EPOXY 4-INCH			REMARKS
			SOLID WHITE LF	DASHED WHITE LF	SOLID YELLOW LF	
IH 41		3.00				
From: Scheuring Rd (CTH F)	71.90					Pvmt change 3/4 Mi S of Scheuring Rd
To: Ashland Ave	74.90					Round-a-bout Glory/Ashland Ave
North Bound Right/Left Edge Lines			14,500		15,750	Main Line Edge Lines
South Bound Right/Left Edge Lines			14,500		15,750	Main Line Edge Lines
US 41 Ashland Ave Ramps			3,625	1,000	3,625	USH 41 Interchange @ Ashland Ave
South Bound On ramp			3,625		3,625	Round-a-bout Glory/Ashland Ave
North Bound Off ramp			3,625	1,000	3,625	Ramp Lane line/Ramp Edge Lines
<b>SUB-TOTALS</b>			<b>36,250</b>	<b>2,000</b>	<b>38,750</b>	<b>Ramp Lane line/Ramp Edge Lines</b>
<b>TOTALS</b>			<b>77,000</b>			



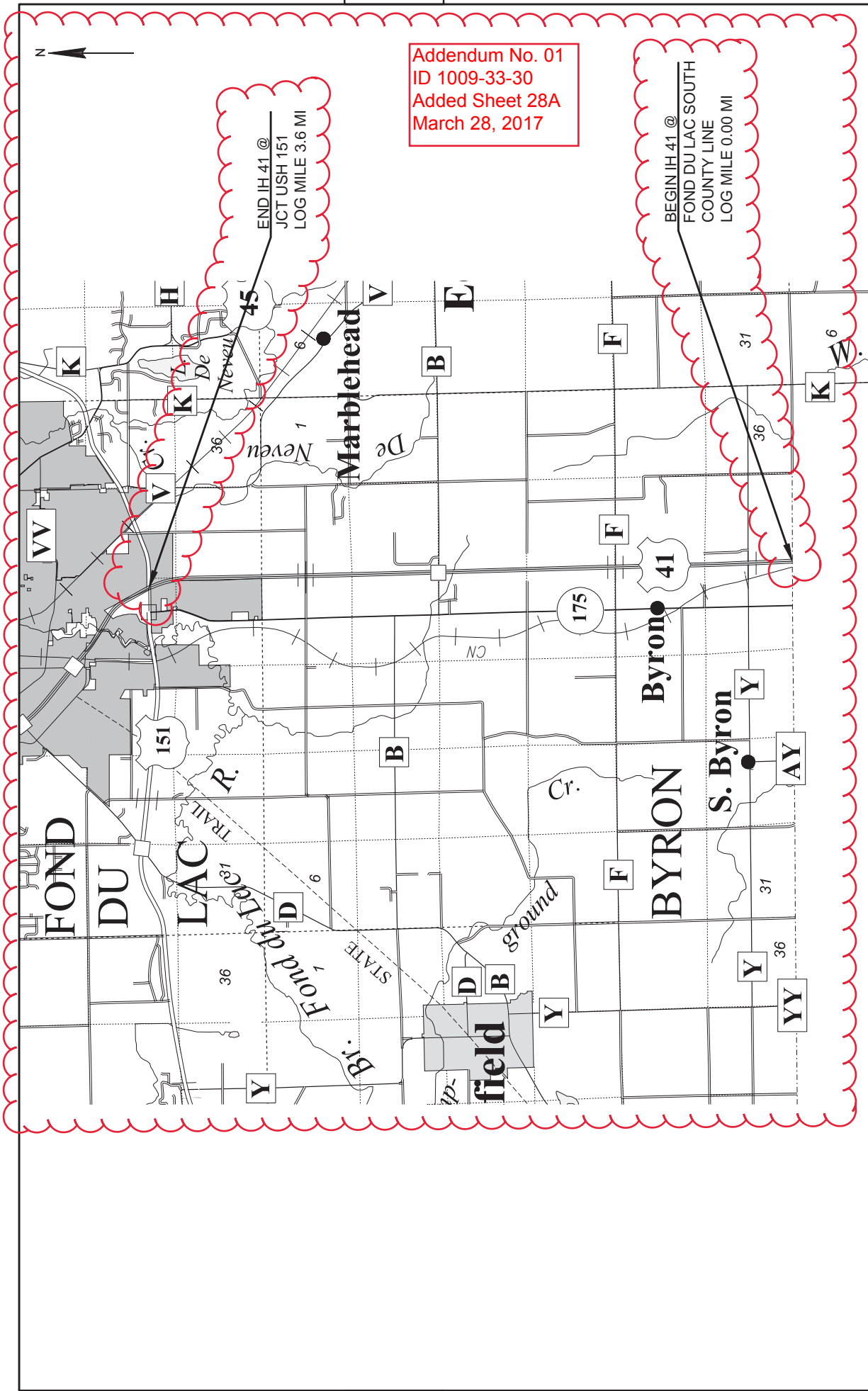

PROJECT NO: 1009-33-30  
 FILE NAME: F:\03\_100933\100933\050205-PN1.DWG LAYOUT NAME: 050205-PN

COUNTY: FOND DU LAC  
 HWY: IH 41

PAVEMENT MARKING LOCATION MAP  
 PLOT BY: CAMPBURE, MICHAEL R. PLOT NAME: WIS007\CADDS SHEET 4A

DATE: 3/23/2017 2:24 PM  
 PLOT SCALE: 1 IN=1 MI

SHEET 28A  
 E



## Proposal Schedule of Items

Proposal ID: 20170411023 Project(s): 1009-33-30

Federal ID(s): WISC 2017169

SECTION: 0001

Contract Items

Alt Set ID:

Alt Mbr ID:

Proposal Line Number	Item ID Description	Approximate Quantity and Units	Unit Price	Bid Amount
0010	619.1000 Mobilization	1.000 EACH	_____.	_____.
0020	643.0100 Traffic Control (project) 01. 1009-33-30	1.000 EACH	_____.	_____.
0030	646.0106 Pavement Marking Epoxy 4-Inch	2,257,145.000 LF	_____.	_____.
0040	646.0126 Pavement Marking Epoxy 8-Inch	34,010.000 LF	_____.	_____.
0050	646.0841.S Pavement Marking Grooved Wet Reflective Contrast Tape 4-Inch	37,555.000 LF	_____.	_____.
0060	646.0843.S Pavement Marking Grooved Wet Reflective Contrast Tape 8-Inch	105,961.000 LF	_____.	_____.
0070	647.0110 Pavement Marking Railroad Crossings Epoxy	13.000 EACH	_____.	_____.
0080	647.0166 Pavement Marking Arrows Epoxy Type 2	36.000 EACH	_____.	_____.
0090	647.0206 Pavement Marking Arrows Bike Lane Epoxy	25.000 EACH	_____.	_____.
0100	647.0306 Pavement Marking Symbols Bike Lane Epoxy	25.000 EACH	_____.	_____.
0110	647.0356 Pavement Marking Words Epoxy	28.000 EACH	_____.	_____.
0120	647.0406 Pavement Marking Words Bike Lane Epoxy	9.000 EACH	_____.	_____.
0130	647.0526 Pavement Marking Yield Line Symbols Epoxy 18-Inch	9.000 EACH	_____.	_____.
0140	647.0566 Pavement Marking Stop Line Epoxy 18-Inch	850.000 LF	_____.	_____.





Proposal Schedule of Items

Proposal ID: 20170411023 Project(s): 1009-33-30  
Federal ID(s): WISC 2017169

SECTION: 0001 Contract Items

Alt Set ID: Alt Mbr ID:

Proposal Line Number	Item ID Description	Approximate Quantity and Units	Unit Price	Bid Amount
0150	647.0803 Pavement Marking Aerial Enforcement Bars Epoxy 24-Inch	192.000 LF	_____.	_____.
	Section: 0001		Total:	_____.
			Total Bid:	_____.

