

Wisconsin Department of Transportation

May 2, 2017

Division of Transportation Systems Development

Bureau of Project Development
4802 Sheboygan Avenue, Rm 601
P O Box 7916
Madison, WI 53707-7916

Telephone: (608) 266-1631
Facsimile (FAX): (608) 266-8459

NOTICE TO ALL CONTRACTORS:

Proposal #17: 1590-16-71, WISC 2017 273
WCL – USH 141
WCL – CTH O
USH 8
Marinette County

Letting of May 9, 2017

This is Addendum No. 02, which provides for the following:

Special Provisions:

Added Special Provisions	
Article No.	Description
27	Locating No-Passing Zones, Item 648.0100

Schedule of Items:

Revised Bid Item Quantities					
Bid Item	Item Description	Unit	Old Quantity	Revised Quantity	Proposal Total
608.0412	Storm Sewer Pipe Reinforced Concrete Class IV 12-Inch	LF	61	521	582

Added Bid Item Quantities					
Bid Item	Item Description	Unit	Old Quantity	Revised Quantity	Proposal Total
608.3018	Storm Sewer Pipe Class III-A 18-Inch	LF	0	50	50
608.3024	Storm Sewer Pipe Class III-A 24-Inch	LF	0	1,268	1,268
648.0100	Locating No-Passing Zones	MI	0	14.26	14.26

Deleted Bid Item Quantities					
Bid Item	Item Description	Unit	Old Quantity	Revised Quantity	Proposal Total
608.0312	Storm Sewer Pipe Reinforced Concrete Class III 12-Inch	LF	521	-521	0
608.0318	Storm Sewer Pipe Reinforced Concrete Class III 18-Inch	LF	50	-50	0
608.0324	Storm Sewer Pipe Reinforced Concrete Class III 24-Inch	LF	1,268	-1,268	0

Plan Sheets:

Revised Plan Sheets	
Plan Sheet	Plan Sheet Title (brief description of changes to sheet)
43-44	Storm Sewer Plans updated to allow alternate pipe materials.
83	Miscellaneous Quantities table (storm sewer summary) updated to allow alternate pipe materials.

Special Provisions

27. Locating No-Passing Zones, Item 648.0100.

For this project, the spotting sight distance in areas with a 55 mph posted speed limit is 0.21 miles (1108 feet).
stp-648-005 (20060512)

Schedule of Items

Attached, dated May 2, 2017, are the revised Schedule of Items Pages 1 – 8.

Plan Sheets

The following 8½ x 11-inch sheets are attached and made part of the plans for this proposal:
Revised: 43, 44, and 83.

The responsibility for notifying potential subcontractors and suppliers of these changes remains with the prime contractor.

Sincerely,

Mike Coleman

Proposal Development Specialist
Proposal Management Section

END OF ADDENDUM

Addendum No. 02
 ID 1590-16-71
 Revised Sheet 43
 May 2, 2017

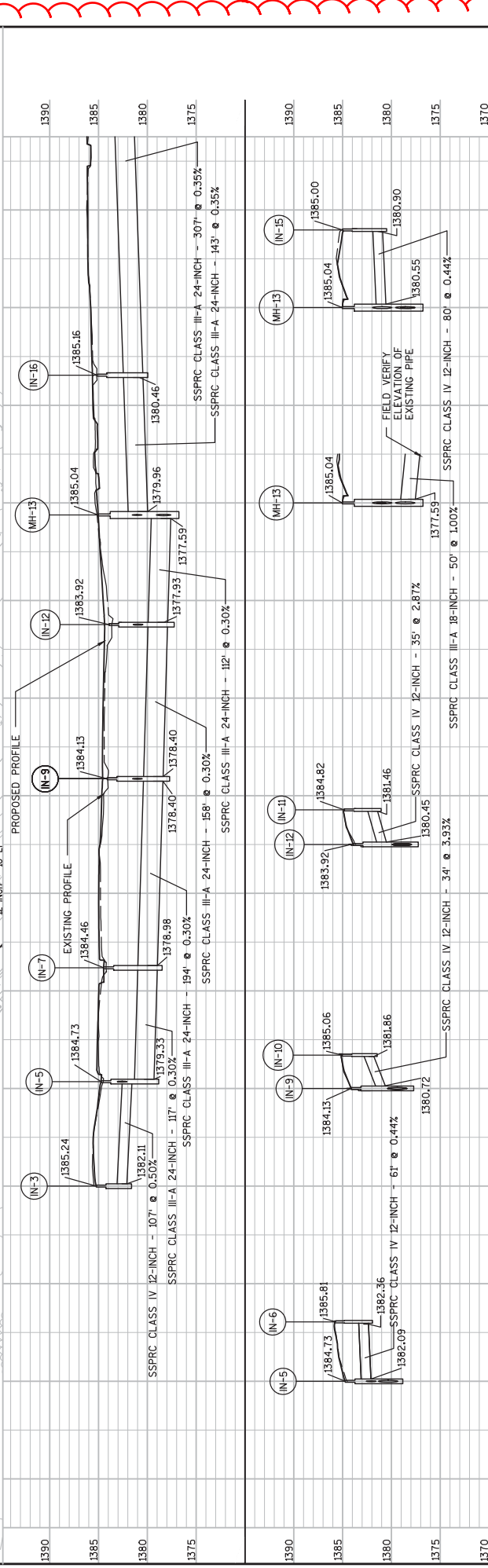
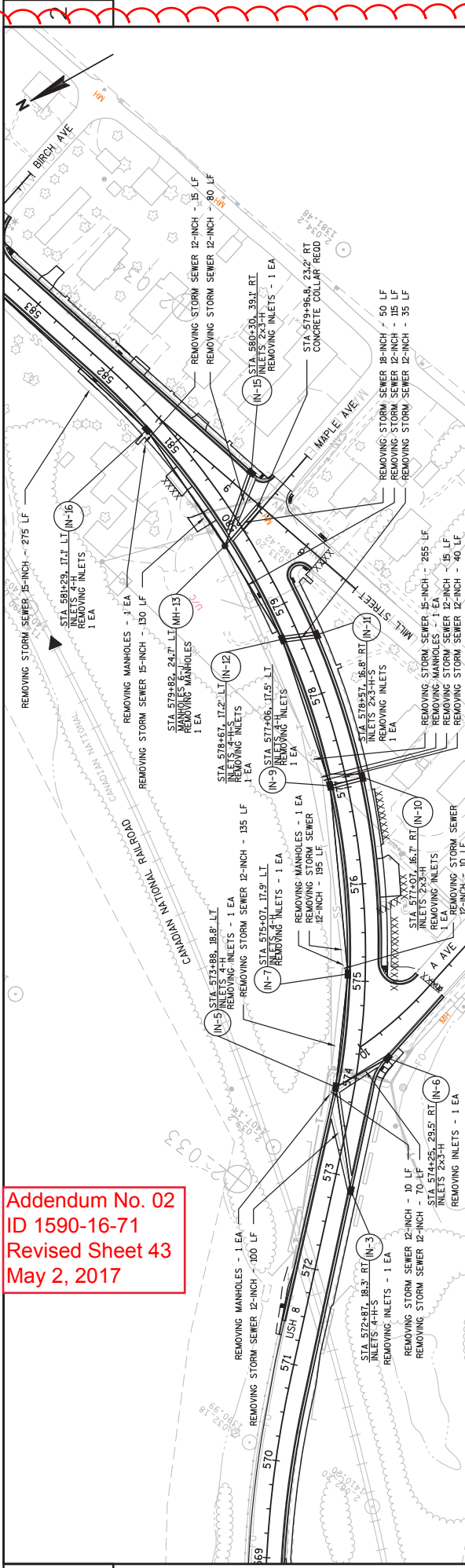

PROJECT NO: 1590-16-71	COUNTY: MARINETTE	STORM SEWER	SHEET 43
HWY: USH 8			
FILE NAME : X:\PROJECTS\MARINETTE\1590-16-00 USH 8\DESIGN\CD\SHEETPLAN\02501-SS.DWG	DATE : 5/2/2017 6:18 AM	BY : ANDY BLOCK	SCALE : 1"=100 FT
LAYOUT NAME : 02501-SS			

Addendum No. 02
 ID 1590-16-71
 Revised Sheet 44
 May 2, 2017

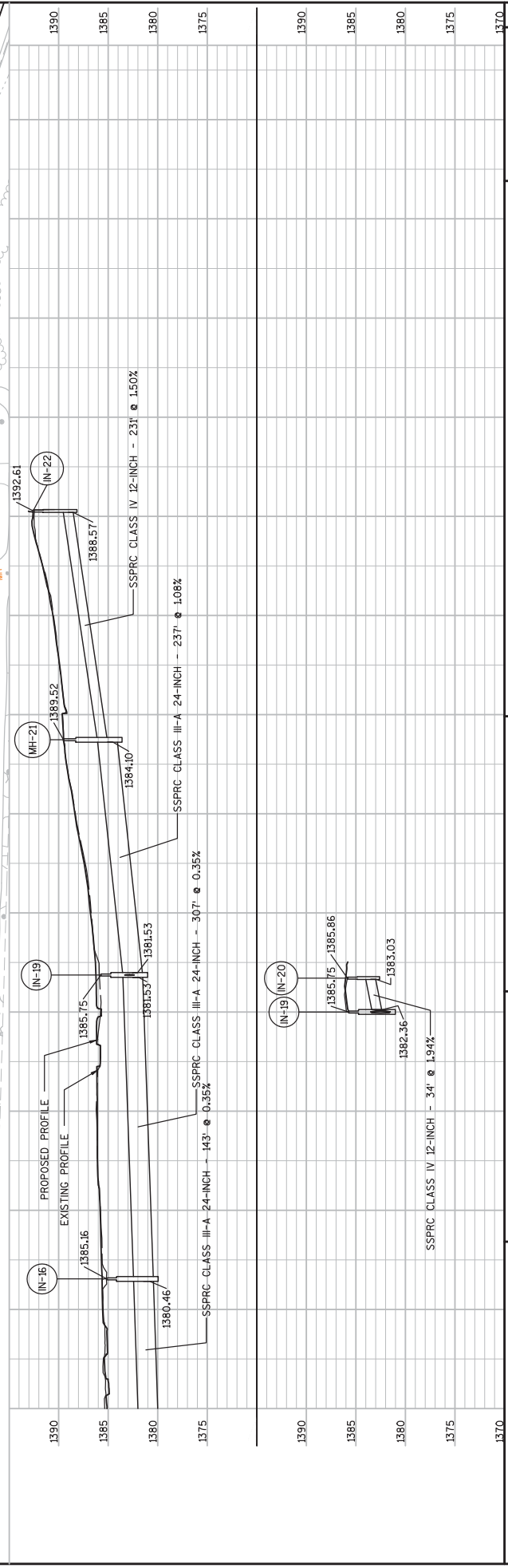
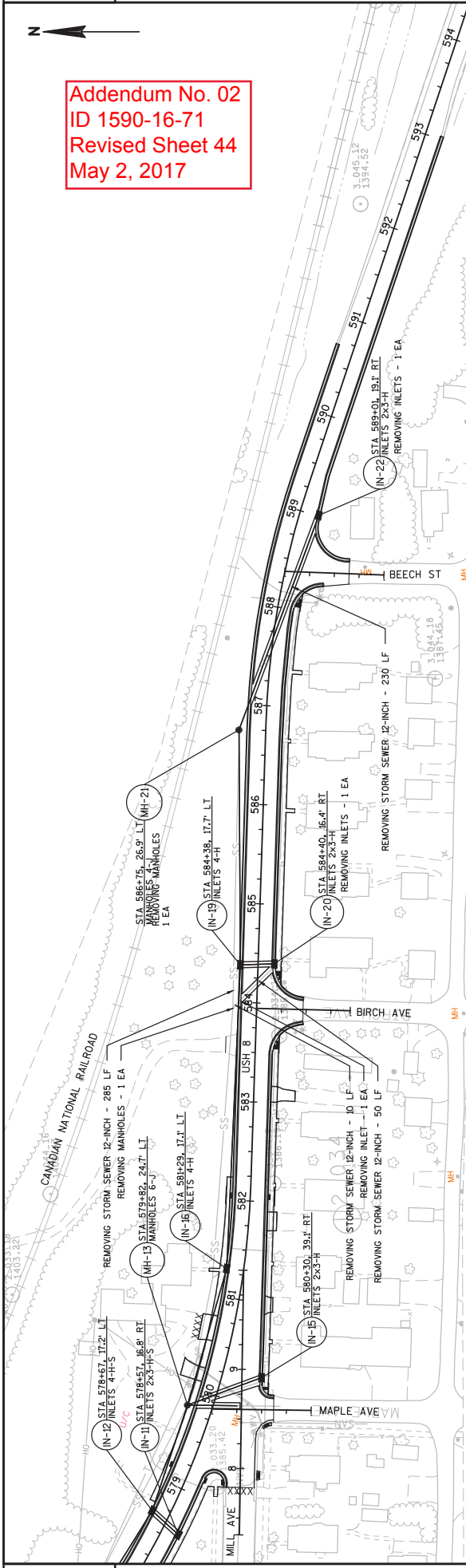

PROJECT NO: 1590-16-71	HWY: USH 8	COUNTY: MARINETTE	STORM SEWER	SHEET 44	E
FILE NAME : X:\PROJECTS\MARINETTE\1590-16-00 USH 8\DESIGN\CADD\SHEETPLAN\022501-SS.DWG					
LAYOUT NAME : 022502-SS					
PLOT DATE : 5/2/2017 6:18 AM					
PLOT BY : ANDY BLOCK					
PLOT NAME :					
PLOT SCALE : 1 IN=100 FT					
WSDOT/CADD SHEET 41					

Addendum No. 02
ID 1590-16-71
Revised Sheet 83
May 2, 2017

STORM SEWER PIPE SUMMARY

CATEGORY	FROM STRUCTURE	TO STRUCTURE	12-INCH LF	18-INCH LF	24-INCH LF	CONCRETE CLASS IV PIPE CLASS 111-A	STORM SEWER	CONCRETE CLASS IV PIPE CLASS 111-A	STORM SEWER	DI CHARGE ELEVATION	SLOPE %	REMARKS	
0010	IN 3	IN 5	107							1382.11	1381.58	0.50	
0010	IN 6	IN 5	61							1382.36	1382.09	0.44	
0010	IN 5	IN 7			117					1379.33	1378.98	0.30	
0010	IN 7	IN 9			194					1378.98	1378.40	0.30	
0010	IN 9	IN 12			158					1378.40	1377.93	0.30	
0010	IN 12	MH 13			112					1377.93	1377.59	0.30	
0010	IN 10	IN 9	34							1381.86	1380.72	3.93	
0010	IN 11	IN 12	35							1381.46	1380.45	2.87	
0010	IN 15	MH 13	80							1380.90	1380.55	0.44	
0010	MH 13	EXIST		50						1377.59	1377.09	1.00	FIELD VERIFY EXISTING ELEVATION AT CONNECTION
0010	IN 22	MH 21	231							1388.57	1385.11	1.50	
0010	MH 21	IN 19			237					1384.10	1381.53	1.08	
0010	IN 19	IN 16			307					1381.53	1380.46	0.35	
0010	IN 16	MH 13			143					1380.46	1379.96	0.35	
0010	IN 20	IN 19	34							1383.03	1382.36	1.94	
TOTAL			582	50	1268								

STORM SEWER STRUCTURE SUMMARY

STRUCTURE CATEGORY	NO.	STATION	OFFSET	LOCATION	MANHOLE COVERS TYPE J EACH	INLET COVERS TYPE H EACH	INLET TYPE H-S DIAMETER EACH	MANHOLES DIAMETER 4-FT EACH	INLETS 4-FT DIAMETER EACH	INLETS 2X3-FT EACH	ADJUSTING INLET COVERS EACH	CONCRETE COLLARS FOR PIPE EACH	INLET PROTECTION TYPE C EACH	CONSTRUCTION STAKING STORM SEWER EACH	RIM ELEVATION	TOP OF STRUCTURE ELEVATION	FLOWLINE ELEVATION	DEPTH	REMARKS	
0010	---	571+32	17.8	USH 8, RT							1				1385.24	1384.24	1382.11	2.13		
0010	IN 3	572+87	18.3	USH 8, RT					1						1385.01	1384.01	1379.33	4.68		
0010	IN 5	573+88	18.8	USH 8, LT	1										1385.81	1384.81	1382.36	2.45		
0010	IN 6	574+29	29.5	USH 8, RT		1			1						1384.46	1383.46	1378.98	4.48		
0010	IN 7	575+07	17.9	USH 8, LT					1						1384.13	1383.13	1378.40	4.73		
0010	IN 9	577+06	17.5	USH 8, LT					1						1385.06	1384.06	1381.86	2.20		
0010	IN 10	577+07	16.7	USH 8, RT						1					1384.82	1383.82	1381.46	2.36		
0010	IN 11	578+57	16.8	USH 8, RT						1					1383.92	1382.92	1377.93	4.99		
0010	IN 12	578+67	17.2	USH 8, LT					1						1385.04	1383.79	1377.59	6.20		
0010	MH 13	578+82	24.7	USH 8, LT	1			1							1385.00	1384.00	1380.90	3.10		
0010	IN 15	580+30	39.1	USH 8, RT					1						1385.16	1384.16	1380.46	3.70		
0010	IN 16	581+29	17.1	USH 8, LT					1						1385.75	1384.75	1381.53	3.22		
0010	IN 19	584+38	17.7	USH 8, LT					1						1385.86	1384.86	1383.03	1.83		
0010	IN 20	584+40	16.4	USH 8, RT						1					1389.52	1388.27	1384.10	4.17		
0010	MH 21	586+75	26.9	USH 8, LT	1										1392.61	1391.61	1388.57	3.04		
0010	IN 22	589+01	19.1	USH 8, RT						1										
TOTAL					2	10	3	1	1	6	1	1	26	15						



Proposal Schedule of Items

Proposal ID: 20170509017 Project(s): 1590-16-71

Federal ID(s): WISC 2017273

SECTION: 0001

Contract Items

Alt Set ID:

Alt Mbr ID:

Proposal Line Number	Item ID Description	Approximate Quantity and Units	Unit Price	Bid Amount
0010	201.0105 Clearing	7.000 STA	_____.	_____.
0020	201.0120 Clearing	40.000 ID	_____.	_____.
0030	201.0205 Grubbing	7.000 STA	_____.	_____.
0040	201.0220 Grubbing	40.000 ID	_____.	_____.
0050	203.0100 Removing Small Pipe Culverts	1.000 EACH	_____.	_____.
0060	204.0110 Removing Asphaltic Surface	270.000 SY	_____.	_____.
0070	204.0115 Removing Asphaltic Surface Butt Joints	415.000 SY	_____.	_____.
0090	204.0150 Removing Curb & Gutter	6,485.000 LF	_____.	_____.
0100	204.0155 Removing Concrete Sidewalk	1,555.000 SY	_____.	_____.
0110	204.0165 Removing Guardrail	727.000 LF	_____.	_____.
0120	204.0185 Removing Masonry	42.000 CY	_____.	_____.
0130	204.0210 Removing Manholes	7.000 EACH	_____.	_____.
0140	204.0220 Removing Inlets	13.000 EACH	_____.	_____.
0150	204.0245 Removing Storm Sewer (size) 01. 12-Inch	1,395.000 LF	_____.	_____.
0160	204.0245 Removing Storm Sewer (size) 02. 15-Inch	660.000 LF	_____.	_____.
0170	204.0245 Removing Storm Sewer (size) 03. 18-inch	50.000 LF	_____.	_____.



Proposal Schedule of Items

Proposal ID: 20170509017 Project(s): 1590-16-71

Federal ID(s): WISC 2017273

SECTION: 0001

Contract Items

Alt Set ID:

Alt Mbr ID:

Proposal Line Number	Item ID Description	Approximate Quantity and Units	Unit Price	Bid Amount
0180	205.0100 Excavation Common	1,460.000 CY	_____	_____
0190	208.0100 Borrow	8,919.000 CY	_____	_____
0200	209.2100 Backfill Granular Grade 2	550.000 CY	_____	_____
0210	211.0100 Prepare Foundation for Asphaltic Paving (project) 01. Project 1590-16-71	LS	LUMP SUM	_____
0220	213.0100 Finishing Roadway (project) 01. Project 1590-16-71	1.000 EACH	_____	_____
0230	305.0110 Base Aggregate Dense 3/4-Inch	2,315.000 TON	_____	_____
0240	305.0120 Base Aggregate Dense 1 1/4-Inch	1,395.000 TON	_____	_____
0250	416.0160 Concrete Driveway 6-Inch	125.000 SY	_____	_____
0260	440.4410 Incentive IRI Ride	114,110.000 DOL	1.00000	114,110.00
0270	455.0605 Tack Coat	34,060.000 GAL	_____	_____
0280	460.2005 Incentive Density PWL HMA Pavement	44,210.000 DOL	1.00000	44,210.00
0290	460.2010 Incentive Air Voids HMA Pavement	64,690.000 DOL	1.00000	64,690.00
0300	460.4110.S Reheating HMA Pavement Longitudinal Joints	150,628.000 LF	_____	_____
0310	460.5223 HMA Pavement 3 LT 58-28 S	36,370.000 TON	_____	_____
0320	460.5224 HMA Pavement 4 LT 58-28 S	28,315.000 TON	_____	_____
0330	465.0105 Asphaltic Surface	365.000 TON	_____	_____



Proposal Schedule of Items

Proposal ID: 20170509017 Project(s): 1590-16-71

Federal ID(s): WISC 2017273

SECTION: 0001

Contract Items

Alt Set ID:

Alt Mbr ID:

Proposal Line Number	Item ID Description	Approximate Quantity and Units	Unit Price	Bid Amount
0340	465.0110 Asphaltic Surface Patching	40.000 TON	_____.	_____.
0350	465.0120 Asphaltic Surface Driveways and Field Entrances	80.000 TON	_____.	_____.
0360	465.0315 Asphaltic Flumes	10.000 SY	_____.	_____.
0370	465.0425 Asphaltic Shoulder Rumble Strips 2-Lane Rural	115,642.000 LF	_____.	_____.
0380	465.0475 Asphalt Center Line Rumble Strips 2-Lane Rural	59,957.000 LF	_____.	_____.
0390	520.1015 Apron Endwalls for Culvert Pipe 15-Inch	2.000 EACH	_____.	_____.
0400	520.3315 Culvert Pipe Class III-A 15-Inch	36.000 LF	_____.	_____.
0410	520.8000 Concrete Collars for Pipe	8.000 EACH	_____.	_____.
0420	521.0124 Culvert Pipe Corrugated Steel 24-Inch	16.000 LF	_____.	_____.
0430	521.1024 Apron Endwalls for Culvert Pipe Steel 24-Inch	7.000 EACH	_____.	_____.
0440	521.1030 Apron Endwalls for Culvert Pipe Steel 30-Inch	1.000 EACH	_____.	_____.
0450	522.0130 Culvert Pipe Reinforced Concrete Class III 30-Inch	18.000 LF	_____.	_____.
0460	522.0142 Culvert Pipe Reinforced Concrete Class III 42-Inch	4.000 LF	_____.	_____.
0470	524.0630 Apron Endwalls for Culvert Pipe Salvaged 30-Inch	3.000 EACH	_____.	_____.



Proposal Schedule of Items

Proposal ID: 20170509017 Project(s): 1590-16-71

Federal ID(s): WISC 2017273

SECTION: 0001

Contract Items

Alt Set ID:

Alt Mbr ID:

Proposal Line Number	Item ID Description	Approximate Quantity and Units	Unit Price	Bid Amount
0480	524.0636 Apron Endwalls for Culvert Pipe Salvaged 36-Inch	2.000 EACH	_____.	_____.
0490	524.0642 Apron Endwalls for Culvert Pipe Salvaged 42-Inch	1.000 EACH	_____.	_____.
0500	601.0411 Concrete Curb & Gutter 30-Inch Type D	5,110.000 LF	_____.	_____.
0510	601.0557 Concrete Curb & Gutter 6-Inch Sloped 36-Inch Type D	1,375.000 LF	_____.	_____.
0520	601.0600 Concrete Curb Pedestrian	145.000 LF	_____.	_____.
0530	602.0405 Concrete Sidewalk 4-Inch	14,245.000 SF	_____.	_____.
0540	602.0505 Curb Ramp Detectable Warning Field Yellow	190.000 SF	_____.	_____.
0580	608.0412 Storm Sewer Pipe Reinforced Concrete Class IV 12-Inch	582.000 LF	_____.	_____.
0590	611.0530 Manhole Covers Type J	2.000 EACH	_____.	_____.
0600	611.0624 Inlet Covers Type H	10.000 EACH	_____.	_____.
0610	611.0639 Inlet Covers Type H-S	3.000 EACH	_____.	_____.
0620	611.2004 Manholes 4-FT Diameter	1.000 EACH	_____.	_____.
0630	611.2006 Manholes 6-FT Diameter	1.000 EACH	_____.	_____.
0640	611.3004 Inlets 4-FT Diameter	7.000 EACH	_____.	_____.
0650	611.3230 Inlets 2x3-FT	6.000 EACH	_____.	_____.



Proposal Schedule of Items

Proposal ID: 20170509017 Project(s): 1590-16-71

Federal ID(s): WISC 2017273

SECTION: 0001

Contract Items

Alt Set ID:

Alt Mbr ID:

Proposal Line Number	Item ID Description	Approximate Quantity and Units	Unit Price	Bid Amount
0660	611.8115 Adjusting Inlet Covers	1.000 EACH	_____.	_____.
0670	611.9800.S Pipe Grates	1.000 EACH	_____.	_____.
0680	614.0370 Steel Plate Beam Guard Energy Absorbing Terminal	14.000 EACH	_____.	_____.
0690	614.0397 Guardrail Mow Strip Emulsified Asphalt	390.000 SY	_____.	_____.
0700	614.0400 Adjusting Steel Plate Beam Guard	2,275.000 LF	_____.	_____.
0710	614.0950 Replacing Guardrail Posts and Blocks	45.000 EACH	_____.	_____.
0720	618.0100 Maintenance And Repair of Haul Roads (project) 01. Project 1590-16-71	1.000 EACH	_____.	_____.
0730	619.1000 Mobilization	1.000 EACH	_____.	_____.
0740	624.0100 Water	20.000 MGAL	_____.	_____.
0750	625.0100 Topsoil	48,430.000 SY	_____.	_____.
0760	627.0200 Mulching	28,080.000 SY	_____.	_____.
0770	628.1504 Silt Fence	11,550.000 LF	_____.	_____.
0780	628.1520 Silt Fence Maintenance	11,550.000 LF	_____.	_____.
0790	628.1905 Mobilizations Erosion Control	4.000 EACH	_____.	_____.
0800	628.1910 Mobilizations Emergency Erosion Control	3.000 EACH	_____.	_____.
0810	628.2004 Erosion Mat Class I Type B	20,350.000 SY	_____.	_____.



Proposal Schedule of Items

Proposal ID: 20170509017 Project(s): 1590-16-71

Federal ID(s): WISC 2017273

SECTION: 0001

Contract Items

Alt Set ID:

Alt Mbr ID:

Proposal Line Number	Item ID Description	Approximate Quantity and Units	Unit Price	Bid Amount
0820	628.7015 Inlet Protection Type C	26.000 EACH	_____.	_____.
0830	628.7504 Temporary Ditch Checks	705.000 LF	_____.	_____.
0840	628.7555 Culvert Pipe Checks	45.000 EACH	_____.	_____.
0850	628.7570 Rock Bags	200.000 EACH	_____.	_____.
0860	629.0210 Fertilizer Type B	30.000 CWT	_____.	_____.
0870	630.0120 Seeding Mixture No. 20	1,210.000 LB	_____.	_____.
0880	630.0140 Seeding Mixture No. 40	62.000 LB	_____.	_____.
0890	634.0614 Posts Wood 4x6-Inch X 14-FT	179.000 EACH	_____.	_____.
0900	634.0616 Posts Wood 4x6-Inch X 16-FT	111.000 EACH	_____.	_____.
0910	637.2210 Signs Type II Reflective H	1,219.720 SF	_____.	_____.
0920	637.2230 Signs Type II Reflective F	528.570 SF	_____.	_____.
0930	638.2602 Removing Signs Type II	252.000 EACH	_____.	_____.
0940	638.3000 Removing Small Sign Supports	297.000 EACH	_____.	_____.
0950	642.5401 Field Office Type D	1.000 EACH	_____.	_____.
0960	643.0100 Traffic Control (project) 01. Project 1590-16-71	1.000 EACH	_____.	_____.
0970	643.0300 Traffic Control Drums	4,250.000 DAY	_____.	_____.



Proposal Schedule of Items

Proposal ID: 20170509017 Project(s): 1590-16-71

Federal ID(s): WISC 2017273

SECTION: 0001

Contract Items

Alt Set ID:

Alt Mbr ID:

Proposal Line Number	Item ID Description	Approximate Quantity and Units	Unit Price	Bid Amount
0980	643.0310.S Temporary Portable Rumble Strips	1.000 LS	_____.	_____.
0990	643.0410 Traffic Control Barricades Type II	175.000 DAY	_____.	_____.
1000	643.0420 Traffic Control Barricades Type III	75.000 DAY	_____.	_____.
1010	643.0705 Traffic Control Warning Lights Type A	3,300.000 DAY	_____.	_____.
1020	643.0715 Traffic Control Warning Lights Type C	250.000 DAY	_____.	_____.
1030	643.0900 Traffic Control Signs	6,560.000 DAY	_____.	_____.
1040	643.1050 Traffic Control Signs PCMS	14.000 DAY	_____.	_____.
1050	646.0106 Pavement Marking Epoxy 4-Inch	97,194.000 LF	_____.	_____.
1060	646.0406 Pavement Marking Same Day Epoxy 4-Inch	96,894.000 LF	_____.	_____.
1070	646.2304.S Pavement Marking Grooved Wet Reflective Epoxy 4-Inch	140,422.000 LF	_____.	_____.
1080	646.2308.S Pavement Marking Grooved Wet Reflective Epoxy 8-Inch	175.000 LF	_____.	_____.
1090	649.0402 Temporary Pavement Marking Paint 4-Inch	177,946.000 LF	_____.	_____.
1100	650.4000 Construction Staking Storm Sewer	15.000 EACH	_____.	_____.
1110	650.5500 Construction Staking Curb Gutter and Curb & Gutter	4,885.000 LF	_____.	_____.
1120	650.8000 Construction Staking Resurfacing Reference	75,314.000 LF	_____.	_____.



Proposal Schedule of Items

Proposal ID: 20170509017 Project(s): 1590-16-71
 Federal ID(s): WISC 2017273

SECTION: 0001 Contract Items

Alt Set ID: Alt Mbr ID:

Proposal Line Number	Item ID Description	Approximate Quantity and Units	Unit Price	Bid Amount
1130	650.9910 Construction Staking Supplemental Control (project) 01. Project 1590-16-71	LS	LUMP SUM	_____.
1140	650.9920 Construction Staking Slope Stakes	33,730.000 LF	_____.	_____.
1150	690.0150 Sawing Asphalt	10,075.000 LF	_____.	_____.
1160	690.0250 Sawing Concrete	95.000 LF	_____.	_____.
1170	ASP.1T0A On-the-Job Training Apprentice at \$5.00/HR	2,400.000 HRS	5.00000	12,000.00
1180	ASP.1T0G On-the-Job Training Graduate at \$5.00/HR	3,040.000 HRS	5.00000	15,200.00
1190	SPV.0060 Special 01. HMA Percent Within Limits (PWL) Test Strip	2.000 EACH	_____.	_____.
1200	SPV.0180 Special 01. Protective Thermoplastic Coating at Snowmobile Crossing	60.000 SY	_____.	_____.
1210	204.0120 Removing Asphaltic Surface Milling	273,460.000 SY	_____.	_____.
1220	608.3018 Storm Sewer Pipe Class III-A 18-Inch	50.000 LF	_____.	_____.
1230	608.3024 Storm Sewer Pipe Class III-A 24-Inch	1,268.000 LF	_____.	_____.
1240	648.0100 Locating No-Passing Zones	14.260 MI	_____.	_____.
Section: 0001			Total:	_____.
			Total Bid:	_____.

