

Wisconsin Department of Transportation

May 30, 2017

Division of Transportation Systems Development

Bureau of Project Development
 4802 Sheboygan Avenue, Rm 601
 P O Box 7916
 Madison, WI 53707-7916

Telephone: (608) 266-1631
 Facsimile (FAX): (608) 266-8459

NOTICE TO ALL CONTRACTORS:

Proposal #06: 1030-11-71
N-S Freeway, CTH K Interchange
CTH K IC Crossroad
IH 94
Racine County

Letting of June 13, 2017

This is Addendum No. 02, which provides for the following:

Special Provisions

Revised Special Provisions	
Article No.	Description
3	Prosecution and Progress

Schedule of Items

Revised Bid Item Quantities					
Bid Item	Item Description	Unit	Old Quantity	Revised Quantity	Proposal Total
205.0100	Excavation Common	CY	64,077	3,615	67,692
312.0110	Select Crushed Material	Ton	29,190	11,693	40,883
608.0412	Storm Sewer Pipe Reinforced Concrete Class IV	LF	1,696	54	1,750
611.0624	Inlet Covers Type H	Each	86	1	87
611.2004	Manholes 4-ft Diameter	Each	5	-2	3
611.3004	Inlets 4-ft Diameter	Each	79	3	82
624.0100	Water	MGal	841	7	848
646.0106	Pavement Marking Epoxy 4-Inch	LF	32,735	180	32,915
646.0844.S	Pavement Marking Grooved Contrast Wet Reflective Epoxy 8-Inch	LF	7,312	-24	7,288
647.0156	Pavement Marking Arrows Epoxy Type 1	Each	3	-1	2
647.0566	Pavement Marking Stop Line Epoxy 18-Inch	LF	582	-8	574
647.0726	Pavement Marking Diagonal Epoxy 12-Inch	LF	1,370	82	1,452
SPV.0060.500	Adjusting Water Valves	Each	13	6	19

Plan Sheets

Revised Plan Sheets	
Plan Sheet	Plan Sheet Title (brief description of changes to sheet)
22	Typical Section – Revised Carol Road typical section to show 16-foot lanes.
59	Plan Details – Revised Carol Road to match existing pavement.
170	Pavement Marking – Revised Carol Road to show edge lane lines to match existing.
208	Miscellaneous Quantities (Revised earthwork summary table to include an undistributed amount for EBS to total 10% of the excavation common total and revised note to have EBS excavation replaced with select crushed material).
209	Miscellaneous Quantities (Revised select crushed material to add replaced EBS excavation. Also revised the water table due to the change in excavation common).
209A	Miscellaneous Quantities (Revised the water table due to the change in excavation common).
219	Miscellaneous Quantities (Revised 2 manholes to be 2 inlets)
220	Miscellaneous Quantities (Added structure 620A which needed to be added to the miscellaneous quantities)
223	Miscellaneous Quantities (Added pipe from 620A to 620B which needed to be added to the miscellaneous quantities)
229	Miscellaneous Quantities (Revised pavement marking for Carol Road revisions and for pavement marking revisions that were a part of Addendum 1).
230	Miscellaneous Quantities (Pavement marking revisions that were a part of Addendum 1).
231	Miscellaneous Quantities (Revised Adjusting Water Valves)
494 - 495	Cross Sections – Carol Road (Revised lane widths).

The responsibility for notifying potential subcontractors and suppliers of these changes remains with the prime contractor.

Sincerely,

Mike Coleman

Proposal Development Specialist
Proposal Management Section

ADDENDUM NO. 02

1030-11-71

May 30, 2017

Special Provisions

3. Prosecution and Progress

*Remove entire section titled **Final Completion of Work.***

*Add the following section titled **Interim and Final Completion of Work:***

Interim and Final Completion of Work

Complete construction operations on CTH K, adjoining ramps and frontage roads, and adjoining municipal streets to the stage necessary to reopen them to through traffic prior to 12:01 AM December 15, 2017. Do not reopen until completing the following work: All work listed in the plans and specification for Stage 1 and Stage 1 sub stages.

If the contractor fails to complete the work necessary to reopen CTH K, adjoining ramps and frontage roads, and adjoining municipal streets to through traffic prior to 12:01 AM December 15, 2015, the department will assess the contractor \$2,065 for damages in interim liquidated damages for each calendar day that the roadway remains closed after 12:01 AM December 15, 2017. An entire calendar day will be charged for any period of time within a calendar day that the road remains closed beyond 12:01 AM.

FD LD (20151210)

If contract time expires prior to completing all work specified in the contract, additional liquidated damages will be affixed according to standard spec 108.11.

The contract time for completion is based on an expedited work schedule and may require extraordinary forces and equipment.

Schedule of Items

Attached, dated May 30, 2017, are the revised Schedule of Items Pages 1, 2, 5 – 7, 10, and 15.

Plan Sheets

The following 8 1/2 x 11-inch sheets are attached and made part of the plans for this proposal:
Revised: 22, 59, 170, 208-209, 209A, 219-220, 223, 229-231, and 494-495.

END OF ADDENDUM

Addendum No. 02
ID 1030-11-71
Revised Sheet 22
May 30, 2017

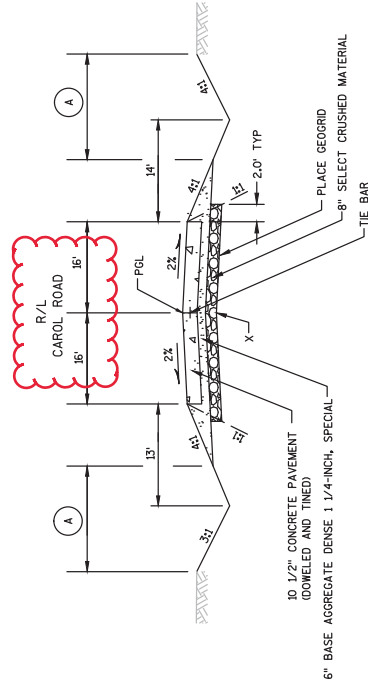

TYPICAL FINISHED SECTION
CAROL ROAD
STA 10+00.00 TO STA 11+43.66

LEGEND

- (A) SEEDING MIXTURE NO. 30 & FERTILIZER TYPE B
- MIXTURE 30, AND FERTILIZER TYPE B.

CURB RETURN DATA TABLE

POINT NO.	STATION	OFFSET	RADIUS
41	58+56.48	50.00' RT	50'
42	58+51.45	36.00' LT	60'
43	59+58.02	50.00' RT	50'
44	59+85.59	39.00' LT	75'

RADIUS TABLE

POINT	STATION	OFFSET	STATION	OFFSET	RADIUS
39	58+58.46	72.00' LT	-	-	40'
40	59+87.08	92.00' LT	-	-	60'

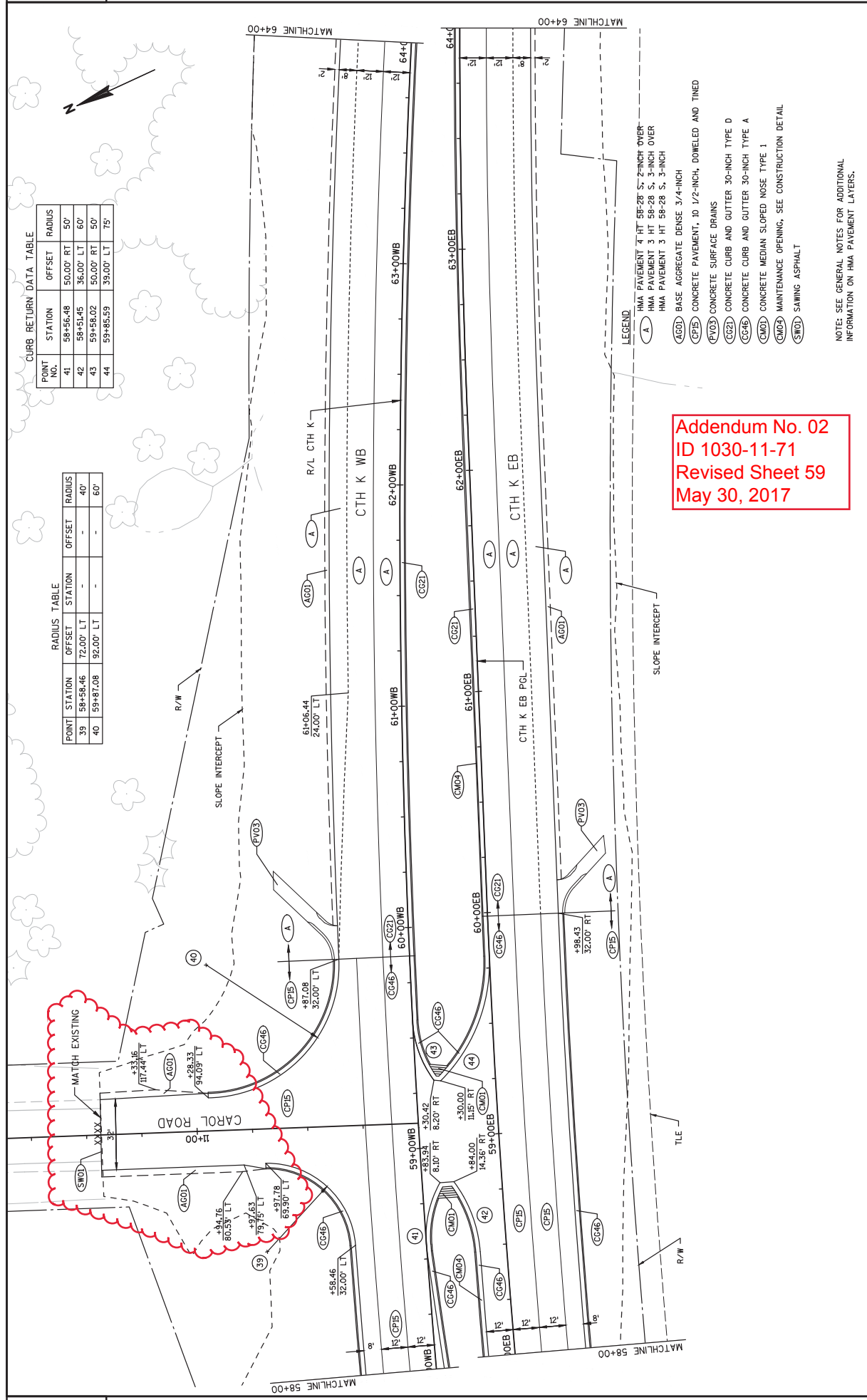

Addendum No. 02
ID 1030-11-71
Revised Sheet 59
May 30, 2017

- LEGEND
- (A) HMA PAVEMENT 4 HT 58-28 S, 2-INCH OVER
 - (A) HMA PAVEMENT 3 HT 58-28 S, 3-INCH
 - (A) HMA PAVEMENT 3 HT 58-28 S, 3-INCH
 - (AG01) BASE AGGREGATE DENSE 3/4-INCH
 - (CP15) CONCRETE PAVEMENT, 10 1/2-INCH, DOMELED AND TINED
 - (PV03) CONCRETE SURFACE DRAINS
 - (CC21) CONCRETE CURB AND GUTTER 30-INCH TYPE D
 - (CC46) CONCRETE CURB AND GUTTER 30-INCH TYPE A
 - (CM01) CONCRETE MEDIAN SLOPED NOSE TYPE 1
 - (CM02) MAINTENANCE OPENING, SEE CONSTRUCTION DETAIL
 - (SW01) SAWING ASPHALT

NOTE: SEE GENERAL NOTES FOR ADDITIONAL INFORMATION ON HMA PAVEMENT LAYERS.

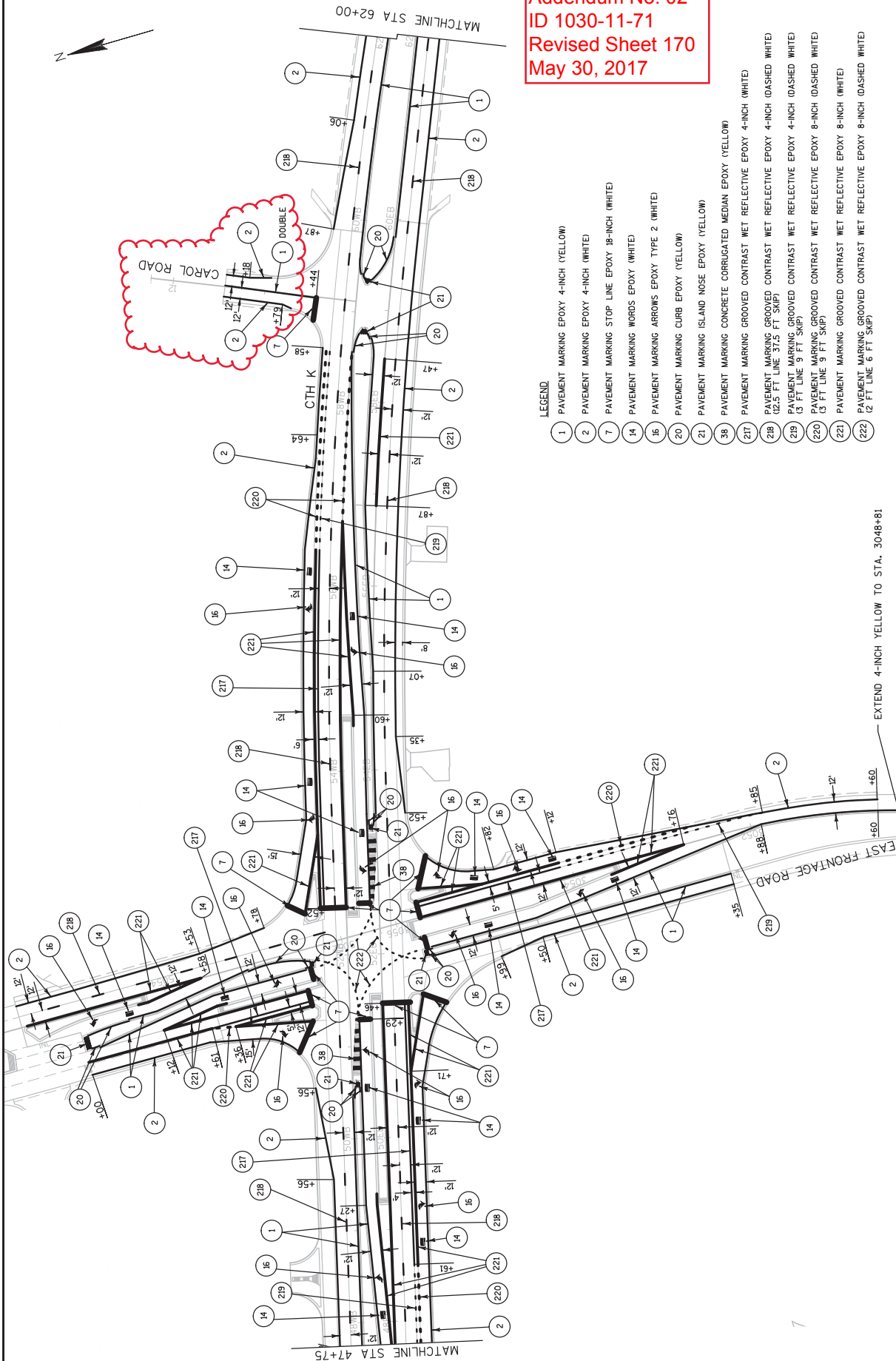

Addendum No. 02
ID 1030-11-71
Revised Sheet 170
May 30, 2017

LEGEND

- 1 PAVEMENT MARKING EPOXY 4-INCH (YELLOW)
- 2 PAVEMENT MARKING EPOXY 4-INCH (WHITE)
- 7 PAVEMENT MARKING STOP LINE EPOXY 18-INCH (WHITE)
- 14 PAVEMENT MARKING WORDS EPOXY (WHITE)
- 16 PAVEMENT MARKING ARROWS EPOXY TYPE 2 (WHITE)
- 20 PAVEMENT MARKING CURB EPOXY (YELLOW)
- 21 PAVEMENT MARKING ISLAND NOSE EPOXY (YELLOW)
- 38 PAVEMENT MARKING CONCRETE CORRUGATED MEDIAN EPOXY (YELLOW)
- 217 PAVEMENT MARKING GROOVED CONTRAST NET REFLECTIVE EPOXY 4-INCH (WHITE)
- 218 PAVEMENT MARKING GROOVED CONTRAST NET REFLECTIVE EPOXY 4-INCH (DASHED WHITE) (2.5 FT LINE 37.5 FT SKIP)
- 219 PAVEMENT MARKING GROOVED CONTRAST NET REFLECTIVE EPOXY 4-INCH (DASHED WHITE) (3 FT LINE 9 FT SKIP)
- 220 PAVEMENT MARKING GROOVED CONTRAST NET REFLECTIVE EPOXY 8-INCH (DASHED WHITE) (3 FT LINE 9 FT SKIP)
- 221 PAVEMENT MARKING GROOVED CONTRAST NET REFLECTIVE EPOXY 8-INCH (WHITE)
- 222 PAVEMENT MARKING GROOVED CONTRAST NET REFLECTIVE EPOXY 8-INCH (DASHED WHITE) (2 FT LINE 6 FT SKIP)

EXTEND 4-INCH YELLOW TO STA. 3048+81

Division	From/To Station	Common Excavation (1)		EBS Excavation (3)	Salvaged/Unusable Pavement Material (4)	Available Material (5)	Expanded EBS Backfill (6)		Unexpanded Fill	Expanded Fill (7)		Mass Ordinate +/- (8)	Waste	Borrow
		Cut (2)	(Item # 205.0100)				Factor 1.25	Factor 1.25		Factor 1.25	Factor 1.25			
Division 1														
CTH K - Under IH 94 Structures	41+83.96/44+11.00	84	0	0	0	84	0	0	0	0	0	84	84	0
CTH K EB R/L - East	45+50/52+27.4	2,710	214	214	0	2,710	268	1,368	1,368	1,710	0	733	733	0
CTH K WB R/L - East	52+18.84/76+00	18,350	463	463	0	18,350	579	3,477	3,477	4,346	0	13,425	13,425	0
NE East Frontage Rd	5052+20/5055+50	1,612	0	0	0	1,612	0	283	283	354	0	1,258	1,258	0
SE East Frontage Rd	3051+00/3055+90	1,601	0	0	0	1,601	0	741	741	926	0	675	675	0
Carol Rd	10+25/11+43.27	406	0	0	0	406	0	56	56	70	0	336	336	0
Temp Widen EFR	3048+00/3052+00	311	0	0	0	311	0	0	0	0	0	311	311	0
Temp Widen EFR SE 1	3054+76.85/3055+90	430	0	0	0	430	0	33	33	41	0	389	389	0
Temp Widen EFR SE 2	52+58.66/57+64.52	804	0	0	0	804	0	28	28	35	0	769	769	0
Temp Widen CTH K North Side	60+00/78+50	805	0	0	0	805	0	1,725	1,725	2,156	0	-1,351	0	1,351
Temp Widen CTH K South Side	68+00/79+00	2,288	0	0	0	2,288	0	542	542	678	0	1,611	1,611	0
Sanitary & Water Main - CTH K East		0	924	924	0	0	1,155	0	0	0	0	0	0	0
Division 1 Subtotal		29,401	1,601	1,601	0	29,401	2,001	8,253	8,253	10,316	18,239	19,590	19,590	1,351
Division 2														
CTH K - West	11+50.4/37+99	30,378	938	938	3,235	27,143	1,173	12,769	12,769	15,961	10,009	10,009	10,009	0
CTH K Transition - West	338+50/341+00	659	0	0	0	659	0	163	163	204	455	455	455	0
NW West Frontage Rd	4053+74.38/4056+50	373	0	0	0	373	0	280	280	350	23	23	23	0
SW West Frontage Rd	2055+00/2058+99.38	727	0	0	0	727	0	170	170	213	515	515	515	0
Division 2 Subtotal		32,137	938	938	3,235	28,902	1,173	13,382	13,382	16,728	11,002	11,002	11,002	0
Undistributed			3,615	3,615			4,519							
Grand Total		61,538	6,154	6,154	3,235	58,303	7,693	21,635	21,635	27,044	29,241	30,592	30,592	1,351
			67,692	67,692										

- 1) Common Excavation is the sum of the Cut and EBS Excavation columns. Item number 205.0100
- 2) Salvaged/Unusable Pavement Material is included in Cut
- 3) EBS Excavation to be backfilled with Select Crushed Material. Item number 312.0110.
- 4) Salvaged/Unusable Pavement Material
- 5) Available Material = Cut - Salvaged/Unusable Pavement Material
- 6) Expanded EBS Backfill - This is to be filled with Cut material. EBS Backfill Factor = 1.25.
- 7) Expanded Fill. Factor = 1.25
- 8) The Mass Ordinate + or - Qty calculated for the Division. Plus quantity indicates an excess of material within the Division. Minus indicates a shortage of material within the Division.

Addendum No. 02
ID 1030-11-71
Revised Sheet 208
May 30, 2017

Addendum No. 02
 ID 1030-11-71
 Revised Sheet 209
 May 30, 2017

BASE AGGREGATE (CONT.)											
CATEGORY	ROADWAY	STATION	TO STATION	305.0110		305.0120		312.0110		645.0220	
				BASE AGGREGATE	DENSE 3/4 INCH	BASE AGGREGATE	DENSE 1 1/4 INCH	SELECT CRUSHED	MATERIAL	TON	GEORID
1000	STAGE 1A	CTHK	E FRONTAGE RD ISLANDS			77					
	E FRONTAGE RD	3051+88	57+28 CTHK			634					
	STAGE 1A SUBTOTAL										
						711					
	STAGE 1B	CTHK	45+18 WB	47+75 WB		657					985
		CTHK	48+50 WB	LT							
		CTHK	47+75 WB	50+44 WB		482					1445
		CTHK	51+91 WB	59+87 WB		1110					3330
	E FRONTAGE RD 3050+60 3055+90										
						885					1133
	E FRONTAGE RD 5052+20 5055+61										
						1086					1484
	CAROL RD										
						215					550
	TEMP PAVT	E FRONTAGE RD	NORTH			429					
		E FRONTAGE RD	NE QUADRANT			89					
		E FRONTAGE RD	SOUTH			309					
		CTHK	59+87 WB	76+00 WB		2391					
	STAGE 1B SUBTOTAL										
						7653					8927
	STAGE 1C	CTHK	50+44 WB	51+91 WB		344					1031
	TEMP PAVT	E FRONTAGE RD	NW QUADRANT			116					
	STAGE 1C SUBTOTAL										
						460					1031
	STAGE 1D	CTHK	44+64 EB	52+07 EB		1761					4989
		CTHK	53+34 EB	59+98 EB		1692					4825
		CTHK	54+13 EB	RT							
		CTHK	56+37 EB	RT							
		CTHK	59+98 EB	76+00 EB		5848					6282
		CTHK	70+76 EB	RT							
		CTHK	67+86 WB	78+89 WB		1,075					
	STAGE 1D SUBTOTAL										
						10,376					16,096
	STAGE 1E	E FRONTAGE RD	SE QUADRANT			364					1093
	TEMP PAVT	CTHK	52+07 EB	53+63 EB		354					
	STAGE 1E SUBTOTAL										
						718					1093
	STAGE 1F	CTHK	59+87 EB	76+00 EB		6730					5263
		CTHK	66+21 WB	LT							
		CTHK	68+40 WB	LT							
		CTHK	74+20 WB	LT							
		CTHK	75+06 WB	LT							
	STAGE 1F SUBTOTAL										
						6730					5263

BASE AGGREGATE (CONT.)											
CATEGORY	ROADWAY	STATION	TO STATION	305.0110		305.0120		312.0110		645.0220	
				BASE AGGREGATE	DENSE 3/4 INCH	BASE AGGREGATE	DENSE 1 1/4 INCH	SELECT CRUSHED	MATERIAL	TON	GEORID
1000	STAGE 1G	E FRONTAGE RD				49					134
		CTHK	51+91 WB	53+63 WB		203					546
	STAGE 1G SUBTOTAL										
						\$252					680
	STAGE 1H	CTHK	50+44 WB	51+91 WB		200					526
		E FRONTAGE RD	NW QUADRANT			67					174
	STAGE 1H SUBTOTAL										
						267					700
	STAGE 1I	E FRONTAGE RD	3050+60	3055+88		489					1423
		E FRONTAGE RD	5052+35	5055+61		590					1491
	STAGE 1I SUBTOTAL										
						1,080					2,914
		CTHK	(SANITARY & WATER BACKFILL)			0					1,386
						509					38,090
	TOTAL STAGE I:										
						28,247					17,545
	STAGE 2A	CTHK	11+50	26+25		144					10013
		CTHK	12+82	RT		89					
		CTHK	21+00	RT		301					
		CTHK	25+59	33+00		31					7346
		CTHK	26+92	RT		44					
		CTHK	31+30	RT		13					
		W FRONT RD	SW QUAD								726
		W FRONT RD	NW QUAD			242					335
		W FRONT RD	NE QUAD			261					331
		W FRONT RD	SE QUAD			306					387
		CTHK	33+29	38+00							2486
		CTHK	34+44	RT		8					
		CTHK	34+88	RT		19					
		CTHK	35+79	RT		8					
		CTHK	38+00	41+55							1852
	STAGE 2A SUBTOTAL										
						657					11,174
	STAGE 2B	CTHK	33+00	33+29		133					368
		W FRONT RD	MEDIANS			239					717
	STAGE 2B SUBTOTAL										
						372					471
	TOTAL STAGE 2:										
						657					11,645
		EBS	0	0		0					11,693
		MCHELS DW	0	546		546					0
	TOTAL										
						1,166					40,883
						47,556					65,675

PAVEMENT REPAIR

495,1000.S
COLD PATCH
TON

CATEGORY	LOCATION	TON
1000	UNDISTRIBUTED	20
TOTAL:		20

OMP BASE AGGREGATE

371,1000.S
OMP BASE AGGREGATE
DENSE 1 1/4 INCH COMPACTION
TON

CATEGORY	PROJECT	TON
1000	1030-11-71	47,556
TOTAL:		47,556

WATER

624,0100
WATER
MGAL

CATEGORY	LOCATION	MGAL
1000	PROJECT - BASE AGGREGATE (COMPACTION)	713
	PROJECT - EXCAVATION (DUST CONTROL)	135
TOTAL:		848

CONCRETE PAVEMENT JOINT LAYOUT

SPV,0105,003
CONCRETE PAVEMENT
JOINT LAYOUT
LS

CATEGORY	LOCATION	LS
1000	CTH K & FRONTA GE ROADS	1
TOTAL:		1

Addendum No. 02
ID 1030-11-71
Revised Sheet 209A
May 30, 2017

Addendum No. 02
ID 1030-11-71
Revised Sheet 219
May 30, 2017

STORMSEWER (CONT.)

CATEGORY	STRUCTURE NUMBER	STATION	OFFSET	611.2004		611.2007		611.3003		611.3004		611.3901		611.0535		611.0606		611.0624		611.0642		5208000
				MANHOLES 4-FT DIAMETER EACH	MANHOLES 6-FT DIAMETER EACH	MANHOLES 7-FT DIAMETER EACH	INLETS 3-FT DIAMETER EACH	INLETS 4-FT DIAMETER EACH	INLETS 4-FT DIAMETER EACH	INLETS 4-FT DIAMETER EACH	INLETS 4-FT DIAMETER EACH	INLETS 4-FT DIAMETER EACH	INLETS 4-FT DIAMETER EACH	INLETS 4-FT DIAMETER EACH	INLETS 4-FT DIAMETER EACH	INLETS 4-FT DIAMETER EACH	INLETS 4-FT DIAMETER EACH	INLETS 4-FT DIAMETER EACH	INLETS 4-FT DIAMETER EACH	INLETS 4-FT DIAMETER EACH	INLETS 4-FT DIAMETER EACH	
1000	606C	27+50.0	89.5'LT	1																		
	606	27+50.0	54.0'LT	1																		
	607A	24+50.0	1.5'LT																			
	607B	24+50.0	27.7'LT																			
	607C	24+50.0	62.8'LT																			
	607	24+50.0	47.2'LT																			
	608	21+60.0	32.6'LT																			
	608A	21+60.0	14.7'LT																			
	608B	21+60.0	1.5'LT																			
	608C	21+60.0	77.9'RT																			
	610A	40+32.7	7.4'LT																			
	610B	40+32.6	13.0'LT																			
	610C	41+33.7	81.6'LT																			
	610D	41+18.2	102.8'LT																			
	614	45+07.0	54.0'LT																			
	614A	45+12.0	64.4'LT																			
	614B	44+96.9	62.3'RT																			
	615A	48+00.0	41.5'RT																			
	615B	48+00.0	19.0'LT																			
	615C	48+00.0	34.5'LT																			
	615D	47+96.0	77.5'LT																			
	615E	46+50.1	30.1'RT																			
	615F	47+31.4	74.1'LT																			
	615	48+00.0	54.0'LT																			
	616A	50+50.0	77.5'LT																			
	616B	50+54.0	27.5'LT																			
	616C	50+54.5	33.6'LT																			
	616	50+50.0	54.0'LT																			
	617A	51+41.0	68.7'RT																			
	617B	51+46.6	41.6'RT																			
	617C	51+49.0	29.9'RT																			
	617D	51+45.8	1.5'LT																			
	617E	51+45.8	12.5'LT																			
	617F	51+49.9	172.6'LT																			
	617G	51+43.1	171.0'LT																			
	617H	51+36.0	107.8'LT																			
	617I	51+29.9	106.8'LT																			
	617	51+25.0	54.0'LT																			
	618A	52+75.0	73.6'LT																			
	618B	52+75.0	66.8'LT																			
	SUBTOTAL:				1	8	0	2	2	0	7	0	29	0	0	2	29	0	0	0	0	3

CONTINUED ON NEXT PAGE

SHEET NO: 219

PROJECT NO: 1030-11-71

HWY: IH 94/CTH K

COUNTY: RACINE

MISCELLANEOUS QUANTITIES

DATE: 5/25/2017 11:10 AM

PLOT NAME: 032001.mxd

PLOT SCALE: 1.000000:1.000000

WISDOT/CADDSS SHEET 42

STORM SEWER (CONT.)

CATEGORY	611.2004	611.2006	611.2007	611.3003	611.3004	611.3901	611.0535	611.0606	611.0624	611.0642	520.8000			
STRUCTURE	MANHOLES	MANHOLES	MANHOLES	INLETS	INLETS	INLETS	MANHOLE	INLET	INLET	INLET	CONCRETE			
NUMBER	DIAMETER	DIAMETER	DIAMETER	DIAMETER	DIAMETER	DIAMETER	COVERS	COVERS	COVERS	COVERS	COLLARS			
	4-FT	6-FT	7-FT	3-FT	4-FT	1 GRATE	TYPE J-SPECIAL	TYPE B	TYPE H	TYPE MS	FOR PIPE			
	OFFSET	DIAMETER	DIAMETER	DIAMETER	DIAMETER	TYPE	TYPE	TYPE	TYPE	TYPE	DEPTH			
	STATION	EACH	EACH	EACH	EACH	EACH	EACH	EACH	EACH	EACH	ELEV			
	OFFSET	DIAMETER	DIAMETER	DIAMETER	DIAMETER	DIAMETER	DIAMETER	DIAMETER	DIAMETER	DIAMETER	ELEV			
	STATION	DIAMETER	DIAMETER	DIAMETER	DIAMETER	DIAMETER	DIAMETER	DIAMETER	DIAMETER	DIAMETER	ELEV			
	STATION	DIAMETER	DIAMETER	DIAMETER	DIAMETER	DIAMETER	DIAMETER	DIAMETER	DIAMETER	DIAMETER	ELEV			
618C	52+62.6	61.9 RT	---	---	---	---	---	---	---	---	772.04	3.5	---	---
618D	52+68.3	60.6 RT	---	---	---	---	---	---	---	---	771.97	4.0	---	---
618	52+75.0	54.0 LT	---	---	---	---	---	---	---	---	772.52	10.1	---	---
619A	54+50.0	33.5 RT	---	---	---	---	---	---	---	---	770.59	3.6	---	---
619B	54+50.0	1.5 LT	---	---	---	---	---	---	---	---	771.35	4.7	---	---
619C	54+50.0	8.5 LT	---	---	---	---	---	---	---	---	771.17	4.6	---	---
619D	54+50.0	23.5 LT	---	---	---	---	---	---	---	---	771.41	5.0	---	---
619E	54+50.0	34.5 LT	---	---	---	---	---	---	---	---	771.59	5.3	---	---
619F	54+50.0	77.5 LT	---	---	---	---	---	---	---	---	772.39	3.8	---	---
619	54+50.0	54.0 LT	---	---	---	---	---	---	---	---	771.95	10.6	---	---
620A	58+54.0	32.0 LT	---	---	---	---	---	---	---	---	766	3.5	---	---
620B	58+68.0	17.3 LT	---	---	---	---	---	---	---	---	766.67	4.8	---	---
620C	58+68.0	31.9 LT	---	---	---	---	---	---	---	---	766.94	5.4	---	---
620D	58+50.0	69.5 LT	---	---	---	---	---	---	---	---	767.85	3.7	---	---
620	58+57.4	54.0 LT	---	---	---	---	---	---	---	---	767.52	7.6	---	---
621	59+94.8	54.0 LT	---	---	---	---	---	---	---	---	765.56	6.3	---	---
622	60+45.9	56.6 LT	---	---	---	---	---	---	---	---	---	---	---	---
623A	63+11.4	24.5 LT	---	---	---	---	---	---	---	---	762.81	4.5	---	---
623B	62+91.5	25.4 LT	---	---	---	---	---	---	---	---	762.81	4.5	---	---
623C	63+01.5	25.0 LT	---	---	---	---	---	---	---	---	762.80	4.8	---	---
623D	62+82.5	1.5 LT	---	---	---	---	---	---	---	---	762.25	4.0	---	---
623E	62+92.5	1.5 LT	---	---	---	---	---	---	---	---	762.25	4.3	---	---
623F	62+92.5	52.3 RT	---	---	---	---	---	---	---	---	---	---	---	---
301A	3053+56.7	8.6 LT	---	---	---	---	---	---	---	---	770.41	3.1	---	---
301B	3053+57.5	1.5 LT	---	---	---	---	---	---	---	---	770.50	3.2	---	---
301C	3053+51.1	35.0 RT	---	---	---	---	---	---	---	---	---	---	---	---
EX302A	3052+37.0	42.5 LT	---	---	---	---	---	---	---	---	769.46	2.5	1	SEE NOTE 3
302C	3052+39.3	9.1 LT	---	---	---	---	---	---	---	---	769.61	3.9	---	---
302E	3052+29.4	7.8 LT	---	---	---	---	---	---	---	---	769.60	3.9	---	---
EX302E	5054+88.9	26.5 LT	---	---	---	---	---	---	---	---	770.93	4.6	---	SEE NOTE 3
EX501B	5054+88.9	42.5 LT	---	---	---	---	---	---	---	---	770.51	4.3	1	SEE NOTE 3
501C	5045+92.5	9.3 LT	---	---	---	---	---	---	---	---	770.62	4.1	---	---
SUBTOTAL:	0	3	1	0	23	0	5	0	25	0	2	2	5	---
TOTAL:	3	15	1	2	82	2	17	2	87	2	5	5	---	---

1. RIMELEVATIONS ARE GIVEN AT THE FLANGE LINE FOR INLET GRATES OR THE CENTER OF THE MANHOLE STRUCTURE FOR MANHOLES AT CTH K R/L.
 2. STR DEPTH = RIMELEV - INV
 9' FOR TYPE J COVERS; AND 6" FOR TYPE H COVERS
 3. REMOVE COVER PLATE LEFT IN PLACE UNDER ID 1030-11-70 AND REPLACE WITH INLET COVER
 4. FLAT TOP SLAB WITH CENTERED 36 3/16 X 24 1/4-INCH RECTANGULAR OPENING REQUIRED

STORM SEWER (CONT.)

CATEGORY 1000 608.0312 608.0315 608.0318 608.0324 608.0330 608.0336 608.0412 608.0415 608.0436 610.0419 608.3012 608.3015 522.1012 522.1015 522.1036 633.5200 611.9800.S ** **

FROM STR	TO STR	INLET ELEV	DISCH ELEV	SLOPE (FT/FT)	12-INCH		15-INCH		18-INCH		24-INCH		30-INCH		36-INCH		19X30-INCH		CLASS HE-IV		CLASS III-A		PIPE REINFORCED CONCRETE		APRON END WALLS FOR CULVERT		CULVERT MARKERS		PIPE GRATES		JOINT TIES		COMMENTS
					LF	LF	LF	LF	LF	LF	LF	LF	LF	LF	LF	LF	LF	LF	LF	LF	LF	LF	LF	LF	LF	LF	LF	LF	LF	LF	LF	LF	
618C	618D	768.04	767.98	0.01					5.9																								
618D	618	767.98	766.83	0.010				114.8																									
618	619	762.47	761.86	0.004				1762																									
619A	619B	767.01	766.66	0.010				35.0																									
619B	619C	766.66	766.59	0.010															7.0														
619C	619D	766.59	766.44	0.010																													
619D	619E	766.44	766.33	0.010															11.0														
619E	619	766.33	766.14	0.010																													
619F	619	768.59	768.36	0.010				23.5																									
619	620	761.36	759.91	0.004				412.2																									
620A	620B	762.38	762.11	0.005				54.0																									
620B	620C	761.86	761.79	0.005																			14.6										
620C	620	761.54	761.42	0.005			24.6																										
620D	620	764.17	764.00	0.010				17.2																									
620	621	759.91	759.35	0.004				139.1																									
621	622	759.35	759.05	0.005																													
622	OUTLET	759.05																															
623A	623C	758.34	758.29	0.005			10.0																										
623B	623C	758.34	758.29	0.005			10.1																										
623C	623E	758.04	757.91	0.005																													
623D	623E	758.21	758.16	0.005																													
623E	623F	757.91	757.37	0.010																													
623F	OUTLET	757.37																															
301A	301B	767.33	767.30	0.004																													
301B	301C	767.30	767.12	0.005																													
301C	OUTLET	767.12																															
EX.302B	302E	766.01	765.66	0.010																													
302C	302E	765.76	765.66	0.010																													
302E	EX.302E	765.66	765.59	0.010																													
501A	501B	766.38	766.22	0.010																													
501C	501A	766.56	766.38	0.010																													
SUBTOTAL:		55	0	25	0	176	551	390	79	57	0	18	15	47	1	1	1	1	1	1	1	1	1	1	1	1	1	1	1	1	1	1	18
TOTAL:		279	126	68	1387	651	631	1750	140	88	282	61	47	2	1	1	2	3	5	4	4	30	2	4	2	4	30	2	4	4	4	30	

1. STATIONS AND OFFSETS ARE TO THE CENTER OF STRUCTURES OR TO THE END OF PIPE WHERE THERE IS AN ENDWALL. PIPE LENGTHS ARE MEASURED TO THE CENTER OF STRUCTURE OR ENDWALL CONNECTION AND DO NOT INCLUDE THE LAYING LENGTH OF ENDWALLS.
 2. JOINT TIES FOR CONCRETE PIPE SHALL BE PROVIDED AT ALL REINFORCED CONCRETE APRON ENDWALL LOCATIONS. APRON ENDWALLS SHALL BE TIED FOR THE LAST THREE JOINTS AT PIPE ENDS. THE COST OF THESE TIES SHALL BE INCLUDED IN THE CONTRACT UNIT PRICE FOR THE REINFORCED CONCRETE STORM SEWER PIPE.

** FOR INFORMATION ONLY
 *** ADDITIONAL QUANTITIES SHOWN ELSEWHERE SEE CULVERT TABLE

**Addendum No. 02
 ID 1030-11-71
 Revised Sheet 223
 May 30, 2017**

PAVEMENT MARKING ITEMS

CATEGORY	LOCATION	STATION	TO STATION	PAVEMENT MARKING EPOXY 4-INCH		PAVEMENT MARKING GROOVED CONTRAST WET REFLECTIVE EPOXY 4-INCH				PAVEMENT MARKING GROOVED CONTRAST WET REFLECTIVE EPOXY 8-INCH			
				YELLOW L F	WHITE L F	WHITE L F	12.5 FT LINE L F	3 FT LINE L F	9 FT SKIP L F	2 FT LINE L F	6 FT SKIP L F	2 FT LINE L F	6 FT SKIP L F
1000	CTHK	11+50	32+60	5637	4151	440	462.5	39	--	--	--	30	1,167
		32+31	33+93	--	--	--	--	--	--	114	--	--	--
		33+65	41+33	1489	1450	39	212.5	57	--	--	--	111	828
		SB RAMP		83	76	--	--	--	--	--	--	--	83
		41+95	43+86	382	328	--	--	--	--	--	--	--	361
		NB RAMP		92	79	--	--	--	--	--	--	--	--
		43+81	51+46	1716	1236	345	263	66	18	--	--	117	1,263
		51+29	52+65	--	--	--	--	--	--	96	--	--	--
		52+52	76+00	6009	4464	390	550	54	--	--	--	99	1,280
		WEST FRONTAGE RD.	2054+33	2058+90	740	786	191	--	63	--	--	45	271
	4053+82	4057+60	581	599	101	--	--	--	--	39	262		
EAST FRONTAGE RD.	3048+81	3055+79	1026	789	161	--	54	--	--	36	613		
	5052+15	5055+61	381	517	112	88	--	--	--	6	677		
CAROL RD.	10+44	11+44	200	124	--	--	--	--	--	--	--	--	
SUBTOTAL			18,336	14,579	1,779	1,576	711	18	210	483	6,805		
TOTAL			32,915	4,294							7,288		

Addendum No. 02
ID 1030-11-71
Revised Sheet 229
May 30, 2017

Addendum No. 02
ID 1030-11-71
Revised Sheet 230
May 30, 2017

PAVEMENT MARKING ITEMS (CONTINUED)

CATEGORY	LOCATION	STATION	TO STATION	PAVEMENT MARKING		PAVEMENT MARKING		PAVEMENT MARKING		PAVEMENT MARKING		PAVEMENT MARKING		PAVEMENT MARKING		PAVEMENT MARKING CONCRETE CORRUGATED MEDIAN EPOXY YELLOW YELLOW
				ARROWS EPOXY TYPE 1 WHITE EA	ARROWS EPOXY TYPE 2 WHITE EA	ARROWS EPOXY TYPE 3 WHITE EA	WORDS EPOXY WHITE EA	CURB EPOXY YELLOW LF	STOP LINE EPOXY 18-INCH WHITE LF	ISLAND NOSE EPOXY YELLOW EA	DIAGONAL EPOXY 12-INCH WHITE LF	DIAGONAL EPOXY 12-INCH YELLOW LF				
1000	CTHK	11+60	32+60	--	4	--	4	--	27	26	--	2	--	614	--	--
		32+31	33+93	--	--	--	--	--	--	--	--	--	--	--	--	--
		33+65	41+33	2	5	--	4	--	27	47	--	2	--	--	--	--
		SB RAMP	41+95	--	1	1	1	--	--	42	--	--	--	--	--	--
		NB RAMP	43+86	--	--	--	--	--	--	28	--	--	--	--	--	--
			43+86	--	6	--	5	--	27	38	--	2	--	93	--	135
			51+29	--	--	--	--	--	--	--	--	--	--	--	--	--
			52+52	--	4	--	4	--	112	61	--	4	--	663	--	193
		WEST FRONTAGE RD.	2054+33	--	2	--	2	--	33	45	--	1	--	--	--	--
			4053+82	--	2	--	2	--	33	46	--	1	--	--	--	--
	EAST FRONTAGE RD.	3048+81	--	4	--	4	--	10	66	--	1	--	--	--	--	
		5052+15	--	3	--	2	--	129	66	--	2	--	--	--	--	
	CAROL RD.	10+44	11+44	--	--	--	--	--	24	--	--	--	--	--	--	
	SUBTOTAL			2	31	1	28	398	574	574	15	82	1,370	328		
	TOTAL			2	31	1	28	398	574	574	15	82	1,370	328		

ADJUSTING WATER VALVES

CATEGORY	ROADWAY	STATION	OFFSET	SPV,0060.500 ADJUSTING WATER VALVES EACH
1000	CTHK	50+71WB	58.2' LT	1
		50+88WB	52.8' LT	1
		51+03WB	57.7' LT	1
		52+99WB	42.7' LT	1
		53+04WB	47.9' LT	1
		55+69WB	53.8' LT	1
		64+28WB	34.5' LT	2
		64+39WB	37.4' LT	2
		69+14WB	39.7' LT	2
		69+24WB	42.2' LT	2
		74+34WB	43.4' LT	2
		74+40WB	45.7' LT	2
	CAROL ROAD	10+68	43.0' LT	1
	TOTAL			19

STEEL PLATE BEAM GUARD

CATEGORY	LOCATION	STAGE	STATION	TO STATION	STEEL PLATE BEAM GUARD SHORT RADIUS TEMPORARY	STEEL PLATE BEAM GUARD ENERGY ABSORBING TERMINAL TEMPORARY	STEEL PLATE BEAM GUARD SHORT RADIUS TERMINAL	STEEL PLATE BEAM GUARD REMOVING GUARDRAIL
					LF	EACH	EACH	LF
1000	CTHK (EAST END)	1D/MG	69WB+75	70WB+70	37	1	1	37
			70WB+85	73WB+25	37	1	1	37
			TOTAL:		74	2	2	74

Addendum No. 02
ID 1030-11-71
Revised Sheet 231
May 30, 2017

Addendum No. 02
 ID 1030-11-71
 Revised Sheet 494
 May 30, 2017

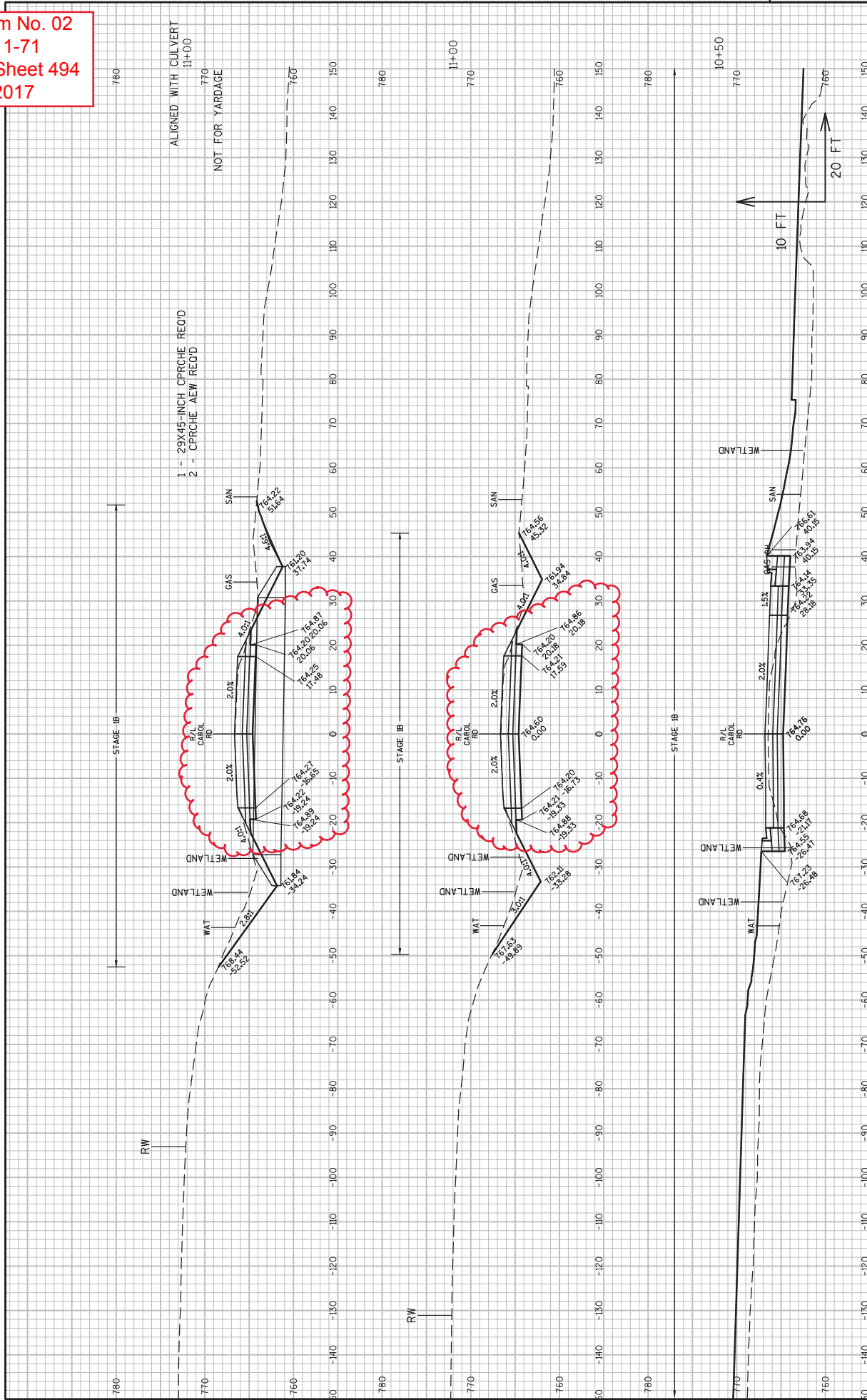

Addendum No. 02
ID 1030-11-71
Revised Sheet 495
May 30, 2017

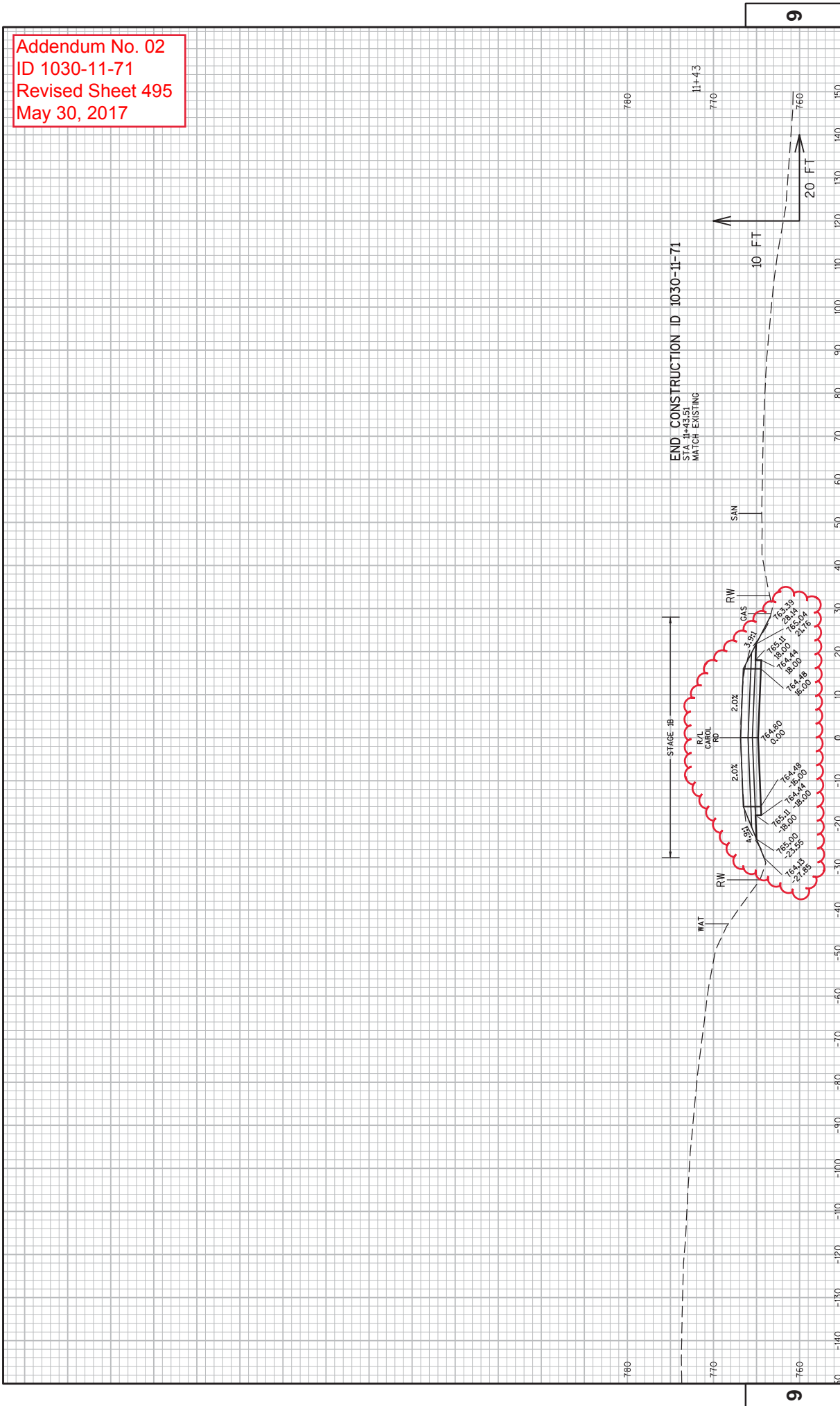

PROJECT NO: 1030-11-71
HWY: IH 94/CTH K
COUNTY: RACINE
CROSS SECTIONS: CAROL ROAD
CROSS SECTIONS: RACINE
SHEET 495
E
PLOT DATE : 5/22/2017 7:56 AM
PLOT BY : JOHANSEN, AMANDA A
PLOT NAME :
PLOT SCALE : 1 IN:20 FT
WSDOT/CADD SHEET 49
FILE NAME : N:\VPOS\C3D\10301100\SHEETS\PLAN\1030-11-71\090202-X5.DWG
LAYOUT NAME - XS A2



Proposal Schedule of Items

Proposal ID: 20170613006 Project(s): 1030-11-71

Federal ID(s): N/A

SECTION: 0001

Contract Items

Alt Set ID:

Alt Mbr ID:

Proposal Line Number	Item ID Description	Approximate Quantity and Units	Unit Price	Bid Amount
0010	108.4400 CPM Progress Schedule	1.000 EACH	_____.	_____.
0020	201.0105 Clearing	11.000 STA	_____.	_____.
0030	201.0120 Clearing	120.000 ID	_____.	_____.
0040	201.0205 Grubbing	11.000 STA	_____.	_____.
0050	201.0220 Grubbing	120.000 ID	_____.	_____.
0060	203.0100 Removing Small Pipe Culverts	21.000 EACH	_____.	_____.
0070	204.0100 Removing Pavement	14,558.000 SY	_____.	_____.
0080	204.0150 Removing Curb & Gutter	180.000 LF	_____.	_____.
0090	204.0210 Removing Manholes	3.000 EACH	_____.	_____.
0100	204.0245 Removing Storm Sewer (size) 008. 18-Inch	35.000 LF	_____.	_____.
0110	204.0245 Removing Storm Sewer (size) 014. 24x38-Inch	59.000 LF	_____.	_____.
0120	204.9060.S Removing (item description) 001. Wooden Bollards	4.000 EACH	_____.	_____.
0130	204.9060.S Removing (item description) 002. Cover Plates Left In Place	3.000 EACH	_____.	_____.
0150	205.0100 Excavation Common	67,692.000 CY	_____.	_____.
0160	213.0100 Finishing Roadway (project) 002. 1030-11-71	1.000 EACH	_____.	_____.



Proposal Schedule of Items

Proposal ID: 20170613006 Project(s): 1030-11-71

Federal ID(s): N/A

SECTION: 0001

Contract Items

Alt Set ID:

Alt Mbr ID:

Proposal Line Number	Item ID Description	Approximate Quantity and Units	Unit Price	Bid Amount
0170	305.0110 Base Aggregate Dense 3/4-Inch	1,166.000 TON	_____.	_____.
0180	305.0120 Base Aggregate Dense 1 1/4-Inch	47,556.000 TON	_____.	_____.
0190	310.0115 Base Aggregate Open-Graded	30.000 CY	_____.	_____.
0200	312.0110 Select Crushed Material	40,883.000 TON	_____.	_____.
0210	371.1000.S QMP Base Aggregate Dense 1 1/4-Inch Compaction	47,556.000 TON	_____.	_____.
0220	415.0095 Concrete Pavement 9 1/2-Inch	8,334.000 SY	_____.	_____.
0230	415.0105 Concrete Pavement 10 1/2-Inch	22,835.000 SY	_____.	_____.
0240	416.0160 Concrete Driveway 6-Inch	68.000 SY	_____.	_____.
0250	416.1010 Concrete Surface Drains	26.000 CY	_____.	_____.
0260	440.4410 Incentive IRI Ride	7,651.000 DOL	1.00000	7,651.00
0270	455.0605 Tack Coat	2,331.000 GAL	_____.	_____.
0280	460.2000 Incentive Density HMA Pavement	5,410.000 DOL	1.00000	5,410.00
0290	460.7223 HMA Pavement 3 HT 58-28 S	6,407.000 TON	_____.	_____.
0300	460.7224 HMA Pavement 4 HT 58-28 S	2,135.000 TON	_____.	_____.
0310	465.0120 Asphaltic Surface Driveways and Field Entrances	236.000 TON	_____.	_____.
0320	465.0125 Asphaltic Surface Temporary	3,636.000 TON	_____.	_____.



Proposal Schedule of Items

Proposal ID: 20170613006 Project(s): 1030-11-71

Federal ID(s): N/A

SECTION: 0001

Contract Items

Alt Set ID:

Alt Mbr ID:

Proposal Line Number	Item ID Description	Approximate Quantity and Units	Unit Price	Bid Amount
0610	608.0318 Storm Sewer Pipe Reinforced Concrete Class III 18-Inch	68.000 LF	_____.	_____.
0620	608.0324 Storm Sewer Pipe Reinforced Concrete Class III 24-Inch	1,387.000 LF	_____.	_____.
0630	608.0330 Storm Sewer Pipe Reinforced Concrete Class III 30-Inch	651.000 LF	_____.	_____.
0640	608.0336 Storm Sewer Pipe Reinforced Concrete Class III 36-Inch	631.000 LF	_____.	_____.
0650	608.0412 Storm Sewer Pipe Reinforced Concrete Class IV 12-Inch	1,750.000 LF	_____.	_____.
0660	608.0415 Storm Sewer Pipe Reinforced Concrete Class IV 15-Inch	140.000 LF	_____.	_____.
0670	608.0436 Storm Sewer Pipe Reinforced Concrete Class IV 36-Inch	88.000 LF	_____.	_____.
0680	608.3012 Storm Sewer Pipe Class III-A 12-Inch	61.000 LF	_____.	_____.
0690	608.3015 Storm Sewer Pipe Class III-A 15-Inch	47.000 LF	_____.	_____.
0700	610.0419 Storm Sewer Pipe Reinforced Concrete Horizontal Elliptical Class HE-IV 19x30-Inch	282.000 LF	_____.	_____.
0710	611.0535 Manhole Covers Type J-Special	17.000 EACH	_____.	_____.
0720	611.0606 Inlet Covers Type B	2.000 EACH	_____.	_____.
0730	611.0624 Inlet Covers Type H	87.000 EACH	_____.	_____.
0740	611.0642 Inlet Covers Type MS	2.000 EACH	_____.	_____.



Proposal Schedule of Items

Proposal ID: 20170613006 Project(s): 1030-11-71

Federal ID(s): N/A

SECTION: 0001

Contract Items

Alt Set ID:

Alt Mbr ID:

Proposal Line Number	Item ID Description	Approximate Quantity and Units	Unit Price	Bid Amount
0750	611.2004 Manholes 4-FT Diameter	3.000 EACH	_____.	_____.
0760	611.2006 Manholes 6-FT Diameter	15.000 EACH	_____.	_____.
0770	611.2007 Manholes 7-FT Diameter	1.000 EACH	_____.	_____.
0780	611.3003 Inlets 3-FT Diameter	2.000 EACH	_____.	_____.
0790	611.3004 Inlets 4-FT Diameter	82.000 EACH	_____.	_____.
0800	611.3901 Inlets Median 1 Grate	2.000 EACH	_____.	_____.
0810	611.8115 Adjusting Inlet Covers	2.000 EACH	_____.	_____.
0820	611.8120.S Cover Plates Temporary	15.000 EACH	_____.	_____.
0830	611.9800.S Pipe Grates	6.000 EACH	_____.	_____.
0840	612.0106 Pipe Underdrain 6-Inch	815.000 LF	_____.	_____.
0850	612.0700 Drain Tile Exploration	2,000.000 LF	_____.	_____.
0860	616.0700.S Fence Safety	5,000.000 LF	_____.	_____.
0870	618.0100 Maintenance And Repair of Haul Roads (project) 002. 1030-11-71	1.000 EACH	_____.	_____.
0880	619.1000 Mobilization	1.000 EACH	_____.	_____.
0890	620.0100 Concrete Corrugated Median	1,169.000 SF	_____.	_____.
0900	620.0300 Concrete Median Sloped Nose	2,736.000 SF	_____.	_____.



Proposal Schedule of Items

Proposal ID: 20170613006 Project(s): 1030-11-71

Federal ID(s): N/A

SECTION: 0001

Contract Items

Alt Set ID:

Alt Mbr ID:

Proposal Line Number	Item ID Description	Approximate Quantity and Units	Unit Price	Bid Amount
0910	621.0100 Landmark Reference Monuments	3.000 EACH	_____.	_____.
0920	623.0200 Dust Control Surface Treatment	63,855.000 SY	_____.	_____.
0930	624.0100 Water	848.000 MGAL	_____.	_____.
0940	625.0500 Salvaged Topsoil	48,676.000 SY	_____.	_____.
0950	627.0200 Mulching	48,676.000 SY	_____.	_____.
0960	628.1104 Erosion Bales	36.000 EACH	_____.	_____.
0970	628.1504 Silt Fence	4,845.000 LF	_____.	_____.
0980	628.1520 Silt Fence Maintenance	4,845.000 LF	_____.	_____.
0990	628.1905 Mobilizations Erosion Control	6.000 EACH	_____.	_____.
1000	628.1910 Mobilizations Emergency Erosion Control	6.000 EACH	_____.	_____.
1010	628.1920 Cleaning Sediment Basins	6.000 CY	_____.	_____.
1020	628.2004 Erosion Mat Class I Type B	61,227.000 SY	_____.	_____.
1030	628.7005 Inlet Protection Type A	108.000 EACH	_____.	_____.
1040	628.7020 Inlet Protection Type D	103.000 EACH	_____.	_____.
1050	628.7504 Temporary Ditch Checks	453.000 LF	_____.	_____.
1060	628.7555 Culvert Pipe Checks	13.000 EACH	_____.	_____.
1070	628.7560 Tracking Pads	4.000 EACH	_____.	_____.



Proposal Schedule of Items

Proposal ID: 20170613006 Project(s): 1030-11-71

Federal ID(s): N/A

SECTION: 0001

Contract Items

Alt Set ID:

Alt Mbr ID:

Proposal Line Number	Item ID Description	Approximate Quantity and Units	Unit Price	Bid Amount
1400	646.0103 Pavement Marking Paint 4-Inch	20,544.000 LF	_____.	_____.
1410	646.0106 Pavement Marking Epoxy 4-Inch	32,915.000 LF	_____.	_____.
1420	646.0690.S Removing Pavement Markings Water Blasting	817.000 LF	_____.	_____.
1430	646.0842.S Pavement Marking Grooved Contrast Wet Reflective Epoxy 4-Inch	4,294.000 LF	_____.	_____.
1440	646.0844.S Pavement Marking Grooved Contrast Wet Reflective Epoxy 8-Inch	7,288.000 LF	_____.	_____.
1450	647.0156 Pavement Marking Arrows Epoxy Type 1	2.000 EACH	_____.	_____.
1460	647.0166 Pavement Marking Arrows Epoxy Type 2	31.000 EACH	_____.	_____.
1470	647.0176 Pavement Marking Arrows Epoxy Type 3	1.000 EACH	_____.	_____.
1480	647.0356 Pavement Marking Words Epoxy	28.000 EACH	_____.	_____.
1490	647.0456 Pavement Marking Curb Epoxy	398.000 LF	_____.	_____.
1500	647.0566 Pavement Marking Stop Line Epoxy 18-Inch	574.000 LF	_____.	_____.
1510	647.0606 Pavement Marking Island Nose Epoxy	15.000 EACH	_____.	_____.
1520	647.0726 Pavement Marking Diagonal Epoxy 12-Inch	1,452.000 LF	_____.	_____.
1530	647.0856 Pavement Marking Concrete Corrugated Median Epoxy	328.000 SF	_____.	_____.
1540	649.0400 Temporary Pavement Marking Removable Tape 4-Inch	45,313.000 LF	_____.	_____.



Proposal Schedule of Items

Proposal ID: 20170613006 Project(s): 1030-11-71

Federal ID(s): N/A

SECTION: 0001

Contract Items

Alt Set ID:

Alt Mbr ID:

Proposal Line Number	Item ID Description	Approximate Quantity and Units	Unit Price	Bid Amount
2140	SPV.0060 Special 102. Lamp Disposal High Intensity Discharge	8.000 EACH	_____.	_____.
2150	SPV.0060 Special 500. Adjusting Water Valves	19.000 EACH	_____.	_____.
2160	SPV.0060 Special 502. Remove And Reinstall Mailboxes	13.000 EACH	_____.	_____.
2170	SPV.0075 Special 009. Pavement Cleanup	100.000 HRS	_____.	_____.
2180	SPV.0090 Special 101. Removing Electrical Wire From Conduit	2,520.000 LF	_____.	_____.
2190	SPV.0090 Special 300. Fiber Optic Tracer Wire	936.000 LF	_____.	_____.
2200	SPV.0105 Special 002. Survey Project 1030-11-71	LS	LUMP SUM	_____.
2210	SPV.0105 Special 003. Concrete Pavement Joint Layout	LS	LUMP SUM	_____.
2220	SPV.0105 Special 101. Maintenance of Lighting System	LS	LUMP SUM	_____.
2230	SPV.0105 Special 102. Freeway Lighting Integrator Id 1030-11-71	LS	LUMP SUM	_____.
2240	SPV.0105 Special 103. Lighting System Survey	LS	LUMP SUM	_____.
2250	SPV.0105 Special 104. Temporary Mailboxes	LS	LUMP SUM	_____.
2260	SPV.0105 Special 300. Install State Furnished Traffic Signal Cabinet CTH K & East Frontage Rd	LS	LUMP SUM	_____.
2270	SPV.0105 Special 301. Transport Traffic Signal & Intersection Lighting Materials CTH K & East Frontage Rd	LS	LUMP SUM	_____.