



Wisconsin Department of Transportation

Division of Transportation Systems Development

Bureau of Project Development
4802 Sheboygan Avenue, Rm 601
P O Box 7916
Madison, WI 53707-7916

March 7, 2018

Telephone: (608) 266-1631
Facsimile (FAX): (608) 266-8459

NOTICE TO ALL CONTRACTORS:

Proposal #40: 8110-02-73
Stillwater – Somerset
Loop Trail System (Ped/Bike Facility)
STH 64
St. Croix County

Letting of March 13, 2018

This is Addendum No. 01, which provides for the following:

Special Provisions:

Revised Special Provisions	
Article No.	Description
8	Utilities
30	Interpretive Panel Support Posts and Bases, Item SPV.0060.01
31	Interpretive Panel Support Post, Delivered, Item SPV.0060.02

Added Special Provisions	
Article No.	Description
57	Concrete Base Type 1 Modified, Item SPV.0060.12

Schedule of Items:

Revised Bid Item Quantities					
Bid Item	Item Description	Unit	Old Quantity	Revised Quantity	Proposal Total
602.0405	Concrete Sidewalk 4-Inch	SF	4,543	46.50	4,589.50
608.0318	Storm Sewer Pipe Reinforced Concrete Class III 18-Inch	LF	399	-71	328
608.0324	Storm Sewer Pipe Reinforced Concrete Class III 24-Inch	LF	71	35	106
611.3004	Inlets 4-FT Diameter	EA	9	-2	7
611.3253	Inlets 2.5x3-FT	EA	1	1	2
634.0811	Posts Tubular Steel 2x2-Inch, 11-ft	EA	34	-1	33
637.2210	Signs Type II Reflective H	SF	408.79	-5.00	403.79
637.2230	Signs Type II Reflective F	SF	188.38	5.00	193.88
638.2602	Removing Signs Type II	EA	37	-1	36

638.3000	Removing Small Sign Supports	EA	38	-1	37
SPV.0165.01	Special 01. Anti-Graffiti Coating, SPV.0165.01	SF	8,664	-3,869	4,795

Added Bid Item Quantities					
Bid Item	Item Description	Unit	Old Quantity	Revised Quantity	Proposal Total
SPV.0060.12	Special 12. Concrete Base Type 1 Modified	EA	0	2	2

Plan Sheets:

Revised Plan Sheets	
Plan Sheet	Plan Sheet Title (brief description of changes to sheet)
4	Existing Typical Sections – Main St (Added existing pavement depths)
5	Existing Typical Sections – State St, Rainbow St, CTH E (Added existing pavement depths)
6	Existing Typical Sections – Hilltop Dr., School Circle, Old 64 (Added existing pavement depths)
23	Finished Typical Sections-Trailhead Side Paths (Revised Hawk Street Sidewalk Section)
38	Construction Details (Deleted the Interpretive Panel construction detail from plan sheet)
80	Plan and Cross Section: Welcome to Wisconsin Sign (added in language for concrete bases for future lighting)
130	Permanent Signing: Main Street (Revised sign locations)
131	Permanent Signing: Main Street (Revised sign locations)
132	Permanent Signing: Main Street (Revised sign locations)
133	Permanent Signing: Main Street (Revised sign locations)
210	Miscellaneous Quantities (Revised Concrete Sidewalk 4-Inch)
211	Miscellaneous Quantities (Revised Storm Sewer Pipe Reinforced Concrete Class III 18-Inch table and Storm Sewer Pipe Reinforced Concrete Class III 24-Inch)
212	Miscellaneous Quantities (Revised Inlets 2.5x3 and Inlets 4-ft Diameter)
221	Miscellaneous Quantities (Revised Signing Table)
222	Miscellaneous Quantities (Revised Signing Quantities)
225	Miscellaneous Quantities (Revised Signing Quantities)
234	Miscellaneous Quantities (Added Concrete Base Type 1 Modified)
235	Miscellaneous Quantities (Revised Anti-Graffiti Coating)
357	State Welcome Sign Structure Sta 155+50 STH 64 EB (added language for concrete bases)
415	Earthwork (Added in table for Hawk Street Sidewalk)

Added Plan Sheets	
Plan Sheet	Plan Sheet Title (brief description of why sheet was added)
38A	Construction Detail (Added in revised Interpretive Post and Base detail)
582A-582F	Cross Sections: Hawk Street North Sidewalk

The responsibility for notifying potential subcontractors and suppliers of these changes remains with the prime contractor.

Sincerely,

Mike Coleman

Proposal Development Specialist
Proposal Management Section

ADDENDUM NO. 01

8110-02-73

March 7, 2018

Special Provisions

8. Utilities.

*Replace entire section titled **St. Croix Electric Cooperative** with the following:*

St Croix Electric Cooperative (ELCTY) has an underground electric crossing at STH 242+10.

No conflict anticipated.

30. Interpretive Panel Support Posts and Bases, Item SPV.0060.01.

Replace entire article language with the following:

A Description

This special provision describes the furnishing of all labor, equipment and materials to fabricate, construct and install the Interpretive Panel Bases and Posts in accordance with the applicable WisDOT Standard Specifications, the Plan details, and the following. The graphic interpretive panel signs will be installed by others.

B Materials

Furnish materials that are in accordance to section 654 of the standard specifications. WisDOT is not providing the artwork or interpretive panels. Do not store interpretive panel posts, support system, backer panel, or anchorage on site.

B.1 Shop Drawing and Sample Submittals

Submittals and shop drawings shall comply with WisDOT Standard Specification Section 105 signed by a professional engineer in the State of Wisconsin and the following:

B.2 Interpretive Panel surface-mounted Support System

Support system is an upright surface-mounted design with a single post. Submit signed and stamped engineering drawings for interpretive panel concrete base & anchorages, surface plate mounting hardware, post, backer panel and interpretive panel mounting hardware.

B.3 Quality Assurance

The producer shall pre-assemble support system assemblies in the shop to the greatest extent possible to minimize field assembly. Disassemble units only as necessary for shipping and handling limitations. Clearly mark units for re-assembly and coordinated installation. Take care not to damage the paint or finish on the bracket assemblies. If any part of the paint/coating on the posts, mounting plates or backer panel is damaged during shipment, storage or installation, fully repair the finish.

B.4 Products

All materials for this work shall be new stock, free from defects impairing strength, durability, and appearance.

B.5 Interpretive Panel Support

Furnish and install upright single non-rusting metal 3" x 3" single surface-mounted self-supporting post system according to the approved detail. The non-rusting metal frameless backer panel for

holding the sign shall be oriented at 30 degrees from horizontal and have a thickness designed to hold the interpretive panel per St. Croix County's interpretive panel manufacturer. Provide correct mounting assemblies between the post, backer panel and the interpretive panels; coordinate with St. Croix County's interpretive panel manufacturer. Provide pre-drilled holes in the backer panel for ease of interpretive panel mounting; holes to be coordinated with St. Croix County and the engineer. Provide mounting hardware for connecting the interpretive panel to the backer panel. The interpretive panel will be mounted with a blind mount.

B.6.a Concrete Base

Construct cast-in-place concrete base in accordance with WisDOT Standard Specifications Sections 501, 636 and 654 and as the plans show. The concrete base shall be installed prior to installing any surrounding sidewalk or concrete sidewalk pads.

B.6.b Base Surface Plate Mounting Hardware

Provide stainless steel mounting hardware unless recommended otherwise by the manufacturer. Mounting hardware will be designed to be removable and replaceable multiple times without damage to the concrete base. Post and mounting plate must be removable for maintenance purposes. Use the types and sizes of hardware indicated by the Manufacturer's specifications and as needed for a complete and secure installation. Mounting system shall be secure without gaps unless otherwise specified in the plans and specification.

B.6.c Concrete Sidewalk Pad

Cast-in-place 4-inches deep of concrete sidewalk pads or 7-inches deep of concrete sidewalk in accordance with WisDOT Standard Specification 602.

C Construction

The concrete base and surrounding concrete sidewalk pad will be field-located by the engineer. Contractor must anticipate minor adjustment in the interpretive panel location in the field. Location must be suitable for viewing of interpretive sign from the trail and located so that the support bracket provides sufficient height for viewing, based on applicable standards.

C.1 Installation

The concrete base shall be installed prior to installing sidewalk concrete pad or surrounding concrete sidewalk.

Protect work area from soil erosion and runoff per erosion control plan sheets.

Install surface-mounted support system post in accordance with manufacturer's specifications.

Remove any loose rock and/or solid rock to provide a minimum of 48" below existing grade.

Maximum depth of base shall not exceed 5'0" below grade.

Install surface-mounted support system post plumb and centered on concrete base.

Deliver interpretive panel surface-mounted support system components to the site undamaged and ready for immediate installation. Do not store support system on site.

Grade around concrete base and concrete sidewalk pad to ensure drainage away from interpretive panel support system.

Touch-up paint all finishes damaged during installation to the satisfaction of the engineer.

Clean surface-mounted support system after installation is complete.

D Measurement

The department will measure Interpretive Panel Support Posts and Bases by EACH full set interpretive panel base and post completely and satisfactorily installed.

E Payment

The department will pay for measured quantities at the contract unit price under the following bid item:

ITEM NUMBER	DESCRIPTION	UNIT
SPV.0060.01	Interpretive Panel Support Posts and Bases	EACH

Payment will be in full for all costs involved for the concrete base & anchorages, surface-mounted support system, base surface plate and mounting hardware, backer panel, interpretive panel mounting hardware, including all labor and materials, fabrication, submittals, compaction, installation, disposal of all excess material and soil decompaction/seeding repair in the area of the installation. Payment for concrete pad will be under individual sidewalk bid items.

31. Interpretive Panel Support Post, Delivered, Item SPV.0060.02.

Replace entire article language with the following:

A Description

This work shall consist of delivering interpretive panel surface-mounted support system elements (including surface plate mounting hardware and anchorages, panel post, backer panel, and interpretive mounting plates) to St. Croix County for future installation.

B Materials

Provide materials for required items in accordance with special provision Interpretive Panel Support Posts and Bases.

C Construction

Deliver the required surface-mounted support system elements to the St Croix County Government Center, 1101 Carmichael Road, Hudson, Wisconsin 54016. Contact Ellen Denzer, Director of Community Development, at (715) 386-4673 to provide 7 days advanced notice of delivery.

Touch-up paint all finishes damaged during transport and delivery.

D Measurement

The department will measure Interpretive Panel Support Post, Delivered as EACH for all required surface-mounted support system elements to be delivered and acceptably completed.

E Payment

The department will pay for the measured quantity at the contract unit price under the following bid item:

ITEM NUMBER	DESCRIPTION	UNIT
SPV.0060.02	Interpretive Panel Support Post, Delivered	EACH

Payment is full compensation for providing interpretive panel surface-mounted support system elements and delivering to St. Croix County, and any paint touch-up or repair of the posts, acceptably completed.

57. Concrete Base Type 1 Modified, Item SPV.0060.12.

A Description

This special provision describes installation of a Concrete Base Type 1 Modified at the proposed Welcome to Wisconsin Sign site for future lighting installation (lighting by others).

B Materials

Furnish materials that are in accordance to section 654 of the standard specifications.

C Construction

Construct concrete base type 1 modified in accordance with Standard Specification 654, and in accordance with Standard Detail Drawing "Concrete Bases Types 1, 2, 5, & 6", with the exception of:

1) Do not install anchor rods.

2) Install the vertical conduit non-centered within the base. Place conduit with approximately 2-inches clear from edge of base to edge of conduit

3) 6" Conduit stub shall be placed in a direction to accept future electrical service. Contact WisDOT Electrical prior to concrete installation at (715) 839-3787 for location and direction of 6" conduit stub.

D Measurement

The department will measure Concrete Base Type 1 Modified by EACH concrete base completely and satisfactorily constructed.

E Payment

The department will pay for measured quantities at the contract unit price under the following bid item:

ITEM NUMBER	DESCRIPTION	UNIT
SPV.0060.12	Concrete Base Type 1 Modified	EACH

Payment for the Concrete Base Type 1 Modified is full compensation for providing concrete bases; for embedded conduit and electrical components; and for excavating, backfilling, and disposing of surplus materials.

Schedule of Items

Attached, dated March 7, 2018, are the revised Schedule of Items Pages 6, 7, 11, 12, 16 and 17.

Plan Sheets

The following 8½ x 11-inch sheets are attached and made part of the plans for this proposal:

Revised: 4-6, 23, 38, 80, 130-133, 210-212, 221-222, 225, 234-235, 357, and 415.

Added: 38A, and 582A-F.

END OF ADDENDUM

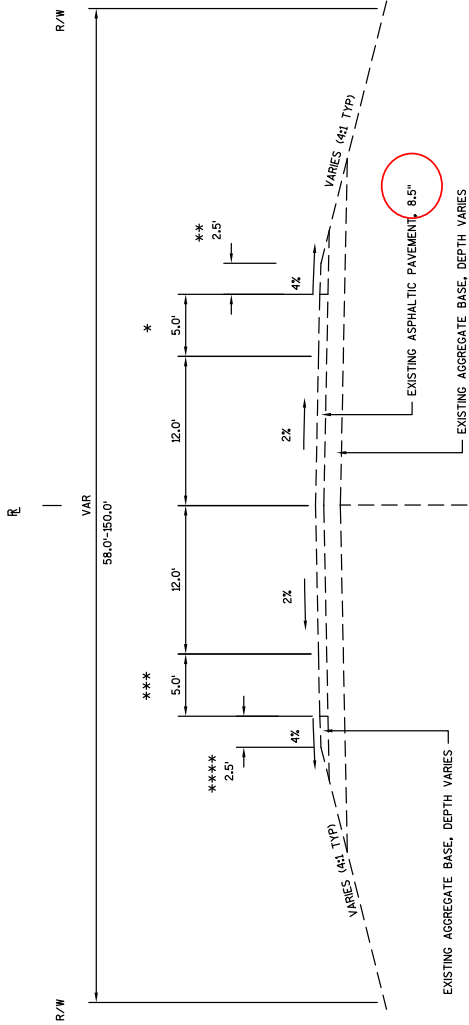

- * RIGHT PAVED SHOULDER VARIES FROM 5.0'-12.0' FROM STA 2012+25 TO STA 2014+75.
- ** RIGHT GRAVEL SHOULDER VARIES FROM 0.5' TO 2.5' FROM STA 202+25 TO STA 204+75.
- *** LEFT PAVED SHOULDER VARIES FROM 12.0'-5.0' FROM STA 2013+75 TO STA 2018+50.
- **** LEFT GRAVEL SHOULDER VARIES FROM 0.5'-2.5' FROM STA 2013+75 TO STA 2018+50.
- ***** LEFT GRAVEL SHOULDER IS 7.5' FROM STA 2026+50 TO STA 2029+00.

EXISTING ASPHALTIC PAVEMENT THICKNESSES BASED ON AS-BUILT INFORMATION.

**EXISTING TYPICAL SECTION
MAIN STREET (OLD STH 35)
STA 2004+01.34 - STA 2007+25.76**

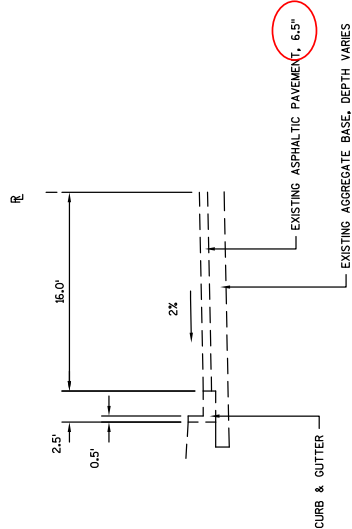

**MAIN STREET (OLD STH 35)
STA 2007+25.76 - STA 2029+00.00**

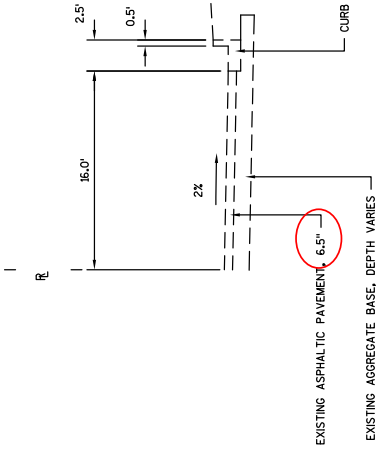

**MAIN STREET (OLD STH 35)
STA 2007+25.76 - STA 2029+00.00**

Addendum No. 01
ID 8110-02-73
Revised Sheet 4
March 7, 2018

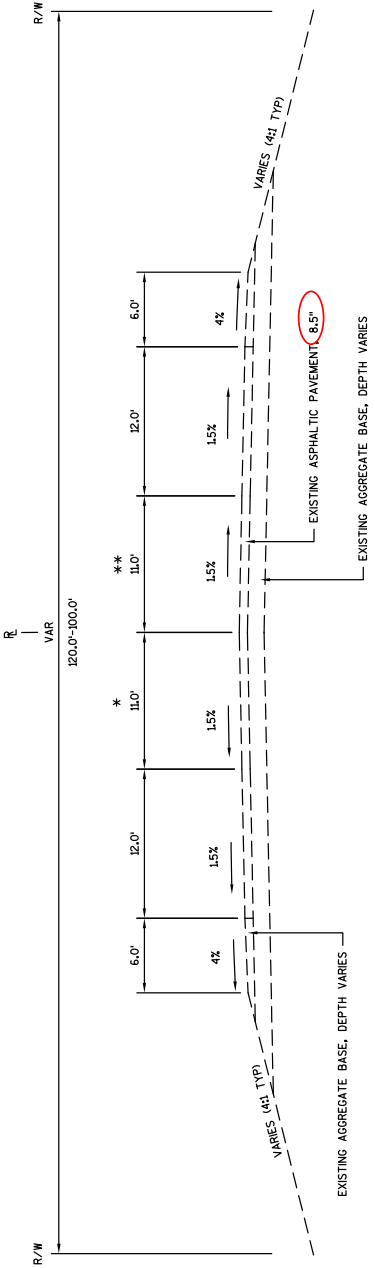

**EXISTING TYPICAL SECTION
 MAIN STREET (OLD STH 35/64)**

STA 2029+00.00 - STA 2045+00.00

- * LANE WIDTH VARIES FROM 10.0'-0.0' FROM STA 2044+00 TO STA 2045+15.
 - ** LANE WIDTH VARIES FROM 10.0'-0.0' FROM STA 2045+15 TO STA 2046+50.
- EXISTING ASPHALTIC PAVEMENT THICKNESSES BASED ON AS-BUILT INFORMATION.

Addendum No. 01
 ID 8110-02-73
 Revised Sheet 5
 March 7, 2018

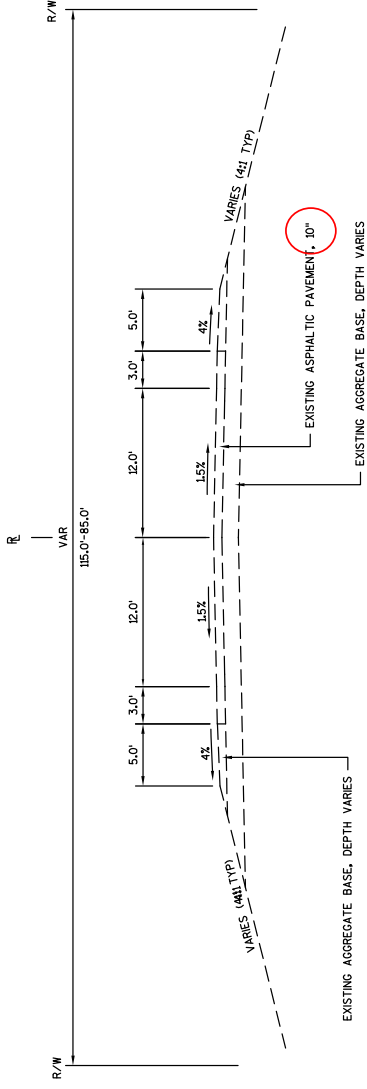

**EXISTING TYPICAL SECTION
 MAIN STREET (OLD STH 35/64)**

STA 2045+00.00 - STA 2078+42.17

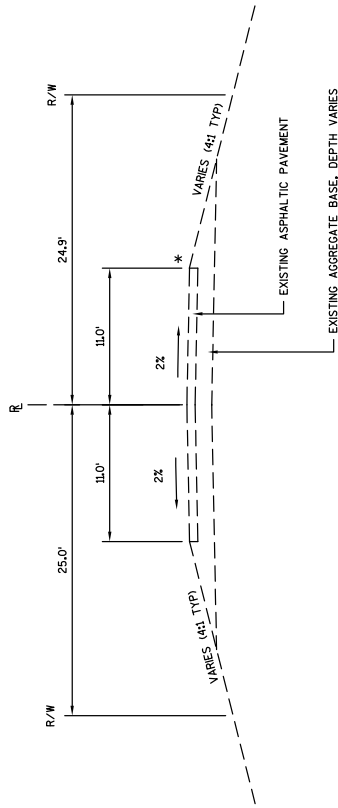

**EXISTING TYPICAL SECTION
STATE STREET
STA 00+77.12 - STA 05+42.35**

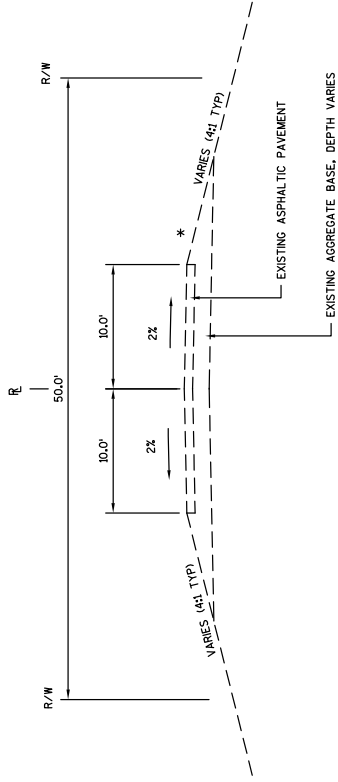

**EXISTING TYPICAL SECTION
RAINBOW STREET
STA 00+71.34 - STA 01+61.34**

NOTE:
EXISTING ASPHALTIC PAVEMENT THICKNESSES BASED ON
AS-BUILT INFORMATION.

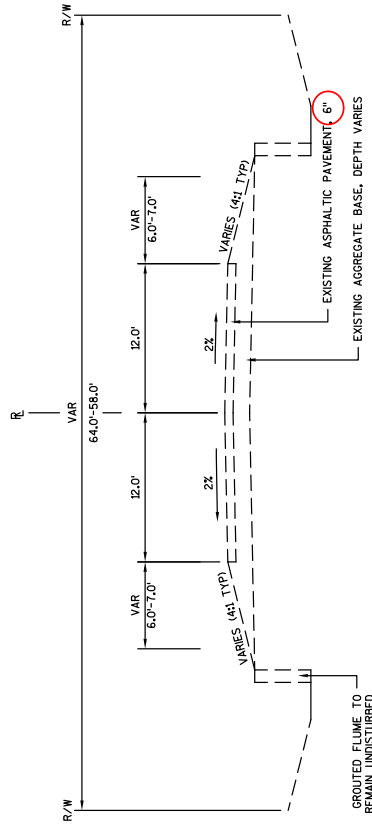

**EXISTING TYPICAL SECTION
CTH E
STA 1100+00.00 - STA 1107+92.67**

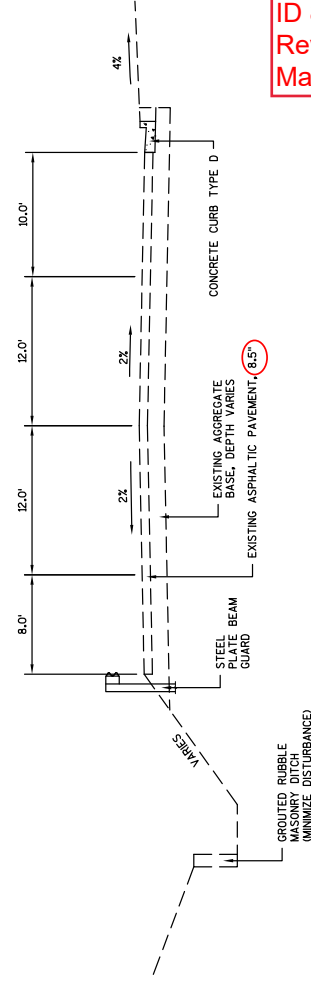

**EXISTING TYPICAL SECTION
OLD 64
STA 1062+00 - STA 1082+52.81**

Addendum No. 01
ID 8110-02-73
Revised Sheet 6
March 7, 2018

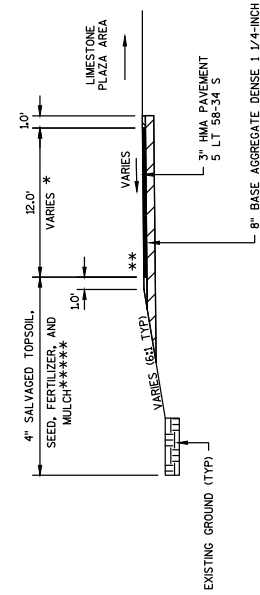

FINISHED TYPICAL SECTION

HILLTOP TRAILHEAD SIDE TRAIL (EAST)

STA 00+18.76 - STA 00+92.13

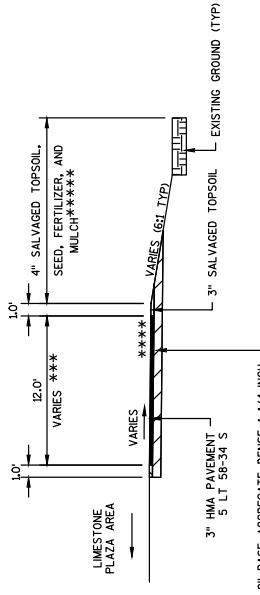

FINISHED TYPICAL SECTION

HILLTOP TRAILHEAD SIDE TRAIL (WEST)

STA 00+18.76 - STA 00+92.13

- * CONCRETE PLAZA AREA NO SHOULDER STA 00+28.86 - 00+70.32
- ** PAVEMENT BUMPOUT STA 00+46.18 - 00+66.96
- *** CONCRETE PLAZA AREA NO SHOULDER STA 00+27.93 - 00+69.61
- **** PAVEMENT BUMPOUT STA 00+71.11 - 00+99.84
- ***** 2" SALVAGED TOPSOIL OVER 6:1 SLOPES, 4" SALVAGED TOPSOIL ELSEWHERE

Addendum No. 01
ID 8110-02-73
Revised Sheet 23
March 7, 2018

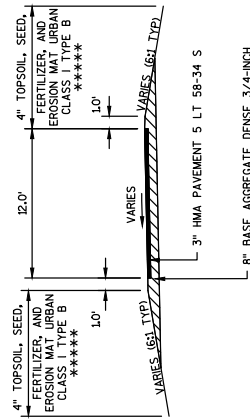

FINISHED TYPICAL SECTION

MAIN TRAILHEAD SIDE TRAIL (N/S)

STA 00+00 - STA 1+36.12

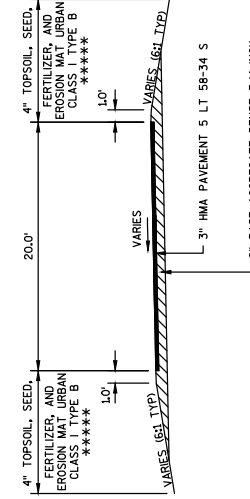

FINISHED TYPICAL SECTION

MAIN TRAILHEAD SIDE TRAIL (N/S)

STA 1+99.60 - STA 2+88.10

MAIN TRAILHEAD SIDE TRAIL (E/W)

STA 00+08.04 - STA 1+28.59

- * 2" SALVAGED TOPSOIL OVER 6:1 SLOPES, 4" SALVAGED TOPSOIL ELSEWHERE

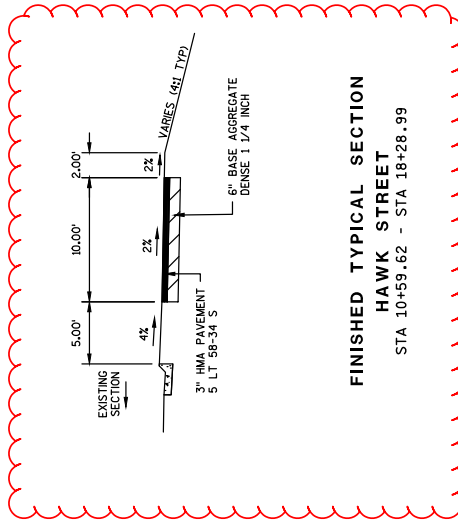

FINISHED TYPICAL SECTION

HAWK STREET

STA 10+59.62 - STA 18+28.99

- * 2" SALVAGED TOPSOIL OVER 6:1 SLOPES, 4" SALVAGED TOPSOIL ELSEWHERE

REMOVE GROUDED RIP RAP AND ROCK ONLY AS REQUIRED, AS DIRECTED BY THE ENGINEER, TO INSTALL NEW STORM SEWER OUTLET. DO NOT INSTALL APRON ENDWALL. UPON INSTALLATION OF STORM SEWER, REPLACE RIP RAP IN A PATTERN TO FILL VOIDS, GROUT AROUND THE STORM SEWER PIPE END TO SEAL DITCH.

SALVAGE RIP RAP FROM NEW INSTALLATION AREAS FOR USE IN RESTORING THE AREAS OF STORM SEWER REMOVAL.

IN AREAS OF STORM SEWER REMOVAL, INSTALL NEW OR SALVAGED RIP RAP OF SIMILAR SIZE TO EXISTING SURROUNDING ROCKS. GROUT NEW RIP RAP AT STORM SEWER REMOVAL LOCATIONS TO SEAL DITCH.

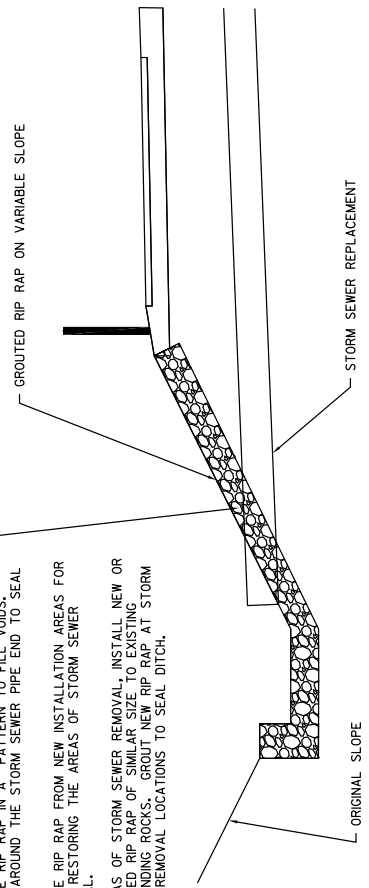

GROUTED RIP RAP RESTORATION

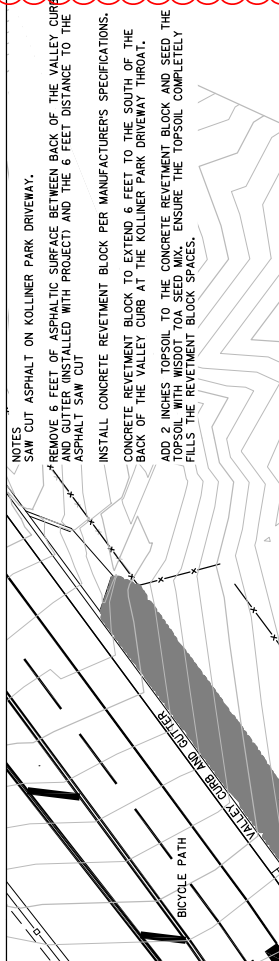

NOTES
 SAW CUT ASPHALT ON KOLLINER PARK DRIVEWAY.
 REMOVE 6 FEET OF ASPHALTIC SURFACE BETWEEN BACK OF THE VALLEY CURB AND 6 FEET DISTANCE TO THE ASPHALT SAW CUT.
 INSTALL CONCRETE REVETMENT BLOCK PER MANUFACTURER'S SPECIFICATIONS.
 CONCRETE REVETMENT BLOCK TO EXTEND 6 FEET TO THE SOUTH OF THE BACK OF THE VALLEY CURB AT THE KOLLINER PARK DRIVEWAY THROAT.
 ADD 2 INCHES TOPSOIL TO THE CONCRETE REVETMENT BLOCK AND SEED THE AREAS WITH GRASS SEED. ENSURE THE TOPSOIL COMPLETELY FILLS THE REVETMENT BLOCK SPACES.

STATION	OFFSET	NORTHING	EASTING
1058+18.23	2.4650	372734.5610	500558.6051
1058+24.46	6.5000	372744.5593	500558.5952
1058+46.159	2.5000	372760.4564	500593.5753
1058+62.14	8.7560	372755.6351	500597.6533
1058+62.30	8.4540	372756.0350	500597.6100
1058+64.82	6.9730	372756.7200	500598.7520

6-INCH FABRIC FORMED ARTICULATED CONCRETE REVETMENT MAT

6-INCH FABRIC FORMED ARTICULATED CONCRETE REVETMENT MAT

30" CURB & GUTTER

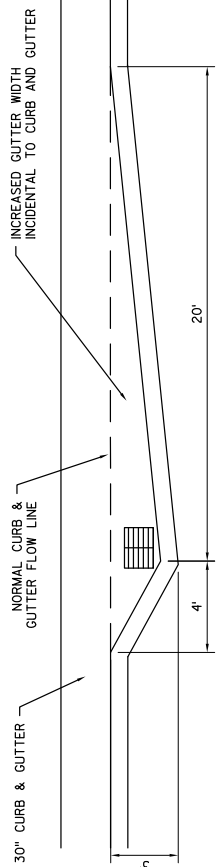

PLAN VIEW

ADDITIONAL GUTTER

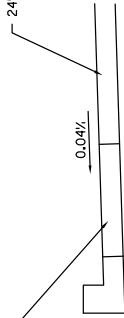

PROFILE VIEW

OFFSET INLET DETAIL

Addendum No. 01
 ID 8110-02-73
 Revised Sheet 38
 March 7, 2018

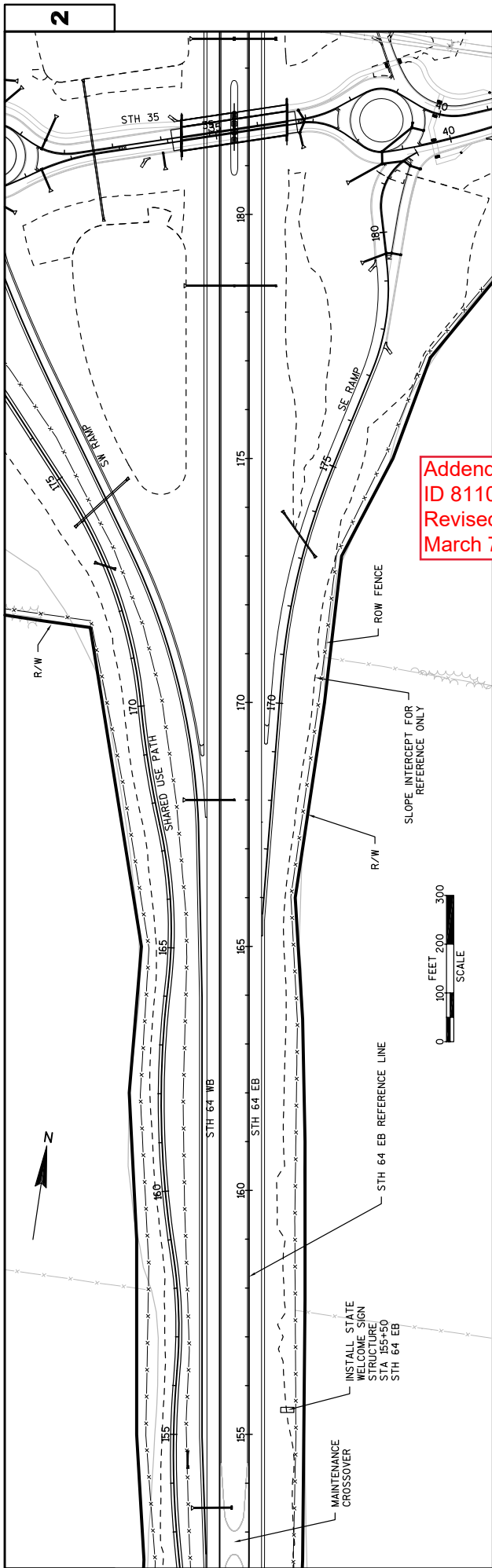

**Addendum No. 01
ID 8110-02-73
Revised Sheet 80
March 7, 2018**

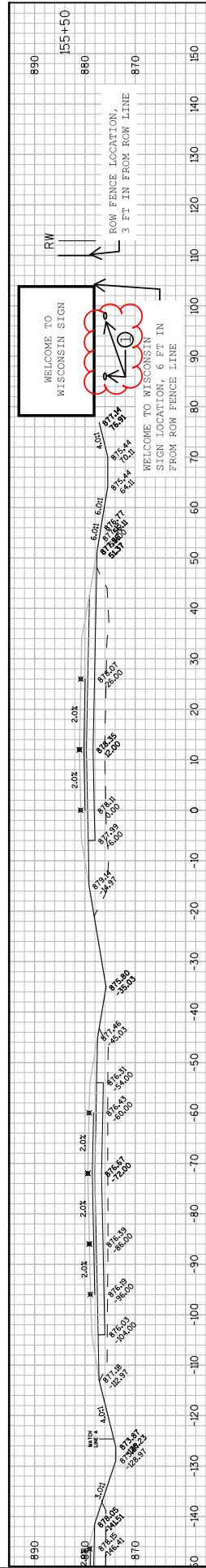

NOTES:
1. INSTALL CONCRETE BASES TYPE 1 MODIFIED FOR LIGHTING (LIGHTING PROVIDED BY OTHERS).

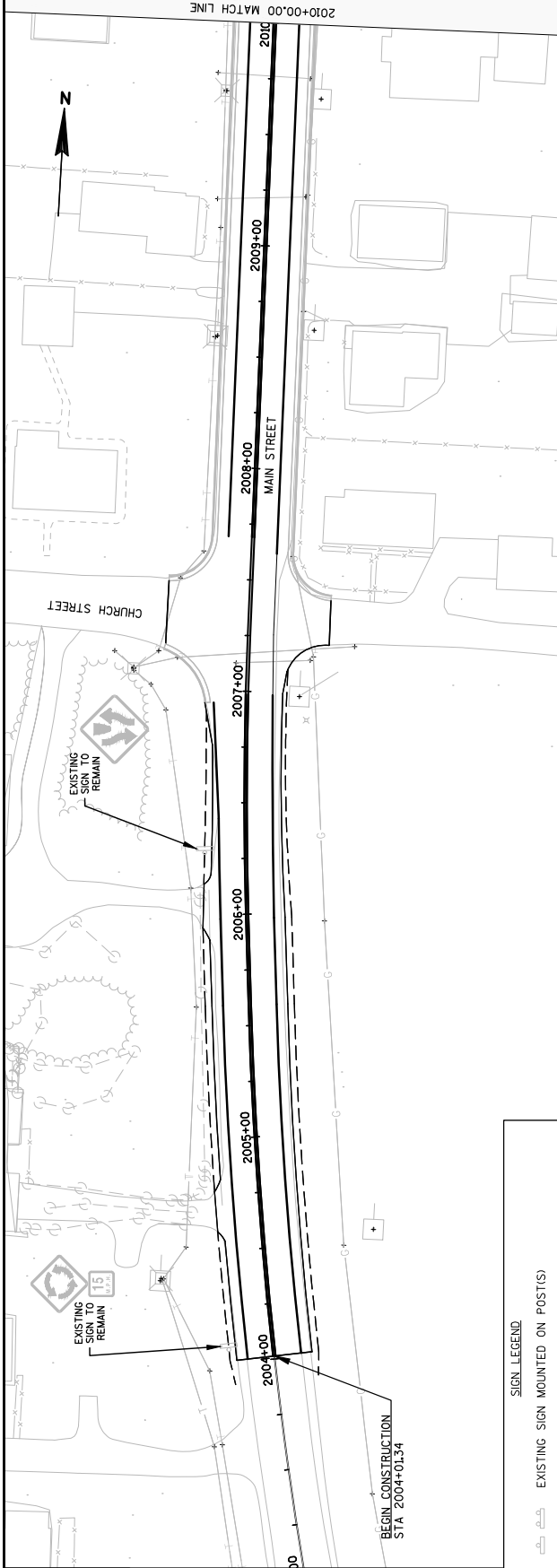

SIGN LEGEND

- EXISTING SIGN MOUNTED ON POST(S)
- PROPOSED SIGN MOUNTED ON 2X2-INCH TUBULAR POST(S)
- 'X' DENOTES SIGN SHEET NO.; 'Y' DENOTES SIGN NO.

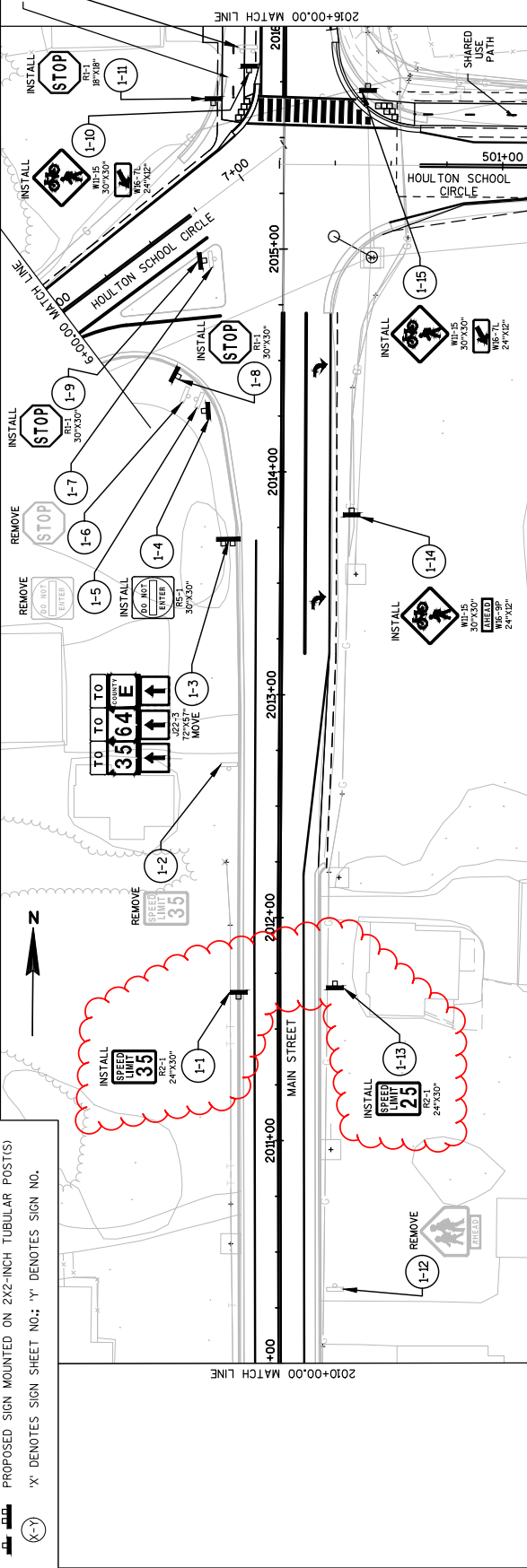

Addendum No. 01
 ID 8110-02-73
 Revised Sheet 130
 March 7, 2018

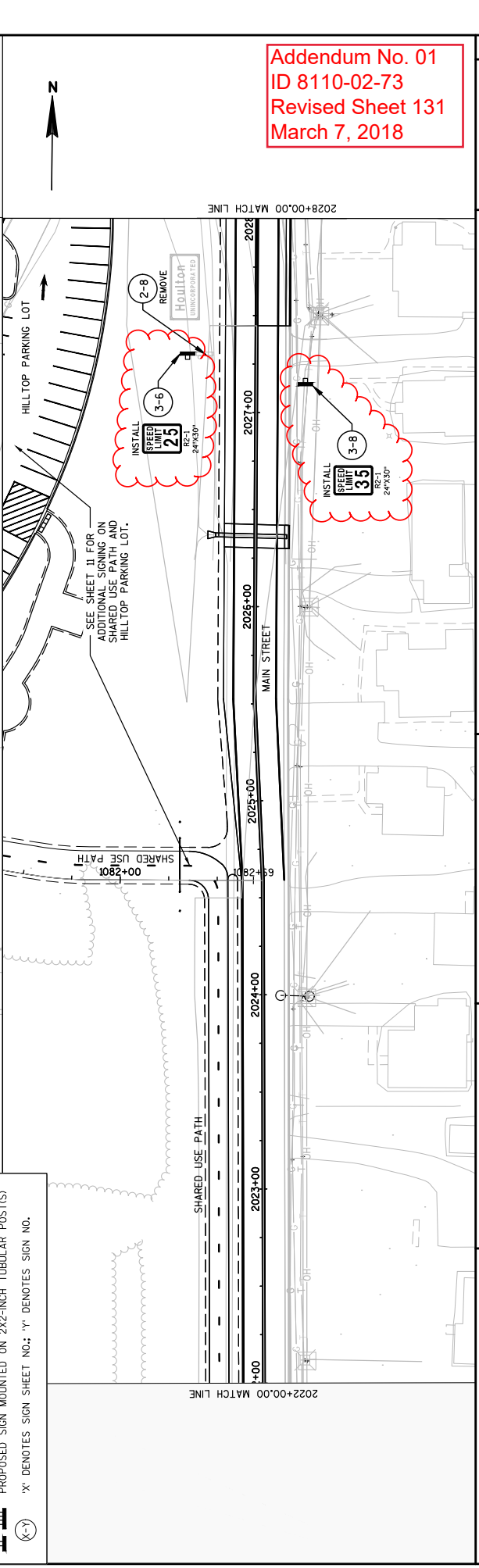
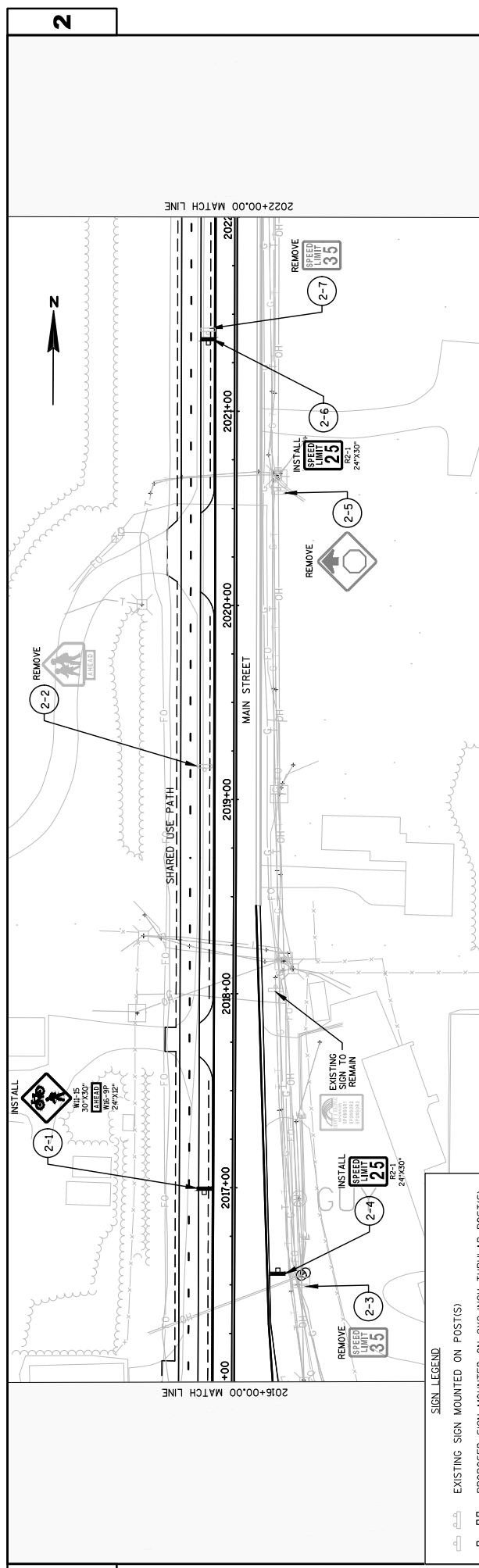

Addendum No. 01
 ID 8110-02-73
 Revised Sheet 131
 March 7, 2018

SIGN LEGEND
 [Symbol] EXISTING SIGN MOUNTED ON POST(S)
 [Symbol] PROPOSED SIGN MOUNTED ON 2X2-INCH TUBULAR POST(S)
 'X' DENOTES SIGN SHEET NO.; 'Y' DENOTES SIGN NO.

PROJECT NO: 8110-02-73	HWY: STH 64	COUNTY: ST. CROIX	PERMANENT SIGNING: MAIN STREET	SHEET 131REV
FILE NAME : N:\VPOS\CSD\81100201\SHEETS\PLAN\8110-02-73\023201-PS.MAIN STREET.DWG		PLOT DATE : 3/5/2018 2:39 PM		PLOT SCALE : 1 IN=50 FT
LAYOUT NAME - MAIN ST 2		PLOT BY : MANDEN, ALLISSA L		WSDOT/CADD SHEET 42

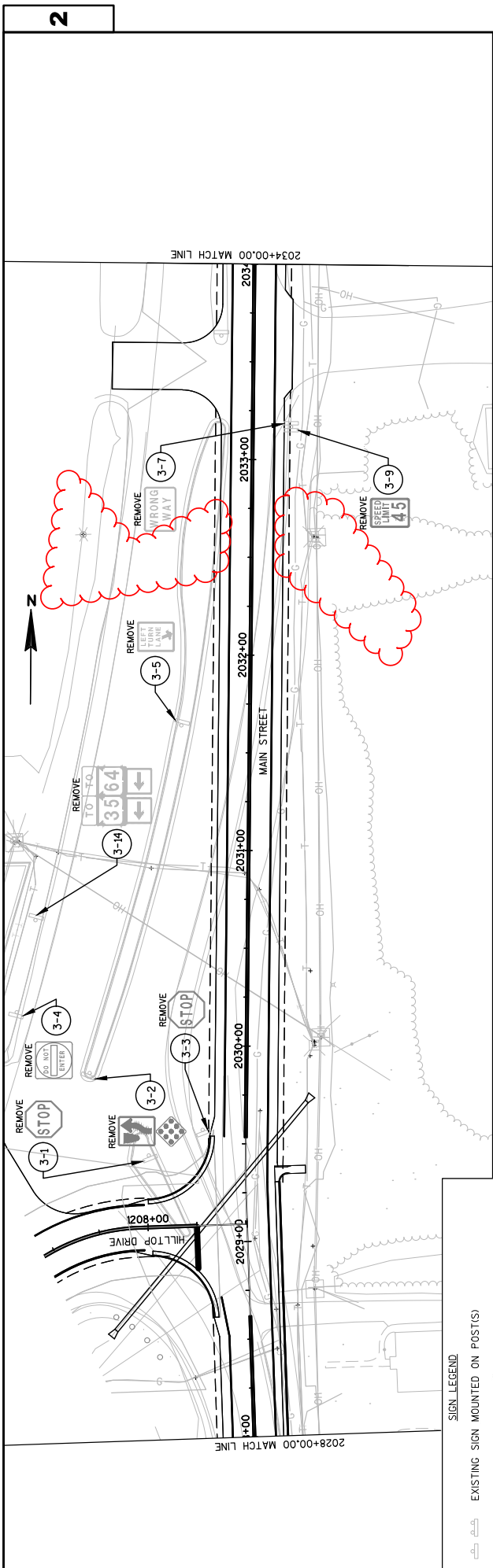

2034+00.00 MATCH LINE

2028+00.00 MATCH LINE

SIGN LEGEND

- EXISTING SIGN MOUNTED ON POST(S)
- PROPOSED SIGN MOUNTED ON 2X2-INCH TUBULAR POST(S)
- 'X' DENOTES SIGN SHEET NO.; 'Y' DENOTES SIGN NO.

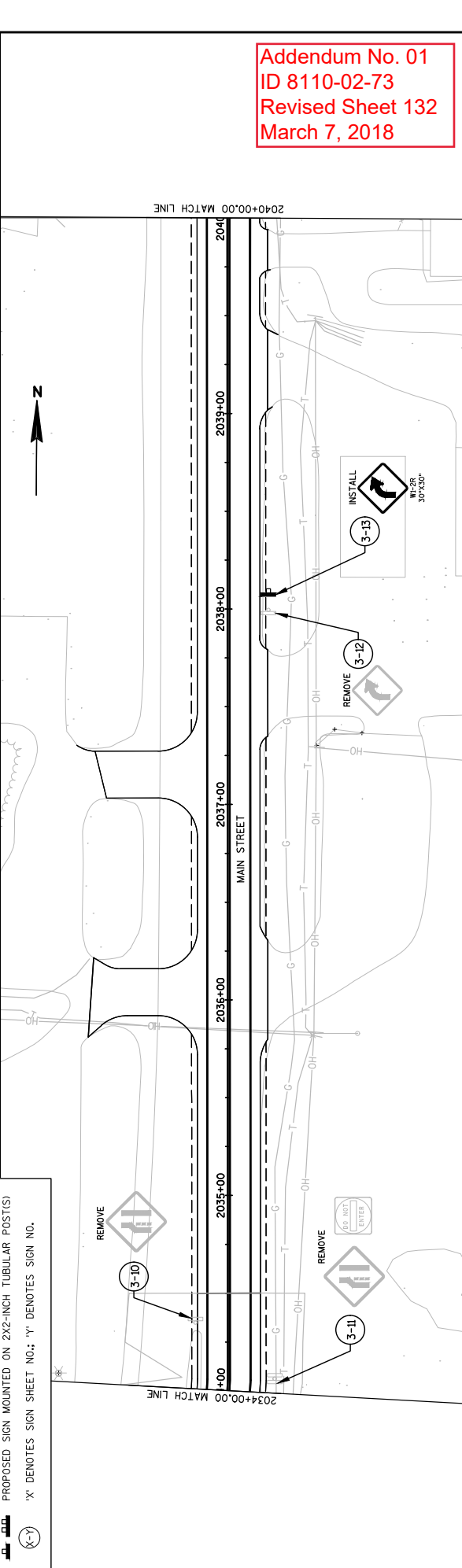

2040+00.00 MATCH LINE

Addendum No. 01
 ID 8110-02-73
 Revised Sheet 132
 March 7, 2018

Addendum No. 01
ID 8110-02-73
Revised Sheet 133
March 7, 2018

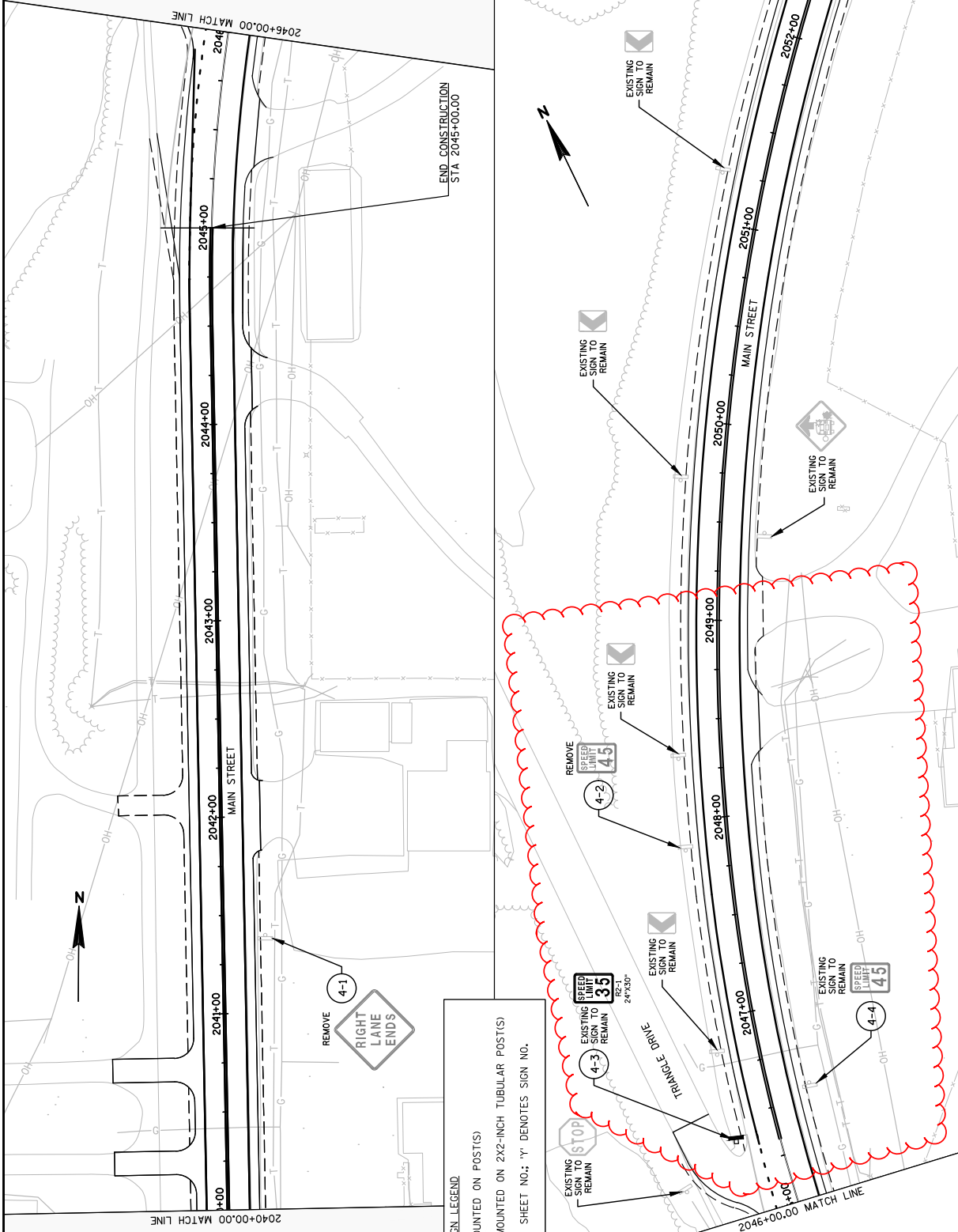

SIGN LEGEND

- EXISTING SIGN MOUNTED ON POST(S)
- PROPOSED SIGN MOUNTED ON 242-INCH TUBULAR POST(S)
- 'X' DENOTES SIGN SHEET NO.; 'Y' DENOTES SIGN NO.

CONCRETE CURB & GUTTER 6-INCH SLOPED 36-INCH TYPE D

CATEGORY	STATION TO	STATION	LOCATION	601.0557 LF	REMARKS
0010	50+00 -	53+00	PARK AND RIDE	162	
			TOTAL 0010	162	
0020			HILLTOP PARKING	55	
			TOTAL 0020	55	

CONCRETE CURB PEDESTRIAN

CATEGORY	STATION TO	STATION	LOCATION	601.0600 LF	REMARKS
0010	2015+60 -	2015+75	MAIN ST	15	
0010	2015+50 -	2015+65	MAIN ST	25	
0010	513+50 -	513+60	HOULTON SCHOOL CIRCLE	10	
0010			HAWK STREET	30	
			TOTAL 0010	80	
0020			HILLTOP PARKING	25	
0020			MAIN TRAILHEAD	20	
			TOTAL 0020	45	

CONCRETE SIDEWALK 4-INCH

CATEGORY	STATION TO	STATION	LOCATION	602.0405 SF	REMARKS
0010	10+00 -	14+30	HAWK STREET SOUTH	1900	
0010	50+00 -	53+00	PARK AND RIDE	2075	
			TOTAL 0010	3975	
0020			MAIN TRAILHEAD	100	
0020			MAIN TRAILHEAD	100	
0020			MAIN TRAILHEAD	100	
0020			MAIN TRAILHEAD	142	
0020	1080+17		RAIN GARDEN HILLTOP TRAILHEAD	27.5	
0020	188+78		RAIN GARDEN MAIN TRAILHEAD	27.5	
0020	180+00		SOUTHEAST OF PED UNDERPASS	27.5	
0020	133+08		OLD STH 64 MULTI-USE PATH	90	
			TOTAL 0020	614.5	

CONCRETE SIDEWALK 6-INCH

CATEGORY	STATION TO	STATION	LOCATION	602.0415 SF	REMARKS
0020			HILLTOP PARKING	288	
0020	165+16 -	165+57	HILLTOP PARKING	150	
0020	156+38 -	156+61	SHARED USE PATH	24	
0020	133+00		SHARED USE PATH	92	
0020			CROSSWALK OLD STH 64 MULTI-USE PATH	400	DARK GREY
0020			CROSSWALK OLD STH 64 MULTI-USE PATH	400	WHITE
			TOTAL 0020	1354	

CONCRETE SIDEWALK 7-INCH

CATEGORY	STATION	LOCATION	602.0420 SF	REMARKS
0020	74	HILLTOP PARKING	74	
0020	663	HILLTOP PARKING	663	
0020	3900	OLD STH 64 MULTI-USE PATH	3900	REST AREAS
0020	1590	MAIN TRAILHEAD	1590	CONCRETE JOINT LAYOUT REQUIRED
0020	200	SHARED USE PATH	200	
0020	85	PLAZA I OLD STH 64 MULTI-USE PATH	85	LIGHT TAN
0020	390	PLAZA I OLD STH 64 MULTI-USE PATH	390	DARK TAN
0020	50	PLAZA II OLD STH 64 MULTI-USE PATH	50	LIGHT TAN
0020	265	PLAZA II OLD STH 64 MULTI-USE PATH	265	DARK TAN
		TOTAL 0020	7217	

Addendum No. 01
ID 8110-02-73
Revised Sheet 210
March 7, 2018

SLOPE PAVING CONCRETE

604.0400

CATEGORY	LOCATION	SY	REMARKS
0010	STH 35 OVERPASS	54	
	TOTAL 0010	54	

RIPRAP LIGHT

606.0100

CATEGORY	STATION	LOCATION	CY	REMARKS
0010	1101+00	CTH E	9	
0010	1101+90	CTH E	9	
0010	1103+90	CTH E	9	
0010	1105+90	CTH E	9	
0010		PARK AND RIDE	15	
	TOTAL 0010		51	

RIPRAP HEAVY

606.0300

CATEGORY	STATION TO	STATION	LOCATION	CY	REMARKS
0010	1101+89 -	1100+82	CTH E	14	
0010	1101+98 -	1102+05	CTH E	14	
0010	1103+96 -	1104+05	CTH E	14	
	TOTAL 0010			43	

STORM SEWER PIPE REINFORCED CONCRETE CLASS III 18-INCH

608.0318

CATEGORY	STATION	LOCATION	LF	REMARKS
0010	2026+36	MAIN STREET	42	
	TOTAL 0010		42	
0020	1063+00	OLD STH 64 MULTI-USE PATH	71	
0020	1066+48	OLD STH 64 MULTI-USE PATH	53	
0020	1069+01	OLD STH 64 MULTI-USE PATH	55	
0020	1072+50	OLD STH 64 MULTI-USE PATH	53	
0020	1076+00	OLD STH 64 MULTI-USE PATH	54	
	TOTAL 0020		286	

STORM SEWER PIPE REINFORCED CONCRETE CLASS III 15-INCH

608.0315

CATEGORY	STATION	LOCATION	LF	REMARKS
0010	2027+45	MAIN STREET	53	
	TOTAL 0010		53	

STORM SEWER PIPE REINFORCED CONCRETE CLASS III 24-INCH

608.0324

CATEGORY	STATION	LOCATION	LF	REMARKS
0020	1064+00	OLD STH 64 MULTI-USE PATH	35	
0020	1078+22	OLD STH 64 MULTI-USE PATH	59	
0020	1078+22	OLD STH 64 MULTI-USE PATH	12	
	TOTAL 0020		106	

STORM SEWER PIPE REINFORCED CONCRETE CLASS IV 12-INCH

608.0412

CATEGORY	LOCATION	LF	REMARKS
0020	HILLTOP PARKING	20	
0020	HILLTOP PARKING	100	
0020	HILLTOP PARKING	106	
	TOTAL 0020	226	

STORM SEWER PIPE REINFORCED CONCRETE CLASS III 30-INCH

608.0330

CATEGORY	STATION	LOCATION	LF	REMARKS
0020	1063+73	OLD STH 64 MULTI-USE PATH	21	
	TOTAL 0020		21	

STORM SEWER PIPE REINFORCED CONCRETE CLASS IV 15-INCH

608.0415

CATEGORY	LOCATION	LF	REMARKS
0020	HILLTOP PARKING	41	
	TOTAL 0020	41	

Addendum No. 01
ID 8110-02-73
Revised Sheet 211
March 7, 2018

MANHOLE COVERS TYPE J

611.0530

CATEGORY	LOCATION	EACH	REMARKS
0020	HILLTOP PARKING	1	
	TOTAL 0020	1	

INLET_COVERS_TYPE_H

CATEGORY	STATION TO	STATION	LOCATION	611.0624 EACH	REMARKS
0010	2026+36		MAIN STREET	1	
0010	2027+45		MAIN STREET	1	
			TOTAL 0010	2	
0020	1066+46		OLD STH 64 MULTI-USE PATH	1	
0020	1063+00 - 1065+49		OLD STH 64 MULTI-USE PATH	2	
0020	1069+01		OLD STH 64 MULTI-USE PATH	1	
0020	1072+50		OLD STH 64 MULTI-USE PATH	1	
0020	1076+00		OLD STH 64 MULTI-USE PATH	1	
0020	1078+22		OLD STH 64 MULTI-USE PATH	1	
			TOTAL 0020	7	

MANHOLES_4-FT_DIAMETER

CATEGORY	LOCATION	611.2004 EACH	REMARKS
0020	HILLTOP PARKING	1	
	TOTAL 0020	1	

INLETS_2-5X3-FI

CATEGORY	STATION	LOCATION	611.3253 EACH	REMARKS
0010	2026+36	MAIN ST	1	
0010	2027+45	MAIN ST	1	
	TOTAL 0010		2	

INLETS_4-FT_DIAMETER

CATEGORY	STATION TO	STATION	LOCATION	611.3004 EACH	REMARKS
0020	1066+46		OLD STH 64 MULTI-USE PATH	1	
0020	1063+00 - 1065+49		OLD STH 64 MULTI-USE PATH	2	
0020	1069+01		OLD STH 64 MULTI-USE PATH	1	
0020	1072+50		OLD STH 64 MULTI-USE PATH	1	
0020	1076+00		OLD STH 64 MULTI-USE PATH	1	
0020	1078+22		OLD STH 64 MULTI-USE PATH	1	
			TOTAL 0020	7	

SALVAGED_RAIL

CATEGORY	STATION	LOCATION	614.0920 LF	REMARKS
0010	1107+50	CTH E	30	
0010	1104+50	CTH E	30	
	TOTAL 0010		60	

INLET_COVERS_TYPE_Z

CATEGORY	LOCATION	611.0666 EACH	REMARKS
0020	HILLTOP PARKING	3	
	TOTAL 0020	3	
	<u>INLETS_3-FT_DIAMETER</u>		
	611.3003		
CATEGORY	LOCATION	EACH	REMARKS
0020	HILLTOP PARKING	3	
	TOTAL 0020	3	

MOBILIZATION

CATEGORY	LOCATION	619.1000 EACH	REMARKS
0010	PROJECT WIDE	0.25	
	TOTAL 0010	0.25	
0020	PROJECT WIDE	0.55	
	TOTAL 0020	0.55	

Addendum No. 01
 ID 8110-02-73
 Revised Sheet 212
 March 7, 2018

Addendum No. 01
 ID 8110-02-73
 Revised Sheet 221
 March 7, 2018

3

PERMANENT SIGNING TYPE II

SIGN #	SIGN CODE	SIGN SIZE W X H N	SIGN TYPE II REFLECTIVE	SIGN TYPE II REFLECTIVE	SIGN TYPE II REFLECTIVE	634.0810			634.0812			634.0814			634.0885			638.2102			638.2602			638.3000			REMARKS
						9.5 FT EACH	10 FT EACH	11 FT EACH	12 FT EACH	14 FT EACH	8.5 FT EACH	MOVING SIGNS TYPE II	MOVING SIGNS TYPE II	MOVING SIGNS TYPE II	REMOVING SIGNS TYPE II	REMOVING SIGNS TYPE II	REMOVING SIGNS TYPE II	SMALL SIGN SUPPORTS EACH	SMALL SIGN SUPPORTS EACH	SMALL SIGN SUPPORTS EACH	ON SAME POST AS	ON SAME POST AS	ON SAME POST AS				
1-1	R2-1	24 X 30	5.00	---	---	---	---	1	---	---	---	---	---	---	---	---	---	---	---	---	---	---	---	---	---	SPEED LIMIT 35 MPH	
1-2	R2-1	24 X 30	5.00	---	---	---	---	---	---	---	---	---	---	---	---	---	---	---	---	---	---	---	---	---	---	SPEED LIMIT 25 MPH	
1-3	J22-3	72 X 57	6.25	---	---	---	---	---	---	---	---	---	---	---	---	---	---	---	---	---	---	---	---	---	---	TRAILBLAZER (ADVANCE TURN)	
1-4	R5-1	30 X 30	6.25	---	---	---	---	---	---	---	---	---	---	---	---	---	---	---	---	---	---	---	---	---	---	DO NOT ENTER	
1-5	R5-1	30 X 30	---	---	---	---	---	---	---	---	---	---	---	---	---	---	---	---	---	---	---	---	---	---	---	DO NOT ENTER	
1-6	R1-1	30 X 30	---	---	---	---	---	---	---	---	---	---	---	---	---	---	---	---	---	---	---	---	---	---	---	STOP SIGN	
1-7	R1-1	30 X 30	---	---	---	---	---	---	---	---	---	---	---	---	---	---	---	---	---	---	---	---	---	---	---	STOP SIGN	
1-8	R1-1	30 X 30	5.18	---	---	---	---	---	---	---	---	---	---	---	---	---	---	---	---	---	---	---	---	---	---	STOP SIGN	
1-9	R1-1	30 X 30	5.18	---	---	---	---	---	---	---	---	---	---	---	---	---	---	---	---	---	---	---	---	---	---	STOP SIGN	
1-10	R1-1	30 X 30	---	---	---	---	---	---	---	---	---	---	---	---	---	---	---	---	---	---	---	---	---	---	---	STOP SIGN	
1-11	S1-1	30 X 30	---	---	---	---	---	---	---	---	---	---	---	---	---	---	---	---	---	---	---	---	---	---	---	SCHOOL ADVANCE	
1-12	R2-1	24 X 30	5.00	---	---	---	---	---	---	---	---	---	---	---	---	---	---	---	---	---	---	---	---	---	---	SPEED LIMIT 25 MPH	
1-13	S1-1	30 X 30	---	---	---	---	---	---	---	---	---	---	---	---	---	---	---	---	---	---	---	---	---	---	---	SCHOOL ADVANCE	
2-2	R2-1	24 X 30	---	---	---	---	---	---	---	---	---	---	---	---	---	---	---	---	---	---	---	---	---	---	---	SPEED LIMIT 35 MPH	
2-3	R2-1	24 X 30	---	---	---	---	---	---	---	---	---	---	---	---	---	---	---	---	---	---	---	---	---	---	---	SPEED LIMIT 35 MPH	
2-4	R2-1	24 X 30	5.00	---	---	---	---	---	---	---	---	---	---	---	---	---	---	---	---	---	---	---	---	---	---	SPEED LIMIT 25 MPH	
2-5	W3-1	36 X 36	---	---	---	---	---	---	---	---	---	---	---	---	---	---	---	---	---	---	---	---	---	---	---	STOP AHEAD	
2-6	R2-1	24 X 30	5.00	---	---	---	---	---	---	---	---	---	---	---	---	---	---	---	---	---	---	---	---	---	---	SPEED LIMIT 25 MPH	
2-7	R2-1	24 X 30	---	---	---	---	---	---	---	---	---	---	---	---	---	---	---	---	---	---	---	---	---	---	---	SPEED LIMIT 35 MPH	
2-8	I2-3U	60 X 30	---	---	---	---	---	---	---	---	---	---	---	---	---	---	---	---	---	---	---	---	---	---	---	HOULTON UNINCORPORATED	
3-1	R1-1	30 X 30	---	---	---	---	---	---	---	---	---	---	---	---	---	---	---	---	---	---	---	---	---	---	---	STOP SIGN	
3-2	R4-7	24 X 30	---	---	---	---	---	---	---	---	---	---	---	---	---	---	---	---	---	---	---	---	---	---	---	KEEP RIGHT	
3-3	R1-1	30 X 30	---	---	---	---	---	---	---	---	---	---	---	---	---	---	---	---	---	---	---	---	---	---	---	STOP SIGN	
3-4	R5-1	30 X 30	---	---	---	---	---	---	---	---	---	---	---	---	---	---	---	---	---	---	---	---	---	---	---	DO NOT ENTER	
3-5	R3-20L	24 X 36	---	---	---	---	---	---	---	---	---	---	---	---	---	---	---	---	---	---	---	---	---	---	---	BEGIN LEFT TURN LANE	
3-6	R2-1	24 X 30	5.00	---	---	---	---	---	---	---	---	---	---	---	---	---	---	---	---	---	---	---	---	---	---	SPEED LIMIT 25 MPH	
3-7	R5-1A	36 X 24	---	---	---	---	---	---	---	---	---	---	---	---	---	---	---	---	---	---	---	---	---	---	---	WRONG WAY	
3-8	R2-1	24 X 30	5.00	---	---	---	---	---	---	---	---	---	---	---	---	---	---	---	---	---	---	---	---	---	---	SPEED LIMIT 35 MPH	
3-9	R2-1	24 X 30	---	---	---	---	---	---	---	---	---	---	---	---	---	---	---	---	---	---	---	---	---	---	---	SPEED LIMIT 45 MPH	
3-10	W4-2L	36 X 36	---	---	---	---	---	---	---	---	---	---	---	---	---	---	---	---	---	---	---	---	---	---	---	LANE REDUCTION TRANSITION SYMBOL (LEFT)	
3-11	W4-2L	36 X 36	---	---	---	---	---	---	---	---	---	---	---	---	---	---	---	---	---	---	---	---	---	---	---	LANE REDUCTION TRANSITION SYMBOL (LEFT)	
3-12	W1-2R	30 X 30	---	---	---	---	---	---	---	---	---	---	---	---	---	---	---	---	---	---	---	---	---	---	---	RIGHT CURVE	
3-13	W1-2R	30 X 30	---	---	---	---	---	---	---	---	---	---	---	---	---	---	---	---	---	---	---	---	---	---	---	RIGHT CURVE	
3-14	J22-2	48 X 57	---	---	---	---	---	---	---	---	---	---	---	---	---	---	---	---	---	---	---	---	---	---	---	TRAILBLAZER (ADVANCE TURN)	
4-1	W9-1R	36 X 36	---	---	---	---	---	---	---	---	---	---	---	---	---	---	---	---	---	---	---	---	---	---	---	RIGHT LANE ENDS	
4-2	R2-1	24 X 30	---	---	---	---	---	---	---	---	---	---	---	---	---	---	---	---	---	---	---	---	---	---	---	SPEED LIMIT 45 MPH	
4-3	R2-1	24 X 30	5.00	---	---	---	---	---	---	---	---	---	---	---	---	---	---	---	---	---	---	---	---	---	---	SPEED LIMIT 35 MPH	
5-1	R1-1	30 X 30	---	---	---	---	---	---	---	---	---	---	---	---	---	---	---	---	---	---	---	---	---	---	---	STOP SIGN	
5-2	W1-1L	36 X 36	---	---	---	---	---	---	---	---	---	---	---	---	---	---	---	---	---	---	---	---	---	---	---	LEFT TURN	
5-3	W13-1	24 X 24	---	---	---	---	---	---	---	---	---	---	---	---	---	---	---	---	---	---	---	---	---	---	---	ADVISORY SPEED (YELLOW BACK)	
5-4	R2-1	24 X 30	5.00	---	---	---	---	---	---	---	---	---	---	---	---	---	---	---	---	---	---	---	---	---	---	SPEED LIMIT 25 MPH	
5-5	R2-1	24 X 30	---	---	---	---	---	---	---	---	---	---	---	---	---	---	---	---	---	---	---	---	---	---	---	SPEED LIMIT 35 MPH	
5-6	R1-1	30 X 30	5.18	---	---	---	---	---	---	---	---	---	---	---	---	---	---	---	---	---	---	---	---	---	---	STOP SIGN	
5-6	W1-6	48 X 24	---	---	---	---	---	---	---	---	---	---	---	---	---	---	---	---	---	---	---	---	---	---	---	NIGHT ARROW (SINGLE)	
5-7	R1-1	30 X 30	---	---	---	---	---	---	---	---	---	---	---	---	---	---	---	---	---	---	---	---	---	---	---	STOP SIGN	
5-8	W3-1	36 X 36	---	---	---	---	---	---	---	---	---	---	---	---	---	---	---	---	---	---	---	---	---	---	---	STOP AHEAD	
5-9	W1-6	48 X 24	---	---	---	---	---	---	---	---	---	---	---	---	---	---	---	---	---	---	---	---	---	---	---	NIGHT ARROW (SINGLE)	
5-10	W1-1R	36 X 36	---	---	---	---	---	---	---	---	---	---	---	---	---	---	---	---	---	---	---	---	---	---	---	RIGHT TURN	
6-1	W13-1	24 X 24	---	---	---	---	---	---	---	---	---	---	---	---	---	---	---	---	---	---	---	---	---	---	---	ADVISORY SPEED (YELLOW BACK)	
6-2	R1-1	30 X 30	5.18	---	---	---	---	---	---	---	---	---	---	---	---	---	---	---	---	---	---	---	---	---	---	STOP SIGN	
6-3	R7-51L	18 X 24	---	---	---	---	---	---	---	---	---	---	---	---	---	---	---	---	---	---	---	---	---	---	---	STOP SIGN	
6-4	R2-1	24 X 30	5.00	---	---	---	---	---	---	---	---	---	---	---	---	---	---	---	---	---	---	---	---	---	---	NO PARKING HERE TO CORNER (LEFT ARROW)	
6-5	R2-1	24 X 30	---	---	---	---	---	---	---	---	---	---	---	---	---	---	---	---	---	---	---	---	---	---	---	SPEED LIMIT 35 MPH	
6-6	W3-1	36 X 36	---	---	---	---	---	---	---	---	---	---	---	---	---	---	---	---	---	---	---	---	---	---	---	STOP AHEAD	

CATEGORY 0010 SHEET 1 SUBTOTALS: 71.97 48.25

30 31

14

PROJECT NO: 8110-02-73

HWY: STH 35

COUNTY: ST. CROIX

MISCELLANEOUS QUANTITIES

SHEET: 221REV E

FILE NAME: N:\PDS\...030200_mq.ppk PLOT NAME: PLOT SCALE: 1:1 PLOT DATE: June 14, 1911 PLOT BY: A.R.H.

3

PERMANENT SIGNING TYPE II (2) (CONTINUED)

SIGN #	SIGN CODE	SIGN SIZE W X H	SIGN REFLECTIVE TYPE II	SIGN TYPE II	637.2230 SIGN TYPE II	634.0809 SIGN TYPE II	634.0810 SIGN TYPE II	634.0811 SIGN TYPE II	634.0812 SIGN TYPE II	634.0814 SIGN TYPE II	634.0885 SIGN TYPE II	638.2102 SIGN TYPE II	638.2602 SIGN TYPE II	638.3000 SIGN TYPE II	REMARKS				
																IN	IN	IN	IN
CATEGORY 0010 SHEET 1 SUBTOTALS:																			
		71.97	48.25	3	14	4	2	30	31										
CATEGORY 0010																			
6-8	R1-1	30 X 30	5.18	---	---	---	---	---	---	---	---	---	---	---	STOP SIGN				
6-10	R2-1	24 X 30	5.00	---	---	---	---	---	---	---	---	---	---	---	SPEED LIMIT 25 MPH				
6-11	R2-1	24 X 30	5.00	---	---	---	---	---	---	---	---	---	---	---	SPEED LIMIT 35 MPH				
6-12	S4-51	24 X 48	---	---	---	---	---	---	---	---	---	---	---	---	SCHOOL SPEED LIMIT				
6-17	R1-1	30 X 30	5.18	---	---	---	---	---	---	---	---	---	---	---	STOP SIGN				
7-1	S4-51	24 X 48	---	---	---	---	---	---	---	---	---	---	---	---	SCHOOL SPEED LIMIT				
9-14	R1-1	30 X 30	5.18	---	---	---	---	---	---	---	---	---	---	---	STOP SIGN				
10-7	R3-1	24 X 24	4.00	---	---	---	---	---	---	---	---	---	---	---	NO RIGHT TURN SYMBOL				
10-8	R4-7	24 X 30	---	---	---	---	---	---	---	---	---	---	---	---	KEEP RIGHT				
10-13	R3-2	24 X 24	4.00	---	---	---	---	---	---	---	---	---	---	---	NO LEFT TURN SYMBOL				
10-14	R4-7	24 X 30	---	---	---	---	---	---	---	---	---	---	---	---	KEEP RIGHT				
10-27	R6-2L	24 X 30	---	---	---	---	---	---	---	---	---	---	---	---	ONE WAY LEFT ARROW				
10-28	R5-1	30 X 30	5.18	---	---	---	---	---	---	---	---	---	---	---	DO NOT ENTER				
10-29	R1-1	30 X 30	5.18	---	---	---	---	---	---	---	---	---	---	---	STOP SIGN				
11-1	R5-3	24 X 24	4.00	---	---	---	---	---	---	---	---	---	---	---	NO MOTOR VEHICLES				
11-3	R7-8A	12 X 18	1.50	---	---	---	---	---	---	---	---	---	---	---	RESERVED PARKING HANDICAPPED, THIS SPACE				
11-4	R7-8A	12 X 18	1.50	---	---	---	---	---	---	---	---	---	---	---	RESERVED PARKING HANDICAPPED, THIS SPACE				
11-5	R7-8A	12 X 18	1.50	---	---	---	---	---	---	---	---	---	---	---	RESERVED PARKING HANDICAPPED, THIS SPACE				
11-6	R7-8A	12 X 18	1.50	---	---	---	---	---	---	---	---	---	---	---	RESERVED PARKING HANDICAPPED, THIS SPACE				
11-7	R7-8V	12 X 6	0.50	---	---	---	---	---	---	---	---	---	---	---	VAN ACCESSIBLE				
11-7	W1-6	48 X 24	---	---	---	---	---	---	---	---	---	---	---	---	NIGHT ARROW (SINGLE)				
11-8	W1-6	48 X 24	---	---	---	---	---	---	---	---	---	---	---	---	NIGHT ARROW (SINGLE)				
11-9	R5-3	24 X 24	4.00	---	---	---	---	---	---	---	---	---	---	---	NO MOTOR VEHICLES				
12-1	R1-1	18 X 18	1.86	---	---	---	---	---	---	---	---	---	---	---	STOP SIGN				
12-2	R8-7	48 X 36	12.00	---	---	---	---	---	---	---	---	---	---	---	EMERGENCY STOPPING ONLY				
CATEGORY 0010 TOTAL:		34.05	64.25	7	25	4	4	36	37										
CATEGORY 0020																			
1-10	W11-15	30 X 30	6.25	---	---	---	---	---	---	---	---	---	---	---	BICYCLE/PEDESTRIAN CROSSING				
1-11	W16-7L	24 X 12	2.00	---	---	---	---	---	---	---	---	---	---	---	LEFT DIAGONAL DOWNWARD POINTING ARROW (YELLOW)				
1-14	R1-1	18 X 18	1.86	---	---	---	---	---	---	---	---	---	---	---	STOP SIGN				
1-14	W11-15	30 X 30	6.25	---	---	---	---	---	---	---	---	---	---	---	BICYCLE/PEDESTRIAN CROSSING				
1-14	W16-7L	24 X 12	2.00	---	---	---	---	---	---	---	---	---	---	---	LEFT DIAGONAL DOWNWARD POINTING ARROW (YELLOW)				
1-15	W11-15	30 X 30	6.25	---	---	---	---	---	---	---	---	---	---	---	BICYCLE/PEDESTRIAN CROSSING				
1-15	W16-7L	24 X 12	2.00	---	---	---	---	---	---	---	---	---	---	---	LEFT DIAGONAL DOWNWARD POINTING ARROW (YELLOW)				
2-1	W11-15	30 X 30	6.25	---	---	---	---	---	---	---	---	---	---	---	BICYCLE/PEDESTRIAN CROSSING				
2-1	W16-9P	24 X 12	2.00	---	---	---	---	---	---	---	---	---	---	---	AHEAD PLAQUE (YELLOW)				
6-1	R1-1	18 X 18	1.86	---	---	---	---	---	---	---	---	---	---	---	STOP SIGN				
6-7	R1-2	18 X 16	0.97	---	---	---	---	---	---	---	---	---	---	---	YIELD				
6-9	R1-2	18 X 16	0.97	---	---	---	---	---	---	---	---	---	---	---	YIELD				
6-13	W11-15	30 X 30	6.25	---	---	---	---	---	---	---	---	---	---	---	BICYCLE/PEDESTRIAN CROSSING				
6-13	W16-9P	24 X 12	2.00	---	---	---	---	---	---	---	---	---	---	---	AHEAD PLAQUE (YELLOW)				
6-14	W11-15	30 X 30	6.25	---	---	---	---	---	---	---	---	---	---	---	BICYCLE/PEDESTRIAN CROSSING				
6-14	W16-7L	24 X 12	2.00	---	---	---	---	---	---	---	---	---	---	---	LEFT DIAGONAL DOWNWARD POINTING ARROW (YELLOW)				
6-15	R1-1	18 X 18	1.86	---	---	---	---	---	---	---	---	---	---	---	STOP SIGN				
6-16	W11-15	30 X 30	6.25	---	---	---	---	---	---	---	---	---	---	---	BICYCLE/PEDESTRIAN CROSSING				
6-16	W16-7L	24 X 12	2.00	---	---	---	---	---	---	---	---	---	---	---	LEFT DIAGONAL DOWNWARD POINTING ARROW (YELLOW)				
7-2	W11-15	30 X 30	6.25	---	---	---	---	---	---	---	---	---	---	---	BICYCLE/PEDESTRIAN CROSSING				
7-2	W16-9P	24 X 12	2.00	---	---	---	---	---	---	---	---	---	---	---	AHEAD PLAQUE (YELLOW)				
7-3	R7-52D	18 X 24	3.00	---	---	---	---	---	---	---	---	---	---	---	NO PARKING BETWEEN SIGNS (DOUBLE ARROW)				
7-4	R7-52D	18 X 24	3.00	---	---	---	---	---	---	---	---	---	---	---	NO PARKING BETWEEN SIGNS (DOUBLE ARROW)				
7-5	R4-7	24 X 30	5.00	---	---	---	---	---	---	---	---	---	---	---	KEEP RIGHT				
CATEGORY 0020 SHEET 2 SUBTOTALS:		18.82	66.00	5	8	2	8	2	8										

Addendum No. 01
ID 8110-02-73
Revised Sheet 225
March 7, 2018

PERMANENT SIGNING TYPE II (5) (CONTINUED)

SIGN #	SIGN CODE	SIGN SIZE		SIGN TYPE II	SIGN TYPE II REFLECTIVE	SIGN TYPE II REFLECTIVE	637-2210		634-0809	634-0810	634-0811		634-0812	634-0814	634-0885	638-2102	638-2602	638-3000	SIGN MOUNTED ON SAME POST/AS REMARKS
		W	H				SF	H			10 FT EACH	11 FT EACH							
CATEGORY 0020 SHEET 4 SUBTOTALS:																			
CATEGORY 0020																			
10-26	R7-3A	12	18	1.50	--	--	1	--	1	--	--	--	--	--	--	--	--	--	RESERVED PARKING HANDICAPPED, THIS SPACE
10-30	R1-1	30	30	5.18	--	--	1	--	1	--	--	--	--	--	--	--	--	--	STOP SIGN
10-31	R5-1-C	30	30	5.18	--	--	--	--	--	--	--	--	--	--	--	--	--	--	DO NOT ENTER (CLIPPED CORNERS)
11-2	R5-1-1	30	24	5.00	--	--	1	--	--	--	--	--	--	--	--	--	--	--	AUTHORIZED VEHICLES ONLY
	CUSTOM	48	30	10.00	--	--	--	--	--	--	--	--	--	--	--	--	--	--	TRAIL CLOSED (DO NOT INSTALL)
	CUSTOM	48	30	10.00	--	--	--	--	--	--	--	--	--	--	--	--	--	--	TRAIL CLOSED (DO NOT INSTALL)
	CUSTOM	48	30	10.00	--	--	--	--	--	--	--	--	--	--	--	--	--	--	TRAIL CLOSED (DO NOT INSTALL)
	CUSTOM	48	30	10.00	--	--	--	--	--	--	--	--	--	--	--	--	--	--	TRAIL CLOSED (DO NOT INSTALL)
CATEGORY 0020 TOTAL:																			
		269.74	129.63				53	8	10	1	1	1	1	1	1	1	1	1	
CATEGORY 0010 TOTAL:																			
		134.05	64.25				4	25	1	4	4	4	4	4	4	4	4	4	
PROJECT 8110-02-73 TOTAL		403.79	193.88				57	33	11	4	1	4	4	4	4	4	4	4	

SPECIAL 01. INTERPRETIVE PANEL SUPPORT POSTS AND BASES

CATEGORY	LOCATION	REMARKS	SPV.0060.01 EACH
0040	PROJECT WIDE		10
	TOTAL 0040		10

SPECIAL 02. INTERPRETIVE PANEL SUPPORT POST - DELIVERED

CATEGORY	LOCATION	REMARKS	SPV.0060.02 EACH
0040	PROJECT WIDE		2
	TOTAL 0040		2

SPECIAL 03. GATE PEDESTRIAN RAILING

CATEGORY	LOCATION	REMARKS	SPV.0060.03 EACH
0020	TOURIST PARK	10FT WIDE	1
	TOTAL 0020		1

SPECIAL 09. GATE CHAIN LINK (26 FT. WIDTH) SPECIAL

CATEGORY	LOCATION	REMARKS	SPV.0060.09 EACH
0030	KOLLINER PARK		1
	TOTAL 0030		1

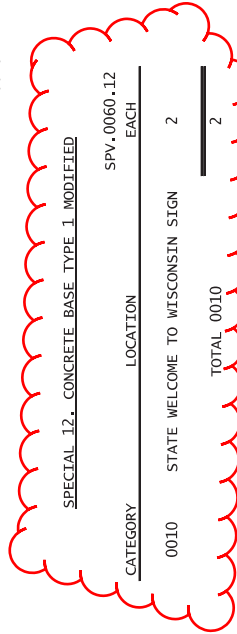

SPECIAL 06. GROUTED RIPRAP RESTORATION

CATEGORY	STATION	LOCATION	REMARKS	SPV.0060.06 EACH
0020	1066+48	OLD STH 64 MULTI-USE PATH		1
0020	1069+01	OLD STH 64 MULTI-USE PATH		1
0020	1072+50	OLD STH 64 MULTI-USE PATH		1
0020	1076+00	OLD STH 64 MULTI-USE PATH		1
0020	1078+22	OLD STH 64 MULTI-USE PATH		1
0020	1064+75	OLD STH 64 MULTI-USE PATH		1
0020	1065+65	OLD STH 64 MULTI-USE PATH		1
	TOTAL 0020			7

SPECIAL 11. TRAFFIC CONTROL REMOVING SIGN COVERS

CATEGORY	STATION	LOCATION	REMARKS	SPV.0060.11 EACH
0010	11+60	STH 35 EB		1
0010	25+60	STH 35 WB		1
0010	189+00	STH 35 WB		1
0010	225+00	STH 35 WB		1
	TOTAL 0010			4

CATEGORY	LOCATION	REMARKS	SPV.0075.01 HRS
0010	PROJECT WIDE		25
	TOTAL 0010		25

SPECIAL 01. INFILTRATION BASIN SEEDING

CATEGORY	LOCATION	REMARKS	SPV.0085.01 LB
0020	MAIN TRAILHEAD	RAIN GARDEN	2
0020	MAIN TRAILHEAD	INFILTRATION BASIN	10
0020	MAIN TRAILHEAD	INFILTRATION BASIN	3
0020	HILLTOP TRAILHEAD	RAIN GARDEN	6
	TOTAL 0020		21

SPECIAL 01. PEDESTRIAN RAILING

CATEGORY	LOCATION	REMARKS	SPV.0090.01 LF
0010	PARK AND RIDE		125
	TOTAL 0010		125
0020	OLD STH 64 MULTI-USE PATH		3350
0020	MAIN RIVER BRIDGE		75
	TOTAL 0020		3425

SPECIAL 02. FENCE CHAIN LINK COATED 6-FI

CATEGORY	STATION TO STATION	REMARKS	SPV.0090.02 LF
0030	1058+00 - 1060+15	OLD STH 64 MULTI-USE PATH	230
		INCLUDES 20 FOOT GATE	
	TOTAL 0030		230

Addendum No. 01
 ID 8110-02-73
 Revised Sheet 234
 March 7, 2018

SPECIAL 04. SAFETY FENCE MAINTENANCE

CATEGORY	STATION TO	STATION	LOCATION	LF	REMARKS
0020	50+00	- 53+00	PARK AND RIDE	113	
0020	2015+55	- 2015+92	MAIN ST	58	
0020	2015+52	- 2015+74	MAIN ST	24	
0020	2018+40	- 2018+63	MAIN ST	23	
0020	2026+30	- 2026+42	MAIN ST	12	
TOTAL					800

SPECIAL 05. STATE WELCOME SIGN STRUCTURE

CATEGORY	STATION TO	STATION	LOCATION	LF	REMARKS
0040	10+00	- 14+30	PICNIC SHELTER	1	
TOTAL					1

SPECIAL 02. CONCRETE SIDEWALK CURE AND SEAL TREATMENT

CATEGORY	STATION TO	STATION	LOCATION	SF	REMARKS
0010	10+00	- 14+30	HAWK STREET SOUTH	1900	
0010	50+00	- 53+00	PARK AND RIDE	2075	
TOTAL					3975

Addendum No. 01
 ID 8110-02-73
 Revised Sheet 235
 March 7, 2018

SPECIAL 03. CONCRETE CURB AND GUTTER CURE AND SEAL TREATMENT

CATEGORY	STATION TO	STATION	LOCATION	LF	REMARKS
0010	50+00	- 53+00	PARK AND RIDE	113	
0010	2015+55	- 2015+92	MAIN ST	58	
0010	2015+52	- 2015+74	MAIN ST	24	
0010	2018+40	- 2018+63	MAIN ST	23	
0010	2026+30	- 2026+42	MAIN ST	12	
TOTAL					185

SPECIAL 01. PICNIC SHELTER

CATEGORY	STATION TO	STATION	LOCATION	LF	REMARKS
0010	2027+44	- 2029+30	MAIN ST	49	
0010	2028+62	- 2028+94	MAIN ST	50	
0010	2029+34	- 2029+54	MAIN ST	50	
0010	10+00	- 14+30	HAWK STREET SOUTH	250	
0010			HAWK STREET	30	
TOTAL					1232

SPECIAL 05. CLEANING, GRADING AND SHAPING EXISTING DITCH

CATEGORY	STATION TO	STATION	LOCATION	LF	REMARKS
0020	1058+18	- 1079+50	HILLTOP PARKING	301	
0020			OLD STH 64 MULTI-USE PATH	2139	
0020			HILLTOP PARKING	55	
0020			HILLTOP PARKING	25	
0020			MAIN TRAILHEAD	20	
TOTAL					2540

SPECIAL 01. ANTI-GRAFFITI COATING

CATEGORY	STATION TO	STATION	LOCATION	LF	REMARKS
0060	2007+00	- 2007+00	MAIN STREET	50	
TOTAL					50

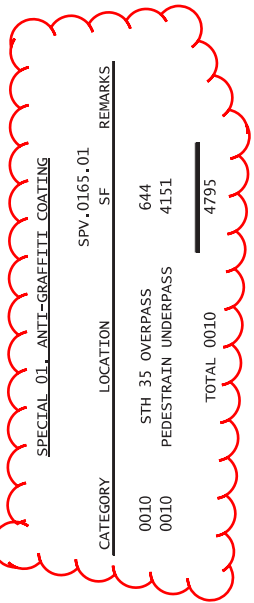

SPECIAL 04. SAFETY FENCE MAINTENANCE

CATEGORY	STATION TO	STATION	LOCATION	LF	REMARKS
0020	50+00	- 53+00	MAIN TRAILHEAD	700	
0020	50+00	- 53+00	MAIN RIVER BRIDGE	100	
TOTAL					800

SPECIAL 05. STATE WELCOME SIGN STRUCTURE

CATEGORY	STATION TO	STATION	LOCATION	LF	REMARKS
0040	10+00	- 14+30	PICNIC SHELTER	1	
TOTAL					1

SPECIAL 02. CONCRETE SIDEWALK CURE AND SEAL TREATMENT

CATEGORY	STATION TO	STATION	LOCATION	SF	REMARKS
0010	10+00	- 14+30	HAWK STREET SOUTH	1900	
0010	50+00	- 53+00	PARK AND RIDE	2075	
TOTAL					3975

Addendum No. 01
 ID 8110-02-73
 Revised Sheet 235
 March 7, 2018

SPECIAL 03. CONCRETE CURB AND GUTTER CURE AND SEAL TREATMENT

CATEGORY	STATION TO	STATION	LOCATION	LF	REMARKS
0010	2027+44	- 2029+30	MAIN ST	49	
0010	2028+62	- 2028+94	MAIN ST	50	
0010	2029+34	- 2029+54	MAIN ST	50	
0010	10+00	- 14+30	HAWK STREET SOUTH	250	
0010			HAWK STREET	30	
TOTAL					1232

SPECIAL 01. PICNIC SHELTER

CATEGORY	STATION TO	STATION	LOCATION	LF	REMARKS
0040	10+00	- 14+30	PICNIC SHELTER	1	
TOTAL					1

SPECIAL 02. CONCRETE SIDEWALK CURE AND SEAL TREATMENT

CATEGORY	STATION TO	STATION	LOCATION	SF	REMARKS
0010	10+00	- 14+30	HAWK STREET SOUTH	1900	
0010	50+00	- 53+00	PARK AND RIDE	2075	
TOTAL					3975

SPECIAL 05. STATE WELCOME SIGN STRUCTURE

CATEGORY	STATION TO	STATION	LOCATION	LF	REMARKS
0020	50+00	- 53+00	MAIN TRAILHEAD	700	
0020	50+00	- 53+00	MAIN RIVER BRIDGE	100	
TOTAL					800

MISCELLANEOUS QUANTITIES

CATEGORY	STATION TO	STATION	LOCATION	LF	REMARKS
0020	156+38	- 156+61	SHARED USE PATH	24	
0020	133+00	- 133+00	STH 64 WB	92	
0020	165+16	- 165+57	SHARED USE PATH	400	
0020	165+16	- 165+57	SHARED USE PATH	400	
0020			HILLTOP PARKING	74	
TOTAL					9139

MISCELLANEOUS QUANTITIES

CATEGORY	STATION TO	STATION	LOCATION	LF	REMARKS
0020	156+38	- 156+61	SHARED USE PATH	24	
0020	133+00	- 133+00	STH 64 WB	92	
0020	165+16	- 165+57	SHARED USE PATH	400	
0020	165+16	- 165+57	SHARED USE PATH	400	
0020			HILLTOP PARKING	74	
TOTAL					9139

MISCELLANEOUS QUANTITIES

CATEGORY	STATION TO	STATION	LOCATION	LF	REMARKS
0020	156+38	- 156+61	SHARED USE PATH	24	
0020	133+00	- 133+00	STH 64 WB	92	
0020	165+16	- 165+57	SHARED USE PATH	400	
0020	165+16	- 165+57	SHARED USE PATH	400	
0020			HILLTOP PARKING	74	
TOTAL					9139

MISCELLANEOUS QUANTITIES

CATEGORY	STATION TO	STATION	LOCATION	LF	REMARKS
0020	156+38	- 156+61	SHARED USE PATH	24	
0020	133+00	- 133+00	STH 64 WB	92	
0020	165+16	- 165+57	SHARED USE PATH	400	
0020	165+16	- 165+57	SHARED USE PATH	400	
0020			HILLTOP PARKING	74	
TOTAL					9139

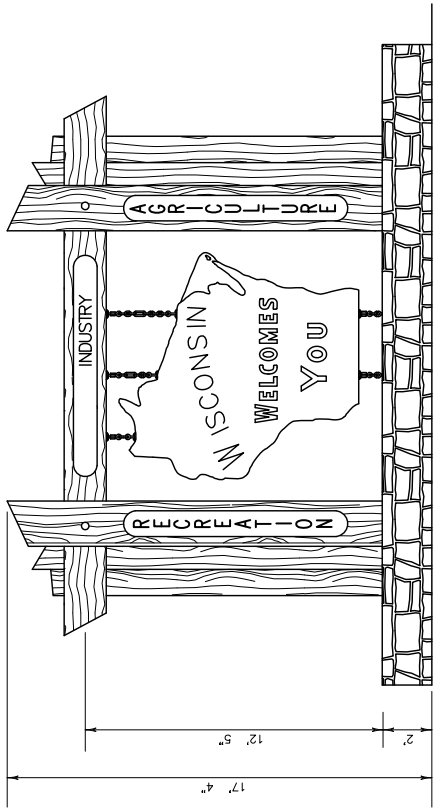

FRONT VIEW

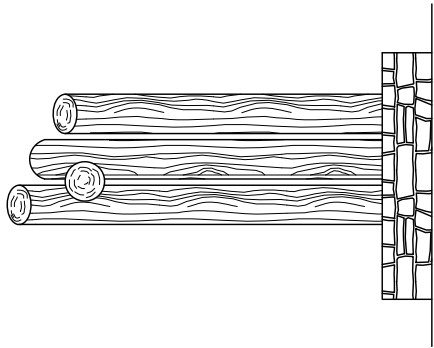

END VIEW

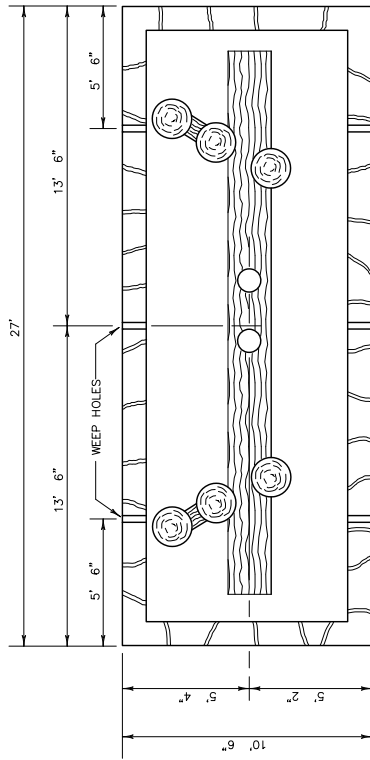

PLAN VIEW

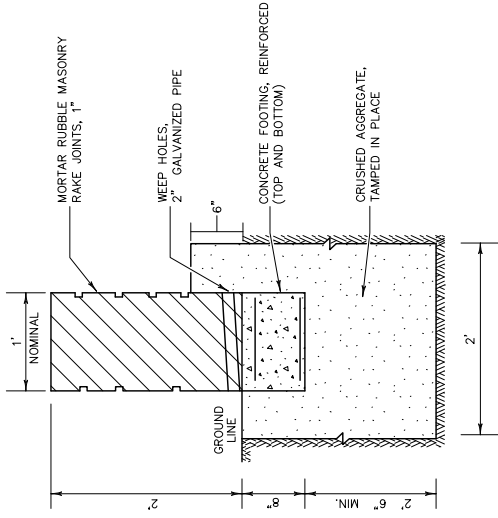

SECTION

GENERAL NOTES

1. FOUNDATION - EXCAVATE AND BACKFILL WITH CRUSHED AGGREGATE AND TAMP IN PLACE.
2. FOOTING - USE GRADE "AA" CONCRETE MASONRY MIXTURE AND STANDARD STEEL WELDED WIRE FABRIC REINFORCEMENT.
3. STONE MASONRY - SHALL BE MORTAR RUBBLE MASONRY LAID IN ACCORDANCE WITH THE REQUIREMENTS OF SECTION 518. PLACE WEEP HOLES AS INDICATED.

4. INSTALL CONCRETE BASE TYPE 1 MODIFIED FOR LIGHTING (LIGHTING PROVIDED BY OTHERS).

ESTIMATE OF QUANTITIES FOR "WELCOME SIGN" - 1 LUMP SUM

ITEM	UNIT	QUANTITY
EXCAVATION	C.Y.	16.0
CRUSHED AGGREGATE	C.Y.	21.0
STEEL WIRE FABRIC	S.Y.	16.0
CONCRETE MASONRY	C.Y.	2.5*
MORTAR RUBBLE MASONRY	C.Y.	5.5
GALVANIZED IRON PIPE, 2" x 1"	EACH	6.0

*INCLUDES SIGN ANCHORS

Addendum No. 01
ID 8110-02-73
Revised Sheet 357
March 7, 2018

'A' HAWK ROAD SOUTH

STA	AREA (SF)		VOLUME (CY)		CUMULATIVE VOLUME (CY)		②MASS HAUL (CY)
	CUT	FILL	CUT	FILL	205.0100	COMMON EXCAVATION	
12+06.00	--	9.9	--	--	13	--	-13
12+50.00	0.0	18.1	--	29	42	--	-42
13+00.00	0.0	18.1	--	42	84	--	-84
13+50.00	0.0	18.1	--	42	126	--	-126
14+00.00	0.0	18.1	--	42	168	--	-168
14+30.00	0.0	18.1	--	25	193	--	-193
14+50.00	--	18.1	--	17	210	--	-210

① EXPANDED THE FILL BY 25%
 ② COMMON EXCAVATION - EXPANDED FILL (+ DENOTES WASTE, - IS BORROW)

'C' PARK AND RIDE

STA	AREA (SF)		VOLUME (CY)		CUMULATIVE VOLUME (CY)		②MASS HAUL (CY)
	CUT	FILL	CUT	FILL	205.0100	COMMON EXCAVATION	
50+71.32	2.8	0.1	--	--	--	--	--
51+00.00	0.4	0.1	--	--	--	--	--
51+20.39	1.5	4.5	1	2	1	2	-1
51+50.00	--	9.2	1	9	2	11	-9
51+63.23	--	9.2	--	6	2	17	-15
52+00.00	0.2	3.6	--	11	2	28	-26
52+50.00	0.1	3.6	--	8	2	36	-34
52+79.25	0.3	3.6	--	5	2	41	-39
52+90.00	0.4	1.8	--	1	2	42	-40

① EXPANDED THE FILL BY 25%
 ② COMMON EXCAVATION - EXPANDED FILL (+ DENOTES WASTE, - IS BORROW)

STA	Length (ft)	Cut Area (sf)	Cut Yards (cy)	Fill Area (sf)	Fill Yards (cy)	Expanded Fill Yards (1.25 Factor)	Mass Ordinate
10+50.000	50	0.00	0.00	0.00	0.00	0.00	0.00
11+00.000	50	11.45	10.08	0.72	0.62	0.78	9.30
11+50.000	50	3.33	12.86	12.53	11.31	14.14	8.02
12+00.000	50	2.82	5.37	8.75	18.23	22.79	-9.40
12+50.000	50	4.80	6.68	3.07	10.19	12.73	-15.45
13+00.000	50	3.12	6.96	5.40	7.32	9.15	-17.64
13+50.000	50	3.04	5.62	4.65	9.11	11.39	-23.41
14+00.000	50	4.07	6.58	4.52	8.48	10.60	-27.43
14+50.000	50	1.59	5.24	7.96	11.56	14.44	-36.63
15+00.000	50	1.75	3.09	7.00	13.85	17.32	-50.86
15+50.000	50	4.16	5.47	2.78	9.06	11.32	-56.71
16+00.000	50	5.85	9.27	1.10	3.60	4.50	-51.94
16+50.000	50	7.26	12.13	0.31	1.31	1.64	-41.45
17+00.000	50	7.58	13.74	0.32	0.59	0.73	-28.44
17+50.000	50	0.00	7.02	0.00	0.30	0.37	-21.79
18+00.000	50	0.00	0.00	0.00	0.00	0.00	-21.79

Addendum No. 01
 ID 8110-02-73
 Revised Sheet 415
 March 7, 2018

Addendum No. 01
ID 8110-02-73
Added Sheet 582A
March 7, 2018

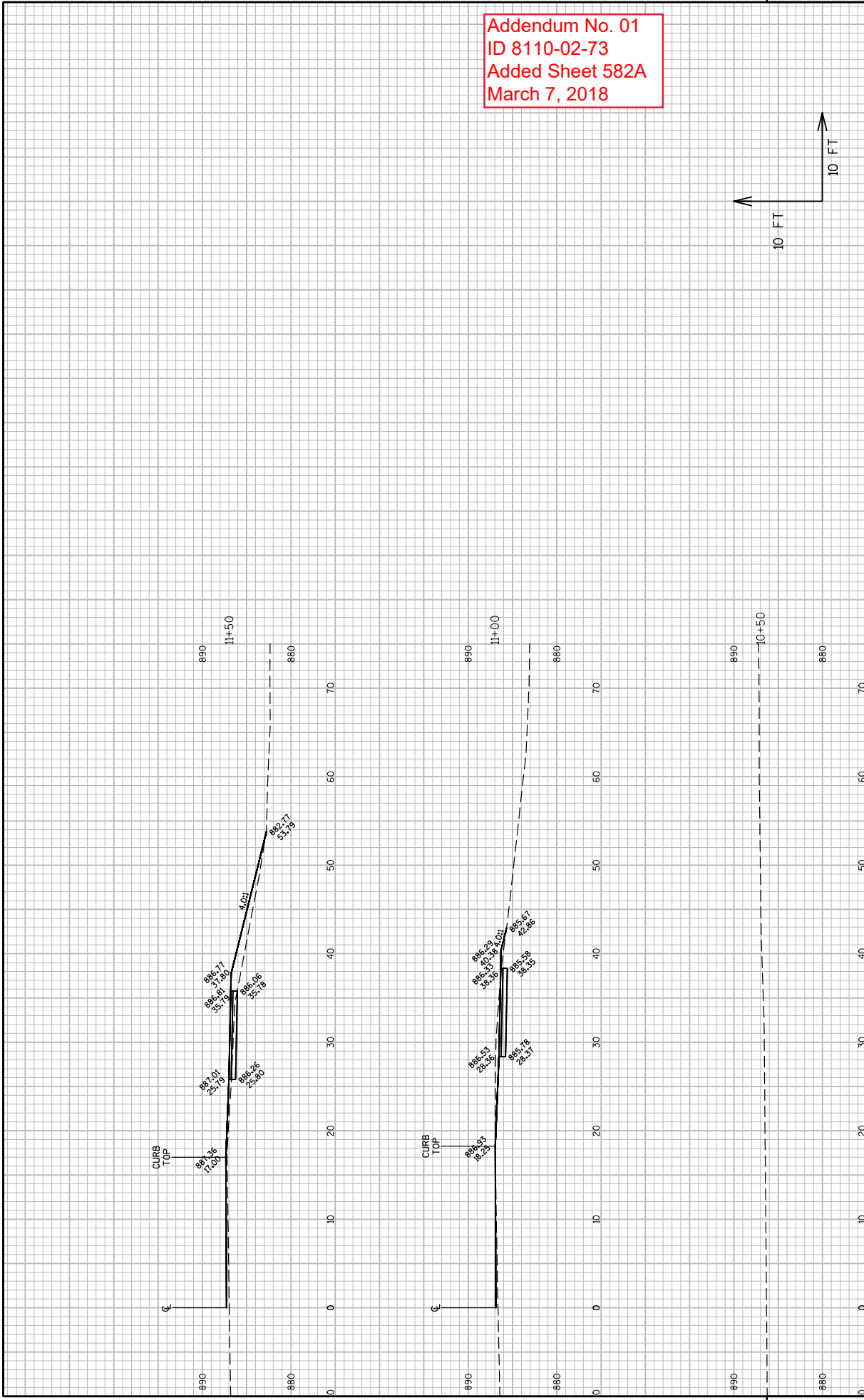

Addendum No. 01
 ID 8110-02-73
 Added Sheet 582B
 March 7, 2018

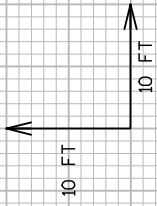
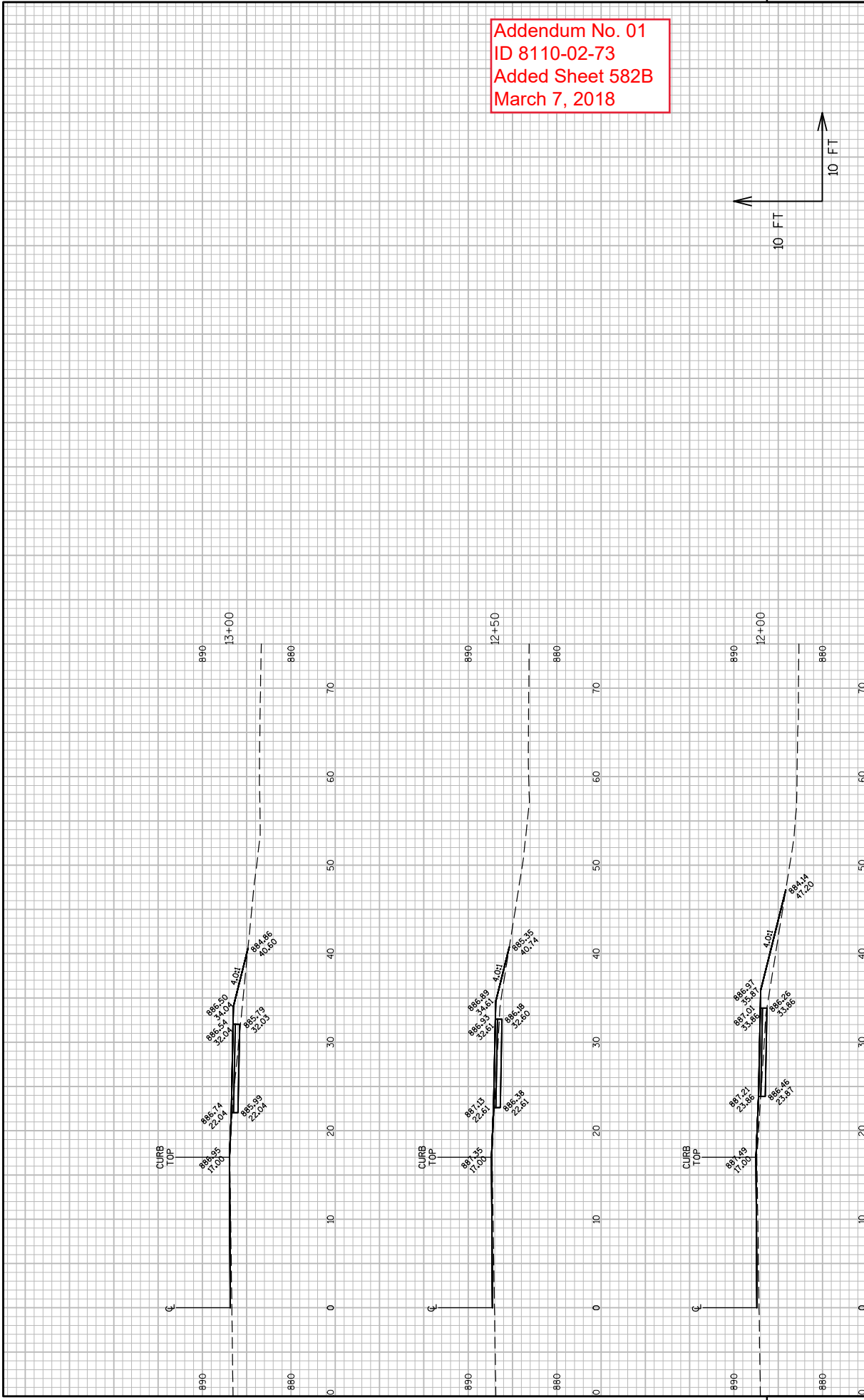

Addendum No. 01
 ID 8110-02-73
 Added Sheet 582C
 March 7, 2018

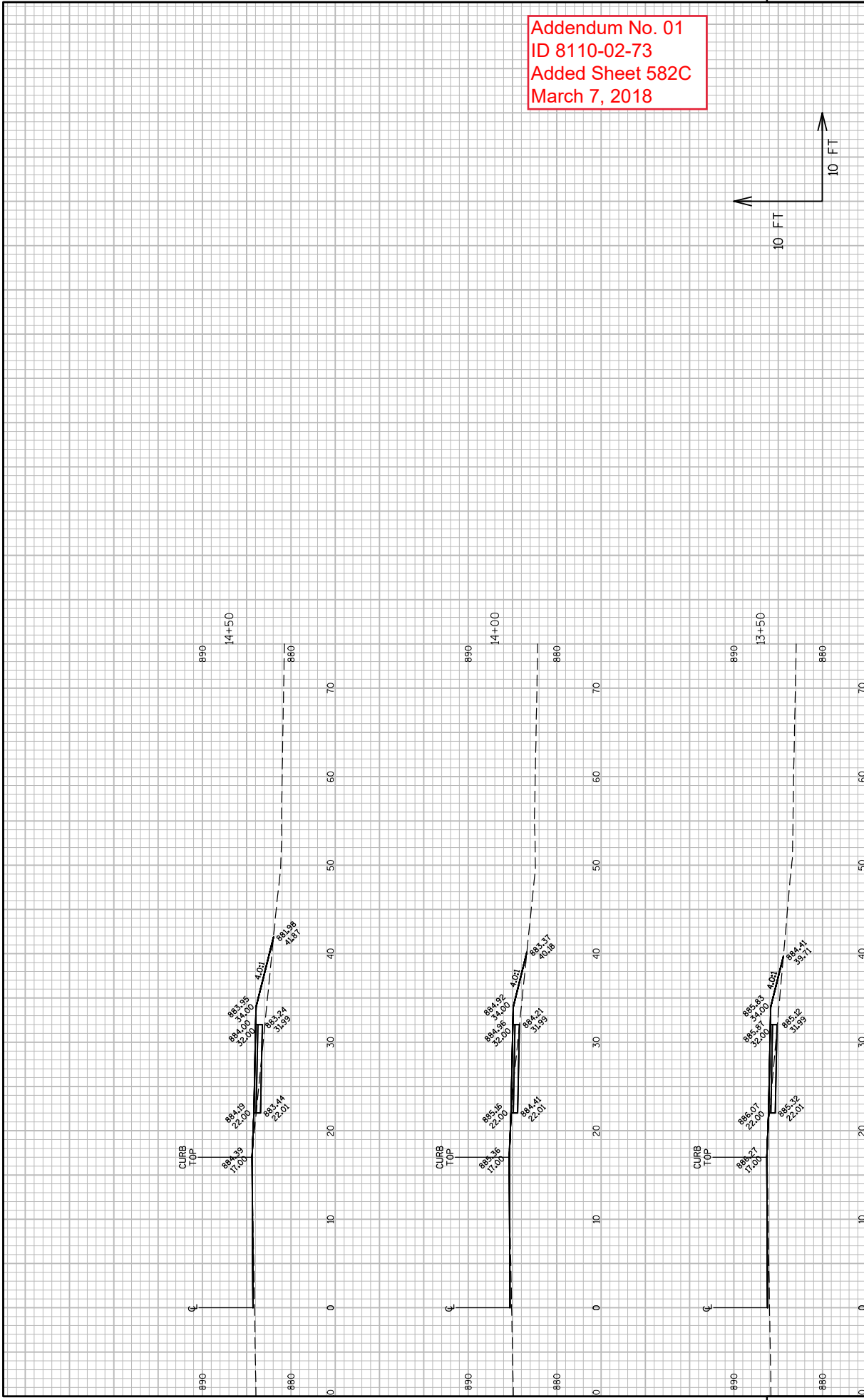

Addendum No. 01
ID 8110-02-73
Added Sheet 582D
March 7, 2018

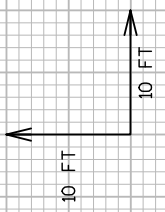
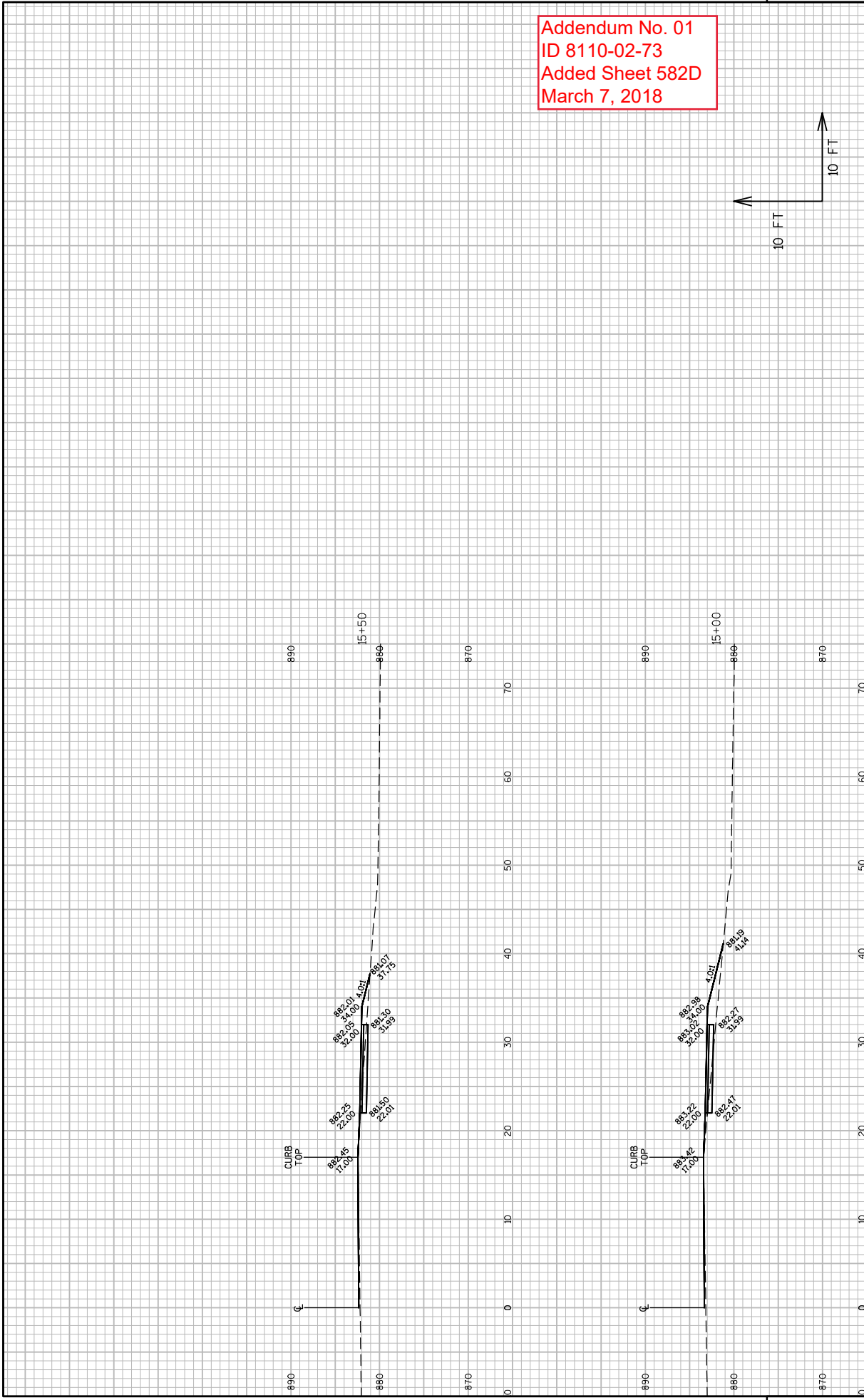

Addendum No. 01
ID 8110-02-73
Added Sheet 582E
March 7, 2018

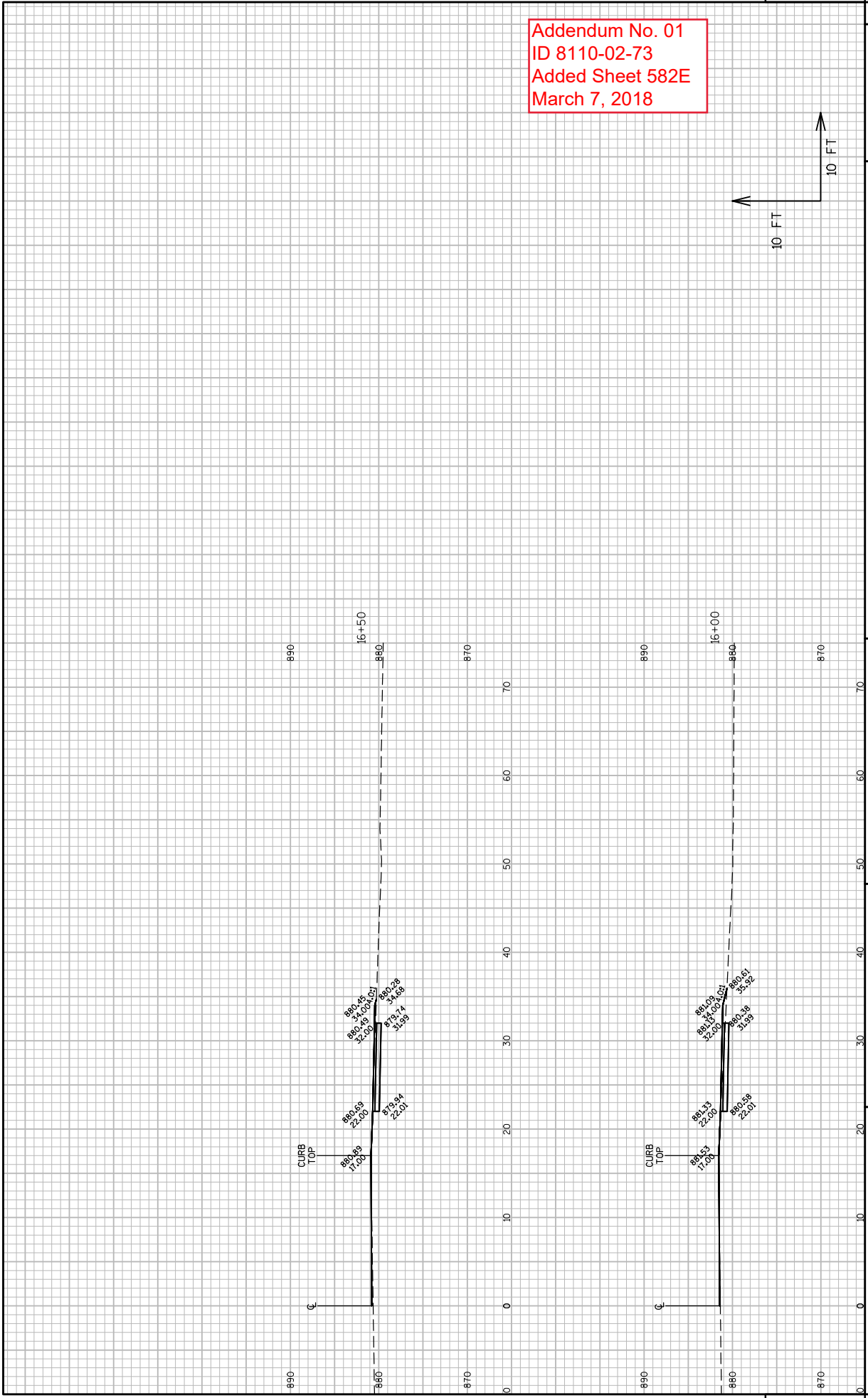

Addendum No. 01
ID 8110-02-73
Added Sheet 582F
March 7, 2018

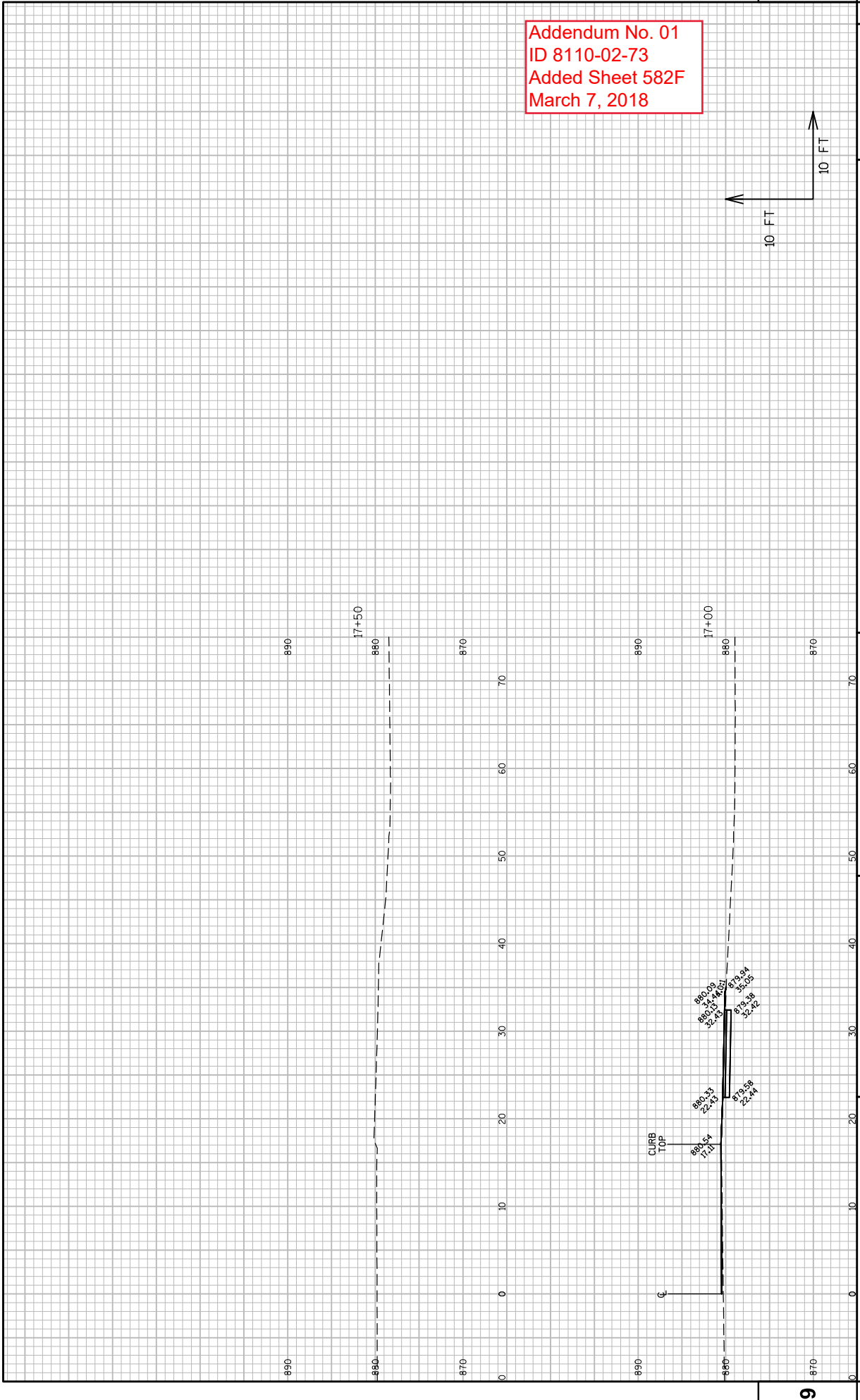

PROJECT NO: 8110-02-73
HWY: STH 64
COUNTY: ST. CROIX
CROSS SECTIONS: HAWK STREET NORTH SIDEWALK
SHEET 582F
E

FILE NAME : N:\POS\GD\81100201\SHEETS\OTHER\HAWK STREET NORTH.DWG
LAYOUT NAME - HAWK STREET NORTH (6)

PLOT DATE : 2/14/2018 2:50 PM
PLOT BY : MANDEN, ALLISSA L
PLOT NAME :

PLOT SCALE : 1 IN:10 FT
WSDOT/CADD SHEET 49



Proposal Schedule of Items

Proposal ID: 20180313040 Project(s): 8110-02-73

Federal ID(s): N/A

SECTION: 0001 Contract Items

Alt Set ID: Alt Mbr ID:

Proposal Line Number	Item ID Description	Approximate Quantity and Units	Unit Price	Bid Amount
0152	601.0600 Concrete Curb Pedestrian	125.000 LF	_____.	_____.
0154	602.0405 Concrete Sidewalk 4-Inch	4,589.500 SF	_____.	_____.
0156	602.0415 Concrete Sidewalk 6-Inch	1,354.000 SF	_____.	_____.
0158	602.0420 Concrete Sidewalk 7-Inch	7,217.000 SF	_____.	_____.
0160	602.0515 Curb Ramp Detectable Warning Field Natural Patina	165.000 SF	_____.	_____.
0162	604.0400 Slope Paving Concrete	54.000 SY	_____.	_____.
0164	606.0100 Riprap Light	64.000 CY	_____.	_____.
0166	606.0300 Riprap Heavy	82.600 CY	_____.	_____.
0168	608.0315 Storm Sewer Pipe Reinforced Concrete Class III 15-Inch	53.000 LF	_____.	_____.
0170	608.0318 Storm Sewer Pipe Reinforced Concrete Class III 18-Inch	328.000 LF	_____.	_____.
0172	608.0324 Storm Sewer Pipe Reinforced Concrete Class III 24-Inch	106.000 LF	_____.	_____.
0174	608.0330 Storm Sewer Pipe Reinforced Concrete Class III 30-Inch	21.000 LF	_____.	_____.
0176	608.0412 Storm Sewer Pipe Reinforced Concrete Class IV 12-Inch	226.000 LF	_____.	_____.
0178	608.0415 Storm Sewer Pipe Reinforced Concrete Class IV 15-Inch	41.000 LF	_____.	_____.
0180	611.0530 Manhole Covers Type J	1.000 EACH	_____.	_____.



Proposal Schedule of Items

Proposal ID: 20180313040 Project(s): 8110-02-73

Federal ID(s): N/A

SECTION: 0001 Contract Items

Alt Set ID: Alt Mbr ID:

Proposal Line Number	Item ID Description	Approximate Quantity and Units	Unit Price	Bid Amount
0182	611.0624 Inlet Covers Type H	9.000 EACH	_____.	_____.
0184	611.0666 Inlet Covers Type Z	3.000 EACH	_____.	_____.
0186	611.2004 Manholes 4-FT Diameter	1.000 EACH	_____.	_____.
0188	611.3003 Inlets 3-FT Diameter	3.000 EACH	_____.	_____.
0190	611.3004 Inlets 4-FT Diameter	7.000 EACH	_____.	_____.
0192	611.3253 Inlets 2.5x3-FT	2.000 EACH	_____.	_____.
0194	614.0920 Salvaged Rail	60.000 LF	_____.	_____.
0196	616.0700.S Fence Safety	500.000 LF	_____.	_____.
0198	618.0100 Maintenance And Repair of Haul Roads (project) 01. 8110-02-73	1.000 EACH	_____.	_____.
0200	619.1000 Mobilization	1.000 EACH	_____.	_____.
0202	624.0100 Water	10.000 MGAL	_____.	_____.
0204	625.0105 Topsoil	620.000 CY	_____.	_____.
0206	625.0500 Salvaged Topsoil	45,978.000 SY	_____.	_____.
0208	627.0200 Mulching	50,332.000 SY	_____.	_____.
0210	628.1104 Erosion Bales	105.000 EACH	_____.	_____.
0212	628.1504 Silt Fence	500.000 LF	_____.	_____.



Proposal Schedule of Items

Proposal ID: 20180313040 Project(s): 8110-02-73

Federal ID(s): N/A

SECTION: 0001 Contract Items

Alt Set ID: Alt Mbr ID:

Proposal Line Number	Item ID Description	Approximate Quantity and Units	Unit Price	Bid Amount
0304	632.0201 Shrubs (species) (size) (root) 05. Fragrant Sumac #1 Cont.	43.000 EACH	_____.	_____.
0306	632.0201 Shrubs (species) (size) (root) 06. Junberry #1 Cont.	114.000 EACH	_____.	_____.
0308	632.0201 Shrubs (species) (size) (root) 07. Nannyberry Viburnum #1 Cont.	125.000 EACH	_____.	_____.
0310	632.0201 Shrubs (species) (size) (root) 08. Frost Grape #1 Cont.	115.000 EACH	_____.	_____.
0312	632.0201 Shrubs (species) (size) (root) 09. Prickly Gooseberry #1 Cont.	6.000 EACH	_____.	_____.
0314	632.0201 Shrubs (species) (size) (root) 10. Gray Dogwood #1 Cont.	135.000 EACH	_____.	_____.
0316	632.0201 Shrubs (species) (size) (root) 11. Red Osier Dogwood #1 Cont.	137.000 EACH	_____.	_____.
0318	632.9101 Landscape Planting Surveillance and Care Cycles	2.000 EACH	_____.	_____.
0320	633.5200 Markers Culvert End	44.000 EACH	_____.	_____.
0322	634.0809 Posts Tubular Steel 2x2-Inch X 9.5-FT	57.000 EACH	_____.	_____.
0324	634.0810 Posts Tubular Steel 2x2-Inch X 10-FT	19.000 EACH	_____.	_____.
0326	634.0811 Posts Tubular Steel 2x2-Inch X 11-FT	33.000 EACH	_____.	_____.
0328	634.0812 Posts Tubular Steel 2x2-Inch X 12-FT	11.000 EACH	_____.	_____.
0330	634.0814 Posts Tubular Steel 2x2-Inch X 14-FT	4.000 EACH	_____.	_____.
0332	634.0885 Posts Tubular Steel 2x2-Inch X 8.5-FT	1.000 EACH	_____.	_____.



Proposal Schedule of Items

Proposal ID: 20180313040 Project(s): 8110-02-73

Federal ID(s): N/A

SECTION: 0001 Contract Items

Alt Set ID: Alt Mbr ID:

Proposal Line Number	Item ID Description	Approximate Quantity and Units	Unit Price	Bid Amount
0334	637.2210 Signs Type II Reflective H	403.790 SF	_____.	_____.
0336	637.2230 Signs Type II Reflective F	193.880 SF	_____.	_____.
0338	638.2102 Moving Signs Type II	4.000 EACH	_____.	_____.
0340	638.2602 Removing Signs Type II	36.000 EACH	_____.	_____.
0342	638.3000 Removing Small Sign Supports	37.000 EACH	_____.	_____.
0344	642.5201 Field Office Type C	1.000 EACH	_____.	_____.
0346	643.0300 Traffic Control Drums	7,700.000 DAY	_____.	_____.
0348	643.0420 Traffic Control Barricades Type III	1,040.000 DAY	_____.	_____.
0350	643.0705 Traffic Control Warning Lights Type A	1,920.000 DAY	_____.	_____.
0352	643.0715 Traffic Control Warning Lights Type C	720.000 DAY	_____.	_____.
0354	643.0900 Traffic Control Signs	4,800.000 DAY	_____.	_____.
0356	643.5000 Traffic Control	1.000 EACH	_____.	_____.
0358	645.0120 Geotextile Type HR	235.000 SY	_____.	_____.
0360	645.0130 Geotextile Type R	40.000 SY	_____.	_____.
0362	646.1020 Marking Line Epoxy 4-Inch	33,971.000 LF	_____.	_____.
0364	646.3020 Marking Line Epoxy 8-Inch	318.000 LF	_____.	_____.
0366	646.5020 Marking Arrow Epoxy	23.000 EACH	_____.	_____.



Proposal Schedule of Items

Proposal ID: 20180313040 Project(s): 8110-02-73

Federal ID(s): N/A

SECTION: 0001 Contract Items

Alt Set ID: Alt Mbr ID:

Proposal Line Number	Item ID Description	Approximate Quantity and Units	Unit Price	Bid Amount
0458	SPV.0060 Special 11. Traffic Control Removing Sign Covers	4.000 EACH	_____.	_____.
0460	SPV.0075 Special 01. Polyethylene Sheeting Mobilization	25.000 HRS	_____.	_____.
0462	SPV.0085 Special 01. Infiltration Basin Seeding	21.000 LB	_____.	_____.
0464	SPV.0090 Special 01. Pedestrian Railing	3,550.000 LF	_____.	_____.
0466	SPV.0090 Special 02. Fence Chain Link Coated 6-FT	230.000 LF	_____.	_____.
0468	SPV.0090 Special 03. Concrete Curb and Gutter Cure and Seal Treatment	3,792.000 LF	_____.	_____.
0470	SPV.0090 Special 04. Safety Fence Maintenance	800.000 LF	_____.	_____.
0472	SPV.0090 Special 05. Cleaning, Grading and Shaping Existing Ditch	50.000 LF	_____.	_____.
0474	SPV.0105 Special 02. Electrical Service Meter Breaker Pedestal Special (MB100)	LS	LUMP SUM	_____.
0476	SPV.0105 Special 03. Electrical Service Meter and Control Panels (CB200)	LS	LUMP SUM	_____.
0478	SPV.0105 Special 03. Picnic Shelter	LS	LUMP SUM	_____.
0480	SPV.0105 Special 04. Electrical Service Meter and Control Panels (CB300)	LS	LUMP SUM	_____.
0482	SPV.0105 Special 05. State Welcome Sign Structure	LS	LUMP SUM	_____.
0484	SPV.0165 Special 01. Anti-Graffiti Coating	4,795.000 SF	_____.	_____.



Proposal Schedule of Items

Proposal ID: 20180313040 Project(s): 8110-02-73

Federal ID(s): N/A

SECTION: 0001 Contract Items

Alt Set ID: Alt Mbr ID:

Proposal Line Number	Item ID Description	Approximate Quantity and Units	Unit Price	Bid Amount
0486	SPV.0165 Special 02. Concrete Sidewalk Cure and Seal Treatment	13,114.000 SF	_____.	_____.
0488	SPV.0180 Special 01. Infiltration Basin Soil Mix	3,807.000 SY	_____.	_____.
0490	SPV.0180 Special 02. 6-Inch Fabric Formed Articulated Concrete Revetment Mat	27.000 SY	_____.	_____.
0492	SPV.0195 Special 01. Limestone Aggregate	387.000 TON	_____.	_____.
0494	SPV.0060 Special 12. Concrete Base Type 1 Modified	2.000 EACH	_____.	_____.
Section: 0001			Total:	_____.
			Total Bid:	_____.

