



Wisconsin Department of Transportation

April 2, 2018

Division of Transportation Systems Development

Bureau of Project Development
4802 Sheboygan Avenue, Rm 601
P O Box 7916
Madison, WI 53707-7916

Telephone: (608) 266-1631
Facsimile (FAX): (608) 266-8459

NOTICE TO ALL CONTRACTORS:

Proposal #09: 3100-07-70 / WISC 2018194
Summit Ave, Village of Dousman
B67-0010 over Bark River
STH 67
Waukesha County

Letting of April 10, 2018

This is Addendum No. 01, which provides for the following:

Special Provisions:

Revised Special Provisions	
Article No.	Description
4	Prosecution and Progress

Schedule of Items:

Added Bid Item Quantities					
Bid Item	Item Description	Unit	Old Quantity	Revised Quantity	Proposal Total
460.5224	HMA Pavement 4 LT 58-28S	TON	0	2,689	2,689
643.0910	Traffic Control Covering Signs Type 1	EACH	0	2	2

Deleted Bid Item Quantities					
Bid Item	Item Description	Unit	Old Quantity	Revised Quantity	Proposal Total
460.5225	HMA Pavement 5 LT 58-28S	TON	2,689	-2,689	0

Plan Sheets:

Revised Plan Sheets	
Plan Sheet	Plan Sheet Title (brief description of changes to sheet)
04	Existing Typical Section: Removing existing underdrain
05	Typical Section: HMA pavement bid item
06	Typical Section: HMA pavement bid item
18	Plan Details: HMA pavement bid item
19	Plan Details: HMA pavement bid item
20	Plan Details: HMA pavement bid item
21	Plan Details: HMA pavement bid item
22	Plan Details: HMA pavement bid item
56	Detour: Added note for covering existing signs
136	MQs: HMA pavement bid item
139	MQs: Added TC covering signs type 1

The responsibility for notifying potential subcontractors and suppliers of these changes remains with the prime contractor.

Sincerely,

Mike Coleman

Proposal Development Specialist
Proposal Management Section

ADDENDUM NO. 01

1300-07-70

April 2, 2018

Special Provisions

4. Prosecution and Progress

*Add the following section after section titled **C Contractor Coordination**:*

Existing Truck Detour Signage

The Engineer shall coordinate the removal of all route signage currently in place for the truck detour on WIS 67. The removal of these signs shall occur within a maximum of 3 calendar days of the full closure of WIS 67 as shown within the plans. Please coordinate with Tom Hydell, SE Region Traffic Engineer at (262) 548-6763 immediately following the per-construction meeting to coordinate the contractor's schedule with WisDOT/County staff for the removal of the truck detour signage.

Schedule of Items

Attached, dated April 2, 2018, are the revised Schedule of Items Pages 1 – 9.

Plan Sheets

The following 8½ x 11-inch sheets are attached and made part of the plans for this proposal:

Revised: 04, 05, 06, 18, 19, 20, 21, 22, 56, 136, 139

END OF ADDENDUM

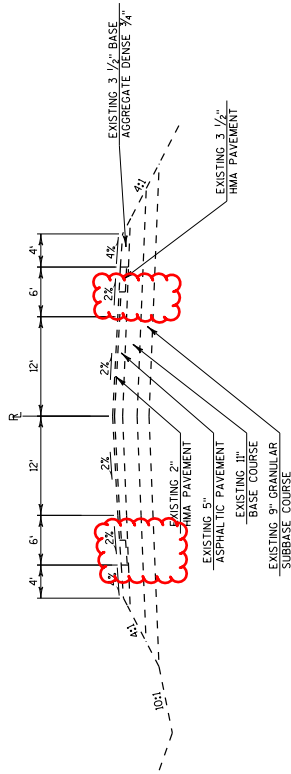

EXISTING TYPICAL SECTION
STH 67

STA 100+00 TO STA 129+25

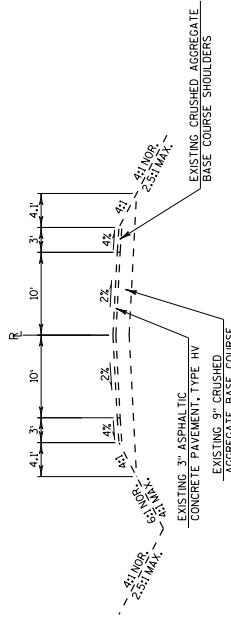

EXISTING TYPICAL SECTION
WHITAKER LANE

STA 10WL+00 TO STA 115WL+86

Addendum No. 01
 ID 3100-07-70
 Revised Sheet 4
 April 2, 2018

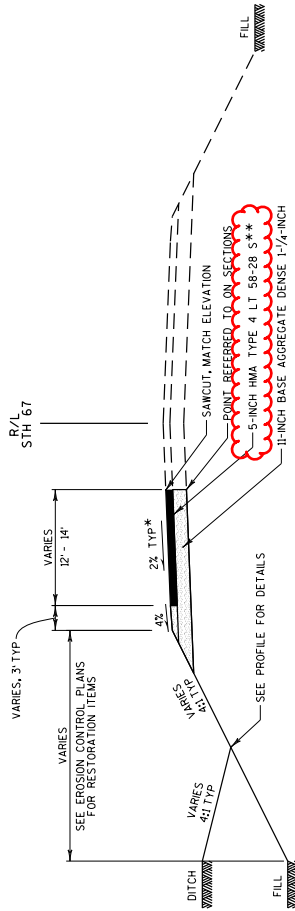

TYPICAL FINISHED SECTION

STH 67

STA 112+65.00 TO STA 114+75.00
 *MATCH ADJACENT CROSS SLOPE
 ** TWO LIFTS OF 2.5-INCH THICKNESS

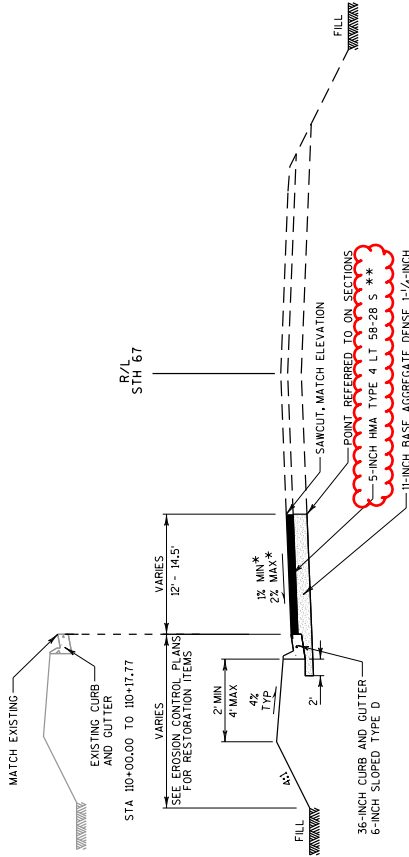

TYPICAL FINISHED SECTION

STH 67

STA 110+00.00 TO STA 112+65.00
 *MATCH ADJACENT CROSS SLOPE
 ** TWO LIFTS OF 2.5-INCH THICKNESS

Addendum No. 01
 ID 3100-07-70
 Revised Sheet 5
 April 2, 2018

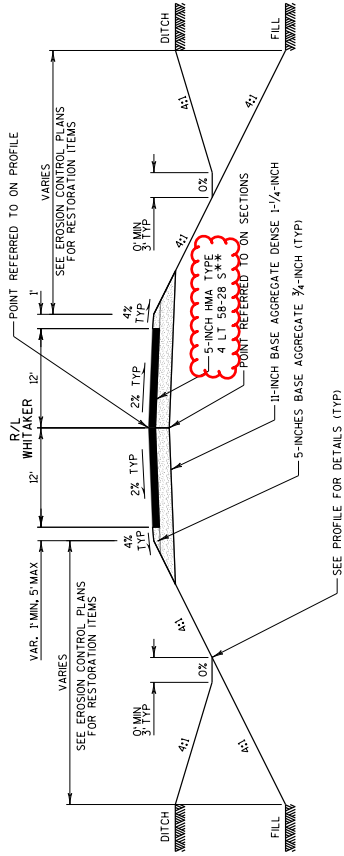

**TYPICAL FINISHED SECTION
WHITAKER ROAD**

STA 10W1+00 TO 13W1+00
 ** TWO LIFTS OF 2.5-INCH THICKNESS

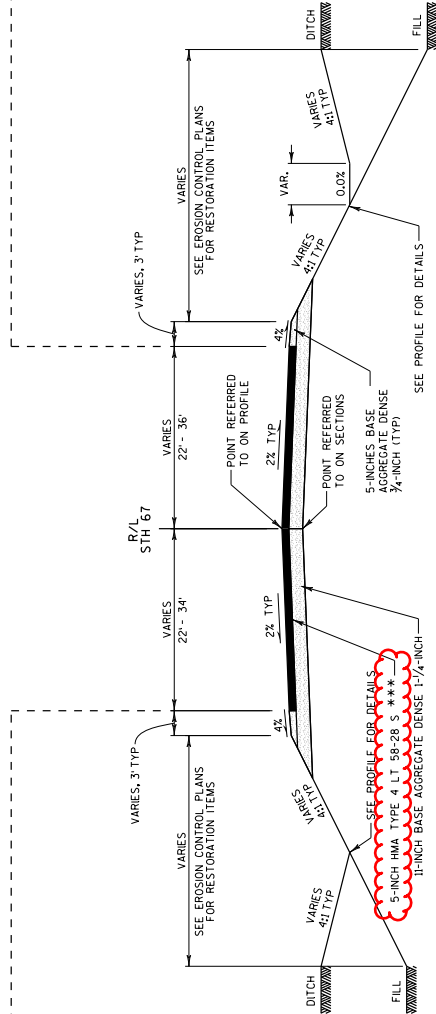

**TYPICAL FINISHED SECTION
STH 67**

STA 112+65.00 TO STA 129+25.00
 *** SEE PLAN DETAILS REGARDING LIMITS OF CONCRETE APPROACH PAVEMENT

**Addendum No. 01
 ID 3100-07-70
 Revised Sheet 6
 April 2, 2018**

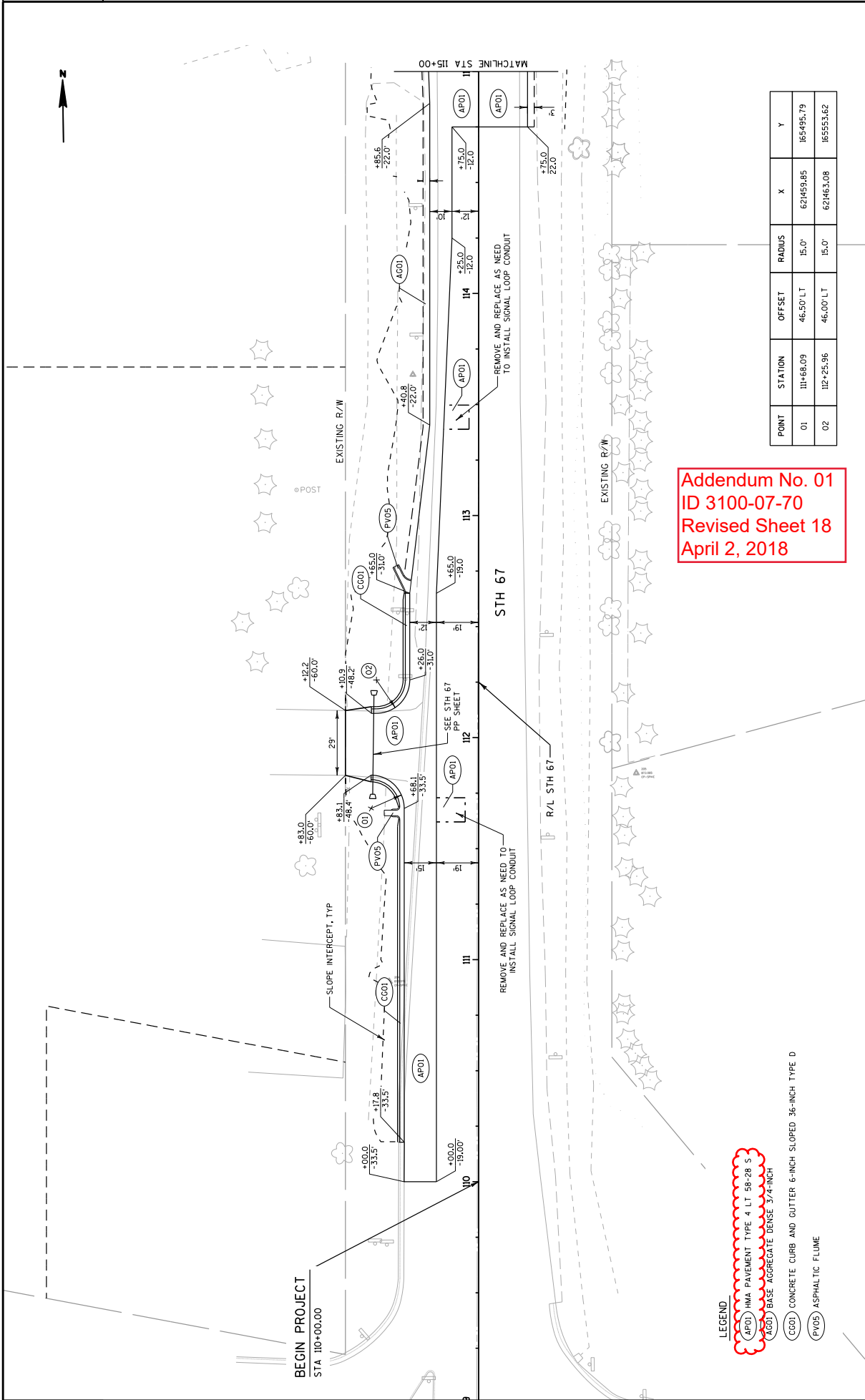

POINT	STATION	OFFSET	RADIUS	X	Y
01	111+68.09	46.50' LT	15.0'	624459.85	855495.79
02	112+25.96	46.00' LT	15.0'	624463.08	855553.62

Addendum No. 01
 ID 3100-07-70
 Revised Sheet 18
 April 2, 2018

- LEGEND**
- AP01 HMA PAVEMENT TYPE 4 LT 58-28 S
 - CC01 CONCRETE CURB AND GUTTER 6-INCH SLOPED 36-INCH TYPE D
 - PV05 ASPHALTIC FLUME

POINT	STATION	OFFSET	RADIUS	X	Y
03	118+35.81	82.00 RT	60.0'	621598.71	166161.81
04	119+45.82	56.00 RT	20.0'	621574.09	166272.14

BEANGUARD SEGMENT 'SBO1'			
BID ITEM	STATION	OFFSET	LF
MGS GUARDRAIL TERMINAL EAT	118+28.70	36.0' LT	53.2'
MGS GUARDRAIL 3	118+81.81	34.0' LT	50.0'
MGS THREE BEAM TRANSITION	119+31.81	34.0' LT	39.4'

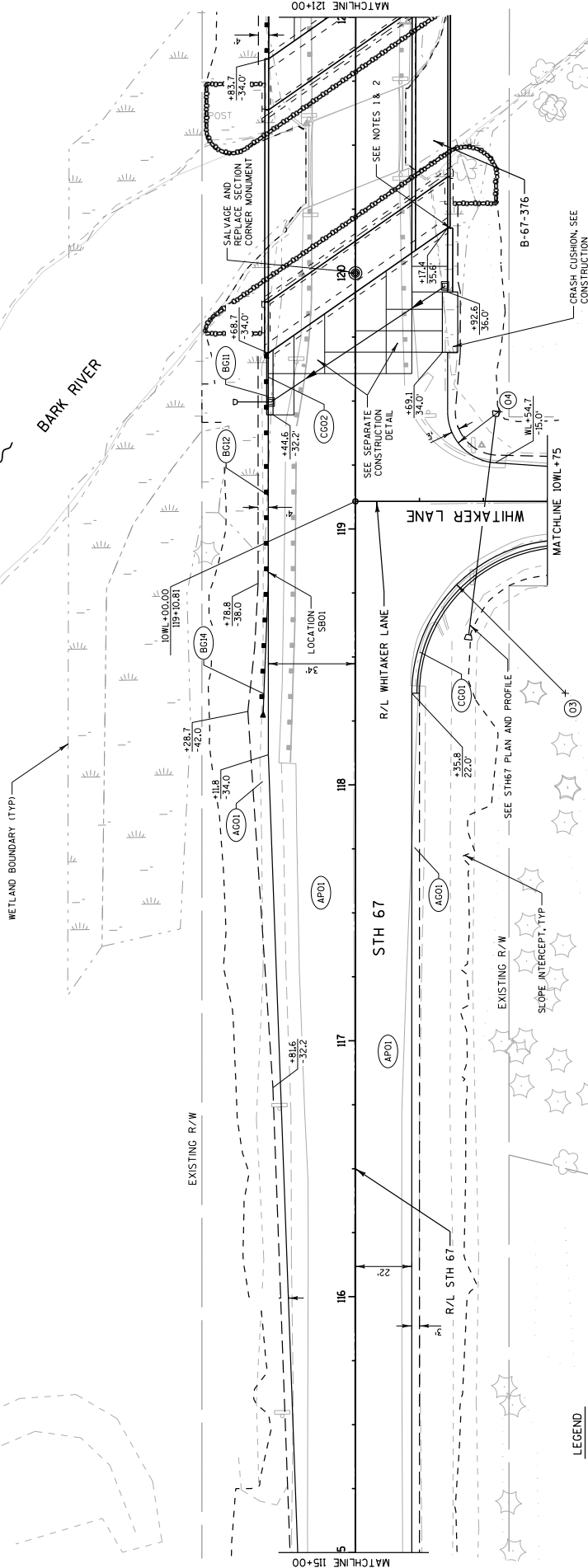

Addendum No. 01
ID 3100-07-70
Revised Sheet 19
April 2, 2018

- LEGEND**
- (AP01) HMA PAVEMENT TYPE 4 LT 58-28 S
 - (AC01) BASE AGGREGATE DENSE 3/4-INCH
 - (BC01) MGS THREE BEAM TRANSITION
 - (BC02) MGS GUARDRAIL 3
 - (BC03) MGS TERMINAL EAT
 - (CC01) CONCRETE CURB AND GUTTER 6-INCH SLOPED 36-INCH TYPE D
 - (CC02) CONCRETE CURB AND GUTTER TYPE TBTT 30-INCH
- NOTES**
- 1) PROVIDE 1/2" FILLER MATERIAL BETWEEN BRIDGE PARAPET AND ROADWAY BARRIER. COST INCIDENTAL TO ROADWAY BARRIER.
 - 2) TRANSITION THE FACE OF THE ROADWAY BARRIER TO VERTICAL OVER 10-FEET TO MATCH THE BRIDGE PARAPET. TRANSITION COST INCIDENTAL TO ROADWAY BARRIER.

NOTES

- 1) OMIT THE FOOTING FOR THE SINGLE SLOPE BARRIER OVER THE PROPOSED BRIDGE WINGWALL NO.4.
- 2) PROVIDE 1/2" FILLER MATERIAL BETWEEN BRIDGE PARAPET AND ROADWAY BARRIER. COST INCIDENTAL TO THE ROADWAY BARRIER.
- 3) TRANSITION THE FACE OF THE ROADWAY BARRIER TO VERTICAL OVER 10-FEET TO MATCH THE BRIDGE PARAPET. TRANSITION COST INCIDENTAL TO ROADWAY BARRIER.

BEAMGUARD SEGMENT 'SB02'					
BID ITEM	STATION FROM	OFFSET FROM	STATION TO	OFFSET TO	LF
MGS THREE BEAM TRANSITION	120+81.22	34.0'L	121+20.62	34.0'L	39.4'
MGS GUARDRAIL 3	121+20.62	34.0'L	122+58.02	30.6'L	137.5'
MGS GUARDRAIL TERMINAL EAT	122+58.02	28.7'L	123+118	28.7'L	53.2'

LEGEND

- (APO) HMA PAVEMENT TYPE 4 LT 58-28.5
- (AGC) BASE AGGREGATE DENSE 3/4-INCH
- (BGI) MGS THREE BEAM TRANSITION
- (BG2) MGS GUARDRAIL 3
- (BGT) MGS TERMINAL EAT

Addendum No. 01
 ID 3100-07-70
 Revised Sheet 20
 April 2, 2018

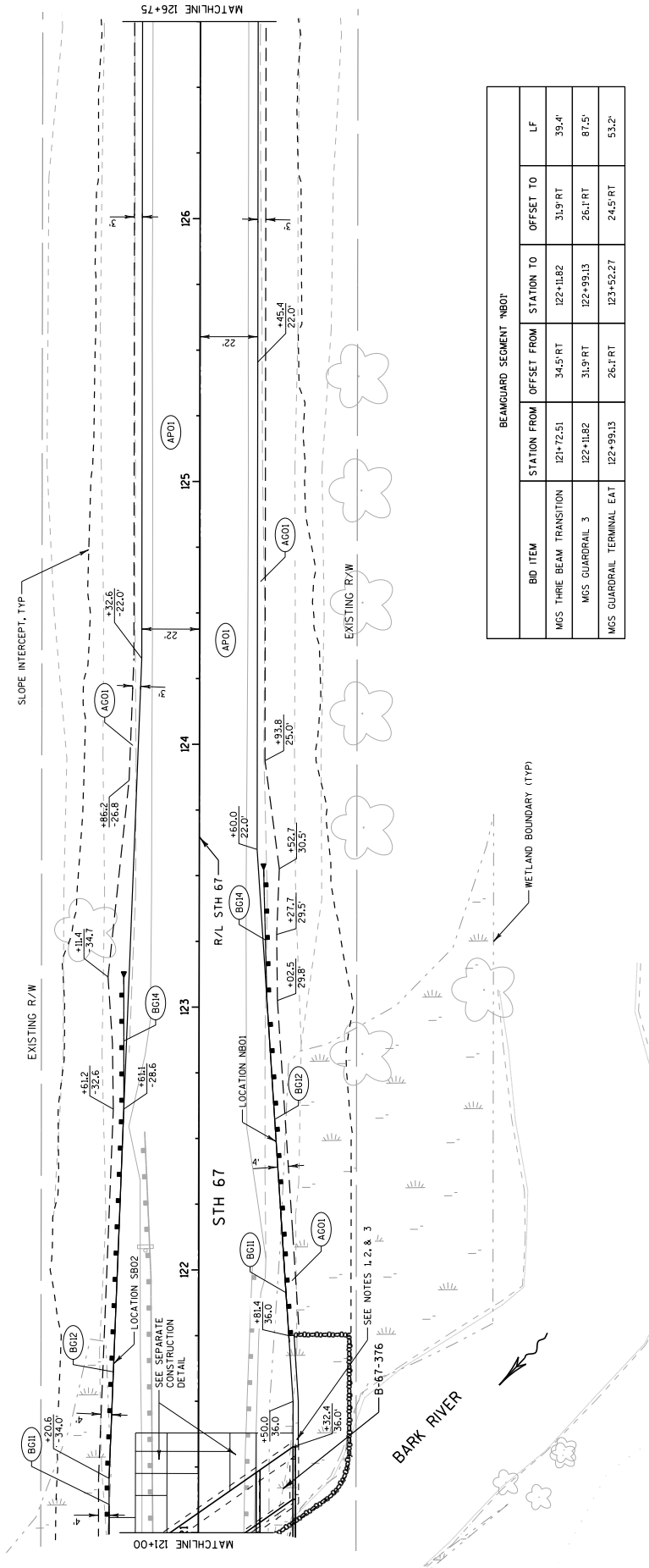

BEAMGUARD SEGMENT 'NB01'					
BID ITEM	STATION FROM	OFFSET FROM	STATION TO	OFFSET TO	LF
MGS THREE BEAM TRANSITION	121+72.51	34.5'RT	122+11.82	31.9'RT	39.4'
MGS GUARDRAIL 3	122+11.82	31.9'RT	122+99.13	26.1'RT	87.5'
MGS GUARDRAIL TERMINAL EAT	122+99.13	26.1'RT	123+52.27	24.5'RT	53.2'



LEGEND

(AP01) HMA PAVEMENT TYPE 4 LT 58-28 S

(AG01) BASE AGGREGATE DENSE 3/4-INCH

(DR06) ASPHALTIC SURFACE DRIVEWAYS AND FIELD ENTRANCES, 3-INCH

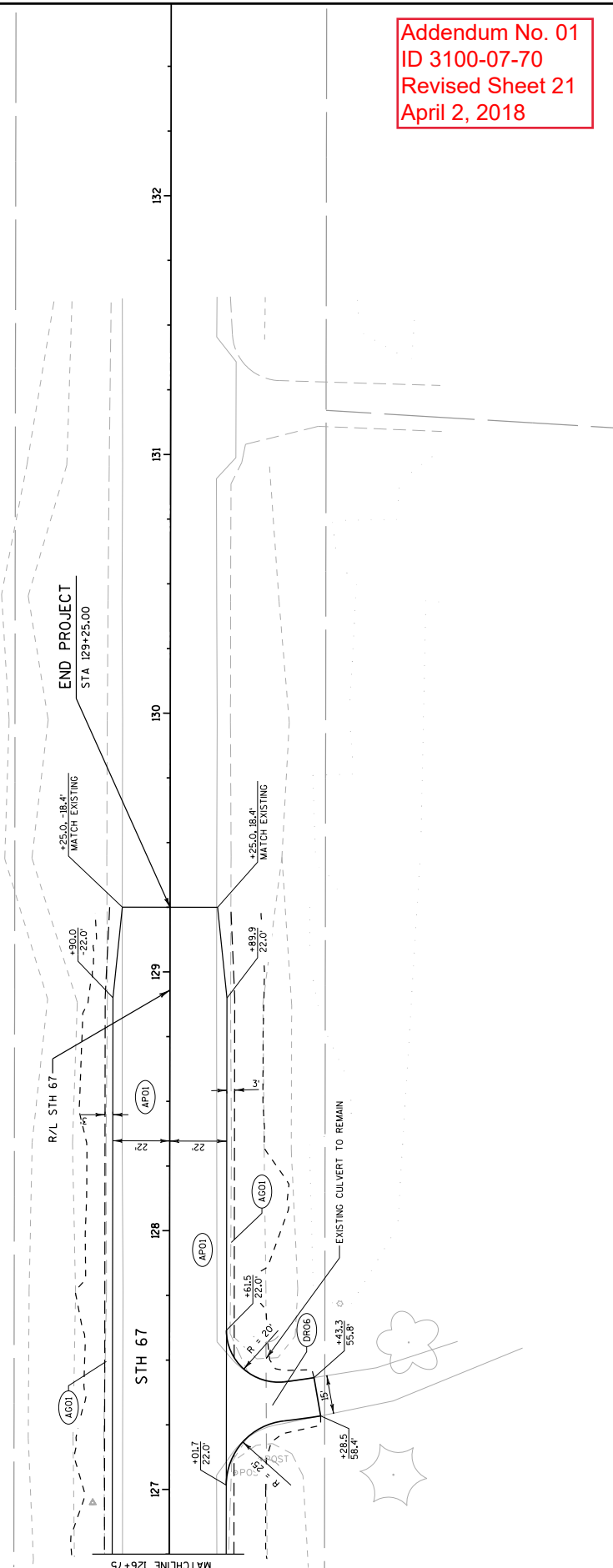

PROJECT NO: 3100-07-70

HWY: STH 67

COUNTY: WAUKESHA

PLAN DETAILS

SHEET 21

E

FILE NAME : \\m11400\lrg\proj\66224\MO1101\1\cbs\021204.LPD.dgn

PLOT DATE : 3/27/2018

FLOT BY : Grossemyer

PLOT SCALE : 40:1

WISDOT/CADD SHEET 42



Addendum No. 01
ID 3100-07-70
Revised Sheet 22
April 2, 2018

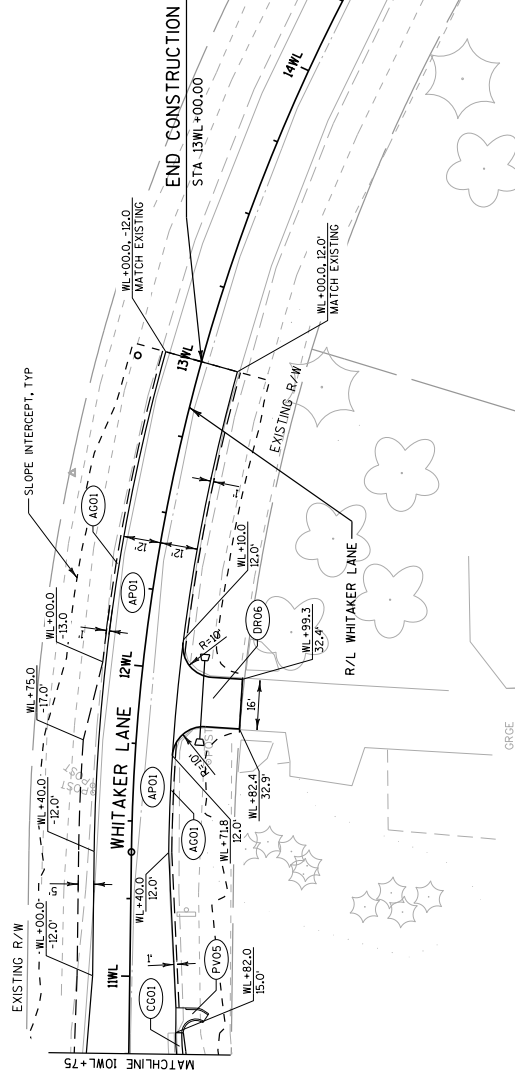

- LEGEND**
- (AP01) HMA PAVEMENT TYPE 4 LT 58-28 S
 - (AC01) BASE AGGREGATE DENSE 3/4-INCH
 - (BO1) MGS THREE BEAM TRANSITION
 - (BO2) MGS GUARDRAIL 3
 - (BO3) MGS TERMINAL EAT
 - (CO01) CONCRETE CURB AND GUTTER 6-INCH SLOPED 36-INCH TYPE D
 - (DR06) ASPHALTIC SURFACE DRIVEWAYS AND FIELD ENTRANCES, 3-INCH
 - (PV05) ASPHALTIC FLUME

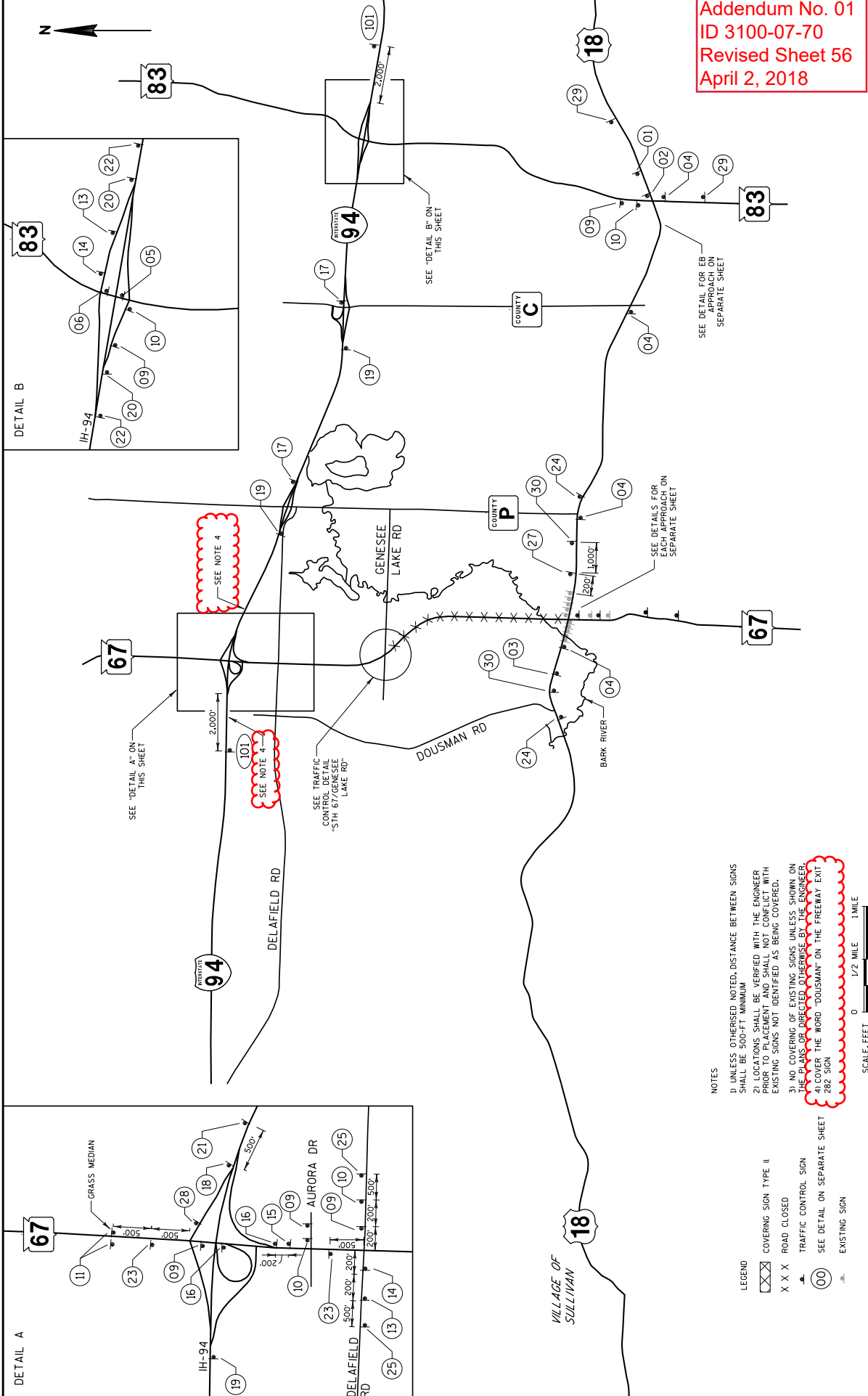

Addendum No. 01
 ID 3100-07-70
 Revised Sheet 56
 April 2, 2018

DETAIL B

DETAIL A

- NOTES
- 1) UNLESS OTHERWISE NOTED, DISTANCE BETWEEN SIGNS SHALL BE 500-FT. MINIMUM
 - 2) LOCATIONS SHALL BE VERIFIED WITH THE ENGINEER PRIOR TO PLACEMENT AND SHALL NOT CONFLICT WITH EXISTING SIGNS NOT IDENTIFIED AS BEING COVERED.
 - 3) NO COVERING OF EXISTING SIGNS UNLESS SHOWN ON THE PLAN OR INDICATED OTHERWISE BY THE ENGINEER
 - 4) COVER THE WORD "DOUSMAN" ON THE FREEMWAY EXIT 282 SIGN

- LEGEND
- XX X ROAD CLOSED
 - ▲ TRAFFIC CONTROL SIGN
 - SEE DETAIL ON SEPARATE SHEET
 - ▲ EXISTING SIGN

SCALE, FEET
 0 1/2 MILE 1 MILE

PROJECT NO: 3100-07-70	COUNTY: WAUKESHA	TRAFFIC CONTROL DETOUR	SHEET 56
HWY: STH 67		PLOT BY: crassemyer	
FILE NAME: \\m11400\ingr\proj\66224\WD10\11\cbs\027001.dwg		PLOT DATE: 3/28/2018	
		PLOT SCALE: 4800:1	

HMA PAVEMENT
460.5224
HMA PAVEMENT
4 LT 58+28 S

455.0605		465.0120		465.0425		465.0475	
TACK COAT		ASPHALTIC SURFACE DRIVEWAYS AND FIELD ENTRANCES		ASPHALTIC SHOULDER RUMBLE STRIPS 2-LANE RURAL		ASPHALTIC CENTERLINE RUMBLE STRIPS 2-LANE RURAL	
ROADWAY	STATION	FROM	TO	TON	LF	TON	LF
STH 67	L/RT	110+00	119+69	--	--	--	--
STH 67	L/RT	121+10	129+25	1,093	--	--	--
STH 67	RT	127+02	127+62	1,312	--	--	--
STH 67	RT	110+46	117+11	16	136	--	--
STH 67	L/RT	114+25	117+11	--	--	286	--
STH 67	LT	114+25	119+45	--	--	--	--
STH 67	LT	121+06	129+25	--	820	--	--
STH 67	L/RT	121+63	129+25	--	--	762	--
STH 67	RT	123+60	129+25	--	565	--	--
WHITAKER	L/RT	10WL+25	13WL+00	284	--	--	--
WHITAKER	RT	11WL+72	12WL+10	2	--	--	--
PROJECT 3100-07-70 TOTAL				2,689	2,041	1,048	

Addendum No. 01
ID 3100-07-70
Revised Sheet 136
April 2, 2018

CRASH CUSHION

614.0800		603.1132		606.0200		606.0300		645.0120	
CRASH CUSHION PERMANENT		CONCRETE BARRIER		RIPRAP MEDIUM		RIPRAP HEAVY		GEOTEXTILE FABRIC	
ROADWAY	STATION	OFFSET	TYPE	ROADWAY	STATION	OFFSET	GRADE 1	TON	TYPE HR
STH 67	119+92.6	36.0' RT	S32	STH 67	112+77	LT	---	---	---
PROJECT 3100-07-70 TOTAL				STH 67	119+50	LT	---	3	10
				STH 67	119+50	RT	---	4	14
				STH 67	121+32 - 121+81	RT	---	2	7
				STH 67	10+87	RT	---	48	117
				UNISTRIBUTED (DEFINING NEW STREAM BOTTOM)		---	---	---	---
				UNISTRIBUTED (SETTLING BASIN)		---	---	56	70
				UNISTRIBUTED (ROCK/STONE DITCH CHECKS)		---	---	---	---
PROJECT 3100-07-70 TOTAL				37	56	11	---	48	245

CURB & GUTTER AND BARRIER ITEMS

601.0557		601.0586		603.1132	
CONCRETE CURB AND GUTTER		CONCRETE CURB AND GUTTER		CONCRETE BARRIER	
ROADWAY	STATION	OFFSET	TYPE	ROADWAY	STATION
STH 67	110+17.80	-	36-INCH TYPE B	STH 67	110+17.80
STH 67	112+10.90	-	4-INCH SLOPED	STH 67	112+10.90
STH 67	119+44.60	-	30-INCH TYPE B/T	STH 67	119+44.60
STH 67	119+92.60	-	---	STH 67	119+92.60
STH 67	121+32.40	-	---	STH 67	121+32.40
STH 67/WHITAKER	118+35.80	-	---	STH 67/WHITAKER	118+35.80
PROJECT 3100-07-70 TOTAL			25	PROJECT 3100-07-70 TOTAL	

PROJECT NO: 3100-07-70
COUNTY: WAUKESHA
HWY: STH 67

MISCELLANEOUS QUANTITIES

SHEET: 136

TRAFFIC CONTROL ITEMS

ROADWAY	DURATION DAYS	TRAFFIC CONTROL (3100-07-70)	EACH	DAYS	TRAFFIC CONTROL BARICADES TYPE II	EACH	DAYS	TRAFFIC CONTROL WARNING LIGHTS TYPE A	EACH	DAYS	TRAFFIC CONTROL WARNING LIGHTS TYPE C	EACH	DAYS	TRAFFIC CONTROL COVERING SIGNS TYPE I	EACH	DAYS	TRAFFIC CONTROL COVERING SIGNS TYPE II	EACH	DAYS	TRAFFIC CONTROL SIGNS POMS	EACH	DAYS
PRECONSTRUCTION	7																					
STH 67/ WIS 18 INTERSECTION	120		34	4,080		6	720	10	1,200		12	1,440	4	480		1	11				4	28
WHITAKER LANE	120					4	480			8	960											
STH 67 NORTH CONSTRUCTION LIMITS	120					5	600			10	1,200	3	360									
STH 67/GENESSE LAKE RD INTERSECTION	120					6	720			12	1,440	18	2,160									
STH 67/GRIFFITH RD INTERSECTION	120					6	720			12	1,440	9	1,080									
DETOUR SIGNAGE	120											226	27,120									
WATERWAY DETOUR	120					3	360					3	360									
UNDISTRIBUTED	120		1	200			160				320		1,570									50
PROJECT 3100-07-70 TOTAL			1	4,280		3,760	1,200	6,800			33,370		27									78

643.0910 TRAFFIC CONTROL COVERING SIGNS TYPE I

* PROVIDED FOR INFORMATION ONLY

CONCRETE BARRIER

ROADWAY	STATION	OFFSET	DELIVERED LF	TEMPORARY PRECAST INSTALLED LF
STH 67	120+60	RT	25	25
STH 67	121+30	RT	33	33
PROJECT 3100-07-70 TOTAL				
			58	58

FIELD FACILITY

ROADWAY	TYPE C EACH
PROJECT 3100-07-70	1
PROJECT 3100-07-70 TOTAL	1

Addendum No. 01
ID 3100-07-70
Revised Sheet 139
April 2, 2018

PAVEMENT MARKINGS

ROADWAY	MARKING LINE	OFFSET	LENGTH LF	MARKING WORDS	LENGTH LF	MARKING STOP LINE	LENGTH LF	MARKING REMOVAL	LENGTH LF
646.1020	MARKING LINE GROOVED PERMANENT TAPE 8-INCH		646.3020	MARKING WORDS EPOXY	646.5120	MARKING STOP LINE EPOXY 18-INCH	646.6120	MARKING REMOVAL LINE WATER BLASTING 4-INCH	646.9010
	MARKING LINE REFLECTIVE EPOXY 4-INCH	2/8'		MARKING WORDS EPOXY		MARKING STOP LINE EPOXY 18-INCH		MARKING REMOVAL LINE WATER BLASTING 4-INCH	
	MARKING LINE EPOXY 4-INCH	3/7.9'		MARKING WORDS EPOXY		MARKING STOP LINE EPOXY 18-INCH		MARKING REMOVAL LINE WATER BLASTING 4-INCH	
	MARKING LINE (WHITE) (YELLOW) (WHITE) (WHITE) (WHITE) (WHITE)			MARKING WORDS EPOXY		MARKING STOP LINE EPOXY 18-INCH		MARKING REMOVAL LINE WATER BLASTING 4-INCH	
PROJECT 3100-07-70									
STH 67			114		2				260
WHITAKER LANE			121						
PROJECT 3100-07-70 TOTAL			121		2				260

ALL ITEMS ON THIS SHEET ARE CATEGORY 0020



Proposal Schedule of Items

Proposal ID: 20180410009 Project(s): 3100-07-70

Federal ID(s): WISC 2018194

SECTION: 0001 Contract Items

Alt Set ID: Alt Mbr ID:

Proposal Line Number	Item ID Description	Approximate Quantity and Units	Unit Price	Bid Amount
0002	108.4400 CPM Progress Schedule	1.000 EACH	_____.	_____.
0004	201.0105 Clearing	1.500 STA	_____.	_____.
0006	201.0205 Grubbing	1.500 STA	_____.	_____.
0008	203.0100 Removing Small Pipe Culverts	5.000 EACH	_____.	_____.
0010	204.0150 Removing Curb & Gutter	363.000 LF	_____.	_____.
0012	204.9105.S Removing (item description) 01. Loop Detector Wire & Lead-in Cable	LS	LUMP SUM	_____.
0014	205.0100 Excavation Common	3,356.000 CY	_____.	_____.
0016	206.1000 Excavation for Structures Bridges (structure) 01. B-67-376	LS	LUMP SUM	_____.
0018	209.1500 Backfill Granular Grade 1	37.000 TON	_____.	_____.
0020	210.1500 Backfill Structure Type A	414.000 TON	_____.	_____.
0022	213.0100 Finishing Roadway (project) 01. 3100-07-70	1.000 EACH	_____.	_____.
0024	305.0110 Base Aggregate Dense 3/4-Inch	338.000 TON	_____.	_____.
0026	305.0120 Base Aggregate Dense 1 1/4-Inch	6,932.000 TON	_____.	_____.
0028	415.0080 Concrete Pavement 8-Inch	146.000 SY	_____.	_____.
0030	415.0410 Concrete Pavement Approach Slab	318.000 SY	_____.	_____.
0032	440.4410 Incentive IRI Ride	965.000 DOL	1.00000	965.00



Proposal Schedule of Items

Proposal ID: 20180410009 Project(s): 3100-07-70

Federal ID(s): WISC 2018194

SECTION: 0001 Contract Items

Alt Set ID: Alt Mbr ID:

Proposal Line Number	Item ID Description	Approximate Quantity and Units	Unit Price	Bid Amount
0034	455.0605 Tack Coat	616.000 GAL	_____.	_____.
0036	460.2000 Incentive Density HMA Pavement	2,160.000 DOL	1.00000	2,160.00
0040	465.0120 Asphaltic Surface Driveways and Field Entrances	24.000 TON	_____.	_____.
0042	465.0315 Asphaltic Flumes	21.000 SY	_____.	_____.
0044	465.0425 Asphaltic Shoulder Rumble Strips 2-Lane Rural	2,041.000 LF	_____.	_____.
0046	465.0475 Asphalt Centerline Rumble Strips 2-Lane Rural	1,048.000 LF	_____.	_____.
0048	502.0100 Concrete Masonry Bridges	624.000 CY	_____.	_____.
0050	502.3200 Protective Surface Treatment	942.000 SY	_____.	_____.
0052	502.3210 Pigmented Surface Sealer	104.000 SY	_____.	_____.
0054	503.0137 Prestressed Girder Type I 36W-Inch	584.000 LF	_____.	_____.
0056	505.0400 Bar Steel Reinforcement HS Structures	12,230.000 LB	_____.	_____.
0058	505.0600 Bar Steel Reinforcement HS Coated Structures	76,060.000 LB	_____.	_____.
0060	505.0800.S Bar Steel Reinforcement HS Stainless Structures	2,480.000 LB	_____.	_____.
0062	506.2605 Bearing Pads Elastomeric Non-Laminated	16.000 EACH	_____.	_____.
0064	506.4000 Steel Diaphragms (structure) 01. B-67-376	7.000 EACH	_____.	_____.



Proposal Schedule of Items

Proposal ID: 20180410009 Project(s): 3100-07-70

Federal ID(s): WISC 2018194

SECTION: 0001 Contract Items

Alt Set ID: Alt Mbr ID:

Proposal Line Number	Item ID Description	Approximate Quantity and Units	Unit Price	Bid Amount
0066	513.4056 Railing Tubular Type H (structure) 01. B-67-376	115.000 LF	_____.	_____.
0068	516.0500 Rubberized Membrane Waterproofing	37.000 SY	_____.	_____.
0070	521.3112 Culvert Pipe Corrugated Steel 12-Inch	32.000 LF	_____.	_____.
0072	522.0118 Culvert Pipe Reinforced Concrete Class III 18-Inch	88.000 LF	_____.	_____.
0074	522.0412 Culvert Pipe Reinforced Concrete Class IV 12-Inch	50.000 LF	_____.	_____.
0076	522.1012 Apron Endwalls for Culvert Pipe Reinforced Concrete 12-Inch	3.000 EACH	_____.	_____.
0078	522.1018 Apron Endwalls for Culvert Pipe Reinforced Concrete 18-Inch	2.000 EACH	_____.	_____.
0080	550.0500 Pile Points	50.000 EACH	_____.	_____.
0082	550.2106 Piling CIP Concrete 10 3/4 X 0.365-Inch	5,500.000 LF	_____.	_____.
0084	601.0557 Concrete Curb & Gutter 6-Inch Sloped 36-Inch Type D	324.000 LF	_____.	_____.
0086	601.0586 Concrete Curb & Gutter 4-Inch Sloped 30-Inch Type TBTT	25.000 LF	_____.	_____.
0088	603.1132 Concrete Barrier Type S32	75.000 LF	_____.	_____.
0090	603.8000 Concrete Barrier Temporary Precast Delivered	58.000 LF	_____.	_____.
0092	603.8125 Concrete Barrier Temporary Precast Installed	58.000 LF	_____.	_____.



Proposal Schedule of Items

Proposal ID: 20180410009 Project(s): 3100-07-70

Federal ID(s): WISC 2018194

SECTION: 0001 Contract Items

Alt Set ID: Alt Mbr ID:

Proposal Line Number	Item ID Description	Approximate Quantity and Units	Unit Price	Bid Amount
0094	606.0100 Riprap Light	56.000 CY	_____.	_____.
0096	606.0200 Riprap Medium	11.000 CY	_____.	_____.
0098	606.0300 Riprap Heavy	356.000 CY	_____.	_____.
0100	608.0318 Storm Sewer Pipe Reinforced Concrete Class III 18-Inch	98.000 LF	_____.	_____.
0102	611.0654 Inlet Covers Type V	2.000 EACH	_____.	_____.
0104	611.3230 Inlets 2x3-FT	2.000 EACH	_____.	_____.
0106	612.0406 Pipe Underdrain Wrapped 6-Inch	251.000 LF	_____.	_____.
0108	614.0150 Anchor Assemblies for Steel Plate Beam Guard	4.000 EACH	_____.	_____.
0110	614.0800 Crash Cushions Permanent	1.000 EACH	_____.	_____.
0112	614.0920 Salvaged Rail	624.000 LF	_____.	_____.
0114	614.0925 Salvaged Guardrail End Treatments	4.000 EACH	_____.	_____.
0116	614.2300 MGS Guardrail 3	276.000 LF	_____.	_____.
0118	614.2500 MGS Thrie Beam Transition	117.000 LF	_____.	_____.
0120	614.2610 MGS Guardrail Terminal EAT	3.000 EACH	_____.	_____.
0122	616.0600.S Fence Temporary	50.000 LF	_____.	_____.
0124	618.0100 Maintenance And Repair of Haul Roads (project) 01. 3100-07-70	1.000 EACH	_____.	_____.



Proposal Schedule of Items

Proposal ID: 20180410009 Project(s): 3100-07-70

Federal ID(s): WISC 2018194

SECTION: 0001 Contract Items

Alt Set ID: Alt Mbr ID:

Proposal Line Number	Item ID Description	Approximate Quantity and Units	Unit Price	Bid Amount
0126	619.1000 Mobilization	1.000 EACH	_____.	_____.
0128	624.0100 Water	138.000 MGAL	_____.	_____.
0130	625.0500 Salvaged Topsoil	4,183.000 SY	_____.	_____.
0132	627.0200 Mulching	418.000 SY	_____.	_____.
0134	628.1104 Erosion Bales	20.000 EACH	_____.	_____.
0136	628.1504 Silt Fence	1,186.000 LF	_____.	_____.
0138	628.1520 Silt Fence Maintenance	1,186.000 LF	_____.	_____.
0140	628.1905 Mobilizations Erosion Control	4.000 EACH	_____.	_____.
0142	628.1910 Mobilizations Emergency Erosion Control	4.000 EACH	_____.	_____.
0144	628.2006 Erosion Mat Urban Class I Type A	3,301.000 SY	_____.	_____.
0146	628.2027 Erosion Mat Class II Type C	881.000 SY	_____.	_____.
0148	628.7005 Inlet Protection Type A	2.000 EACH	_____.	_____.
0150	628.7020 Inlet Protection Type D	2.000 EACH	_____.	_____.
0152	628.7504 Temporary Ditch Checks	140.000 LF	_____.	_____.
0154	628.7515.S Stone or Rock Ditch Checks	15.000 CY	_____.	_____.
0156	628.7570 Rock Bags	24.000 EACH	_____.	_____.
0158	629.0210 Fertilizer Type B	2.700 CWT	_____.	_____.



Proposal Schedule of Items

Proposal ID: 20180410009 Project(s): 3100-07-70

Federal ID(s): WISC 2018194

SECTION: 0001 Contract Items

Alt Set ID: Alt Mbr ID:

Proposal Line Number	Item ID Description	Approximate Quantity and Units	Unit Price	Bid Amount
0160	630.0120 Seeding Mixture No. 20	90.000 LB	_____.	_____.
0162	630.0160 Seeding Mixture No. 60	23.000 LB	_____.	_____.
0164	630.0200 Seeding Temporary	100.000 LB	_____.	_____.
0166	633.5200 Markers Culvert End	4.000 EACH	_____.	_____.
0168	634.0616 Posts Wood 4x6-Inch X 16-FT	6.000 EACH	_____.	_____.
0170	634.0618 Posts Wood 4x6-Inch X 18-FT	10.000 EACH	_____.	_____.
0172	634.0810 Posts Tubular Steel 2x2-Inch X 10-FT	3.000 EACH	_____.	_____.
0174	637.2210 Signs Type II Reflective H	1.000 SF	_____.	_____.
0176	637.2230 Signs Type II Reflective F	12.000 SF	_____.	_____.
0178	638.2102 Moving Signs Type II	6.000 EACH	_____.	_____.
0180	638.2602 Removing Signs Type II	24.000 EACH	_____.	_____.
0182	638.3000 Removing Small Sign Supports	46.000 EACH	_____.	_____.
0184	642.5201 Field Office Type C	1.000 EACH	_____.	_____.
0186	643.0300 Traffic Control Drums	4,280.000 DAY	_____.	_____.
0188	643.0420 Traffic Control Barricades Type III	3,760.000 DAY	_____.	_____.
0190	643.0705 Traffic Control Warning Lights Type A	1,200.000 DAY	_____.	_____.
0192	643.0715 Traffic Control Warning Lights Type C	6,800.000 DAY	_____.	_____.



Proposal Schedule of Items

Proposal ID: 20180410009 Project(s): 3100-07-70

Federal ID(s): WISC 2018194

SECTION: 0001 Contract Items

Alt Set ID: Alt Mbr ID:

Proposal Line Number	Item ID Description	Approximate Quantity and Units	Unit Price	Bid Amount
0194	643.0900 Traffic Control Signs	33,370.000 DAY	_____.	_____.
0196	643.0920 Traffic Control Covering Signs Type II	27.000 EACH	_____.	_____.
0198	643.1000 Traffic Control Signs Fixed Message	175.600 SF	_____.	_____.
0200	643.1050 Traffic Control Signs PCMS	78.000 DAY	_____.	_____.
0202	643.5000 Traffic Control	1.000 EACH	_____.	_____.
0204	645.0111 Geotextile Type DF Schedule A	154.000 SY	_____.	_____.
0206	645.0120 Geotextile Type HR	838.000 SY	_____.	_____.
0208	646.1020 Marking Line Epoxy 4-Inch	2,624.000 LF	_____.	_____.
0210	646.1040 Marking Line Grooved Wet Ref Epoxy 4-Inch	3,119.000 LF	_____.	_____.
0212	646.3020 Marking Line Epoxy 8-Inch	168.000 LF	_____.	_____.
0214	646.3050 Marking Line Grooved Permanent Tape 8-Inch	121.000 LF	_____.	_____.
0216	646.5020 Marking Arrow Epoxy	2.000 EACH	_____.	_____.
0218	646.5120 Marking Word Epoxy	2.000 EACH	_____.	_____.
0220	646.6120 Marking Stop Line Epoxy 18-Inch	36.000 LF	_____.	_____.
0222	646.9010 Marking Removal Line Water Blasting 4-Inch	260.000 LF	_____.	_____.
0224	650.4000 Construction Staking Storm Sewer	3.000 EACH	_____.	_____.



Proposal Schedule of Items

Proposal ID: 20180410009 Project(s): 3100-07-70

Federal ID(s): WISC 2018194

SECTION: 0001 Contract Items

Alt Set ID: Alt Mbr ID:

Proposal Line Number	Item ID Description	Approximate Quantity and Units	Unit Price	Bid Amount
0226	650.4500 Construction Staking Subgrade	2,158.000 LF	_____.	_____.
0228	650.5000 Construction Staking Base	2,158.000 LF	_____.	_____.
0230	650.5500 Construction Staking Curb Gutter and Curb & Gutter	325.000 LF	_____.	_____.
0232	650.6000 Construction Staking Pipe Culverts	4.000 EACH	_____.	_____.
0234	650.6500 Construction Staking Structure Layout (structure) 01. B-67-376	LS	LUMP SUM	_____.
0236	650.7000 Construction Staking Concrete Pavement	125.000 LF	_____.	_____.
0238	650.8500 Construction Staking Electrical Installations (project) 01. 3100-07-70	LS	LUMP SUM	_____.
0240	650.9910 Construction Staking Supplemental Control (project) 01. 3100-07-70	LS	LUMP SUM	_____.
0242	650.9920 Construction Staking Slope Stakes	2,158.000 LF	_____.	_____.
0244	652.0225 Conduit Rigid Nonmetallic Schedule 40 2-Inch	377.000 LF	_____.	_____.
0246	652.0800 Conduit Loop Detector	62.000 LF	_____.	_____.
0248	653.0135 Pull Boxes Steel 24x36-Inch	2.000 EACH	_____.	_____.
0250	653.0905 Removing Pull Boxes	2.000 EACH	_____.	_____.
0252	655.0700 Loop Detector Lead In Cable	612.000 LF	_____.	_____.
0254	655.0800 Loop Detector Wire	310.000 LF	_____.	_____.



Proposal Schedule of Items

Proposal ID: 20180410009 Project(s): 3100-07-70

Federal ID(s): WISC 2018194

SECTION: 0001 Contract Items

Alt Set ID: Alt Mbr ID:

Proposal Line Number	Item ID Description	Approximate Quantity and Units	Unit Price	Bid Amount
0256	690.0150 Sawing Asphalt	649.000 LF		
0258	715.0415 Incentive Strength Concrete Pavement	3,744.000 DOL	1.00000	3,744.00
0260	715.0502 Incentive Strength Concrete Structures	6,240.000 DOL	1.00000	6,240.00
0262	ASP.1T0A On-the-Job Training Apprentice at \$5.00/HR	900.000 HRS	5.00000	4,500.00
0264	ASP.1T0G On-the-Job Training Graduate at \$5.00/HR	1,000.000 HRS	5.00000	5,000.00
0266	SPV.0035 Special 01. Roadway Embankment	8,863.000 CY		
0268	SPV.0060 Special 02. Section Corner Monument	1.000 EACH		
0270	SPV.0090 Special 01. Salvaging Lane Dividers	370.000 LF		
0272	SPV.0090 Special 02. Heavy Duty Silt Fence	610.000 LF		
0274	SPV.0105 Special 01. Removing Old Structure over Waterway with Approved Method Sta. 120+50	LS	LUMP SUM	
0276	SPV.0180 Special 01. Enhanced Turbidity Barrier	185.000 SY		
0278	SPV.0195 Special 01. Selected Crushed Material for Travel Corridor	124.000 TON		
0280	460.5224 HMA Pavement 4 LT 58-28 S	2,689.000 TON		
0282	643.0910 Traffic Control Covering Signs Type I	2.000 EACH		
Section: 0001			Total:	
			Total Bid:	

