



Wisconsin Department of Transportation

May 2, 2019

Division of Transportation Systems Development

Bureau of Project Development
4822 Madison Yards Way, 4th Floor South
Madison, WI 53705

Telephone: (608) 266-1631
Facsimile (FAX): (608) 266-8459

NOTICE TO ALL CONTRACTORS:

- | | |
|---|--|
| <p>Proposal #51: 1060-33-94, WISC 2019 219
 Zoo IC, Swan & Discovery Rndabt
 1060-33-73 Limits to WDNR
 Access Rd
 Local Street
 Milwaukee County</p> | <p>1060-35-94
 Zoo IC, Swan Blvd Roadway
 Maint
 Underwood Parkway to USH 45
 Local Street
 Milwaukee County</p> |
| <p>1693-37-74, WISC2019 433
 Bike Path B – Hank Aaron
 State Trail
 Hwy 100 to UPRR
 Non Highway
 Milwaukee County</p> | |

Letting of May 14, 2019

This is Addendum No. 01, which provides for the following:

Special Provisions:

Revised Special Provisions	
Article No.	Description
3	Prosecution and Progress
6	Utilities

Schedule of Items:

Revised Bid Item Quantities					
Bid Item	Item Description	Unit	Old Quantity	Revised Quantity	Proposal Total
634.0618	Posts Wood 4x6-Inch x 18-FT	EACH	4	4	8
634.0816	Posts Tubular Steel 2x2-Inch x 16-FT	EACH	94	4	98
637.2210	Signs Type II Reflective H	SF	759.37	63.25	822.62
638.2102	Moving Signs Type II	EACH	3	4	7
638.3000	Removing Small Sign Supports	EACH	15	6	21

Added Bid Item Quantities					
Bid Item	Item Description	Unit	Old Quantity	Revised Quantity	Proposal Total
635.0200	Sign Supports Structural Steel HS	LB	0	1,600	1,600
636.0100	Sign Supports Concrete Masonry	CY	0	2.8	2.8
636.0500	Sign Supports Steel Reinforcing	LB	0	166	166
637.1220	Signs Type I Reflective SH	SF	0	148	148
638.2601	Removing Signs Type I	EACH	0	1	1

Plan Sheets:

Added Plan Sheets – Project ID 1060-33-94	
Plan Sheet	Plan Sheet Title (brief description of why sheet was added)
52A	Backfill Slurry detail for storm sewer (omitted from plan set)

Revised Plan Sheets – Project ID 1693-37-74	
Plan Sheet	Plan Sheet Title (brief description of changes to sheet)
2	General Notes and Utility Contacts (updated utility contacts)
32	Permanent Signing Quantities (additional signs listed)
73	Signing Detail – Type II Signs (sign color clarification added for first two signs)

Added Plan Sheets – Project ID 1693-37-74	
Plan Sheet	Plan Sheet Title (brief description of why sheet was added)
17A-F	Permanent Signing (new signs added to contract)
32A	Permanent Signing Quantities (second sheet needed due to additional signs)
73A-B	Permanent Signing Details (new signs added to contract)

The responsibility for notifying potential subcontractors and suppliers of these changes remains with the prime contractor.

Sincerely,

Mike Coleman

Proposal Development Specialist
Proposal Management Section

ADDENDUM NO. 01

1060-33-94 / 1060-35-94 / 1693-37-74

May 2, 2019

Special Provisions

3. Prosecution and Progress.

Delete the following paragraph:

Do not work next to wetlands on project 1060-33-94 until the Section 404 permit has been approved. The department anticipates approval of this permit Apr11 2019.

6. Utilities.

Replace the entire article with the following:

This contract comes under the provisions of Administrative Rule TRANS 220.

Additional information regarding recently relocated utility facilities may be available on permits issued to the utility companies. These permits can be viewed at the Region Office during normal working hours. Contact WisDOT SE Freeways Utility Coordinator Greg Berry at (414) 750-7828 for further information.

Underground and overhead utility facilities are located within the project limits. Utility adjustments are required for this construction project as noted below. Coordinate construction activities with a call to Diggers Hotline or a direct call to the utilities that have facilities in the area as required per state statute. Use caution to ensure the integrity of underground facilities and maintain code clearances from overhead facilities at all times.

Some utility work, as described below, is dependent on prior work being performed by the contractor at a specific site. Provide the engineer and the affected utility a good faith notice of when the utility is to start work at the site. Notice shall be given 14 to 16 calendar days in advance of when the site will be available to the utility. Follow up with a confirmation notice to the engineer and the utility not less than 3 working days before the site will be ready for the utility to begin its work.

Contact utility companies listed in the plans prior to preparing bids to obtain current information on existing utility locations and the status of any new utility relocation work.

Utility companies will be performing utility work and adjustments within the limits during the life of the project. The contractor shall cooperate and coordinate construction activities with these companies.

There may be discontinued utility facilities within the project limits. If a conflict with a discontinued utility facility is encountered, contact the appropriate utility owner/representative to coordinate construction activities and proper removal and disposal of said facility as necessary.

Utility working days shown herein are as defined in Wisconsin Administrative Code Chapter Trans 220.

Known utilities in the project area are as follows:

Project ID 1060-33-94

AT&T Wisconsin has existing underground and overhead communications facilities within the project limits. Prior to and during construction AT&T Wisconsin will perform the following work:

- Install a new pedestal at STA 193 + 50BV, 47' LT.
- Intercept the existing cable at the new pedestal at STA 193 + 50BV, 47' LT, then install a new cable 2 ft south of the ROW of Swan Blvd from STA 193+50BV, 47' LT to STA 202BV + 90, 100' LT.
- Install a new pedestal at STA 31SB + 78, 54' LT.
- Install new cable from the pedestal at STA 31SB + 78, 54' LT south to STA 27+ 70NB, 65' LT.
- Install cable to existing pedestal in easement defined in 1060-33-27 RWP STA 27 + 68, 65.5' LT to STA 32 + 10, 90' LT.
- AT&T to transfer to new cable and discontinue the existing copper cable and IPP.

It is anticipated that work will begin June 2019. Estimated construction time to complete the work is 45 working days.

Contact Jay C Bulanek (262- 896-7669 office / 414-491-2855 cell) of AT&T Wisconsin 7 days in advance to coordinate locations and any excavation near their facilities.

Charter Communications has existing communications facilities within the project limits. No conflicts are anticipated.

Contact Scott Dietrich (414-277-4283) of Charter Communications 7 days in advance to coordinate locations and any excavation near their communications facilities.

City of Wauwatosa – Street Lighting has existing facilities within the project limits. Street Lighting installation will be completed under project pay items by the contractor during construction.

Contact Randy Michelz (414-471-8429) of the City of Wauwatosa 7 days in advance to coordinate locations and any excavation near their communications facilities.

City of Wauwatosa - Water has existing facilities within the project limits. Water utility relocations will be completed under project pay items by the contractor during construction.

Contact Adam Florin (414-471-8480, ext. 5915) of the City of Wauwatosa 7 days in advance to coordinate locations and any excavation near their communications facilities.

We Energies – Electric has existing overhead and underground electric facilities within the project limits. Prior to and During construction We Energies will be removing all overhead facilities in the project area, and replacing it with new underground lines:

- Install new cable along the north side of Swan Blvd from STA 195BV LT40 in easement to STA 202BVWB+25 LT64', cross Swan Blvd and splice into the existing cable along Discovery Parkway at STA 29SB+62 LT39'.
- Intercept existing cable in Discovery Parkway at STA 29SB+77 LT 31', install new crossing Discovery Pkwy to the east, continue along the south side of Swan Blvd to the existing VFI at STA 210BV RT 60'.
- Pole Removals:

Station	Pole No	Work Proposed
191BV+45 RT 71'	06-03596	Pole and down anchors to be removed
194BV+13 RT 48'	06-03595	Pole and down anchors to be removed
196BV+22 RT 64'	06-03597	Pole to be removed
198BV+05 RT 63'	06-02607	Pole to be removed
198BV+39 RT 63'	13-04108	Pole to be removed
200BVEB+50 RT 66'	06-02606	Pole to be removed
3C+50 LT 39'	13-04347	Pole to be removed
3C+44 LT 27'	13-04346	Pole to be removed
2C+21 LT 16'	13-08567	Pole to be removed

205BVEB+48 RT 41'	06-02608	Pole to be removed
208BV+05 RT 57'	06-02684	Pole to be removed
210BV+44 RT 55'	06-03803	Pole and down anchors to be removed

It is anticipated that work will begin June 2019. Estimated construction time to complete the work is 40 working days.

Contact Leonard Brown (414-540-5705) of We Energies 7 days in advance to coordinate locations and any excavation near their facilities.

We Energies – Gas has existing gas facilities within the project limits. No conflicts anticipated

Contact Nate Zilles (414-944-5664 office/ 414-651-6693 cell) of We Energies 7 days in advance to coordinate locations and any excavation near their facilities.

Project ID 1060-35-94

There are no known utility facilities within the project limits.

Project ID 1693-37-74

AT&T Legacy (aka AT&T Corporation) has an existing underground communications duct package within the project limits beginning beyond the easterly project limits and running northwesterly along a line 18' south and parallel to the Hank Aaron State Trail, crossing STH 100 at Station 565SS+25. It continues northwesterly to beyond the westerly project limits. This duct package consists of six 2-inch ducts. This line will remain in place without adjustment.

Contact Ken Nine (574-842-8830 office / 574-904-6336 cell) of JMC Engineers & Associates, Inc. 7 days in advance to coordinate locations and any excavation near AT&T Corporation facilities.

AT&T Local Network (aka Teleport Communications of America (TCA)) has an existing underground communications line within the project limits beginning beyond the easterly project limits and running northwesterly along a line 18' south and parallel to the Hank Aaron State Trail, crossing STH 100 at Station 565SS+25. It continues northwesterly to beyond the westerly project limits. This line will remain in place without adjustment.

Contact Sandra Falatyk (414-459-3565 office / 414-651-6013 cell) of Northwind Technical Services 7 days in advance to coordinate locations and any excavation near TCA facilities.

AT&T Wisconsin has existing underground communications facilities within the project limits in the following locations:

- An existing underground communications line beginning beyond the southerly project limits and running northerly along the westerly curb line of STH 100, to a manhole at Station 562SS+17, 29' LT. From there the line turns westerly and continues beyond the westerly project limits. This line will remain in place without adjustment.
- A discontinued underground communications line beginning at a manhole at 562SS+17, 29' LT and running northerly along the westerly curb line of STH 100, crossing the Hank Aaron State Trail on the STH 100 structure and continuing to beyond the northerly project limits.

Contact Jay Bulanek (262-896-7669 office / 414-491-2855 cell) of AT&T Wisconsin 7 days in advance to coordinate locations and any excavation near their facilities.

American Transmission Company (ATC) has six overhead 138kV electric transmission lines beginning beyond the westerly project limits and running southeasterly along the south side of eastbound IH 94, crossing STH 100 between Station 566SS+19 and Station 568SS+00, and continuing southeasterly to beyond the

easterly project limits. These lines will remain in place without adjustment. Use caution when operating overhead equipment in this area and maintain OSHA safe working clearance to the overhead conductors at all times.

Contact Ivan Keller (262-506-6773) of American Transmission Company 7 days in advance before beginning any work within or around overhead electric transmission lines and to coordinate locations and any excavation near their facilities.

Milwaukee Metropolitan Sewerage District (MMSD) has existing underground sanitary sewer lines within the project limits at the following locations:

- An existing underground sanitary sewer line beginning at a manhole at Station 564SS+00, 46' RT and running easterly to a manhole at Station 564SS+01, 71' RT. From there it turns and runs northerly to a manhole at Station 566SS+56, 70' RT. It then turns easterly to a manhole at Station 566SS+67, 133' RT. It then turns northerly and continues beyond the northerly project limits. This sewer line will remain in place without adjustment. MMSD will adjust the manhole at Station 566SS+67, 133' RT during construction. Allow 2 days for MMSD to adjust the manhole during construction.
- An existing underground sanitary sewer begins at a manhole at Station 564SS+00, 46' RT running northerly to a manhole at Station 564SS+12, 46' RT. From there it turns northeasterly and connects to a sewer at Station 564SS+30, 56' RT. This sewer line will remain in place without adjustment.
- An existing underground sanitary sewer line begins beyond the westerly project limits and runs easterly, perpendicular to STH 100, crossing at Station 564SS+31, to a manhole at Station 564SS+31, 24' RT. From there it continues in an easterly direction beyond the easterly project limits. This sewer line will remain in place without adjustment.

Milwaukee Metropolitan Sewerage District also has a discontinued sanitary sewer line within the project limits beginning at a manhole at Station 566SS+56, 70' RT and running northerly along the easterly curb of STH 100 to beyond the northerly project limits.

Contact Larry Anderson (414-225-2241) of the Milwaukee Metropolitan Sewerage District 7 days in advance to coordinate locations and any excavation near their facilities. Contact Bob Rebitski (414-225-2214) of the Milwaukee Metropolitan Sewerage District 7 days in advance to coordinate manhole adjustments.

WE Energies – Electric has existing overhead and underground electric facilities within the project limits in the following locations:

- An underground electric line beginning beyond the southerly project limits and running northeasterly, crossing the Hank Aaron State Trail at Station 147HA+98, and continuing northeasterly to Station 147HA+98, 130'LT. From there the line runs northerly to beyond the project limits. This line will remain in place without adjustment.
- Four existing underground electric conduit packages beginning beyond the southerly project limits and running northeasterly, crossing the Hank Aaron State Trail between Stations 148HA+10 and Station 148HA+30, and continuing northeasterly to Station 148HA+10, 126'LT on the west and Station 148HA+30, 106'LT on the east. From there, the four electric conduit packages run southeasterly to beyond the project limits. These lines will remain in place without adjustment.
- An underground electric line beginning beyond the easterly project limits and running northwesterly to Station 148HA+06, 136'LT where it turns and runs northeasterly to beyond the project limits. This line will remain in place without adjustment.

Contact Nicholas Welch (414-944-5765) of We Energies 7 days in advance to coordinate locations and any excavation near their facilities.

We Energies – Gas has an existing 24-inch underground gas line beginning beyond the southerly project limits running northerly along a line 50' easterly of and parallel to the existing easterly curb of STH 100, to Station 564SS+00, 115' RT and continuing northeasterly to Station 564SS+82, 125' RT. From there it continues northerly to beyond the northerly project limits. This line will remain in place without adjustment.

We Energies – Gas also has a discontinued underground gas line beginning beyond the southerly project limit and running northerly along the existing easterly curb of STH 100, to Station 563SS+80, 54' RT where it turns and runs northeasterly to Station 564+33, 79' RT. From there it runs northerly to Station 566SS+15, 78' RT where it turns and runs northwesterly to Station 566SS+70, 53' RT and then turns and runs northerly to beyond the project limits. The discontinued gas main is in a steel casing pipe between Station 564SS+61 and Station 565SS+64, under the Hank Aaron State Trail.

We Energies will remove any portion of the discontinued gas main in conflict with proposed construction in locations where the gas main coating may contain hazardous material. The removal of such discontinued gas main will occur during construction. Allow We Energies 5 days for removal of any impacted portions of gas main. Contact Nick Ernster (414-944-5574) of We Energies 10 days prior to any activity that will expose the existing gas main to coordinate removal activities.

Contact Nick Ernster (414-944-5574) of We Energies 7 days in advance to coordinate locations and any excavation near their facilities.

West Allis – Lighting has existing underground lighting facilities beginning beyond the southerly project limits and running northerly, along the westerly curb of STH 100, to Station 561SS+70, 40' LT where it turns and runs easterly, crossing STH 100 at Station 561SS+70, and continues easterly to Station 561SS+70, 56' RT. From there it continues southerly, along the easterly curb of STH 100, to beyond the southerly project limits. These facilities will remain in place without adjustment.

Contact Peter Daniels (414-302-8374) of the City of West Allis, 7 days in advance to coordinate locations and any excavation near their facilities.

West Allis – Sewer has an underground sanitary sewer beginning beyond the southerly project limits and running northerly, 10' westerly of and parallel to the easterly curb of STH 100, to a manhole at Station 562SS+75, 46' RT. It continues northerly to a Milwaukee Metropolitan Sewerage District manhole at Station 564SS+00, 46' RT. These lines will remain in place without adjustment.

Contact Peter Daniels (414-302-8374) of the City of West Allis 7 days in advance to coordinate locations and any excavation near their facilities.

Wisconsin Independent Network (WIN) has an existing underground communications line in WisDOT Communications conduit beginning beyond the southerly project limits and running northerly along a line approximately 20' east of the easterly curb of STH 100 to Station 565SS+22, 87' RT. From there it runs northwesterly to Station 565SS+50, 74' RT and then runs northerly to Station 566SS+91, 82' RT. From there it turns and runs northeasterly to a vault at Station 567SS+12, 100' RT where it turns and runs northerly to beyond the project limits. This line will remain in place without adjustment.

Contact Jim Birkenheier (715-832-6041 office / 715-838-4007 cell) of Wisconsin Independent Network 7 days in advance to coordinate locations and any excavation near their facilities.

WisDOT – Lighting has existing overhead and underground lighting facilities along STH 100, along IH 94 Mainline, and along the eastbound IH 94 exit ramp to STH 100. These facilities will remain in place without adjustment.

Contact Eric Perea (262-574-5422 office / 414-750-0935 cell) of WisDOT 7 days in advance to coordinate construction, locations and any excavation near their facilities.

WisDOT – Signals has existing overhead and underground signal facilities within the project limits at the eastbound IH 94 exit ramp to STH 100, from Station 566SS+53 to beyond the northerly project limits. The facilities will remain in place without adjustment.

Contact Derrin Wolford of WisDOT (262-521-4409) 7 days in advance to coordinate locations and any excavation near their facilities.

WisDOT – Communications has existing underground traffic management and communications facilities throughout the project limits in the following locations:

- An existing underground communications line beginning beyond the southerly project limits and running northerly along a line approximately 20' east of the easterly curb of STH 100 to Station 565SS+22, 87' RT. From there it runs northwesterly to Station 565SS+50, 74' RT and then runs northerly to Station 566SS+91, 82' RT. From there it turns and runs northeasterly to a vault at Station 567SS+15, 100' RT where it turns and runs northerly to beyond the project limits. This line will remain in place without adjustment.
- A discontinued underground communications line beginning beyond the southerly project limits and running northerly in a conduit in the east parapet wall of the STH 100 bridge over the Hank Aaron State Trail to a vault at Station 566SS+14, 60' LT. From there it runs northeasterly and ends at a vault at Station 567SS+15, 100' RT.
- A discontinued underground communications line beginning at a vault at Station 566SS+14, 60' LT and running northwesterly to beyond the project limits.

Contact Jeff Madson (414-225-3723) of WisDOT 7 days in advance to coordinate construction, locations and any excavation near their facilities.

Schedule of Items

Attached, dated May 2, 2019, are the revised Schedule of Items Pages 1 – 14.

Plan Sheets

The following 8½ x 11-inch sheets are attached and made part of the plans for this proposal:

Revised: 1693-37-74: 2, 32 and 73

Added: 1060-33-94: 52A

1693-37-74: 17A-F, 32A, and 73A-B

END OF ADDENDUM

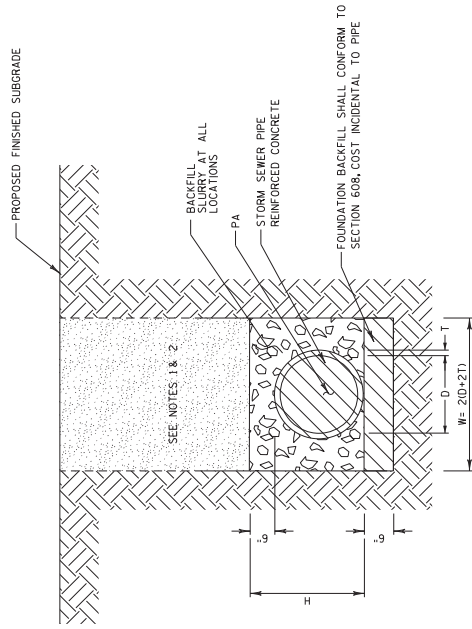

NOTES

- (1) IF THE PIPE IS OUTSIDE THE TRAVELED WAY INCLUSIVE OF SHOULDERS, NATIVE BACKFILL MAY BE USED ABOVE BACKFILL SLURRY AND SHALL CONFORM TO SECTION 209.
- (2) IF THE PIPE IS WITHIN THE TRAVELED WAY INCLUSIVE OF SHOULDERS, BACKFILL ABOVE BACKFILL SLURRY SHALL CONFORM TO SECTION 209.
- (3) WHEN TEMPORARY SUBGRADE IS HIGHER THAN PROPOSED FINISHED SUBGRADE, PROVIDE GRANULAR BACKFILL AT ALL LOCATIONS. COST FOR GRANULAR BACKFILL IS CONSIDERED INCIDENTAL TO CONSTRUCTION.
- (4) PAYMENT FOR BACKFILL SLURRY QUANTITY IS LIMITED TO THE DETAIL AS SHOWN, BACKFILL QUANTITY FOR ANY OVER EXCAVATED AREA IS CONSIDERED PART OF CONSTRUCTION, AND NO ADDITIONAL PAYMENT WILL BE MADE.

BACKFILL SLURRY DETAIL - STORM SEWER TRENCH

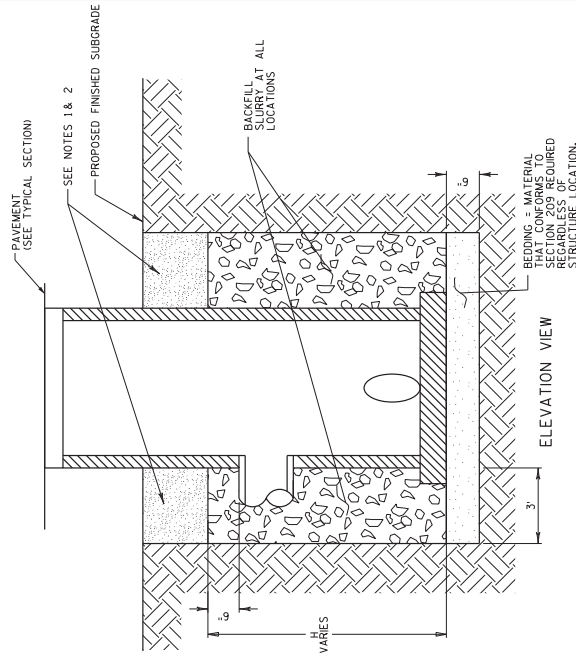

NOTES

- (1) IF THE STRUCTURE IS OUTSIDE THE TRAVELED WAY INCLUSIVE OF SHOULDERS, NATIVE BACKFILL MAY BE USED ABOVE BACKFILL SLURRY AND SHALL CONFORM TO SECTION 209.
- (2) IF THE STRUCTURE IS WITHIN THE TRAVELED WAY INCLUSIVE OF SHOULDERS, BACKFILL ABOVE BACKFILL SLURRY SHALL CONFORM TO SECTION 209.
- (3) WHEN TEMPORARY SUBGRADE IS HIGHER THAN PROPOSED FINISHED SUBGRADE, PROVIDE GRANULAR BACKFILL AT ALL LOCATIONS. COST FOR GRANULAR BACKFILL IS CONSIDERED INCIDENTAL TO CONSTRUCTION.
- (4) PAYMENT FOR BACKFILL SLURRY QUANTITY IS LIMITED TO THE DETAIL AS SHOWN, BACKFILL QUANTITY FOR ANY OVER EXCAVATED AREA IS CONSIDERED PART OF CONSTRUCTION, AND NO ADDITIONAL PAYMENT WILL BE MADE.

BACKFILL SLURRY DETAIL - STORM SEWER STRUCTURES

Addendum No. 01
 ID 1060-33-94
 Added Sheet 52A
 May 2, 2019

PROJECT NO: 1060-33-94	HWY: SWAN BOULEVARD	COUNTY: MILWAUKEE	STORM SEWER - CONSTRUCTION DETAILS	SHEET 52A	E
FILE NAME : W:\CADD\FINAL\10603394_BVR_Roots\Roots\cads\022500_ss.dgn			PLOT BY : bobosm		
PLOT DATE : 4/4/2017			PLOT NAME : #FILE#		
PLOT SCALE : 1:12			WISDOT/CADD SHEET 42		

UTILITY CONTACTS

ATC
MR. IVAN KELLER
W234 N2000 RIDGEVIEW PARKWAY COURT
WAUKESHA, WI 53187
PHONE: (262) 506-8773
JKELLER@ATCLLC.COM

AT&T CORPORATION
MR. KEN NINE
JMC ENGINEERS & ASSOCIATES, INC
110 NORTH MAIN STREET
CULVER, IN 46511
PHONE: (574) 842-8830
CELL: (574) 904-6536
KENNETHNINE@ATT.NET

**AT&T WISCONSIN -
COMMUNICATION LINE**
JAY BULANEK
2005 PEWAUKEE RD
WAUKESHA, WI 53188-2443
(262) 896-7869
jbs175@att.com

**MMSD MANHOLE ADJUSTMENT
CONTACT**
MR. ROBERT REBITSKI
260 W. SEEBOTH STREET
MILWAUKEE, WI 53204
PHONE: (414) 225-2214
RREBITSKI@MMSD.COM

**MILWAUKEE METROPOLITAN
SEWERAGE DISTRICT – SEWER**
MICKI KLAPPA-SULLIVAN
260 W SEEBOTH ST
MILWAUKEE, WI 53204
(414) 225-2178
MklappaSullivan@mmsd.com

**WISCONSIN DEPARTMENT OF
TRANSPORTATION -
COMMUNICATION LINE**
JEFF MADSON
STE. 300
433 W. ST. PAUL AVE.
MILWAUKEE, WI 53203-3007
(414) 225-3723
Jeffrey.Madson@dot.wi.gov

**WISCONSIN DEPARTMENT OF
TRANSPORTATION - STREET
LIGHTING**
ERIC PEREA
141 NW BARSTOW STREET
WAUKESHA, WI 53188
(262) 574-5422
Eric.Perea@dot.wi.gov

**WISCONSIN DEPARTMENT OF
TRANSPORTATION - WISCONSIN
SIGNAL**
DERRIN WOLFORD
141 NW BARSTOW STREET
WAUKESHA, WI 53188
(262) 521-4409
derim.wolford@dot.wi.gov

**ELECTRICAL FIELD UNIT
WEST ALLIS, WI 53214**
PHONE: (414) 266-1170

**WISCONSIN INDEPENDENT
NETWORK**
MR. JIM BIRKENHEIER
800 WISCONSIN AVE, UNIT 15
EAU CLAIRE, WI 54703
PHONE: (715) 832-6041
CELL: (715) 838-4007

WE ENERGIES – ELECTRICITY
NICOLE SMULLEN
A299
333 W EVERETT ST
MILWAUKEE, WI 53203
(414) 221-5617
Nicole.SmulLEN@weenergygroup.com

CONSTRUCTION FIELD CONTACT:
MR. NICHOLAS WELCH
500 S. 116TH STREET
WEST ALLIS, WI 53214
PHONE: (414) 944-5765
NICHOLAS.WELCH@WE-ENERGIES.COM

WE ENERGIES - GAS/PETROLEUM
NICOLE SMULLEN
A299
333 W EVERETT ST
MILWAUKEE, WI 53203
(414) 221-5617
Nicole.SmulLEN@weenergygroup.com

CONSTRUCTION FIELD CONTACT:
MR. NICK ERNSTER
500 S. 116TH STREET
WEST ALLIS, WI 53214
PHONE: (414) 944-5574
NICHOLAS.ERNSTER@WE-ENERGIES.COM

TCA
SANDRA FALATYK
6070 N. FLINT ROAD
GLENDALE, WI 53209
PHONE: (414) 459-3565
CELL: (414) 651-6013
S.FALATYK@NORTHWINDTECH.COM

**Addendum No. 01
ID 1693-37-74
Revised Sheet 2
May 2, 2019**

STATE AGENCIES

**WISCONSIN DEPARTMENT OF
NATURAL RESOURCES**
MS. KRISTINA BETZOLD - ENVIRONMENTAL SPECIALIST
2300 N. MARTIN LUTHER KING JR. DRIVE
MILWAUKEE, WI 53212
CELL: (414) 507-4946
kristina.betzold@wisconsin.gov

**WISCONSIN DEPARTMENT OF
TRANSPORTATION**
MR. JOSH LEVEQUE - PROJECT MANAGER
141 NW BARSTOW ST.
WAUKESHA, WI 53187-0798
CELL: (414) 750-1468
Joshua.Lev@dot.wi.gov

**WISCONSIN DEPARTMENT OF
TRANSPORTATION**
MR. GREG BERRY – UTILITY COORDINATOR
141 NW BARSTOW STREET
WAUKESHA, WI 53187-0798
CELL: (414) 750-7828
gregory.berry@dot.wi.gov

**WISCONSIN DEPARTMENT OF
TRANSPORTATION**
MS. DOBRA PAYANT
141 NW BARSTOW ST.
WAUKESHA, WI 53187-0798
PHONE: (414) 750-2677
DOBRA.PAYANT@DOT.WI.GOV

OTHER AGENCIES

**MILWAUKEE COUNTY DPW
MANAGER**
MR. GREG HEISEL, HWY MAINT.
10790 W. WATERTOWN PLANK ROAD
MILWAUKEE, WI 53226
PHONE: (414) 257-6566
gheisel@milwcnty.com

MILWAUKEE COUNTY TRANSIT SYSTEM
MS. MELANIE FLYNN
1942 N. 17TH STREET
MILWAUKEE, WI 53205
PHONE: (414) 343-1764
mflynn@mcts.org

**WISCONSIN DEPARTMENT OF
NATURAL RESOURCES**
MS. MELISSA COOK – HAST TRAIL MANAGER
2300 N. MARTIN LUTHER KING JUR. DRIVE
MILWAUKEE, WI 53212
PHONE: (414) 263-8559
MELISSA.COOK@WISCONSIN.GOV

**SOUTHEASTERN WISCONSIN
REGIONAL PLANNING COMMISSION**
MR. ROB MERRY
W239 N1812 ROCKWOOD DRIVE
P.O. BOX 1807
WAUKESHA, WI 53187-1607
PHONE: (262) 953-4289
CELL: (920) 912-1036
rmerry@sewrpc.org

**CITY OF WEST ALLIS – CITY
ENGINEER**
PETER DANIELS
7525 W GREENFIELD AVE
WEST ALLIS, WI 53214
(414) 302-8374
pdaniels@westallis.wi.gov





Addendum No. 01
ID 1693-37-74
Added Sheet 17A
May 2, 2019

S. 78TH ST

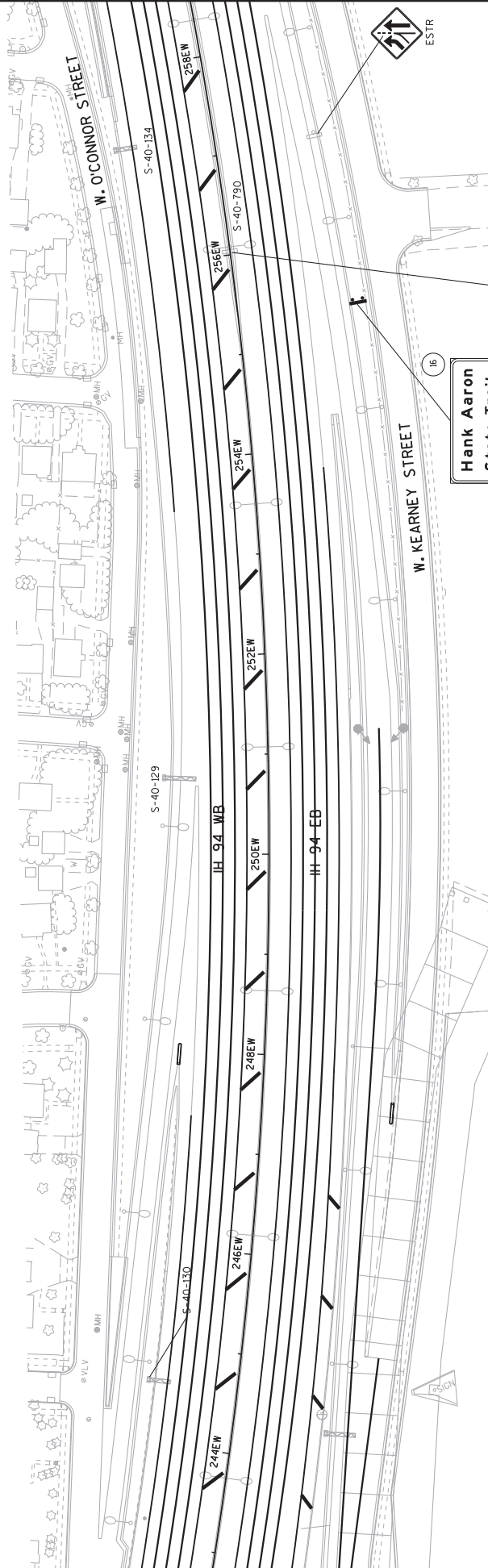

Hank Aaron
State Trail
Exit 307A

68th - 70th St 1/4
Hawley Rd 1
Mitchell Blvd (LEFT) 1 1/2

- LEGEND
- EXISTING SIGN MOUNTED ON POST(S)
 - EXISTING SIGN MOUNTED ON BRIDGE OR SIGN BRIDGE
 - PROPOSED SIGN MOUNTED ON POST(S)
 - PROPOSED SIGN MOUNTED ON BRIDGE OR SIGN BRIDGE
 - VARIABLE MESSAGE SIGN
 - EXISTING LIGHT OR SIGNAL POLE
 - SIGN BRIDGE
 - CANTILEVER SIGN BRIDGE
 - DENOTES SIGN NUMBER
 - INDICATES SIGN SIZE
 - EXISTING SIGN TO REMAIN

TYPE 1
SIGN POSTS
STEEL SUPPORTS
4" BEHIND BARRIER WALL
EXISTING LIGHT OR SIGNAL POLE

ESTR
TYPE 1
(EB)

ADDENDUM #1

SHEET 1 OF 6

E

SHEET 17A

PERMANENT SIGNING - HANK AARON STATE TRAIL

COUNTY: MILWAUKEE

HWY: I 94

PROJECT NO: 1693-37-74

FILE NAME : J:\proj\jects\02-16933794\SIGN\023234_.ps-dgn

PLOT DATE : 17-APR-2019 14:09

PLOT BY : d0187m

PLOT SCALE : 100:1

WISDOT/CADDIS SHEET 42



- LEGEND**
- EXISTING SIGN MOUNTED ON POST(S)
 - EXISTING SIGN MOUNTED ON BRIDGE OR SIGN BRIDGE
 - PROPOSED SIGN MOUNTED ON POST(S)
 - PROPOSED SIGN MOUNTED ON BRIDGE OR SIGN BRIDGE
 - VARIABLE MESSAGE SIGN
 - EXISTING LIGHT OR SIGNAL POLE
 - SIGN BRIDGE
 - CANTILEVER SIGN BRIDGE
 - DENOTES SIGN NUMBER
 - INDICATES SIGN SIZE
 - ESTR EXISTING SIGN TO REMAIN

(17)

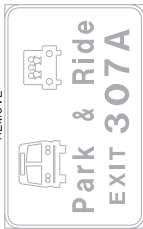
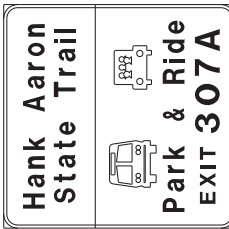
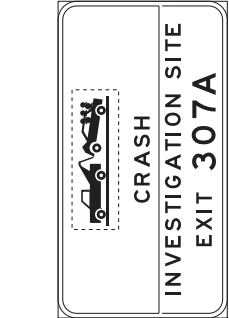

TYPE I MOUNT ON STEEL POSTS 7 BETWEEN POSTS

TYPE I MOUNT ON 2 WOOD POSTS

TYPE I ESTR

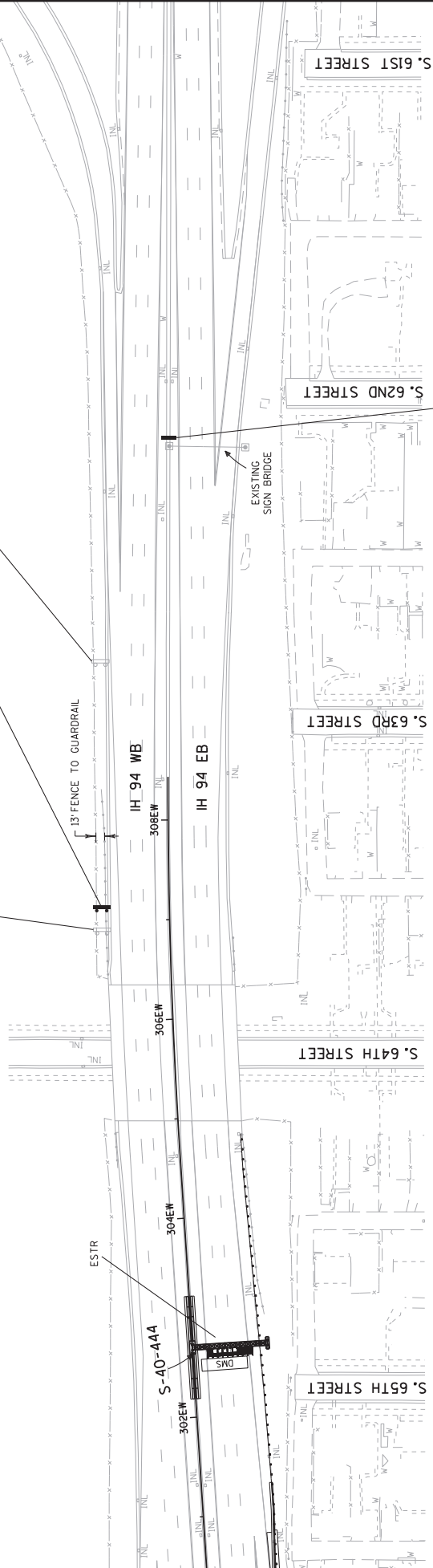

Addendum No. 01
ID 1693-37-74
Added Sheet 17B
May 2, 2019

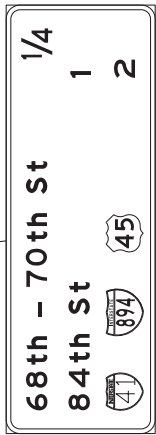

ADDENDUM #1

- LEGEND**
- EXISTING SIGN MOUNTED ON POST(S)
 - EXISTING SIGN MOUNTED ON BRIDGE OR SIGN BRIDGE
 - PROPOSED SIGN MOUNTED ON POST(S)
 - PROPOSED SIGN MOUNTED ON BRIDGE OR SIGN BRIDGE
 - VARIABLE MESSAGE SIGN
 - EXISTING LIGHT OR SIGNAL POLE
 - SIGN BRIDGE
 - CANTILEVER SIGN BRIDGE
 - DENOTES SIGN NUMBER
 - INDICATES SIGN SIZE
 - EXSTR EXISTING SIGN TO REMAIN

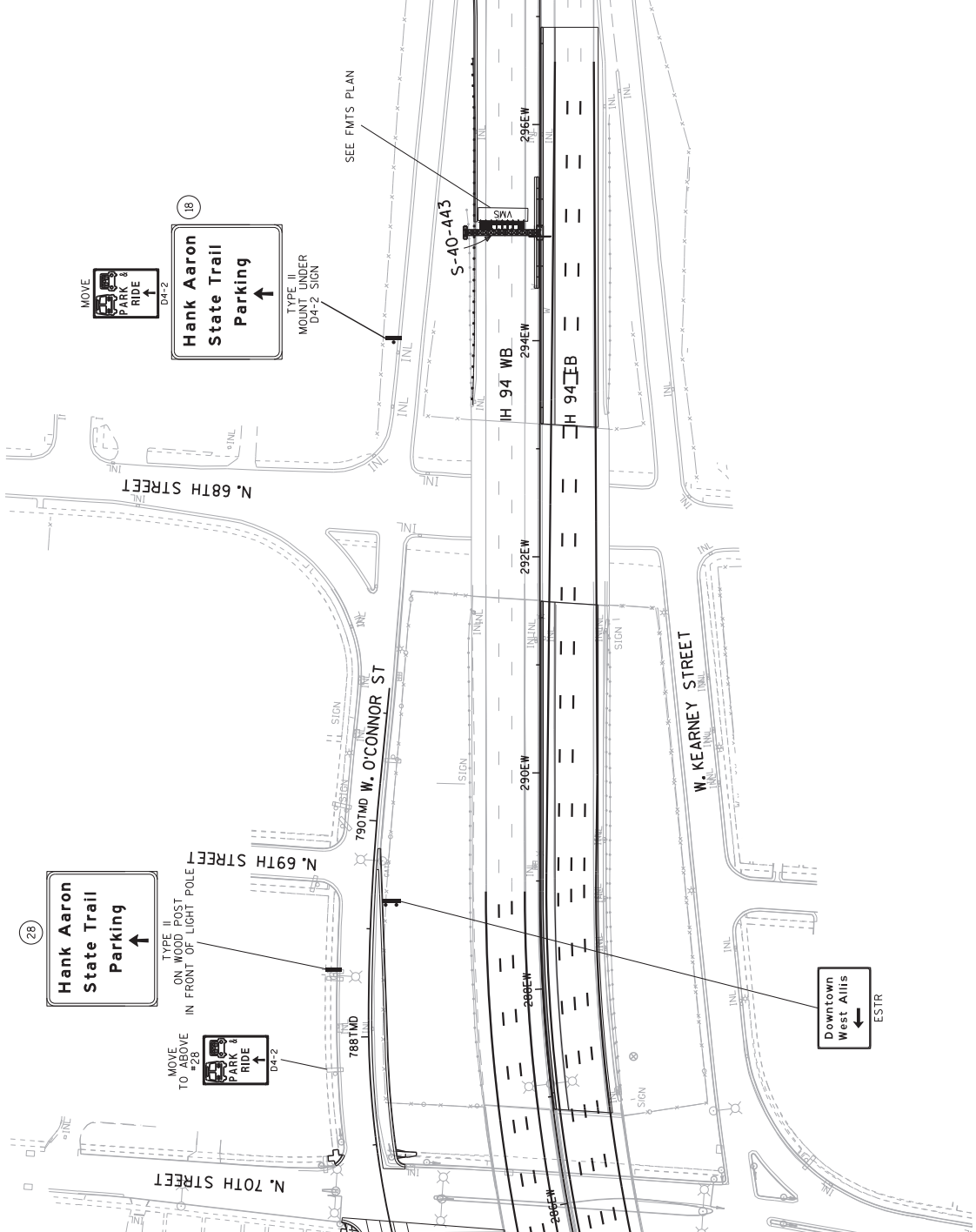

Addendum No. 01
ID 1693-37-74
Added Sheet 17C
May 2, 2019

ADDENDUM #1

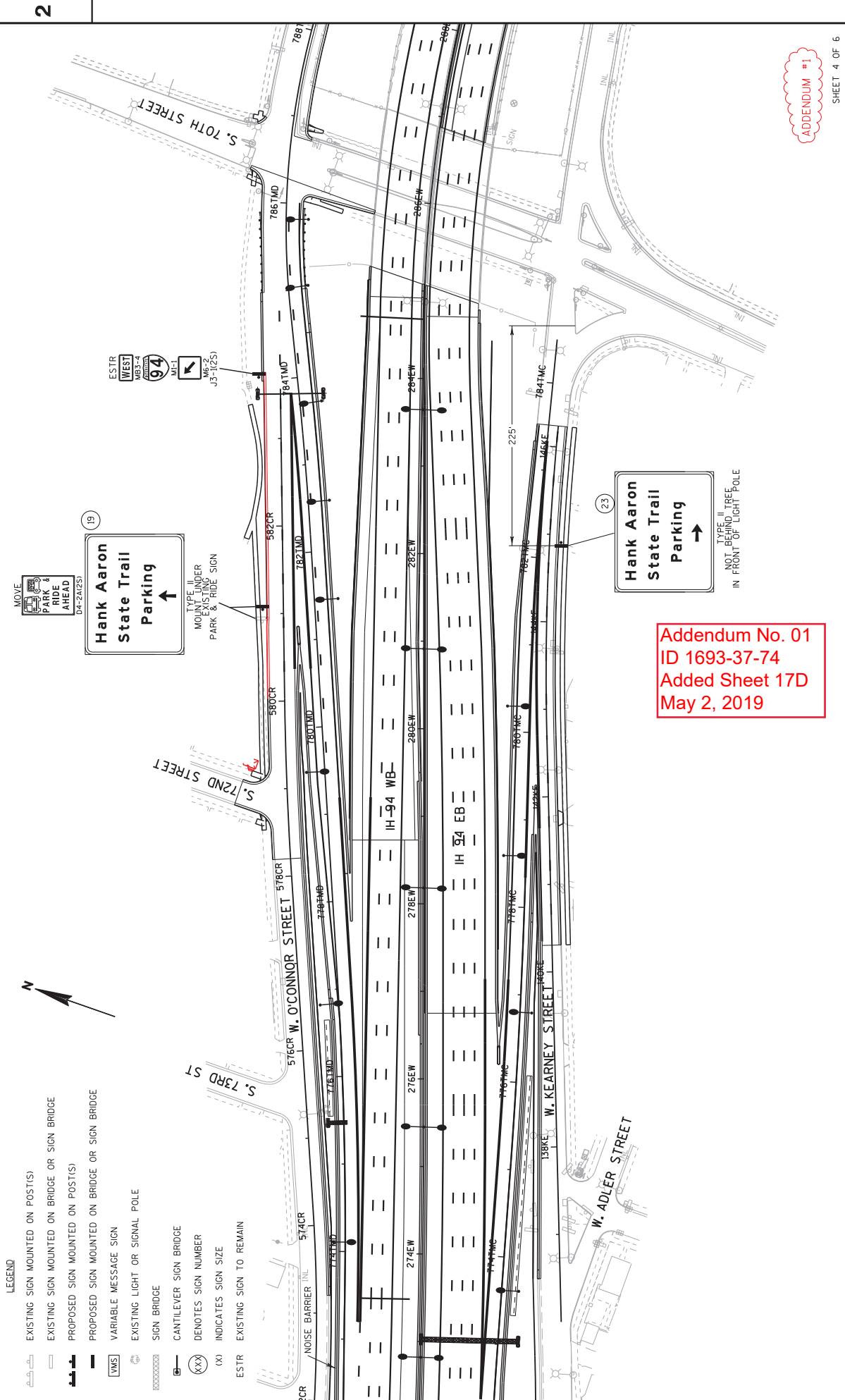

- LEGEND**
- EXISTING SIGN MOUNTED ON POST(S)
 - EXISTING SIGN MOUNTED ON BRIDGE OR SIGN BRIDGE
 - PROPOSED SIGN MOUNTED ON POST(S)
 - PROPOSED SIGN MOUNTED ON BRIDGE OR SIGN BRIDGE
 - [LWS] VARIABLE MESSAGE SIGN
 - ⊙ EXISTING LIGHT OR SIGNAL POLE
 - SIGN BRIDGE
 - CANTILEVER SIGN BRIDGE
 - (XXX) DENOTES SIGN NUMBER
 - (X) INDICATES SIGN SIZE
 - ESTR EXISTING SIGN TO REMAIN

Addendum No. 01
 ID 1693-37-74
 Added Sheet 17D
 May 2, 2019

ADDENDUM #1



Hank Aaron State Trail Parking
TYPE II ON LEFT

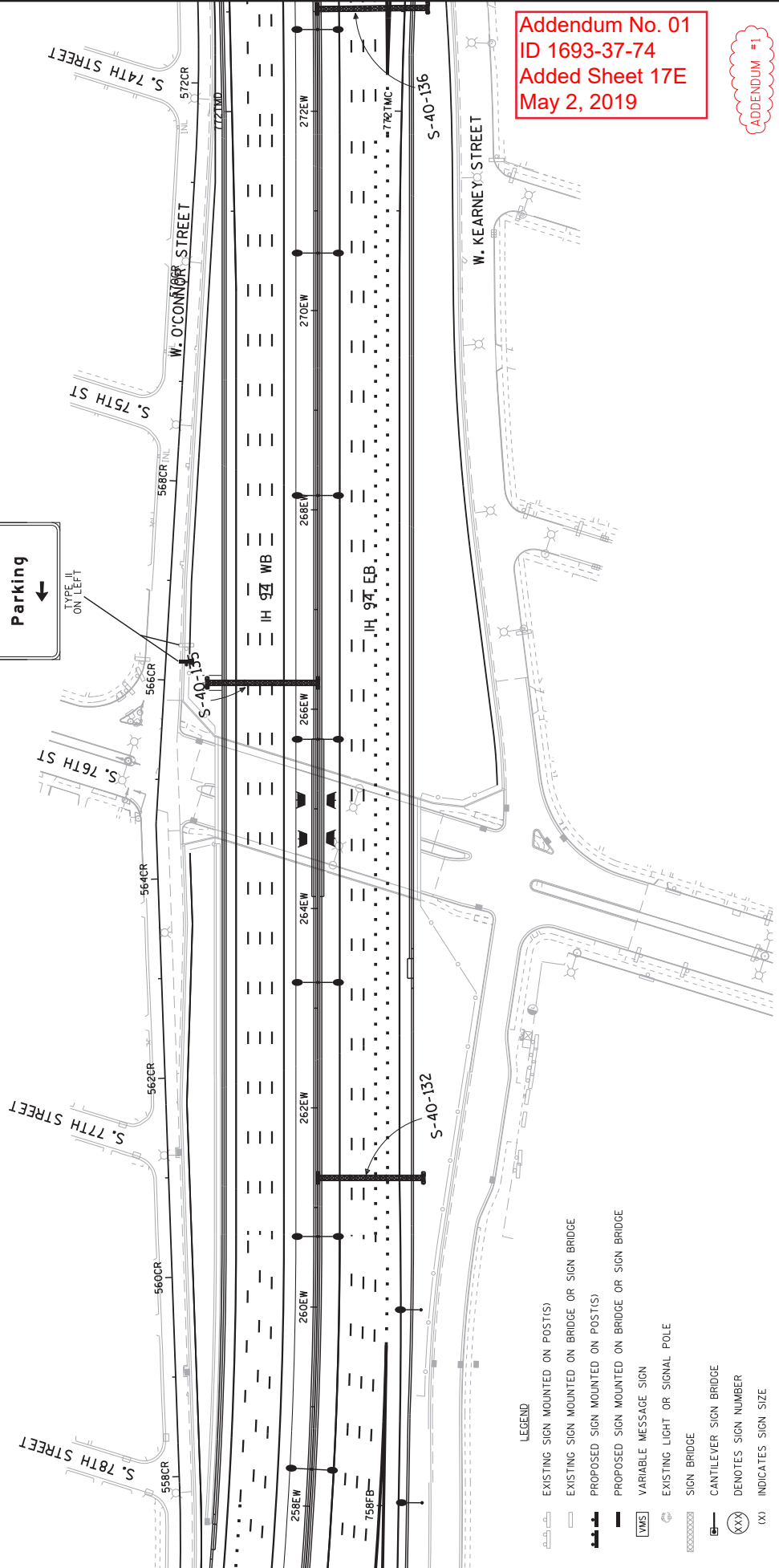

Addendum No. 01
ID 1693-37-74
Added Sheet 17E
May 2, 2019

ADDENDUM #1

Addendum No. 01
 ID 1693-37-74
 Added Sheet 17F
 May 2, 2019

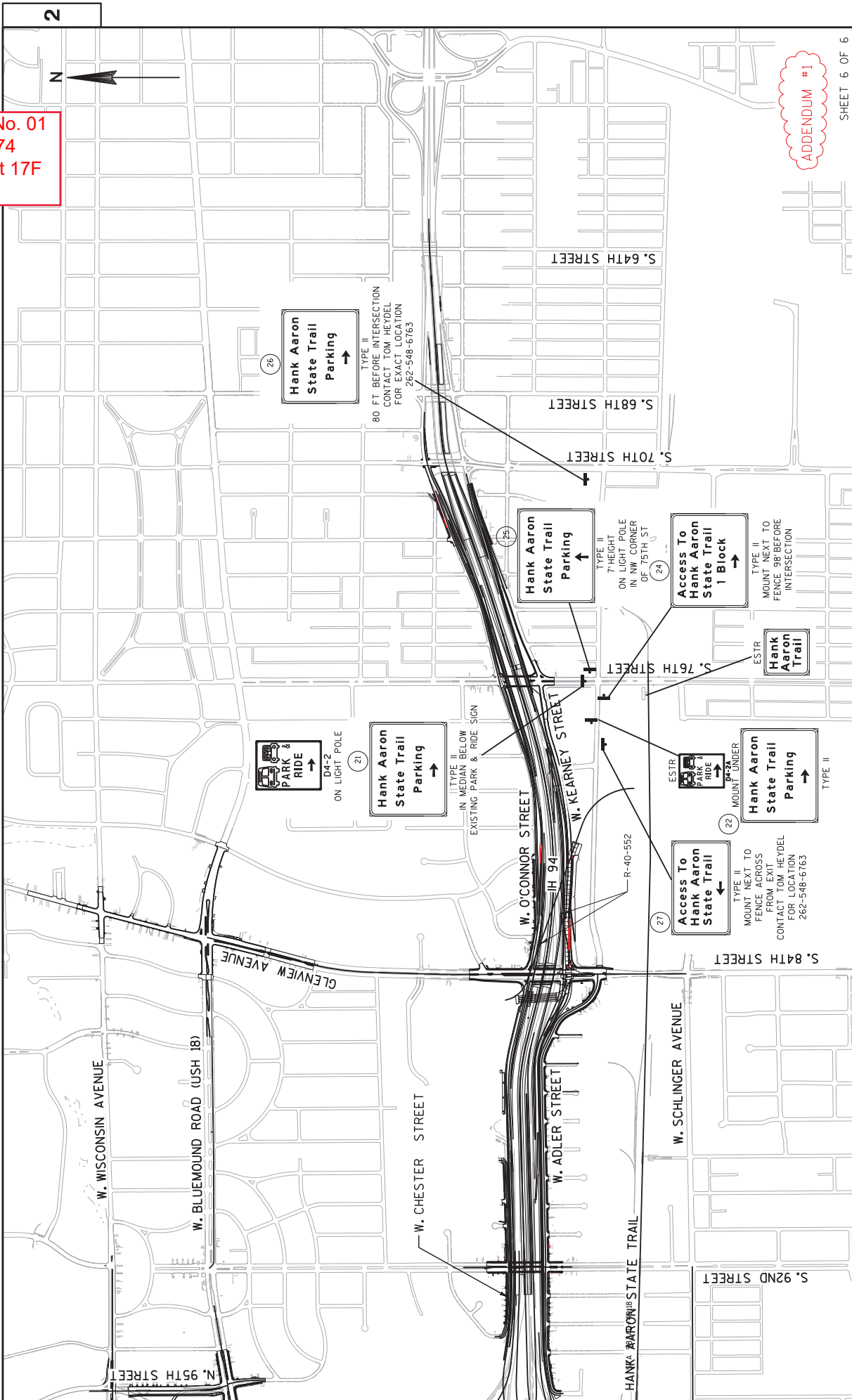

ADDENDUM #1

1693-37-74

TYPE I & II PERMANENT SIGNING -

SIGN NO.	SIGN CODE & SIZE	SIGN MESSAGE	TYPE II SIGN SIZE W x H [IN.] x [IN.]	637.2210 SIGNS TYPE II REFLC H [SF]	637.2230 SIGNS TYPE II REFLC F [SF]	634.0618 WOOD POSTS 4"X 6"X18" [EA]	634.0816 TUBULAR STEEL POSTS 2"X2"X16" [EA]	638.3000 REM SMALL SIGN SUP [EA]	638.2102 MOVE SIGNS TYPE II [EA]	MOUNT POSTS AS SIGN#	TYPE I SIGN SIZE W X H FEET	637.1220 SIGNS TYPE I REFLECTIVE SH SF	638.2801 REMOVING SIGNS TYPE I EA	STEEL POST TYPE	636.0100 SIGN SUPPORTS CONCRETE MASONRY CY	636.0500 SIGN SUPPORTS STEEL REINFORCING LBS	635.0200 SIGN SUPPORTS STRUCTURAL STEEL HS EST LBS	REMARKS / NEW SIGN LOCATION
1	NONE	TO HANK AARON TRAIL	24 X 30	5.000			1											SEE DETAIL
2	NONE	TO HANK AARON TRAIL	24 X 30	5.000			1											SEE DETAIL
3	R1-2		18 X 15.5	0.970			1											
4	W1-5L		18 X 18		2.250		1											
5	W1-2L		18 X 18		2.250		1											
6	W3-1		18 X 18		2.250		1											
7	R1-1		18 X 18	1.880			1											
8	J3-1		24 X 57	9.500		1												
	IM-5		24 X 12															
	M1-6	STH 100	24 X 24															
	M6-1		21 X 21															
9	J3-1		24 X 57	9.500		1												
	IM-5		24 X 12															
	M1-6	STH 100	24 X 24															
	M6-1		21 X 21															
10	R5-3(ZS)		24 X 24	4.000														
11	NONE	TO MILWAUKEE COUNTY ZOO	24 X 36	6.000			1											
12	NONE	TO MILWAUKEE COUNTY ZOO	24 X 36	6.000			1											
13	NONE	TO MILWAUKEE COUNTY ZOO	24 X 36	6.000			1											
14	W7-5		18 X 18		2.250		1											
15	R5-3(ZS)		24 X 24	4.000			1											
16	NONE	HANK AARON STATE TRAIL									12 X 7	64		A	1.2	68	600	4 FEET BEHIND BARRIER WALL
		EXT 307A																
17	NONE	HANK AARON STATE TRAIL						2			8 X 8	64	1	B	1.6	98	1000	7 FEET BETWEEN POSTS. BEHIND GUARDRAIL
		PARK AND RIDE																
		EXT 307A																
18	NONE	HANK AARON STATE TRAIL PARKING	30 X 36	7.500		1												
		ARROW AHEAD																
19	NONE	HANK AARON STATE TRAIL PARKING	30 X 36	7.500		1												
		ARROW AHEAD																

ADDENDUM # 1

SHEET 1 OF 2

E

PERMANENT SIGNING QUANTITIES

COUNTY: MILWAUKEE

HWY: STH 100

PROJECT NO.: 1693-37-74

SHEET: 32

PLOT BY: DOTTAH

PLOT DATE: April 17, 2019

FILE NAME: N:\SPO\Operations\Signing\Miscellaneous Quantities\1693-37-74\03603_.img; .ptx

PLOT SCALE: 1:1

TYPE I & II PERMANENT SIGNING -

SIGN NO.	SIGN CODE & SIZE	SIGN MESSAGE	TYPE II SIGN SIZE (IN) x (IN) x (IN)	SIGN REFLECT H (SF)	637.2210 SIGN TYPE II REFLECT H (SF)	637.2230 SIGN TYPE II REFLECT F (SF)	634.0818 WOOD POSTS 4" X 6" X 18" (EA)	634.0816 TUBULAR STEEL POSTS 2" X 2" X 16" (EA)	638.3000 REM SMALL SIGN SUP (EA)	638.2102 MOVE SIGN TYPE II (EA)	MOUNT ON SAME POST AS SIGN #	TYPE I SIGN SIZE W X H FEET	637.1220 SIGN TYPE I REFLECTIVE SH SF	638.2001 REMOVING SIGN TYPE I EA	STEEL POST TYPE	636.0100 SIGN SUPPORTS CONCRETE MASONRY CY	636.0500 SIGN SUPPORTS STEEL REINFORCING LBS	635.0200 SIGN SUPPORTS STRUCTURAL STEEL HS EST LBS	REMARKS / NEW SIGN LOCATION
20	NONE	HANK AARON STATE TRAIL PARKING	30 x 30	6.250	1				1	1									
		ARROW LEFT																	
21	NONE	HANK AARON STATE TRAIL PARKING	24 x 24	4.000															MOUNT ON LIGHT POLE
		ARROW RIGHT																	
22	NONE	HANK AARON STATE TRAIL PARKING	30 x 30	6.250															
		ARROW RIGHT																	
23	NONE	HANK AARON STATE TRAIL PARKING	30 x 30	6.250			1												
		ARROW RIGHT																	
24	NONE	HANK AARON STATE TRAIL PARKING	24 x 30	5.000				1											
		1 BLOCK ARROW RIGHT																	
25	NONE	HANK AARON STATE TRAIL PARKING	24 x 30	5.000															
		ARROW AHEAD																	MOUNT ON LIGHT POLE
26	NONE	HANK AARON STATE TRAIL PARKING	24 x 24	4.000															
		ARROW RIGHT																	
27	NONE	HANK AARON STATE TRAIL	24 x 24	4.000				1											
		ARROW LEFT																	
28	NONE	HANK AARON STATE TRAIL PARKING	30 x 36	7.500					1	1									MOUNT ON WOOD POST
		ARROW AHEAD																	
		UNDISTRIBUTED							2	1									
TOTALS				121.080	9.000		6	16	8	5			148	1		2.8	166	1600	

- 1. All Signs Type II - Type H Reflective
- 2. Color: Background - Green
Message - White

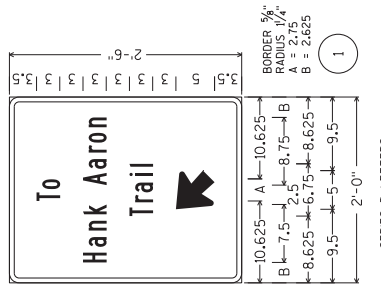
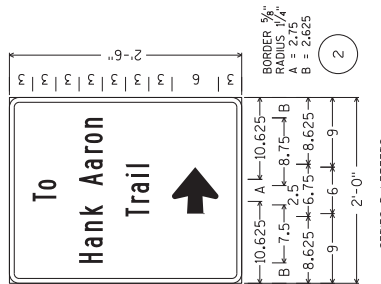
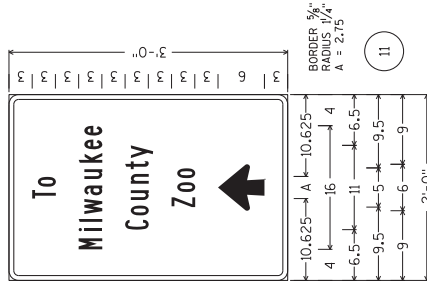
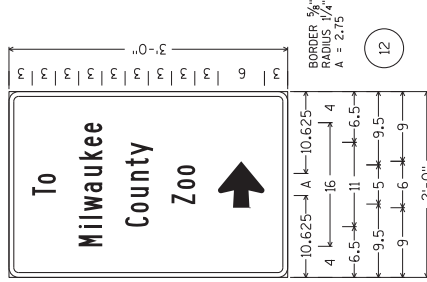
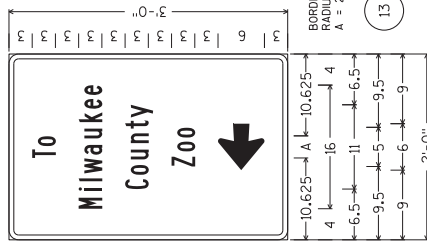

Addendum # 1 - Signs
1 and # 2 to be
brown with white
letters

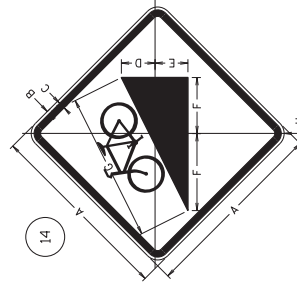

W7-5
BICYCLE HILL PLAQUE

A	B	C	D	E	F	G	H
18	17.5	17.5	4	5.625	12.625	15	15
24	23.5	23.5	7.5	16.833	17.5	21	21

Colors:
Legend - Black
Background - Yellow Type F Sheeting
Background - Yellow Type F Sheeting

Addendum No. 01
ID 1693-37-74
Revised Sheet 73
May 2, 2019

NOTES

1. All Signs Type I - Type SH Reflective
2. Color:
Background - Brown
Message - White
3. Message Series - E Modified except all CAP words Series E or as noted

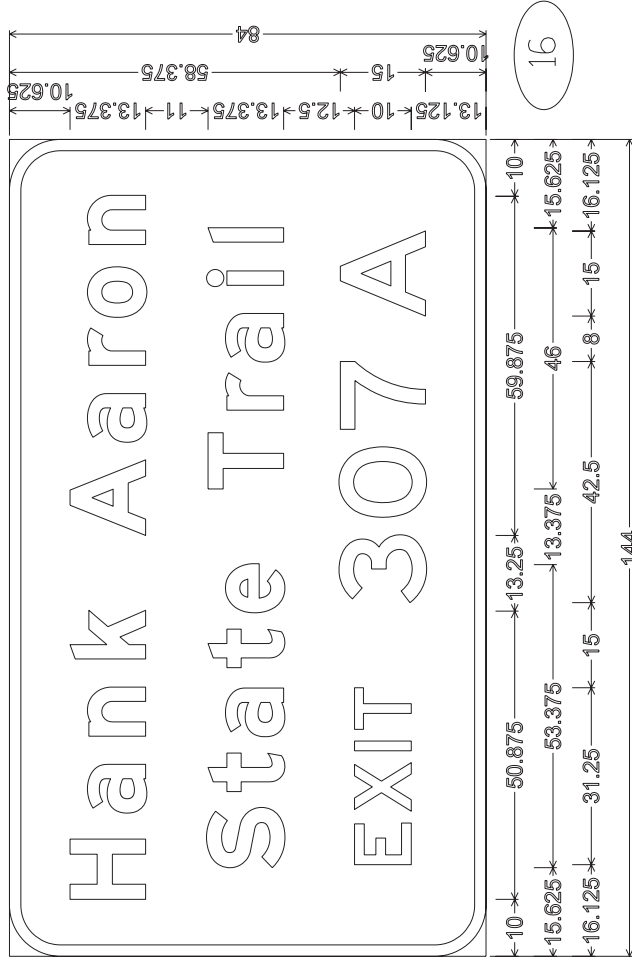

Identifier : E3-1

9.000" Radius, 2.000" Border, White on Brown;

"Hank" E Mod; "Aaron" E Mod; "State" E Mod; "Trail" E Mod; "EXIT" E;

"307" E; "A" E;

Addendum No. 01
ID 1693-37-74
Added Sheet 73A
May 2, 2019

NOTES

1. All Signs Type II - Type H Reflective
2. Color:
Background - Green except as noted
Message - White
3. Message Series - B except as noted

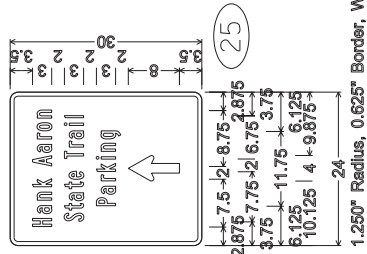
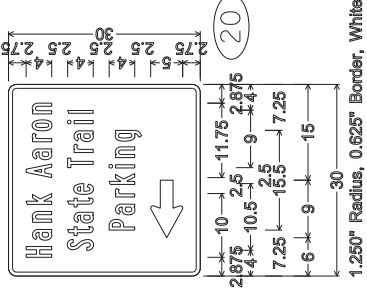
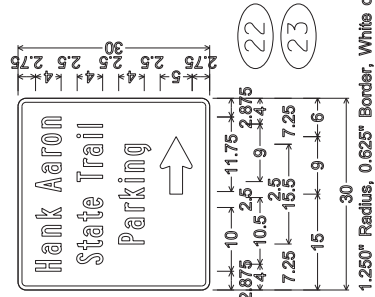

Type I sign - sign # 17

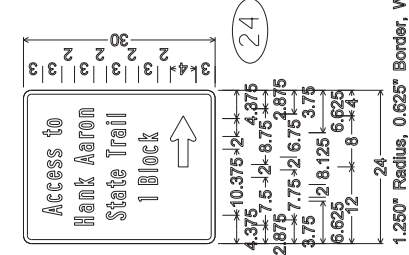
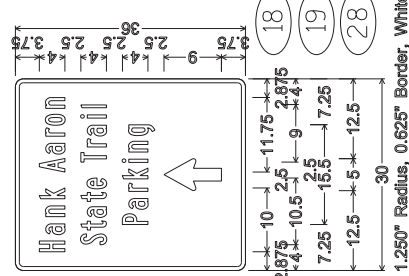
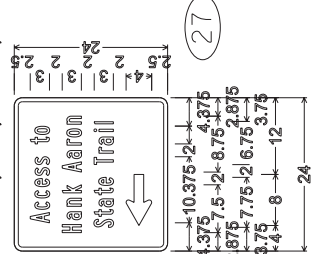
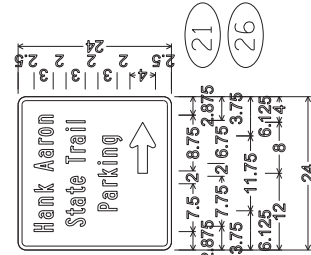
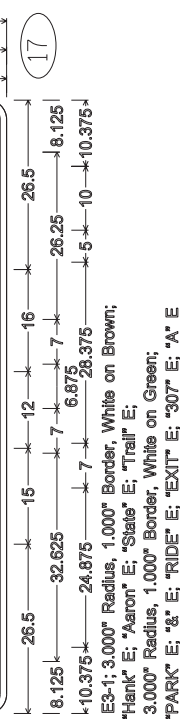
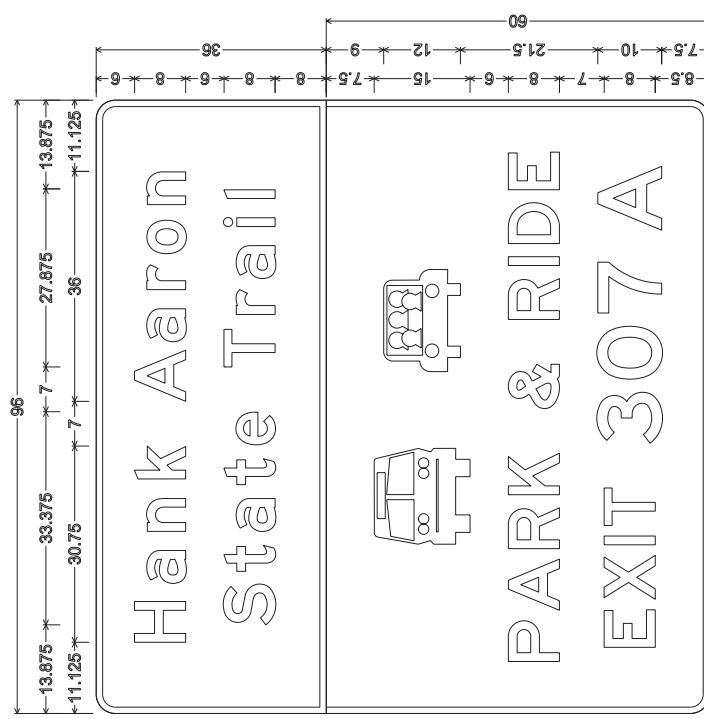

Addendum No. 01
ID 1693-37-74
Added Sheet 73B
May 2, 2019



Proposal Schedule of Items

Proposal ID: 20190514051 Project(s): 1060-33-94, 1060-35-94, 1693-37-74

Federal ID(s): WISC 2019219, N/A, WISC 2019433

SECTION: 0001 Contract Items

Alt Set ID: Alt Mbr ID:

Proposal Line Number	Item ID Description	Approximate Quantity and Units	Unit Price	Bid Amount
0002	201.0105 Clearing	14.000 STA	_____.	_____.
0004	201.0205 Grubbing	14.000 STA	_____.	_____.
0006	204.0100 Removing Pavement	9,622.000 SY	_____.	_____.
0008	204.0150 Removing Curb & Gutter	2,665.000 LF	_____.	_____.
0010	204.0155 Removing Concrete Sidewalk	274.000 SY	_____.	_____.
0012	204.0195 Removing Concrete Bases	20.000 EACH	_____.	_____.
0014	204.0220 Removing Inlets	10.000 EACH	_____.	_____.
0016	204.0245 Removing Storm Sewer (size) 01. 15-Inch	76.000 LF	_____.	_____.
0018	204.0245 Removing Storm Sewer (size) 02. 18-Inch	215.000 LF	_____.	_____.
0020	204.9090.S Removing (item description) 0001. Removing Concrete Barrier Temporary Precast	100.000 LF	_____.	_____.
0022	205.0100 Excavation Common	29,914.000 CY	_____.	_____.
0024	206.3000 Excavation for Structures Retaining Walls (structure) 0006. R-40-631	LS	LUMP SUM	_____.
0026	206.3000 Excavation for Structures Retaining Walls (structure) 0007. R-40-655	LS	LUMP SUM	_____.
0028	208.0100 Borrow	13,127.000 CY	_____.	_____.
0030	213.0100 Finishing Roadway (project) 01. 1060-33-94	1.000 EACH	_____.	_____.



Proposal Schedule of Items

Proposal ID: 20190514051 Project(s): 1060-33-94, 1060-35-94, 1693-37-74

Federal ID(s): WISC 2019219, N/A, WISC 2019433

SECTION: 0001 Contract Items

Alt Set ID: Alt Mbr ID:

Proposal Line Number	Item ID Description	Approximate Quantity and Units	Unit Price	Bid Amount
0032	213.0100 Finishing Roadway (project) 02. 1060-35-94	1.000 EACH	_____.	_____.
0034	213.0100 Finishing Roadway (project) 03. 1693-37-74	1.000 EACH	_____.	_____.
0036	305.0120 Base Aggregate Dense 1 1/4-Inch	16,497.000 TON	_____.	_____.
0038	312.0110 Select Crushed Material	16,684.000 TON	_____.	_____.
0040	405.0100 Coloring Concrete WisDOT Red	132.000 CY	_____.	_____.
0042	415.0080 Concrete Pavement 8-Inch	252.000 SY	_____.	_____.
0044	416.0512 Concrete Truck Apron 12-Inch	372.000 SY	_____.	_____.
0046	416.0610 Drilled Tie Bars	153.000 EACH	_____.	_____.
0048	416.0620 Drilled Dowel Bars	149.000 EACH	_____.	_____.
0050	455.0605 Tack Coat	1,764.000 GAL	_____.	_____.
0052	460.2000 Incentive Density HMA Pavement	3,450.000 DOL	1.00000	3,450.00
0054	460.5223 HMA Pavement 3 LT 58-28 S	3,118.000 TON	_____.	_____.
0056	460.5224 HMA Pavement 4 LT 58-28 S	2,259.000 TON	_____.	_____.
0058	465.0105 Asphaltic Surface	739.000 TON	_____.	_____.
0060	504.0500 Concrete Masonry Retaining Walls	114.000 CY	_____.	_____.
0062	505.0600 Bar Steel Reinforcement HS Coated Structures	11,655.000 LB	_____.	_____.



Proposal Schedule of Items

Proposal ID: 20190514051 **Project(s):** 1060-33-94, 1060-35-94, 1693-37-74
Federal ID(s): WISC 2019219, N/A, WISC 2019433

SECTION: 0001 Contract Items

Alt Set ID: **Alt Mbr ID:**

Proposal Line Number	Item ID Description	Approximate Quantity and Units	Unit Price	Bid Amount
0064	506.0605 Structural Steel HS	78,960.000 LB	_____.	_____.
0066	506.3010 Welded Stud Shear Connectors 7/8x5-Inch	406.000 EACH	_____.	_____.
0068	513.2001 Railing Pipe	47.000 LF	_____.	_____.
0070	516.0500 Rubberized Membrane Waterproofing	2.000 SY	_____.	_____.
0072	517.0600 Painting Epoxy System (structure) 0005. R-40-631	LS	LUMP SUM	_____.
0074	517.0600 Painting Epoxy System (structure) 0006. R-40-655	LS	LUMP SUM	_____.
0076	517.1010.S Concrete Staining (structure) 0109. R-40-631	1,690.000 SF	_____.	_____.
0078	517.1010.S Concrete Staining (structure) 0110. R-40-655	1,205.000 SF	_____.	_____.
0080	517.1050.S Architectural Surface Treatment (structure) 0032. R-40-631	1,485.000 SF	_____.	_____.
0082	517.1050.S Architectural Surface Treatment (structure) 0033. R-40-655	1,040.000 SF	_____.	_____.
0084	520.1012 Apron Endwalls for Culvert Pipe 12-Inch	3.000 EACH	_____.	_____.
0086	520.1015 Apron Endwalls for Culvert Pipe 15-Inch	2.000 EACH	_____.	_____.
0088	520.3512 Culvert Pipe Class III-B 12-Inch	168.000 LF	_____.	_____.
0090	520.3515 Culvert Pipe Class III-B 15-Inch	47.000 LF	_____.	_____.
0092	520.8000 Concrete Collars for Pipe	8.000 EACH	_____.	_____.



Proposal Schedule of Items

Proposal ID: 20190514051 Project(s): 1060-33-94, 1060-35-94, 1693-37-74

Federal ID(s): WISC 2019219, N/A, WISC 2019433

SECTION: 0001 Contract Items

Alt Set ID: Alt Mbr ID:

Proposal Line Number	Item ID Description	Approximate Quantity and Units	Unit Price	Bid Amount
0094	522.1015 Apron Endwalls for Culvert Pipe Reinforced Concrete 15-Inch	3.000 EACH	_____.	_____.
0096	522.1018 Apron Endwalls for Culvert Pipe Reinforced Concrete 18-Inch	2.000 EACH	_____.	_____.
0098	522.1030 Apron Endwalls for Culvert Pipe Reinforced Concrete 30-Inch	1.000 EACH	_____.	_____.
0100	522.2634 Apron Endwalls for Culvert Pipe Reinforced Concrete Horizontal Elliptical 34x53-Inch	1.000 EACH	_____.	_____.
0102	601.0331 Concrete Curb & Gutter 31-Inch	3,092.000 LF	_____.	_____.
0104	601.0405 Concrete Curb & Gutter 18-Inch Type A	264.000 LF	_____.	_____.
0106	601.0582 Concrete Curb & Gutter 4-Inch Sloped 36-Inch Type T	346.000 LF	_____.	_____.
0108	601.0600 Concrete Curb Pedestrian	198.000 LF	_____.	_____.
0110	602.0410 Concrete Sidewalk 5-Inch	36,447.000 SF	_____.	_____.
0112	602.0515 Curb Ramp Detectable Warning Field Natural Patina	272.000 SF	_____.	_____.
0114	606.0200 Riprap Medium	27.000 CY	_____.	_____.
0116	608.0315 Storm Sewer Pipe Reinforced Concrete Class III 15-Inch	727.000 LF	_____.	_____.
0118	608.0318 Storm Sewer Pipe Reinforced Concrete Class III 18-Inch	635.000 LF	_____.	_____.
0120	608.0330 Storm Sewer Pipe Reinforced Concrete Class III 30-Inch	17.000 LF	_____.	_____.



Proposal Schedule of Items

Proposal ID: 20190514051 Project(s): 1060-33-94, 1060-35-94, 1693-37-74

Federal ID(s): WISC 2019219, N/A, WISC 2019433

SECTION: 0001 Contract Items

Alt Set ID: Alt Mbr ID:

Proposal Line Number	Item ID Description	Approximate Quantity and Units	Unit Price	Bid Amount
0122	608.0415 Storm Sewer Pipe Reinforced Concrete Class IV 15-Inch	104.000 LF	_____.	_____.
0124	608.2334 Storm Sewer Pipe Reinforced Concrete Horizontal Elliptical Class HE-III 34x53-Inch	123.000 LF	_____.	_____.
0126	611.0420 Reconstructing Manholes	1.000 EACH	_____.	_____.
0128	611.0535 Manhole Covers Type J-Special	3.000 EACH	_____.	_____.
0130	611.0624 Inlet Covers Type H	31.000 EACH	_____.	_____.
0132	611.0642 Inlet Covers Type MS	5.000 EACH	_____.	_____.
0134	611.0652 Inlet Covers Type T	2.000 EACH	_____.	_____.
0136	611.0663 Inlet Covers Type X	1.000 EACH	_____.	_____.
0138	611.2005 Manholes 5-FT Diameter	2.000 EACH	_____.	_____.
0140	611.2006 Manholes 6-FT Diameter	2.000 EACH	_____.	_____.
0142	611.2007 Manholes 7-FT Diameter	2.000 EACH	_____.	_____.
0144	611.3004 Inlets 4-FT Diameter	12.000 EACH	_____.	_____.
0146	611.3230 Inlets 2x3-FT	17.000 EACH	_____.	_____.
0148	611.3901 Inlets Median 1 Grate	1.000 EACH	_____.	_____.
0150	611.3902 Inlets Median 2 Grate	2.000 EACH	_____.	_____.
0152	611.8115 Adjusting Inlet Covers	3.000 EACH	_____.	_____.



Proposal Schedule of Items

Proposal ID: 20190514051 Project(s): 1060-33-94, 1060-35-94, 1693-37-74
Federal ID(s): WISC 2019219, N/A, WISC 2019433

SECTION: 0001 Contract Items

Alt Set ID: Alt Mbr ID:

Table with 5 columns: Proposal Line Number, Item ID Description, Approximate Quantity and Units, Unit Price, Bid Amount. Rows include items like Pipe Grates, Pipe Underdrain, Fence Safety, Mobilization, Concrete Median, Dust Control, Water, Mulching, Silt Fence, Erosion Control, and Inlet Protection.



Proposal Schedule of Items

Proposal ID: 20190514051 Project(s): 1060-33-94, 1060-35-94, 1693-37-74

Federal ID(s): WISC 2019219, N/A, WISC 2019433

SECTION: 0001 Contract Items

Alt Set ID: Alt Mbr ID:

Proposal Line Number	Item ID Description	Approximate Quantity and Units	Unit Price	Bid Amount
0188	628.7010 Inlet Protection Type B	4.000 EACH	_____.	_____.
0190	628.7020 Inlet Protection Type D	41.000 EACH	_____.	_____.
0192	628.7504 Temporary Ditch Checks	1,137.000 LF	_____.	_____.
0194	628.7555 Culvert Pipe Checks	6.000 EACH	_____.	_____.
0196	628.7560 Tracking Pads	6.000 EACH	_____.	_____.
0198	630.0171 Seeding Mixture No. 70A	4.000 LB	_____.	_____.
0200	630.0175 Seeding Mixture No. 75	15.000 LB	_____.	_____.
0202	630.0200 Seeding Temporary	63.000 LB	_____.	_____.
0204	631.0300 Sod Water	56.000 MGAL	_____.	_____.
0206	631.1000 Sod Lawn	2,492.000 SY	_____.	_____.
0208	633.5200 Markers Culvert End	12.000 EACH	_____.	_____.
0210	634.0618 Posts Wood 4x6-Inch X 18-FT	8.000 EACH	_____.	_____.
0212	634.0816 Posts Tubular Steel 2x2-Inch X 16-FT	98.000 EACH	_____.	_____.
0214	637.2210 Signs Type II Reflective H	822.620 SF	_____.	_____.
0216	637.2230 Signs Type II Reflective F	175.000 SF	_____.	_____.
0218	638.2102 Moving Signs Type II	7.000 EACH	_____.	_____.
0220	638.2602 Removing Signs Type II	40.000 EACH	_____.	_____.



Proposal Schedule of Items

Proposal ID: 20190514051 Project(s): 1060-33-94, 1060-35-94, 1693-37-74

Federal ID(s): WISC 2019219, N/A, WISC 2019433

SECTION: 0001 Contract Items

Alt Set ID: Alt Mbr ID:

Proposal Line Number	Item ID Description	Approximate Quantity and Units	Unit Price	Bid Amount
0222	638.3000 Removing Small Sign Supports	21.000 EACH	_____.	_____.
0224	642.5401 Field Office Type D	1.000 EACH	_____.	_____.
0226	643.0300 Traffic Control Drums	331.000 DAY	_____.	_____.
0228	643.0420 Traffic Control Barricades Type III	3,332.000 DAY	_____.	_____.
0230	643.0705 Traffic Control Warning Lights Type A	6,663.000 DAY	_____.	_____.
0232	643.0715 Traffic Control Warning Lights Type C	100.000 DAY	_____.	_____.
0234	643.0800 Traffic Control Arrow Boards	13.000 DAY	_____.	_____.
0236	643.0900 Traffic Control Signs	7,107.000 DAY	_____.	_____.
0238	643.0920 Traffic Control Covering Signs Type II	1.000 EACH	_____.	_____.
0240	643.1000 Traffic Control Signs Fixed Message	100.000 SF	_____.	_____.
0242	643.1050 Traffic Control Signs PCMS	156.000 DAY	_____.	_____.
0244	643.5000 Traffic Control	1.000 EACH	_____.	_____.
0246	645.0120 Geotextile Type HR	53.000 SY	_____.	_____.
0248	646.1020 Marking Line Epoxy 4-Inch	16,568.000 LF	_____.	_____.
0250	646.1545 Marking Line Grooved Wet Ref Contrast Epoxy 4-Inch	37.500 LF	_____.	_____.
0252	646.3020 Marking Line Epoxy 8-Inch	935.000 LF	_____.	_____.



Proposal Schedule of Items

Proposal ID: 20190514051 Project(s): 1060-33-94, 1060-35-94, 1693-37-74
Federal ID(s): WISC 2019219, N/A, WISC 2019433

SECTION: 0001 Contract Items

Alt Set ID: Alt Mbr ID:

Table with 5 columns: Proposal Line Number, Item ID Description, Approximate Quantity and Units, Unit Price, Bid Amount. Rows include items like Marking Arrow Epoxy, Marking Word Epoxy, Marking Symbol Epoxy, Marking Stop Line Epoxy 18-Inch, Marking Dotted Extension Epoxy 18-Inch, Marking Diagonal Epoxy 12-Inch, Marking Crosswalk Epoxy Transverse Line 6-Inch, Marking Crosswalk Epoxy Ladder Pattern 24-Inch, Marking Curb Epoxy, Marking Island Nose Epoxy, Marking Removal Special Marking Water Blasting, Conduit Rigid Nonmetallic Schedule 40 2-Inch, Concrete Bases Type 5, Electrical Wire Lighting 12 AWG, Electrical Wire Lighting 8 AWG, Electrical Wire Lighting 6 AWG.



Proposal Schedule of Items

Proposal ID: 20190514051 Project(s): 1060-33-94, 1060-35-94, 1693-37-74
 Federal ID(s): WISC 2019219, N/A, WISC 2019433

SECTION: 0001 Contract Items

Alt Set ID: Alt Mbr ID:

Proposal Line Number	Item ID Description	Approximate Quantity and Units	Unit Price	Bid Amount
0286	655.0630 Electrical Wire Lighting 4 AWG	1,894.000 LF	_____.	_____.
0288	657.0255 Transformer Bases Breakaway 11 1/2-Inch Bolt Circle	4.000 EACH	_____.	_____.
0290	657.0322 Poles Type 5-Aluminum	25.000 EACH	_____.	_____.
0292	657.0610 Luminaire Arms Single Member 4 1/2-Inch Clamp 6-FT	25.000 EACH	_____.	_____.
0294	659.1120 Luminaires Utility LED B	4.000 EACH	_____.	_____.
0296	690.0150 Sawing Asphalt	170.000 LF	_____.	_____.
0298	690.0250 Sawing Concrete	586.000 LF	_____.	_____.
0300	715.0415 Incentive Strength Concrete Pavement	500.000 DOL	1.00000	500.00
0302	740.0440 Incentive IRI Ride	1,050.000 DOL	1.00000	1,050.00
0304	ASP.1T0A On-the-Job Training Apprentice at \$5.00/HR	1,500.000 HRS	5.00000	7,500.00
0306	ASP.1T0G On-the-Job Training Graduate at \$5.00/HR	1,800.000 HRS	5.00000	9,000.00
0308	SPV.0030 Special 1000. Fertilizer Type B Special	21.900 CWT	_____.	_____.
0310	SPV.0035 Special 1000. Riprap Repair	250.000 CY	_____.	_____.
0312	SPV.0035 Special 4010. Concrete Masonry Soldier Pile Footings	131.000 CY	_____.	_____.
0314	SPV.0060 Special 01. Removing Luminaires	7.000 EACH	_____.	_____.



Proposal Schedule of Items

Proposal ID: 20190514051 **Project(s):** 1060-33-94, 1060-35-94, 1693-37-74
Federal ID(s): WISC 2019219, N/A, WISC 2019433

SECTION: 0001 Contract Items

Alt Set ID: **Alt Mbr ID:**

Proposal Line Number	Item ID Description	Approximate Quantity and Units	Unit Price	Bid Amount
0316	SPV.0060 Special 02. Luminaires Utility Salvaged	13.000 EACH	_____.	_____.
0318	SPV.0060 Special 03. Removing Lighting Units	20.000 EACH	_____.	_____.
0320	SPV.0060 Special 04. Lighting Units Salvaged	4.000 EACH	_____.	_____.
0322	SPV.0060 Special 05. 17X30X18 Composite Pull Boxes	1.000 EACH	_____.	_____.
0324	SPV.0060 Special 06. Luminaires Utility LED C 3000K	12.000 EACH	_____.	_____.
0326	SPV.0060 Special 1000. Remove and Cap Existing Drainage Storm Sewer Structure	4.000 EACH	_____.	_____.
0328	SPV.0060 Special 1001. Pond Outlet Storm Sewer Structure	1.000 EACH	_____.	_____.
0330	SPV.0060 Special 1002. Cleaning Pipe and Pipe Inverts	2.000 EACH	_____.	_____.
0332	SPV.0060 Special 1003. Precast Concrete Parking Bumper	18.000 EACH	_____.	_____.
0334	SPV.0060 Special 2000. Removing Cover Plate Left in Place	1.000 EACH	_____.	_____.
0336	SPV.0060 Special 2001. State-Furnished Gates Decorative HAST Ground Mounted 12-Ft	1.000 EACH	_____.	_____.
0338	SPV.0060 Special 2002. State-Furnished Gates Decorative HAST Ground Mounted 30-Ft	1.000 EACH	_____.	_____.
0340	SPV.0075 Special 1000. Pavement Cleanup Project 1060-33-94	100.000 HRS	_____.	_____.
0342	SPV.0075 Special 4210. Obstructions Foundation Drilling	8.000 HRS	_____.	_____.



Proposal Schedule of Items

Proposal ID: 20190514051 **Project(s):** 1060-33-94, 1060-35-94, 1693-37-74
Federal ID(s): WISC 2019219, N/A, WISC 2019433

SECTION: 0001 Contract Items

Alt Set ID: **Alt Mbr ID:**

Proposal Line Number	Item ID Description	Approximate Quantity and Units	Unit Price	Bid Amount
0344	SPV.0085 Special 1000. Seeding Mixture No. 30 Special	669.000 LB	_____.	_____.
0346	SPV.0090 Special 0126. Pipe Underdrain 6-Inch Special	285.000 LF	_____.	_____.
0348	SPV.0090 Special 1000. Concrete C&G Integral 67-Inch	3,579.000 LF	_____.	_____.
0350	SPV.0090 Special 2000. State-Furnished Fence Decorative HAST Ground Mounted	1,306.000 LF	_____.	_____.
0352	SPV.0090 Special 4411. State-Furnished Fence Decorative HAST Wall Mounted	232.000 LF	_____.	_____.
0354	SPV.0090 Special 4420. Foundation Drilling Special	810.000 LF	_____.	_____.
0356	SPV.0105 Special 1000. Survey Project 1060-33-94	LS	LUMP SUM	_____.
0358	SPV.0105 Special 1001. RRFB System 'STA 204+65 BVWB Right	LS	LUMP SUM	_____.
0360	SPV.0105 Special 1002. RRFB System 'STA 204+50 Median Left WB	LS	LUMP SUM	_____.
0362	SPV.0105 Special 1003. RRFB System 'STA 204+50 BVWB Median Left EB	LS	LUMP SUM	_____.
0364	SPV.0105 Special 1004. RRFB System 'STA 501+70 SE Right	LS	LUMP SUM	_____.
0366	SPV.0105 Special 1005. RRFB System 'STA 300+50 SW Right	LS	LUMP SUM	_____.
0368	SPV.0105 Special 1006. RRFB System 'STA 202+30 Median Island Left EB	LS	LUMP SUM	_____.



Proposal Schedule of Items

Proposal ID: 20190514051 Project(s): 1060-33-94, 1060-35-94, 1693-37-74
 Federal ID(s): WISC 2019219, N/A, WISC 2019433

SECTION: 0001 Contract Items

Alt Set ID: Alt Mbr ID:

Proposal Line Number	Item ID Description	Approximate Quantity and Units	Unit Price	Bid Amount
0370	SPV.0105 Special 1007. RRFB System 'STA 202+30 Median Island Left WB	LS	LUMP SUM	_____.
0372	SPV.0105 Special 1008. RRFB System 'STA 100+60 NW Right	LS	LUMP SUM	_____.
0374	SPV.0105 Special 1009. Wayfinder Post Assembly - Sign No. 1001	LS	LUMP SUM	_____.
0376	SPV.0105 Special 1010. Wayfinder Post Assembly - Sign No. 1002	LS	LUMP SUM	_____.
0378	SPV.0105 Special 1011. Wayfinder Post Assembly - Sign No. 1003	LS	LUMP SUM	_____.
0380	SPV.0105 Special 1100. Survey Project 1060-35-94	LS	LUMP SUM	_____.
0382	SPV.0105 Special 1200. Survey Project 1693-37-74	LS	LUMP SUM	_____.
0384	SPV.0110 Special 4600. Timber Lagging	10.000 MBM	_____.	_____.
0386	SPV.0165 Special 4780. Geocomposite Drain Board	3,085.000 SF	_____.	_____.
0388	SPV.0180 Special 1001. Topsoil Special	22,097.000 SY	_____.	_____.
0390	635.0200 Sign Supports Structural Steel HS	1,600.000 LB	_____.	_____.
0392	636.0100 Sign Supports Concrete Masonry	2.800 CY	_____.	_____.
0394	636.0500 Sign Supports Steel Reinforcement	166.000 LB	_____.	_____.
0396	637.1220 Signs Type I Reflective SH	148.000 SF	_____.	_____.
0398	638.2601 Removing Signs Type I	1.000 EACH	_____.	_____.



Proposal Schedule of Items

Proposal ID: 20190514051 **Project(s):** 1060-33-94, 1060-35-94, 1693-37-74

Federal ID(s): WISC 2019219, N/A, WISC 2019433

Section: 0001

Total: _____.

Total Bid: _____.

