



Wisconsin Department of Transportation

Division of Transportation Systems Development

Bureau of Project Development
4822 Madison Yards Way, 4th Floor South
Madison, WI 53705

August 1, 2019

Telephone: (608) 266-1631
Facsimile (FAX): (608) 266-8459

NOTICE TO ALL CONTRACTORS:

Proposal #05: 1100-27-70, WISC 2019 578
IH 41
STH 145 To Dodge County Line
IH 41
Washington County

1100-41-70, WISC 2019 579
Milwaukee – Fond Du Lac
CTH K To N Washington County
Line
IH 41
Washington County

1107-00-71, WISC 2019 580
IH 41
USH 41/45 Split to Dodge Co
Line
IH 41
Washington County

Letting of August 13, 2019

This is Addendum No. 02, which provides for the following:

Schedule of Items:

Revised Bid Item Quantities					
Bid Item	Item Description	Unit	Old Quantity	Revised Quantity	Proposal Total
415.0410	Pavement Approach Slab	SY	254	160	160
506.3015	Welded Shear Stud Connectors 7/8 x 6-Inch	EACH	28	56	56

Added Bid Item Quantities					
Bid Item	Item Description	Unit	Old Quantity	Revised Quantity	Proposal Total
415.0090	Pavement 9-Inch	SY	0	96	96

Plan Sheets:

Revised Plan Sheets	
Plan Sheet	Plan Sheet Title (brief description of changes to sheet)
9	Paving Detail: I-41 (Plan Change)
51	Miscellaneous Quantities (Quantity Change)
140	Cross Section and Quantities (Quantity Change)

Schedule of Items

Attached, dated August 1, 2019, are the revised Schedule of Items Pages 2, 4, and 13.

Plan Sheets

The following 8½ x 11-inch sheets are attached and made part of the plans for this proposal:
1100-41-70 Revised: 9, 51, and 140.

The responsibility for notifying potential subcontractors and suppliers of these changes remains with the prime contractor.

Sincerely,

Mike Coleman

Proposal Development Specialist
Proposal Management Section

END OF ADDENDUM

STATE PROJECT NUMBER
1100-41-70

GENERAL NOTES

DRAWINGS SHALL NOT BE SCALED.
ALL DIMENSIONS ARE IN FEET AND INCHES UNLESS OTHERWISE NOTED. ALL STATIONS AND ELEVATIONS ARE IN FEET.
BAR STEEL REINFORCEMENT SHALL BE EMBEDDED 2" CLEAR UNLESS SHOWN OR NOTED OTHERWISE.
THE FIRST DIGIT OF A THREE DIGIT BAR MARK OR THE FIRST TWO DIGITS OF A FOUR DIGIT BAR MARK SIGNIFIES THE BAR SIZE.
FILLER SHALL CONFORM TO THE REQUIREMENTS OF M213.
AT THE BACKFACE OF ABUTMENTS, ALL SPACES EXCAVATED AND NOT OCCUPIED BY THE NEW STRUCTURE SHALL BE FILLED WITH STRUCTURE BACKFILL.
THE EXISTING GROUNDLINE SHALL BE USED AS THE UPPER LIMITS OF EXCAVATION FOR STRUCTURES.
LEVEL EXPOSED EDGES OF CONCRETE 3/4" UNLESS NOTED OTHERWISE.
THE EXISTING STRUCTURE IS A SINGLE SPAN STEEL GIRDER BRIDGE ON FILL. RETAINING CONCRETE ABUTMENTS WITH AN OVERALL LENGTH OF 26'-6" AND AN OVERALL WIDTH OF 44'-0" AND IS TO BE WIDENED.
THE SLOPE OF THE FILL IN FRONT OF THE ABUTMENTS SHALL BE COVERED WITH HEAVY RIPRAP AND GEOTEXTILE.
CONCRETE POURING UNDER WATER WILL BE ALLOWED AND SHALL BE DONE IN ACCORDANCE WITH SECTION 502.3.5.3 OF THE STANDARD SPECIFICATION.
ALL CONCRETE REMOVAL SHALL BE DEFINED BY A 1-INCH DEEP SAW CUT.
UTILIZE EXISTING BAR STEEL REINFORCEMENT WHERE SHOWN, CLEAN, STRAIGHTEN AND INCORPORATE INTO NEW WORK.

BENCH MARK TABLE

NO.	STATION	DESCRIPTION	ELEVATION
32	1446+03.27(TL' QUAD OF B-66-17)	CHISELED "X" ON SW QUAD OF B-66-17	960.370
33	1446+28.86(TL' QUAD OF B-66-22)	CHISELED "X" ON NE QUAD OF B-66-22	959.470

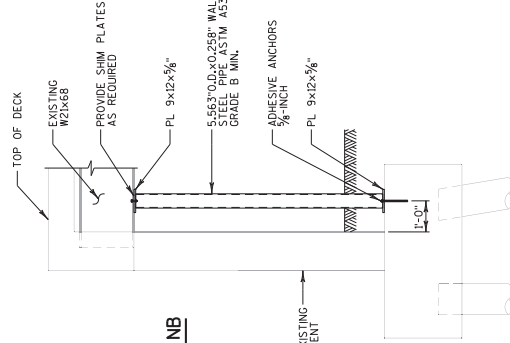

EXISTING/TEMPORARY PROFILE GRADE LINE I-41 NB

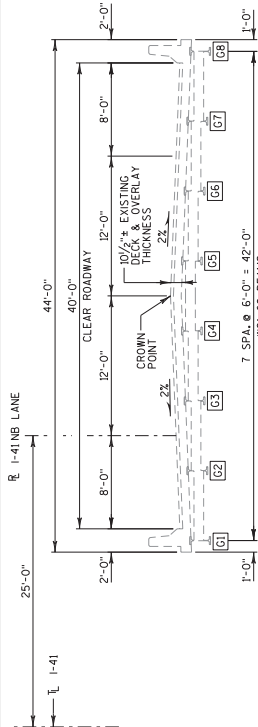

EXISTING CROSS SECTION THRU ROADWAY

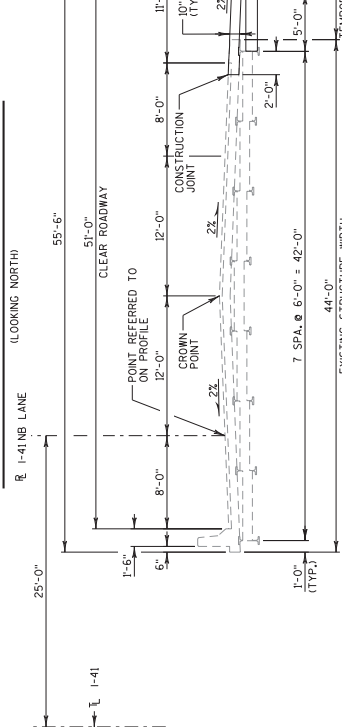

PROPOSED CROSS SECTION THRU ROADWAY



EXISTING GIRDER SUPPORT

PLACE AT LOCATIONS DETERMINED BY ENGINEER. LOCATIONS SHOWN ARE FOR INFORMATION ONLY. ADHESIVE ANCHORS, STRUCTURAL STEEL CARBON DIOXIDE INHIBITORS, AND EPOXY SHALL BE USED TO REPAIR EXISTING SUPPORTS. REPAIRS SHALL BE DONE UNDER THE "REMOVING OLD STRUCTURE" ITEM.



7/31/2019

TOTAL ESTIMATED QUANTITIES

BID ITEM NUMBER	BID ITEM	UNIT	SOUTH ABUTMENT	ABUTMENT	NORTH ABUTMENT	SUPER.	TOTALS	
206.1000-01	EXCAVATION FOR STRUCTURES BRIDGES B-66-17	LS	---	---	---	---	1	
210.1500	BACKFILL STRUCTURE TYPE A	TON	10	10	10	---	220	
502.0100	CONCRETE MASONRY BRIDGES	CY	7	7	19	---	33	
502.4105	ADHESIVE ANCHORS 5/8-INCH	EACH	12	12	24	---	24	
502.4205	ADHESIVE ANCHORS NO. 5 BAR	EACH	5	5	5	---	10	
505.0400	BAR STEEL REINFORCEMENT HS STRUCTURES	LB	840	840	3,180	---	4,860	
506.0005	STRUCTURAL STEEL CARBON	LB	935	935	---	---	1,870	
506.0605	STRUCTURAL STEEL HS	LB	---	---	---	4,060	4,060	
506.2605	BEARING PADS ELASTOMERIC NON-LAMINATED	EACH	---	---	---	4	4	
506.3015	WELDED STUD SHEAR CONNECTORS 7/8 x 6-INCH	EACH	---	---	---	56	56	
511.200	TEMPORARY SHORING B-66-17	SF	95	95	95	---	285	
512.1000	PILENG STEEL SHEET TEMPORARY	SF	125	125	---	---	250	
516.0500	RUBBERIZED MEMBRANE WATERPROOFING	SY	5	5	5	---	10	
550.0020	PRE-BORING ROCK OR CONSOLIDATED MATERIALS	LF	2.5	2.5	---	---	5	
550.1000	PILENG STEEL HP 10-INCH X 42 LB	LF	100	100	---	---	200	
606.0300	PIPE UNDERDRAIN WRAPPED 6-INCH	CY	15	25	---	---	40	
612.0406	GEOTEXTILE TYPE DF SCHEDULE A	SF	25	20	---	---	45	
645.0311	GEOTEXTILE TYPE HR	SY	45	65	---	---	110	
645.0320	PARTIALLY REMOVING OLD STRUCTURE OVER WATERWAY WITH MINIMAL DEBRIS STATION 1446NB+19	LS	---	---	---	---	1	
SPV.0005-01	FILLER	SIZE					1/2", 3/4" & 1 1/2"	

ALL ITEMS ARE CATEGORY 020

NOTICE: TEMPORARY BARRIER INCLUDED WITH ROADWAY ITEMS.

FILE NAME : C:\GMY D\1\verTrk Prj\objects\Bridges\B-66-17\B-66-17\B-66-17-02_typesections.dgn

Addendum No. 02
ID 1100-41-70
Revised Sheet 140
August 1, 2019

NO.	DATE	REVISION	BY
1		QUANTITY REVISION	BH
STATE OF WISCONSIN DEPARTMENT OF TRANSPORTATION			
STRUCTURE B-66-17			
DRAWN BY: []			
CHECKED BY: []			
CROSS SECTION & QUANTITIES			
SHEET 2 OF 10			
140			

PLOT DATE : 7/30/2019

PLOT SCALE : 2.00000 ' / 1"



Proposal Schedule of Items

Proposal ID: 20190813005 Project(s): 1100-27-70, 1100-41-70, 1107-00-71

Federal ID(s): WISC 2019578, WISC 2019579, WISC 2019580

SECTION: 0001

Contract Items

Alt Set ID:

Alt Mbr ID:

Proposal Line Number	Item ID Description	Approximate Quantity and Units	Unit Price	Bid Amount
0030	206.1000 Excavation for Structures Bridges (structure) 03. B-66-194	LS	LUMP SUM	_____.
0032	208.0100 Borrow	8,026.000 CY	_____.	_____.
0034	210.1500 Backfill Structure Type A	780.000 TON	_____.	_____.
0036	213.0100 Finishing Roadway (project) 01. 1100-41-70	1.000 EACH	_____.	_____.
0038	213.0100 Finishing Roadway (project) 02. 1107-00-71	1.000 EACH	_____.	_____.
0040	305.0110 Base Aggregate Dense 3/4-Inch	13,081.000 TON	_____.	_____.
0042	305.0120 Base Aggregate Dense 1 1/4-Inch	10,171.000 TON	_____.	_____.
0044	305.0500 Shaping Shoulders	2,042.000 STA	_____.	_____.
0046	311.0110 Breaker Run	11,920.000 TON	_____.	_____.
0048	390.0403 Base Patching Concrete Shes	29,843.000 SY	_____.	_____.
0050	415.0410 Concrete Pavement Approach Slab	160.000 SY	_____.	_____.
0052	416.0610 Drilled Tie Bars	4,278.000 EACH	_____.	_____.
0054	416.0620 Drilled Dowel Bars	56,846.000 EACH	_____.	_____.
0056	416.1010 Concrete Surface Drains	17.000 CY	_____.	_____.
0058	450.4000 HMA Cold Weather Paving	2,421.000 TON	_____.	_____.
0060	455.0605 Tack Coat	21,636.000 GAL	_____.	_____.



Proposal Schedule of Items

Proposal ID: 20190813005 Project(s): 1100-27-70, 1100-41-70, 1107-00-71

Federal ID(s): WISC 2019578, WISC 2019579, WISC 2019580

SECTION: 0001

Contract Items

Alt Set ID:

Alt Mbr ID:

Proposal Line Number	Item ID Description	Approximate Quantity and Units	Unit Price	Bid Amount
0094	503.0128 Prestressed Girder Type I 28-Inch	468.000 LF	_____.	_____.
0096	505.0400 Bar Steel Reinforcement HS Structures	19,380.000 LB	_____.	_____.
0098	505.0600 Bar Steel Reinforcement HS Coated Structures	92,030.000 LB	_____.	_____.
0100	505.0800.S Bar Steel Reinforcement HS Stainless Structures	3,850.000 LB	_____.	_____.
0102	506.0105 Structural Steel Carbon	1,870.000 LB	_____.	_____.
0104	506.0605 Structural Steel HS	4,060.000 LB	_____.	_____.
0106	506.2605 Bearing Pads Elastomeric Non-Laminated	28.000 EACH	_____.	_____.
0108	506.3015 Welded Stud Shear Connectors 7/8x6-Inch	56.000 EACH	_____.	_____.
0110	506.4000 Steel Diaphragms (structure) 01. B-66-193	5.000 EACH	_____.	_____.
0112	506.4000 Steel Diaphragms (structure) 02. B-66-194	5.000 EACH	_____.	_____.
0114	511.1200 Temporary Shoring (structure) 01. B-66-17	190.000 SF	_____.	_____.
0116	512.1000 Piling Steel Sheet Temporary	250.000 SF	_____.	_____.
0118	516.0500 Rubberized Membrane Waterproofing	70.000 SY	_____.	_____.
0120	520.1015 Apron Endwalls for Culvert Pipe 15-Inch	2.000 EACH	_____.	_____.
0122	520.2015 Culvert Pipe Temporary 15-Inch	490.000 LF	_____.	_____.



Proposal Schedule of Items

Proposal ID: 20190813005 Project(s): 1100-27-70, 1100-41-70, 1107-00-71

Federal ID(s): WISC 2019578, WISC 2019579, WISC 2019580

SECTION: 0001

Contract Items

Alt Set ID:

Alt Mbr ID:

Proposal Line Number	Item ID Description	Approximate Quantity and Units	Unit Price	Bid Amount
0372	SPV.0195 Special 01. Excavation, Hauling, and Disposal of Creosote Contaminated Soil	5.000 TON	_____.	_____.
0374	415.0090 Concrete Pavement 9-Inch	96.000 SY	_____.	_____.
	Section: 0001		Total:	_____.
			Total Bid:	_____.