



# Wisconsin Department of Transportation

## Division of Transportation Systems Development

Bureau of Project Development  
4822 Madison Yards Way, 4<sup>th</sup> Floor South  
Madison, WI 53705

March 3, 2020

Telephone: (608) 266-1631  
Facsimile (FAX): (608) 266-8459

### NOTICE TO ALL CONTRACTORS:

**Proposal #21: 1166-00-79, WISC 2020 078**  
**Stevens Point - Wausau**  
**N 2<sup>nd</sup> St to CTH X**  
**IH 39**  
**Portage County**

### Letting of March 10, 2020

This is Addendum No. 02, which provides for the following:

#### Schedule of Items:

Added Bid Item Quantities					
Bid Item	Item Description	Unit	Old Quantity	Revised Quantity	Proposal Total
305.0500	Shaping Shoulders	STA	0	760	760

#### Plan Sheets:

Revised Plan Sheets	
Plan Sheet	Plan Sheet Title (brief description of changes to sheet)
34, 35	Added to notes on traffic control typical sections "paid as shaping shoulders"
96	Changed density acceptance from 460.2005 to 460.2000

Added Plan Sheets	
Plan Sheet	Plan Sheet Title (brief description of why sheet was added)
105A	Miscellaneous quantity sheet for Shaping Shoulders bid item

**Schedule of Items**

Attached, dated March 3, 2020, are the revised Schedule of Items Page 7.

**Plan Sheets**

The following 8½ x 11-inch sheets are attached and made part of the plans for this proposal:

Revised: 34, 35 and 96.

Added: 105A.

The responsibility for notifying potential subcontractors and suppliers of these changes remains with the prime contractor.

Sincerely,

*Mike Coleman*

Proposal Development Specialist  
Proposal Management Section

END OF ADDENDUM

Addendum No. 02  
 ID 1166-00-79  
 Revised Sheet 34  
 March 3, 2020

2

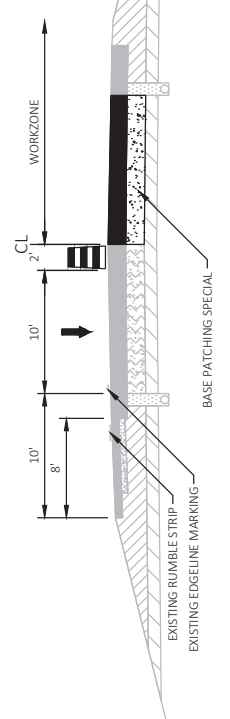

TRAFFIC CONTROL TYPICAL SECTION IH 39  
 STAGE 1

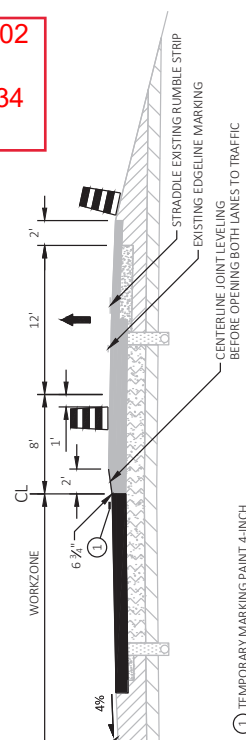

STAGE 1 NOTES:  
 MILL NB PASSING LANE AND INSIDE SHOULDER FULL DEPTH  
 PAVE NB PASSING LANE AND INSIDE SHOULDER HMA LOWER LAYERS  
 RESTORE NB INSIDE SHOULDER TO BE FLUSH  
 INSTALL TEMPORARY MARKING PAINT CENTERLINE  
 BASE PATCH SB PASSING LANE

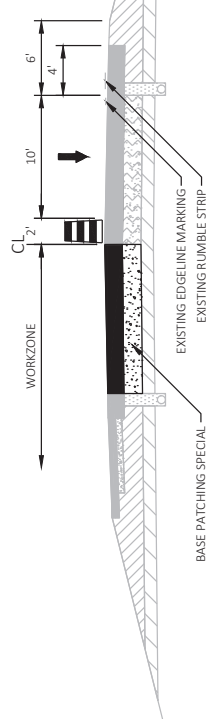

TRAFFIC CONTROL TYPICAL SECTION IH 39  
 STAGE 2

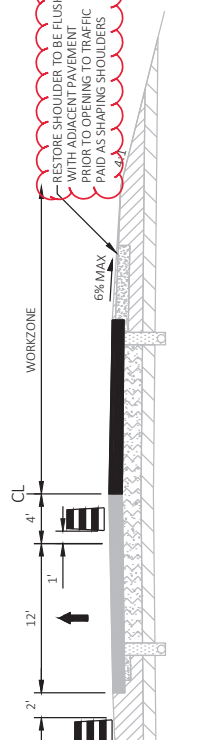

STAGE 2 NOTES:  
 MILL NB DRIVING LANE AND OUTSIDE SHOULDER FULL DEPTH  
 PAVE NB DRIVING LANE HMA LOWER LAYERS  
 RESTORE OUTSIDE SHOULDER TO BE FLUSH  
 BASE PATCH SB DRIVING LANE

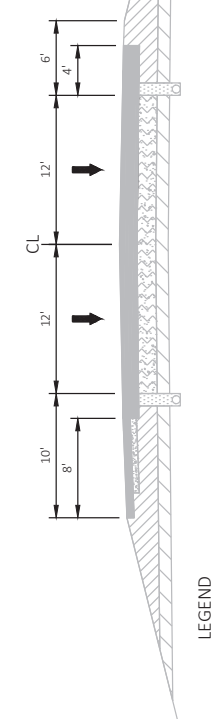

TRAFFIC CONTROL TYPICAL SECTION IH 39  
 STAGE 3A

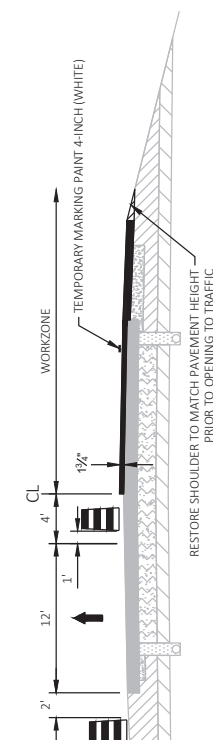

STAGE 3A NOTES:  
 PAVE NB DRIVING LANE HMA SURFACE LAYER  
 PAVE NB OUTSIDE SHOULDER  
 RESTORE AND FINISH OUTSIDE SHOULDER  
 INSTALL TEMPORARY MARKING PAINT ON EDGELINE

- LEGEND**
- EXISTING HMA PAVEMENT
  - EXISTING RUBBLIZED CONCRETE PAVEMENT
  - EXISTING BASE AGGREGATE DENSE 3/4-INCH
  - EXISTING BASE AGGREGATE DENSE 1 1/2-INCH
  - EXISTING PULVERIZED AND RELAXED HMA
  - EXISTING BASE AGGREGATE OPENED GRADED
  - HMA PAVEMENT

Addendum No. 02  
 ID 1166-00-79  
 Revised Sheet 35  
 March 3, 2020

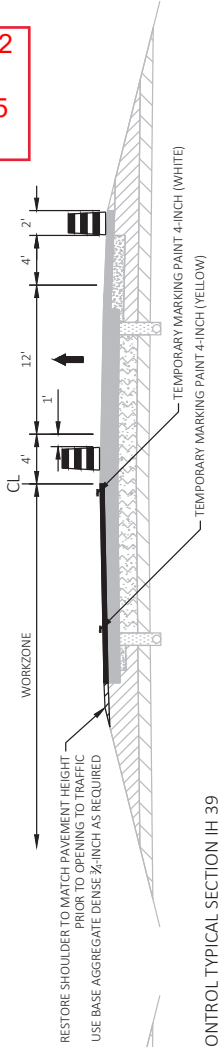

STAGE 3B NOTES:  
 PAVE NB PASSING LANE HMA SURFACE LAYER  
 RESTORE AND FINISH INSIDE SHOULDER  
 INSTALL TEMPORARY MARKING PAINT ON EDGE LINE AND CENTERLINE

TRAFFIC CONTROL TYPICAL SECTION IH 39  
 STAGE 3B

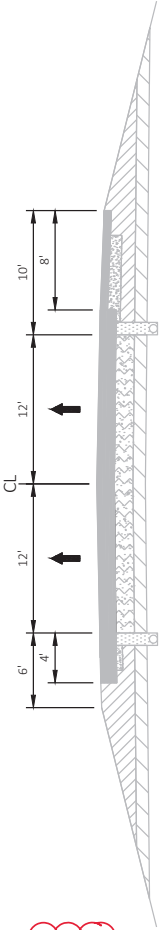

STAGE 4 NOTES:  
 MILL SB PASSING LANE AND INSIDE SHOULDER FULL DEPTH  
 PAVE SB PASSING LANE AND INSIDE SHOULDER HMA LOWER LAYERS  
 RESTORE SB INSIDE SHOULDER TO BE FLUSH  
 INSTALL TEMPORARY MARKING PAINT CENTERLINE

TRAFFIC CONTROL TYPICAL SECTION IH 39  
 STAGE 4

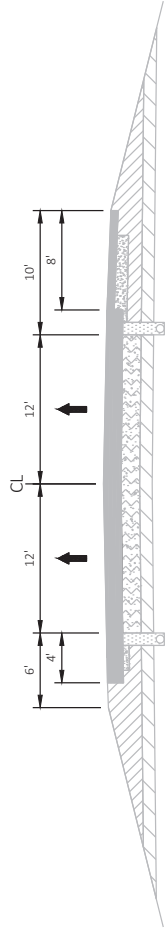

STAGE 5 NOTES:  
 MILL SB DRIVING LANE AND OUTSIDE SHOULDER FULL DEPTH  
 PAVE SB DRIVING LANE HMA LOWER LAYERS  
 RESTORE OUTSIDE SHOULDER TO BE FLUSH

TRAFFIC CONTROL TYPICAL SECTION IH 39  
 STAGE 5

RESTORE SHOULDER TO BE FLUSH WITH ADJACENT PAVEMENT PRIOR TO OPENING TO TRAFFIC PAID AS SHAPING SHOULDERS

RESTORE SHOULDER TO BE FLUSH WITH ADJACENT PAVEMENT PRIOR TO OPENING TO TRAFFIC PAID AS SHAPING SHOULDERS

LEGEND

- EXISTING HMA PAVEMENT
- EXISTING RUBBLIZED CONCRETE PAVEMENT
- EXISTING BASE AGGREGATE DENSE 1/2-INCH
- EXISTING BASE AGGREGATE DENSE 1 1/2-INCH
- EXISTING PULVERIZED AND RELAYED HMA
- EXISTING BASE AGGREGATE OPENED GRADED
- HMA PAVEMENT

Addendum No. 02  
 ID 1166-00-79  
 Revised Sheet 96  
 March 3, 2020

3

PWL MIXTURE USE TABLE

STATION	LOCATION	MIXTURE USE	UNDERLYING SURFACE	BID ITEM	*TONS	THICKNESS (IN)	QUALITY MANAGEMENT PROGRAM TO BE USED:	IDENSITY ACCEPTANCE
1509+00 - 1686+00	IH 39 NB 24 FOOT DRIVING LANE	LOWER LAYER	RUBBLIZED CONCRETE	2 HT 58-28 S	10178	3.5 AVE	INCENTIVE AIR VOIDS PWL HMA PAVEMENT 460.2010	INCENTIVE DENSITY HMA PAVEMENT 460.2000
1509+00 - 1686+00	IH 39 NB 24 FOOT DRIVING LANE	LOWER LAYER	2 HT 58-28 H	3 HT 58-28 S	6107	2.25	INCENTIVE AIR VOIDS PWL HMA PAVEMENT 460.2010	INCENTIVE DENSITY PWL HMA PAVEMENT 460.2005
1509+00 - 1686+00	IH 39 NB 24 FOOT DRIVING LANE	UPPER LAYER	3 HT 58-28 H	4 HT 58-28 H	5428	2	INCENTIVE AIR VOIDS PWL HMA PAVEMENT 460.2010	INCENTIVE DENSITY PWL HMA PAVEMENT 460.2005
1509+00 - 1686+00	IH 39 NB 8 FOOT OUTSIDE SHOULDER	UPPER LAYER	BASE AGGREGATE/PULVERIZED HMA	3 HT 58-28 S	2422	3.5	QMP AS PER SS 460	INCENTIVE DENSITY HMA PAVEMENT 460.2000
1509+00 - 1686+00	IH 39 NB 4 FOOT INSIDE SHOULDER	LOWER LAYER	BASE AGGREGATE/PULVERIZED HMA	2 HT 58-28 S	2544	3.5 AVE	INCENTIVE AIR VOIDS PWL HMA PAVEMENT 460.2010	ACCEPTANCE TESTING BY THE DEPARTMENT; NOT ELIGIBLE FOR INCENTIVE
1509+00 - 1686+00	IH 39 NB 2 FOOT OUTSIDE SHOULDER	LOWER LAYER	BASE AGGREGATE/PULVERIZED HMA	3 HT 58-28 S	1527	2.25	INCENTIVE AIR VOIDS PWL HMA PAVEMENT 460.2010	ACCEPTANCE TESTING BY THE DEPARTMENT; NOT ELIGIBLE FOR INCENTIVE
1509+00 - 1686+00	IH 39 NB 4 FOOT INSIDE SHOULDER	UPPER LAYER	3 HT 58-28 H	4 HT 58-28 H	1357	2	INCENTIVE AIR VOIDS PWL HMA PAVEMENT 460.2010	ACCEPTANCE TESTING BY THE DEPARTMENT; NOT ELIGIBLE FOR INCENTIVE
1484+00 - 1488+00	IH 39 SB 24 FOOT DRIVING LANE	LOWER LAYER	RUBBLIZED CONCRETE	2 HT 58-28 S	9315	3.5 AVE	INCENTIVE AIR VOIDS PWL HMA PAVEMENT 460.2010	INCENTIVE DENSITY HMA PAVEMENT 460.2000
1510+50 - 1604+00	IH 39 SB 24 FOOT DRIVING LANE	LOWER LAYER	BASE AGGREGATE OPEN GRADED	2 HT 58-28 S	2185	3.5 AVE	INCENTIVE AIR VOIDS PWL HMA PAVEMENT 460.2010	INCENTIVE DENSITY HMA PAVEMENT 460.2000
1488+00 - 1510+50	IH 39 SB 24 FOOT DRIVING LANE	LOWER LAYER	2 HT 58-28 H	3 HT 58-28 S	6900	2.25	INCENTIVE AIR VOIDS PWL HMA PAVEMENT 460.2010	INCENTIVE DENSITY PWL HMA PAVEMENT 460.2005
1484+00 - 1684+00	IH 39 SB 24 FOOT DRIVING LANE	UPPER LAYER	3 HT 58-28 H	4 HT 58-28 H	5367	1.75	INCENTIVE AIR VOIDS PWL HMA PAVEMENT 460.2010	INCENTIVE DENSITY PWL HMA PAVEMENT 460.2005
1484+00 - 1684+00	IH 39 SB 8 FOOT OUTSIDE SHOULDER	UPPER LAYER	BASE AGGREGATE/PULVERIZED HMA	3 HT 58-28 S	2918	3.5	QMP AS PER SS 460	INCENTIVE DENSITY HMA PAVEMENT 460.2000
1484+00 - 1684+00	IH 39 SB 4 FOOT INSIDE SHOULDER	LOWER LAYER	BASE AGGREGATE	2 HT 58-28 S	2875	3	INCENTIVE AIR VOIDS PWL HMA PAVEMENT 460.2010	ACCEPTANCE TESTING BY THE DEPARTMENT; NOT ELIGIBLE FOR INCENTIVE
1484+00 - 1684+00	IH 39 SB 4 FOOT INSIDE SHOULDER	LOWER LAYER	2 HT 58-28 H	3 HT 58-28 S	1725	2.25	INCENTIVE AIR VOIDS PWL HMA PAVEMENT 460.2010	ACCEPTANCE TESTING BY THE DEPARTMENT; NOT ELIGIBLE FOR INCENTIVE
1484+00 - 1684+00	IH 39 SB 2 FOOT INSIDE SHOULDER	UPPER LAYER	3 HT 58-28 H	4 HT 58-28 H	1342	1.75	INCENTIVE AIR VOIDS PWL HMA PAVEMENT 460.2010	ACCEPTANCE TESTING BY THE DEPARTMENT; NOT ELIGIBLE FOR INCENTIVE
VARIOUS	RAMPS	LAYER	MILLED EXISTING HMA SURFACE	4 HT 58-28 H	1170	2	QMP AS PER SS 460	INCENTIVE DENSITY HMA PAVEMENT 460.2000
VARIOUS	RAMP TAPERS	LOWER LAYER	MILLED EXISTING HMA SURFACE	4 HT 58-28 H	941	2.25	QMP AS PER SS 460	INCENTIVE DENSITY HMA PAVEMENT 460.2000
VARIOUS	RAMP TAPERS	UPPER LAYER	4 HT 58-28 H	4 HT 58-28 H	1139	1.75/2	QMP AS PER SS 460	INCENTIVE DENSITY HMA PAVEMENT 460.2000
11+25 - 28+50	CASIMIR RD	UPPER LAYER	MILLED EXISTING HMA SURFACE	4 HT 58-28 H	703	2	QMP AS PER SS 460	INCENTIVE DENSITY HMA PAVEMENT 460.2000

\*QUANTITIES ARE APPROXIMATE

PROJECT NO: 1166-00-79

HWY: IH 39

COUNTY: PORTAGE

PLOT DATE: March 2, 2020

PLOT BY: Zach Gungor

MISCELLANEOUS QUANTITIES

SHEET: 96

E

3

Addendum No. 02  
ID 1166-00-79  
Added Sheet 105A  
March 3, 2020

**SHAPING SHOULDERS**

STATION - STATION	LOCATION	305.0500 STATION	REMARKS
1508+50 - 1686+50	NB LT	178	STAGE 1
1508+50 - 1686+50	NB RT	178	STAGE 2
1483+50 - 1484+51	SB RT	1	STAGE 4
1483+44 - 1684+50	SB RT	201	STAGE 4
1483+50 - 1484+51	SB LT	1	STAGE 5
1483+44 - 1684+50	SB LT	201	STAGE 5
<b>TOTAL</b>			<b>760</b>



Proposal Schedule of Items

Proposal ID: 20200310021 Project(s): 1166-00-79  
Federal ID(s): WISC 2020078

SECTION: 0001 Contract Items

Alt Set ID: Alt Mbr ID:

Proposal Line Number	Item ID Description	Approximate Quantity and Units	Unit Price	Bid Amount
0188	305.0500 Shaping Shoulders	760.000 STA	_____.	_____.
	Section: 0001		Total:	_____.
			Total Bid:	_____.

