



Wisconsin Department of Transportation

February 16, 2021

Division of Transportation Systems Development

Bureau of Project Development
4822 Madison Yards Way, 4th Floor South
Madison, WI 53705

Telephone: (608) 266-1631
Facsimile (FAX): (608) 266-8459

NOTICE TO ALL CONTRACTORS:

Proposal #10: 1009-33-25
Region Wide Deck Sealing FY21
Various Backbone Routes STH
Var Hwy
Northeast Region Wide County

1009-33-32
Region Wide Deck Sealing FY21
Various 3R/LCB Routes STH
Var Hwy
Northeast Region Wide County

Letting of March 9, 2021

This is Addendum No. 01, which provides for the following:

Special Provisions:

Revised Special Provisions	
Article No.	Description
5	Traffic

Schedule of Items:

Revised Bid Item Quantities					
Bid Item	Item Description	Unit	Old Quantity	Revised Quantity	Proposal Total
502.3215.S	Protective Surface Treatment Reseal	SY	84,111	-861	83,250

Plan Sheets:

Revised Plan Sheets	
Plan Sheet	Plan Sheet Title (brief description of changes to sheet)
3	Traffic Control and Work Restrictions Removed B-36-0093 from list
9	Misc Quantities. Remove B-36-0093 from quantity table. Updated page total
10	Misc Quantities. Update Manitowoc County Total and ID total quantity
12	Misc Quantities. Update Traffic Control Signs PCMS remarks with bridge locations
14	Plan/Manitowoc County Backbone Routes Removed B-36-0093

The responsibility for notifying potential subcontractors and suppliers of these changes remains with the prime contractor.

Sincerely,

Mike Coleman

Proposal Development Specialist
Proposal Management Section

ADDENDUM NO. 01
1009-33-25/1009-33-32
February 16, 2021

Special Provisions

5. Traffic.

*Replace paragraph two under section titled **Portable Changeable Message Signs – Message Prior Approval** with the following:*

PCMS boards must be deployed 7 days before the lane closure for structure as noted in the plans.

Schedule of Items

Attached, dated February 16, 2021, are the revised Schedule of Items Page 1.

Plan Sheets

The following 8½ x 11-inch sheets are attached and made part of the plans for this proposal:

Revised: 3, 9, 10, 12, and 14.

END OF ADDENDUM

TRAFFIC CONTROL AND WORK RESTRICTIONS

Addendum No. 01
ID 1009-33-25
Revised Sheet 3
February 16, 2021

COUNTY	BRIDGE NO.	ON	OVER	TRAFFIC CONTROL	WORK RESTRICTIONS	WORK RESTRICTIONS	WORK RESTRICTIONS
IH 43							
BROWN	B-05-0187	IH 43 NB	GLENMORE RD	LANE CLOSURE	THURS: 2PM-6PM	FRI: 10AM-7PM	SAT: 10AM-1PM
BROWN	B-05-0188	IH 43 SB	GLENMORE RD	LANE CLOSURE	SUN: 10AM-6PM		
BROWN	B-05-0194	ALLOUEZ AVE	IH 43	FLAGGING OPERATION			
BROWN	B-05-0196	USH 141-STH 29	IH 43	FLAGGING OPERATION	MON-FRI: 4PM-6PM		
BROWN	B-05-0198	CTH JJ	IH 43	FLAGGING OPERATION	MON-FRI: 6AM-8PM		
BROWN	B-05-0201	GREENBRIER RD	IH 43	FLAGGING OPERATION			
BROWN	B-05-0227	MILITARY AVE	IH 43	FLAGGING OPERATION			
BROWN	B-05-0234	COOPERSTOWN RD	IH 43	FLAGGING OPERATION			
BROWN	B-05-0240	IH 43 SB	TOWN HALL RD	LANE CLOSURE	SUN: 10AM-6PM		
BROWN	B-05-0241	IH 43 NB	TOWN HALL RD	LANE CLOSURE	THURS: 2PM-6PM	FRI: 10AM-7PM	SAT: 10AM-1PM
BROWN	B-05-0242	LANGES CORNER ROAD	IH 43	FLAGGING OPERATION			
BROWN	B-05-0247	IH 43 SB	SHADOW LANE	LANE CLOSURE	SUN: 10AM-6PM		
BROWN	B-05-0248	IH 43 NB	SHADOW LANE	LANE CLOSURE	THURS: 2PM-6PM	FRI: 10AM-7PM	SAT: 10AM-1PM
BROWN	B-05-0254	NORTH RD	IH 43	FLAGGING OPERATION			
MANITOWOC	B-36-0037	S CLEVELAND RD	IH 43	FLAGGING OPERATION			
MANITOWOC	B-36-0039	CTH XX	IH 43	FLAGGING OPERATION			
MANITOWOC	B-36-0040	IH 43 SB	CTH F	LANE CLOSURE	SUN: 10AM-6PM		
MANITOWOC	B-36-0043	FISHER CREEK RD	IH 43	FLAGGING OPERATION			
MANITOWOC	B-36-0045	CTH X	IH 43	FLAGGING OPERATION			
MANITOWOC	B-36-0046	POINT CREEK RD	IH 43	FLAGGING OPERATION			
MANITOWOC	B-36-0047	IH 43 SB	POINT CREEK	LANE CLOSURE	SUN: 10AM-6PM		
MANITOWOC	B-36-0050	IH 43 SB	CTH C	LANE CLOSURE	SUN: 10AM-6PM		
MANITOWOC	B-36-0051	IH 43 NB	CTH C	LANE CLOSURE	THURS: 2PM-6PM	FRI: 11AM-7PM	SAT: 10AM-12PM
MANITOWOC	B-36-0056	IH 43 SB	CLOVER RD	LANE CLOSURE	SUN: 10AM-6PM		
MANITOWOC	B-36-0057	IH 43 NB	CLOVER RD	LANE CLOSURE	THURS: 2PM-6PM	FRI: 11AM-7PM	SAT: 10AM-12PM
MANITOWOC	B-36-0059	SILVER CREEK ROAD	IH 43	FLAGGING OPERATION			
MANITOWOC	B-36-0069	MIDDLE RD	IH43-STH 42	FLAGGING OPERATION			
MANITOWOC	B-36-0074	COUNTY LINE RD	IH 43	FLAGGING OPERATION			
MANITOWOC	B-36-0079	ROCKWOOD RD	IH 43	FLAGGING OPERATION			
MANITOWOC	B-36-0080	REFS MILL RD	IH 43	FLAGGING OPERATION			
MANITOWOC	B-36-0083	HIDDEN VALLEY RD	IH 43	FLAGGING OPERATION			
MANITOWOC	B-36-0084	POLUKA RD	IH 43	FLAGGING OPERATION			
MANITOWOC	B-36-0085	CTH P	IH43 - USH 10	FLAGGING OPERATION			
MANITOWOC	B-36-0088	FISHERVILLE RD (CTH Y)	IH 43	FLAGGING OPERATION			
MANITOWOC	B-36-0089	ZANDER RD	IH 43	FLAGGING OPERATION			
MANITOWOC	B-36-0090	GREEN STREET RD	IH 43	FLAGGING OPERATION			
MANITOWOC	B-36-0104	IH 43 NB	ROSCRAINS RD	LANE CLOSURE	THURS: 2PM-6PM	FRI: 11AM-7PM	SAT: 10AM-12PM

STATE PROJECT NO. 1009-33-25

HWY: VARIOUS

COUNTY: NORTHEAST REGION

TRAFFIC CONTROL

SHEET NO: 3

E

Project ID	COUNTY	ROUTE	CORRIDOR	OVER	BRIDGE NO.	LENGTH [FT]	* PARAPETS [SY]	CONCRETE MEDIAN & SIDEWALK [SY]	DECK [SY]	502.3215.S SURFACE TREATMENT RESEAL [SY]	Remarks
1009-33-25	MANITOWOC	S CLEVELAND RD	IH 43	IH 43	B-36-0037	219.2	188	0	828	1016	
1009-33-25	MANITOWOC	CTH XX	IH 43	IH 43	B-36-0039	262.2	213	7	1,806	2026	
1009-33-25	MANITOWOC	IH 43 SB	IH 43	CTH F	B-36-0040	118.0	98	0	525	623	
1009-33-25	MANITOWOC	FISHER CREEK RD	IH 43	IH 43	B-36-0043	303.2	246	0	1,011	1257	
1009-33-25	MANITOWOC	CTH X	IH 43	IH 43	B-36-0045	347.2	297	0	1,312	1609	
1009-33-25	MANITOWOC	POINT CREEK RD	IH 43	IH 43	B-36-0046	345.7	295	0	1,153	1448	
1009-33-25	MANITOWOC	IH 43	IH 43	POINT CREEK	B-36-0047	91.3	86	0	539	625	
1009-33-25	MANITOWOC	IH 43 SB	IH 43	CTH C	B-36-0050	195.6	161	0	869	1030	
1009-33-25	MANITOWOC	IH 43 NB	IH 43	CTH C	B-36-0051	195.6	161	0	869	1030	
1009-33-25	MANITOWOC	IH 43 SB	IH 43	CLOVER RD	B-36-0056	118.7	94	0	527	622	
1009-33-25	MANITOWOC	IH 43 NB	IH 43	CLOVER RD	B-36-0057	118.7	94	0	527	622	
1009-33-25	MANITOWOC	SILVER CREEK ROAD	IH 43	IH 43	B-36-0059	221.7	180	0	788	968	
1009-33-25	MANITOWOC	MIDDLE RD	IH 43	IH 43-5TH 42	B-36-0069	249.2	212	0	831	1043	
1009-33-25	MANITOWOC	COUNTY LINE RD	IH 43	IH 43	B-36-0074	228.2	195	0	761	956	
1009-33-25	MANITOWOC	ROCKWOOD RD	IH 43	IH 43	B-36-0079	249.2	202	0	831	1033	
1009-33-25	MANITOWOC	REIFS MILL RD	IH 43	IH 43	B-36-0080	221.1	189	0	737	926	
1009-33-25	MANITOWOC	HIDDEN VALLEY RD	IH 43	IH 43	B-36-0083	222.7	191	0	742	933	
1009-33-25	MANITOWOC	POLIFKA RD	IH 43	IH 43	B-36-0084	386.7	331	0	1,289	1620	
1009-33-25	MANITOWOC	CTH P	IH 43	IH 43 - USH 10	B-36-0085	246.8	211	0	1,097	1308	
1009-33-25	MANITOWOC	FISCHERVILLE RD (CTH Y)	IH 43	IH 43	B-36-0088	234.8	201	0	783	984	
1009-33-25	MANITOWOC	ZANDER RD	IH 43	IH 43	B-36-0089	344.2	279	0	1,147	1427	
1009-33-25	MANITOWOC	GREEN STREET RD	IH 43	IH 43	B-36-0090	253.7	217	0	855	1072	
1009-33-25	MANITOWOC	IH 43 NB	IH 43	ROSEGRANS RD	B-36-0104	124.7	101	0	554	655	
MANITOWOC COUNTY TOTAL										24829	

* SURFACE AREA (INSIDE FACE AND TOP)

Project ID	COUNTY	ROUTE	CORRIDOR	OVER	BRIDGE NO.	LENGTH [FT]	* PARAPETS [SY]	CONCRETE MEDIAN & SIDEWALK [SY]	DECK [SY]	502.3215.S PROTECTIVE SURFACE TREATMENT RESEAL [SY]	Remarks
1009-33-25	SHEBOYGAN	IH 43 NB	IH 43	CNW RR	B-59-0029	188.6	103	52	817	972	
1009-33-25	SHEBOYGAN	IH 43 SB	IH 43	DEWITT RD	B-59-0040	128.3	70	36	570	676	
1009-33-25	SHEBOYGAN	IH 43 NB	IH 43	DEWITT RD	B-59-0041	128.3	70	36	570	676	
1009-33-25	SHEBOYGAN	CTH KK	IH 43	IH 43	B-59-0044	266.2	216	0	1,020	1,236	
1009-33-25	SHEBOYGAN	IH 43 SB	IH 43	CNW RR	B-59-0052	187.3	102	52	822	976	
1009-33-25	SHEBOYGAN	GARTON RD	IH 43	IH 43	B-59-0068	218.2	177	0	727	904	
1009-33-25	SHEBOYGAN	ROE RD	IH 43	IH 43	B-59-0069	226.0	183	0	753	937	
1009-33-25	SHEBOYGAN	ORCHARD RD	IH 43	IH 43	B-59-0073	220.7	179	0	736	915	
SHEBOYGAN COUNTY TOTAL										7291	

* SURFACE AREA (INSIDE FACE AND TOP)

BROWN COUNTY TOTAL 18772
 MANITOWOC COUNTY TOTAL 24829
 SHEBOYGAN COUNTY TOTAL 7291
 PROJECT 1009-33-25 TOTAL 50,892

Project ID	COUNTY	ROUTE	CORRIDOR	OVER	BRIDGE NO.	LENGTH [FT]	* PARAPETS [SY]	CONCRETE MEDIAN & SIDEWALK [SY]	DECK [SY]	502.3215.S PROTECTIVE SURFACE TREATMENT RESEAL [SY]	Remarks
1009-33-32	SHEBOYGAN	STH 57	STH 57	SHEBOYGAN RIVER	B-59-0006	94.0	0	0	377	377	
1009-33-32	SHEBOYGAN	STH 28 EB/ STH 57 NB (MILL ST)	STH 57	ONION RIVER	B-59-0013	41.5	24	0	184	208	
1009-33-32	SHEBOYGAN	STH 32	STH 32	ONION RIVER	B-59-0027	109.8	89	0	439	528	
1009-33-32	SHEBOYGAN	STH 42	STH 42	PIGEON RIVER	B-59-0066	72.0	0	0	303	303	
1009-33-32	SHEBOYGAN	CTHY	STH 23	STH 23	B-59-0080	211.6	184	308	1,635	2127	
1009-33-32	SHEBOYGAN	STH 23 EB	STH 23	STH 67	B-59-0091	392.5	318	0	2,684	3003	
1009-33-32	SHEBOYGAN	STH 23 EB	STH 23	SUNSET DRIVE/RR	B-59-0097	277.0	225	0	1,354	1579	
1009-33-32	SHEBOYGAN	STH 32-WISCONSIN DR	STH 32	FISHER CREEK	B-59-0134	51.5	30	64	252	346	
1009-33-32	SHEBOYGAN	STH 28 WB/ STH 57 SB (MILL ST)	STH 57	ONION RIVER	B-59-0158	59.8	0	0	278	278	
1009-33-32	SHEBOYGAN	CTHC	STH 23	STH 23	B-59-0179	279.8	221	715	1,582	2518	
1009-33-32	SHEBOYGAN	STH 23 WB	STH 23	SUNSET DRIVE	B-59-0180	279.7	227	0	1,243	1470	
1009-33-32	SHEBOYGAN	STH 57	STH 57	CTH A	B-59-0308	142.5	116	0	697	812	
1009-33-32	SHEBOYGAN	STH 23 WB	STH 23	STH 67	B-59-0309	398.9	324	0	1,979	2302	
SHEBOYGAN COUNTY TOTAL										15851	

* SURFACE AREA (INSIDE FACE AND TOP)

DOOR COUNTY TOTAL 7127
KEWAUNEE COUNTY TOTAL 1411
MANITOWOC COUNTY TOTAL 7968
SHEBOYGAN COUNTY TOTAL 15851
PROJECT 1009-33-32 TOTAL 32,358

TRAFFIC CONTROL SIGNS PCMS

Project ID	ROADWAY	APPROX. SERVICE PERIOD DAYS	NUMBER IN SERVICE	643.1050 DAY	REMARKS
1009-33-25	IH 43	7	12	84	B-05-0194, B-05-0196, B-05-0196, B-05-0201, B-36-0039, B-59-0069, B-15-0100-001.002.
1009-33-32	STH 57	7	4	28	
TOTAL 0010			112	112	

NOTE: ADDITIONAL ADVANCED WARNING WILL BE NECESSARY IF LOCAL BRIDGES ARE COMPLETELY CLOSED. SEE SPECIAL PROVISIONS FOR LOCATIONS.

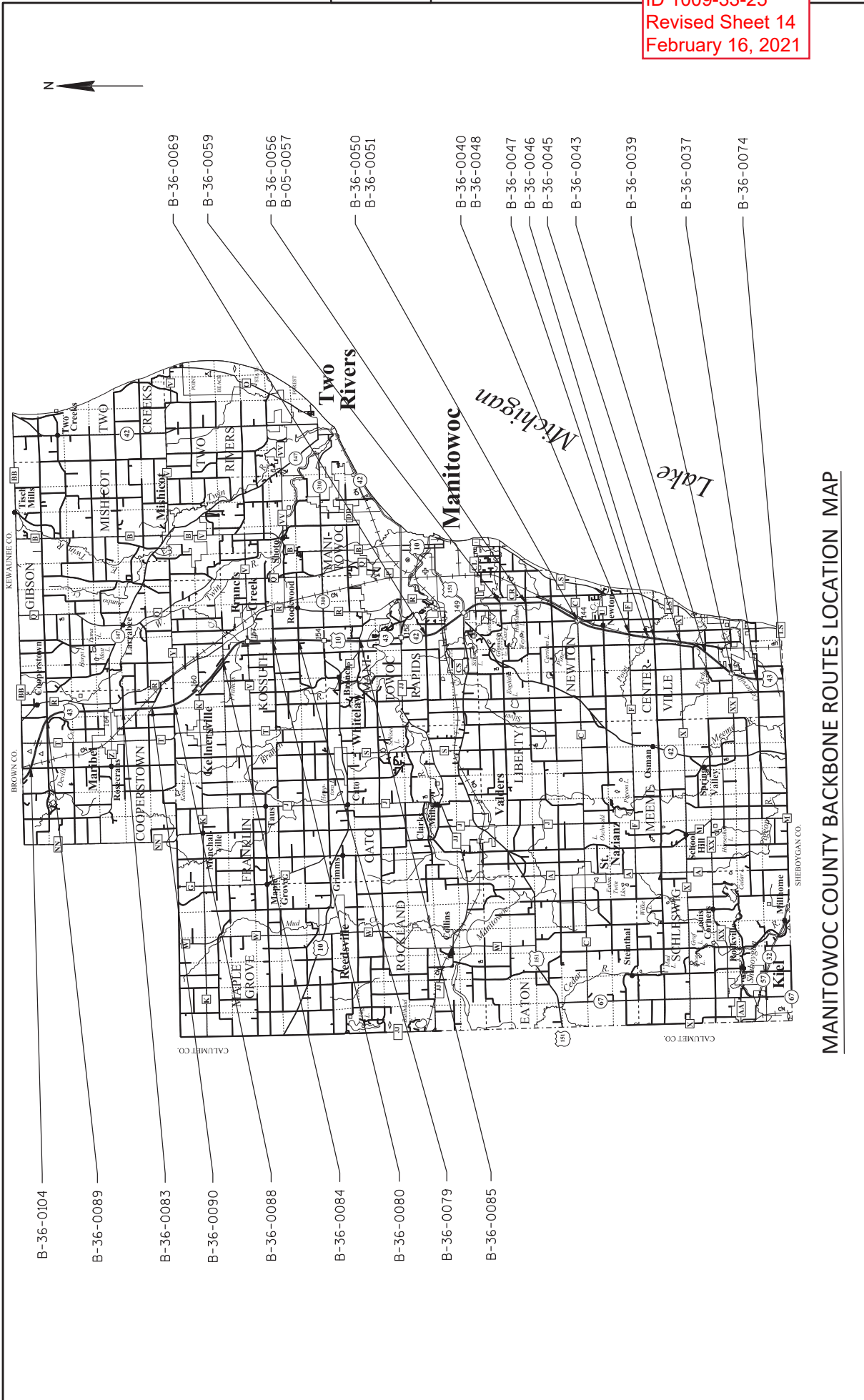

MANITOWOC COUNTY BACKBONE ROUTES LOCATION MAP

PROJECT NO: 1009-33-25	COUNTY: NORTHEAST REGION WIDE	PLAN	SHEET 14
FILE NAME: C:\CIVIL 3D\PROJECTS\100933\33\SHEETS\PLAN\100933-25_BB\SHEETS\PLAN\0502_P\DWG	FLY BY: HARDY, BARBARA A	PLOT NAME:	WISDOT/CADDIS SHEET 14
LAYOUT NAME: 01	FLY DATE: 2/17/2021 11:30 AM	PLOT SCALE: 1 IN=3.5 MI	

5

5



Proposal Schedule of Items

Proposal ID: 20210309010 Project(s): 1009-33-25, 1009-33-32

Federal ID(s): N/A, N/A

SECTION: 0001 Contract Items

Alt Set ID: Alt Mbr ID:

Proposal Line Number	Item ID Description	Approximate Quantity and Units	Unit Price	Bid Amount
0002	502.3215.S Protective Surface Treatment Reseal	83,250.000 SY	_____.	_____.
0004	619.1000 Mobilization	1.000 EACH	_____.	_____.
0006	643.1050 Traffic Control Signs PCMS	112.000 DAY	_____.	_____.
0008	SPV.0105 Special 01. Traffic Control 1009-33-25	LS	LUMP SUM	_____.
0010	SPV.0105 Special 02. Traffic Control 1009-33-32	LS	LUMP SUM	_____.
Section: 0001			Total:	_____.
			Total Bid:	_____.