



# Wisconsin Department of Transportation

November 1, 2021

**Division of Transportation Systems Development**  
 Bureau of Project Development  
 4822 Madison Yards Way, 4<sup>th</sup> Floor South  
 Madison, WI 53705

Telephone: (608) 266-1631  
 Facsimile (FAX): (608) 266-8459

## NOTICE TO ALL CONTRACTORS:

**Proposal #25: 1560-00-70, WISC 2022043**  
**Spoooner - Hayward**  
**Greenwood Ave To Poplar Street**  
**USH 63**  
**Washburn County**

**1560-00-80**  
**Spoooner - Hayward**  
**Greenwood Ave To Poplar Street**  
**USH 63**  
**Washburn County**

## Letting of November 9, 2021

This is Addendum No. 01, which provides for the following:

### Schedule of Items:

Revised Bid Item Quantities					
Bid Item	Item Description	Unit	Old Quantity	Revised Quantity	Proposal Total
643.0900	Traffic Control Signs	Days	89,322	-38,703	50,619
643.0920	Covering Signs Type II	Each	256	-252	4
643.1000	Traffic Control Signs Fixed Message	SF	256	-84	172
646.6464	Cold Weather Marking Line Epoxy 4-Inch	LF	26,908	-15,057	11,851
646.6468	Cold Weather Marking Line Epoxy 8-Inch	LF	746	-627	119
649.0150	Temporary Marking Line Removable Tape 4-Inch	LF	12,420	-940	11,480

Added Bid Item Quantities					
Bid Item	Item Description	Unit	Old Quantity	Revised Quantity	Proposal Total
646.1020	Marking Line Epoxy 4-Inch	LF	0	15,057	15,057
646.3020	Marking Line Epoxy 8-Inch	LF	0	627	627
649.0960	Temporary Marking Removable Mask Out Tape 6-Inch	LF	0	760	760

### Plan Sheets:

Revised Plan Sheets	
Plan Sheet	Plan Sheet Title (brief description of changes to sheet)
213	Changed the 4-Inch Tape to Temporary Marking Removable Mask Out Tape 6-Inch
259	Updates to MQs as noted above
260	Updates to MQs as noted above

**Schedule of Items**

Attached, dated November 1, 2021, are the revised Schedule of Items Pages 10, 11, and 20.

**Plan Sheets**

The following 8½ x 11-inch sheets are attached and made part of the plans for this proposal:

Revised: 213, 259, and 260

The responsibility for notifying potential subcontractors and suppliers of these changes remains with the prime contractor.

Sincerely,

*Mike Coleman*

Proposal Development Specialist  
Proposal Management Section

END OF ADDENDUM

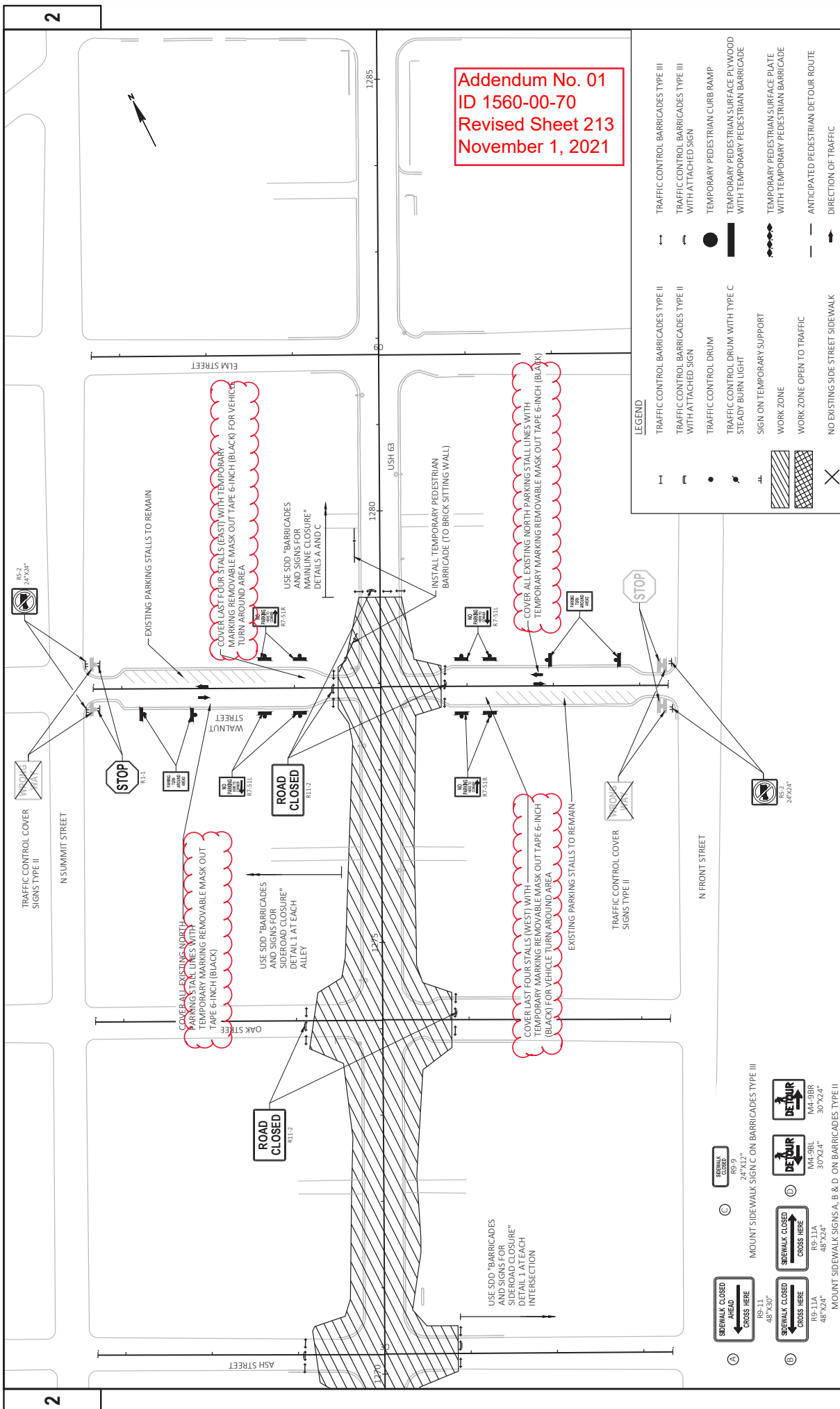

Addendum No. 01  
 ID 1560-00-70  
 Revised Sheet 213  
 November 1, 2021

**LEGEND**

	TRAFFIC CONTROL BARRICADES TYPE III		TRAFFIC CONTROL BARRICADES TYPE III WITH ATTACHED SIGN
	TRAFFIC CONTROL BARRICADES TYPE II		TRAFFIC CONTROL BARRICADES TYPE II WITH ATTACHED SIGN
	TRAFFIC CONTROL DRUM		TRAFFIC CONTROL DRUM WITH TYPE C STEADY BURN LIGHT
	SIGN ON TEMPORARY SUPPORT		WORK ZONE
	TEMPORARY PEDESTRIAN SURFACE PLYWOOD WITH TEMPORARY PEDESTRIAN BARRICADE		TEMPORARY PEDESTRIAN SURFACE PLATE WITH TEMPORARY PEDESTRIAN BARRICADE
	ANTICIPATED PEDESTRIAN DETOUR ROUTE		DIRECTION OF TRAFFIC
	NO EXISTING SIDE STREET SIDEWALK		X

- (A) MOUNT SIDEWALK SIGN C ON BARRICADES TYPE III
- (B) MOUNT SIDEWALK SIGNS A, B & D ON BARRICADES TYPE II
- (C) MOUNT SIDEWALK SIGN C ON BARRICADES TYPE III
- (D) MOUNT SIDEWALK SIGNS A, B & D ON BARRICADES TYPE II

TRAFFIC CONTROL ITEMS

STATION - STATION	DAYS	DRUMS DAY	BARRICADES TYPE II DAY	BARRICADES TYPE III DAY	WARNING LIGHTS TYPE A DAY	ARROW BOARDS DAY	SIGNS DAY	COVERING SIGNS TYPE I EACH	TRAFFIC CONTROL EACH	TEMPORARY PEDESTRIAN SURFACE PLYWOOD SF	TEMPORARY PEDESTRIAN SURFACE PLATE SF	TEMPORARY PEDESTRIAN CURB RAMP DAY	TEMPORARY PEDESTRIAN BARRICADE LF	TEMPORARY MARKING LINE 4-INCH LF	TEMPORARY MARKING LINE REMOVABLE TAPE 4-INCH LF	TEMPORARY MARKING STOP LINE 18-INCH LF		
STAGE 1																		
USH 63																		
1258+38 - 1263+50	26	1430	338	572	832	0	1716	0	1	0	340	52	90	0	1500	1140	80	
STAGE 2																		
USH 63																		
1263+50 - 1279+00	64	11008	1088	3328	5248	384	8768	4	0	3400	480	0	90	75	3680	24	0	
UNDISTRIBUTED	64		384				384						100					
STAGE 3																		
USH 63																		
1279+00 - 1294+00	64	12928	960	3008	4352	384	7232	0	0	2000	480	0	90	75	3100	24	0	
UNDISTRIBUTED	64		384				384											
STAGE 4																		
USH 63																		
1294+00 - 1310+69	61	11285	732	2257	3416	0	6344	0	0	3100	840	0	90	0	3200	24	0	
UNDISTRIBUTED	61		366				366											
STAGE 5																		
USH 63																		
1248+55 - 1258+38	7	0	0	0	0	0	98	0	0	0	0	0	0	0	0	0	0	
ITEM TOTALS		36651	4252	9165	13848	768	25292	4	1	8500	2140	52	460	150	11480	1212	760	80

\*ITEM SHOWN ELSEWHERE IN PLAN

Addendum No. 01  
 ID 1560-00-70  
 Revised Sheet 259  
 November 1, 2021

DETOUR ITEMS

LOCATION	DAYS	SIGNS DAY	TRAFFIC CONTROL SIGNS FIXED MESSAGE SF
STAGE 1			
SHEET 1	26	1040	26
SHEET 2	26	2106	52
SHEET 3	26	2314	
SHEET 4	26	260	
SHEET 5	26	3274	52
STAGE 2			
SHEET 6	64	6208	42
STAGE 3			
SHEET 6	64	6208	
STAGE 4			
SHEET 6	61	5917	
ITEM TOTALS		25327	172

\*ITEM SHOWN ELSEWHERE IN PLAN

NOTE: ALL ITEMS AND QUANTITIES ON THIS SHEET ARE FOR ENGINEER ESTIMATE CATEGORY 0010, UNLESS OTHERWISE NOTED.

Addendum No. 01  
ID 1560-00-70  
Revised Sheet 260  
November 1, 2021

MARKING ITEMS

STATION	LOCATION	646.1020		646.3020		646.8464		646.6468		646.5020		646.5120		646.6120		646.6320		646.7120		646.7420		646.8120		646.8220		
		MARKING LINE EPOXY 4-INCH (WHITE) (YELLOW) (YELLOW) (YELLOW) (YELLOW)	DOUBLE DASHED (YELLOW) (YELLOW) (YELLOW) (YELLOW) (YELLOW)	DOUBLE DASHED (YELLOW) (YELLOW) (YELLOW) (YELLOW) (YELLOW)	MARKING EPOXY 8-INCH (WHITE) (WHITE) (WHITE) (WHITE) (WHITE)	COLD WEATHER MARKING LINE EPOXY 4-INCH (WHITE) (YELLOW) (YELLOW) (YELLOW) (YELLOW)	DOUBLE DASHED (YELLOW) (YELLOW) (YELLOW) (YELLOW) (YELLOW)	DASHED (YELLOW) (YELLOW) (YELLOW) (YELLOW) (YELLOW)	COLD WEATHER MARKING EPOXY 8-INCH (WHITE) (WHITE) (WHITE) (WHITE) (WHITE)	MARKING STOP LINE EPOXY 18-INCH (WHITE) (WHITE) (WHITE) (WHITE) (WHITE)	MARKING WORD EPOXY EACH	MARKING STOP LINE EPOXY 18-INCH (WHITE) (WHITE) (WHITE) (WHITE) (WHITE)	MARKING DIAGONAL EPOXY 12-INCH (WHITE) (WHITE) (WHITE) (WHITE) (WHITE)	MARKING CROSSWALK TRANSVERSE LINE 6-INCH (WHITE) (WHITE) (WHITE) (WHITE) (WHITE)	MARKING CURB EPOXY LF	MARKING ISLAND NOSE EPOXY EACH										
CATEGORY 0010																										
USH 63																										
1248+55.00 - 1262+51.72	LT & RT	2511	1867	1034	441	206																				
1262+51.72 - 1277+95.17	LT & RT	2433	1665	1088	40	237																				
1277+95.17 - 1293+38.76	LT & RT																									
1293+38.76 - 1310+68.73	LT & RT																									
GREENWOOD AVENUE	LT																									
LNIN STREET	RT																									
4+62																										
6+20.9 - 9+39	LT & RT	157	922	217	224	75																				
10+67 - 385+39.8	LT & RT	1368		1090		75																				
VINE STREET																										
19+25 - 19+70	LT & RT																									
20+30 - 20+85	LT & RT																									
ASH STREET																										
29+25 - 29+70	LT & RT																									
30+30 - 30+85	LT & RT																									
OAK STREET																										
39+25 - 39+67	LT & RT																									
40+30 - 40+80	LT & RT																									
WALNUT STREET																										
49+50.67 - 49+65	LT & RT																									
50+43.00 - 50+70	LT & RT																									
ELM STREET																										
59+25 - 59+70	LT & RT																									
60+30 - 60+75	LT & RT																									
PINE STREET																										
69+15 - 69+70	LT & RT																									
70+30 - 70+75	LT & RT																									
CEDAR STREET																										
79+15 - 79+70	LT & RT																									
80+30 - 80+70	LT & RT																									
HAZEL STREET																										
89+15 - 89+70	LT & RT																									
90+30 - 90+75	LT & RT																									
SPRUCE STREET																										
99+25 - 99+70	LT & RT																									
100+30 - 100+75	LT & RT																									
BALSAM STREET																										
109+35 - 109+70	LT & RT																									
110+30 - 110+70	LT & RT																									
POPLAR STREET																										
119+25.18 - 119+63	LT & RT																									
120+33 - 120+73.83	LT & RT																									
SUBTOTAL		6469	4454	3429	705	627	5295	3988	1574	984																
CATEGORY 0010 SUBTOTAL		15057				627		11851		119	63	2	173	52	255	4461	20	2								
ITEM TOTALS		15057				627		11851		119	63	2	173	52	255	4461	20	2								

NOTE: ALL ITEMS AND QUANTITIES ON THIS SHEET ARE FOR ENGINEER ESTIMATE CATEGORY 0010, UNLESS OTHERWISE NOTED.



Proposal Schedule of Items

Proposal ID: 20211109025 Project(s): 1560-00-70, 1560-00-80

Federal ID(s): WISC 2022043, N/A

SECTION: 0001 Contract Items

Alt Set ID: Alt Mbr ID:

Proposal Line Number	Item ID Description	Approximate Quantity and Units	Unit Price	Bid Amount
0278	643.0900 Traffic Control Signs	50,619.000 DAY	_____.	_____.
0280	643.0920 Traffic Control Covering Signs Type II	4.000 EACH	_____.	_____.
0282	643.1000 Traffic Control Signs Fixed Message	172.000 SF	_____.	_____.
0284	643.5000 Traffic Control	1.000 EACH	_____.	_____.
0286	644.1420 Temporary Pedestrian Surface Plywood	8,500.000 SF	_____.	_____.
0288	644.1430 Temporary Pedestrian Surface Plate	2,140.000 SF	_____.	_____.
0290	644.1601 Temporary Pedestrian Curb Ramp	52.000 DAY	_____.	_____.
0292	644.1810 Temporary Pedestrian Barricade	460.000 LF	_____.	_____.
0294	645.0120 Geotextile Type HR	831.000 SY	_____.	_____.
0296	645.0130 Geotextile Type R	333.000 SY	_____.	_____.
0298	646.5020 Marking Arrow Epoxy	63.000 EACH	_____.	_____.
0300	646.5120 Marking Word Epoxy	2.000 EACH	_____.	_____.
0302	646.6120 Marking Stop Line Epoxy 18-Inch	173.000 LF	_____.	_____.
0304	646.6320 Marking Dotted Extension Epoxy 18-Inch	52.000 LF	_____.	_____.
0306	646.6464 Cold Weather Marking Epoxy 4-Inch	11,851.000 LF	_____.	_____.
0308	646.6468 Cold Weather Marking Epoxy 8-Inch	119.000 LF	_____.	_____.
0310	646.7120 Marking Diagonal Epoxy 12-Inch	255.000 LF	_____.	_____.



Proposal Schedule of Items

Proposal ID: 20211109025 Project(s): 1560-00-70, 1560-00-80

Federal ID(s): WISC 2022043, N/A

SECTION: 0001 Contract Items

Alt Set ID: Alt Mbr ID:

Proposal Line Number	Item ID Description	Approximate Quantity and Units	Unit Price	Bid Amount
0312	646.7420 Marking Crosswalk Epoxy Transverse Line 6-Inch	4,461.000 LF	_____.	_____.
0314	646.8120 Marking Curb Epoxy	20.000 LF	_____.	_____.
0316	646.8220 Marking Island Nose Epoxy	2.000 EACH	_____.	_____.
0318	646.9000 Marking Removal Line 4-Inch	150.000 LF	_____.	_____.
0320	649.0150 Temporary Marking Line Removable Tape 4-Inch	11,480.000 LF	_____.	_____.
0322	649.0250 Temporary Marking Line Removable Tape 8-Inch	1,212.000 LF	_____.	_____.
0324	649.0850 Temporary Marking Stop Line Removable Tape 18-Inch	80.000 LF	_____.	_____.
0326	650.4000 Construction Staking Storm Sewer	186.000 EACH	_____.	_____.
0328	650.4500 Construction Staking Subgrade	7,013.000 LF	_____.	_____.
0330	650.5000 Construction Staking Base	1,552.000 LF	_____.	_____.
0332	650.5500 Construction Staking Curb Gutter and Curb & Gutter	2,377.000 LF	_____.	_____.
0334	650.6000 Construction Staking Pipe Culverts	1.000 EACH	_____.	_____.
0336	650.7000 Construction Staking Concrete Pavement	5,650.000 LF	_____.	_____.
0338	650.8000 Construction Staking Resurfacing Reference	950.000 LF	_____.	_____.
0340	650.8500 Construction Staking Electrical Installations (project) 01. 1560-00-70	LS	LUMP SUM	_____.



Proposal Schedule of Items

Proposal ID: 20211109025 Project(s): 1560-00-70, 1560-00-80

Federal ID(s): WISC 2022043, N/A

SECTION: 0001 Contract Items

Alt Set ID: Alt Mbr ID:

Proposal Line Number	Item ID Description	Approximate Quantity and Units	Unit Price	Bid Amount
0584	SPV.0090 Special 13. Water Main C900 10-inch	130.000 LF	_____.	_____.
0586	SPV.0090 Special 14. Water Main Wrapped Ductile Iron 8-inch	150.000 LF	_____.	_____.
0588	SPV.0090 Special 15. Install State Furnished Cat-5E Cable	758.000 LF	_____.	_____.
0590	SPV.0165 Special 01. Modular Block Retaining Wall	30.000 SF	_____.	_____.
0592	SPV.0200 Special 01. Sanitary Manhole Excess Depth 4-FT Diameter	38.700 VF	_____.	_____.
0594	646.1020 Marking Line Epoxy 4-Inch	15,057.000 LF	_____.	_____.
0596	646.3020 Marking Line Epoxy 8-Inch	627.000 LF	_____.	_____.
0598	649.0960 Temporary Marking Removable Mask Out Tape 6-Inch	760.000 LF	_____.	_____.
<b>Section: 0001</b>			<b>Total:</b>	_____.
			<b>Total Bid:</b>	_____.