



# Wisconsin Department of Transportation

January 5, 2023

**Division of Transportation Systems Development**  
Bureau of Project Development  
4822 Madison Yards Way, 4<sup>th</sup> Floor South  
Madison, WI 53705

## NOTICE TO ALL CONTRACTORS:

Telephone: (608) 266-1631  
Facsimile (FAX): (608) 266-8459

**Proposal #22: 4656-07-71, WOSC 2023158**  
**T. Buchanan, County Line Road**  
**Branch of Plum Creek Bridge**  
**Local Street**  
**Outagamie County**

**4656-08-71, WISC 2023159**  
**T Buchanan, New Road**  
**Branch of Plum Creek Bridge**  
**Local Street**  
**Outagamie County**

## Letting of January 10, 2023

This is Addendum No. 01, which provides for the following:

### Schedule of Items:

Added Bid Item Quantities					
Bid Item	Item Description	Unit	Proposal Total Prior to Addendum	Quantity Added	Proposal Total After Addendum
614.0150	Anchor Assemblies for Steel Plate Beam Guard	EACH	0	4	4

### Plan Sheets:

Revised Plan Sheets – ID 4656-07-71	
Plan Sheet	Plan Sheet Title (brief description of changes to sheet)
37	Added Bid Item 614.0150 to Structure Quantities

### **Schedule of Items**

Attached, dated January 5, 2023, are the revised Schedule of Items Page 5.

### **Plan Sheets**

The following 8½ x 11-inch sheets are attached and made part of the plans for this proposal:  
4656-07-71 Revised: 37.

The responsibility for notifying potential subcontractors and suppliers of these changes remains with the prime contractor.

Sincerely,

*Mike Coleman*

Proposal Development Specialist  
Proposal Management Section

END OF ADDENDUM

STATE PROJECT NUMBER  
4656-07-71

**GENERAL NOTES**

DRAWINGS SHALL NOT BE SCALED.  
ALL STATIONS AND ALL ELEVATIONS ARE IN FEET.  
BAR STEEL REINFORCEMENT SHALL BE EMBEDDED 2' CLEAR UNLESS SHOWN OR NOTED OTHERWISE.  
ALL REINFORCING BARS ARE ENGLISH. THE FIRST DIGIT OF A THREE-DIGIT BAR MARK OR THE FIRST TWO DIGITS OF A FOUR-DIGIT BAR MARK SIGNIFIES THE BAR SIZE.  
JOINT FILLERS SHALL CONFORM TO THE REQUIREMENTS OF A.A.S.H.T.O. DESIGNATION M 153. TYPE 1, 11 OR 110R.  
THE SLOPE OF THE FILL IN FRONT OF THE ABUTMENTS SHALL BE COVERED WITH RIPRAP HEAVY AND GEOTEXTILE TYPE "HR" TO THE EXTENT SHOWN ON SHEETS 1 AND 2 AND IN THE ABUTMENT DETAILS.  
THE EXISTING STRUCTURE (P-44-09B5) IS A 26.5' LONG BY 23.6' WIDTH SINGLE SPAN CONCRETE SLAB BRIDGE.  
THE UPPER LIMITS OF "EXCAVATION" FOR STRUCTURES BRIDGES B-44-0487 SHALL BE THE EXISTING GRADE LINE.  
AT THE BACK FACE OF ABUTMENT ALL VOLUME WHICH CANNOT BE IN PLACE BEFORE ABUTMENT CONSTRUCTION SHALL BE REMOVED BY EXCAVATION. THE VOLUME SHALL BE BACKFILLED WITH BACKFILL STRUCTURE.  
AT ABUTMENTS, CONCRETE POURED UNDERWATER WILL BE SECTION 502.3.3 OF THE STANDARD SPECIFICATIONS.  
SLAB FALSE WORK SHALL BE SUPPORTED ON PILES OR ALTERNATE METHOD IS APPROVED BY THE ENGINEER.  
BACKFILL PAY LIMITS, BACKFILL BEYOND BACKFILL PAY LIMITS SHALL BE DETERMINED BY THE CONTRACTOR.  
LIMITS OF EXCAVATION SHALL BE DETERMINED BY THE CONTRACTOR.  
PIPE UNDERDRAIN WRAPPED (ENGLISH), SLOPE 0.6% MIN. TO SUITABLE DRAINAGE. ATTACH RODENT SHIELD AT ENDS OF PIPE UNDERDRAIN.

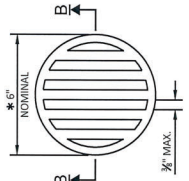

**RODENT SHIELD DETAIL**

\* DIMENSION IS APPROXIMATE. THE GRATE IS SIZED TO FIT INTO A PIPE COUPLING. PIPE COUPLINGS AND SCREWS SHALL BE CONSIDERED INCIDENTAL TO THE BID ITEM "PIPE UNDERDRAIN WRAPPED 6-INCH".  
THE RODENT SHIELD SHALL BE A PVC GRATE SIMILAR TO THIS DETAIL. THE GRATE IS COMMERCIALY AVAILABLE THROUGHOUT THE STATE. THE SHIELD SHALL BE FASTENED TO THE PIPE COUPLING WITH TWO OR MORE NO. 10X 1-INCH STAINLESS STEEL SHEET METAL SCREWS.

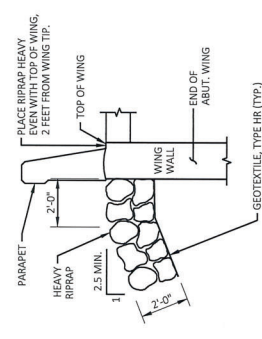

**TYPICAL FILL SECTION AT WING TIPS**

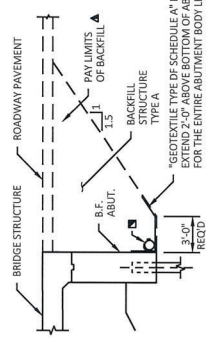

**STRUCTURE BACKFILL & LIMITS**

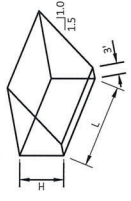

**ABUTMENT BACKFILL DIAGRAM FOR WINGS PARALLEL TO ROADWAY**

L = OUT TO OUT OF ABUTMENT, INCLUDING WINGS (FT)  
H = AVERAGE ABUTMENT FILL HEIGHT (FT)  
EF = EXPANSION FACTOR (1.20 FOR CY BID ITEMS & 1.00 FOR TON BID ITEMS)  
 $V_g = \frac{L \times H \times EF}{2}$   
 $V_{min} = V_g \times 1.27$   
 $V_{max} = V_g \times 1.20$

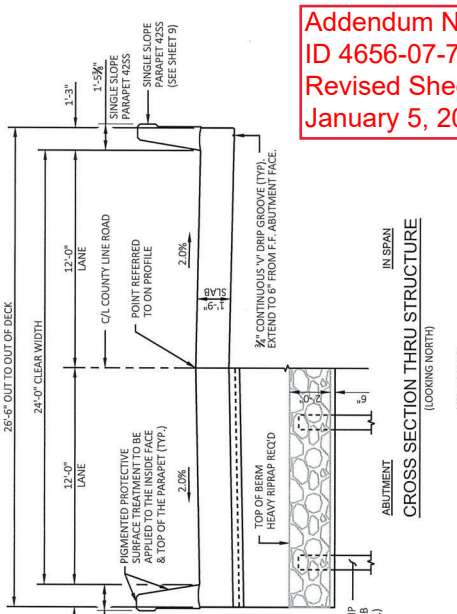

**CROSS SECTION THRU STRUCTURE (LOOKING NORTH)**

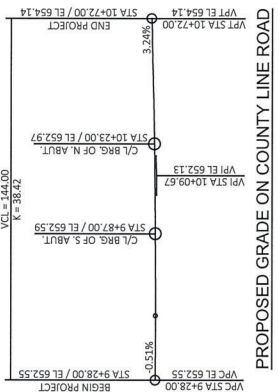

**PROPOSED GRADE ON COUNTY LINE ROAD**

01/04/23

**TOTAL ESTIMATED QUANTITIES**

ITEM NUMBER	BID ITEMS	UNIT	SOUTH ABUT.	NORTH ABUT.	SUPER.	TOTALS
203.0250	REMOVING STRUCTURE OVER WATERWAY REMOVE DEBRIS B-44-0487	EACH	-	-	-	1
206.1001	EXCAVATION FOR STRUCTURES BRIDGES B-44-0487	EACH	-	-	-	1
210.1500	BACKFILL STRUCTURE TYPE A	TON	100	100	-	200
502.0100	CONCRETE MASONRY BRIDGES	CY	30.2	30.6	81.2	142.0
502.3200	PROTECTIVE SURFACE TREATMENT	SY	-	-	103	103
502.3210	PIGMENTED SURFACE SEALER	SY	-	-	58	58
505.0400	BAR STEEL REINFORCEMENT HS STRUCTURES	LB	1530	1530	-	3060
505.0600	BAR STEEL REINFORCEMENT HS COATED STRUCTURES	LB	1250	1260	16040	18550
516.0500	RUBBERIZED MEMBRANE WATERPROOFING	SY	8	8	-	16
550.1100	PILING STEEL HP 10-INCH X 42 LB	LF	280	280	-	560
606.0300	RIPRAP HEAVY	CY	95	75	-	170
612.0406	PIPE UNDERDRAIN WRAPPED 6-INCH	LF	80	80	-	160
614.0150	ANCHOR ASSEMBLIES FOR STEEL PLATE BEAM GUARD	EACH	4	4	-	8
645.0111	GEOTEXTILE TYPE DF SCHEDULE A	SY	27	27	-	54
645.0120	GEOTEXTILE TYPE HR	SY	170	140	-	310
	NON-BID ITEMS	SIZE	-	-	-	4' x 4'
	FILLER					



NO.	DATE	REVISION	BY
01	1/3/23	ADDENDUM	TLP

STATE OF WISCONSIN  
DEPARTMENT OF TRANSPORTATION

STRUCTURE B-44-0487

DRAWN BY: [Blank]  
CHECKED BY: [Blank]

CROSS SECTION, QUANTITIES, & NOTES  
SHEET 2 OF 9  
37



Proposal Schedule of Items

Proposal ID: 20230110022 Project(s): 4656-07-71, 4656-08-71

Federal ID(s): WISC 2023158, WISC 2023159

SECTION: 0001 Roadway

Alt Set ID: Alt Mbr ID:

Proposal Line Number	Item ID Description	Approximate Quantity and Units	Unit Price	Bid Amount
0128	690.0150 Sawing Asphalt	79.000 LF	_____	_____
0130	715.0502 Incentive Strength Concrete Structures	1,610.000 DOL	1.00000	1,610.00
0132	999.2000.S Installing and Maintaining Bird Deterrent System (station) 01. 10+00	1.000 EACH	_____	_____
0134	ASP.1T0A On-the-Job Training Apprentice at \$5.00/HR	100.000 HRS	5.00000	500.00
0136	ASP.1T0G On-the-Job Training Graduate at \$5.00/HR	100.000 HRS	5.00000	500.00
0138	SPV.0090 Special 01. Flashing Stainless Steel	77.000 LF	_____	_____
0140	614.0150 Anchor Assemblies for Steel Plate Beam Guard	4.000 EACH	_____	_____
Section: 0001			Total:	_____
			Total Bid:	_____

