



Wisconsin Department of Transportation

Division of Transportation Systems Development

Bureau of Project Development
4822 Madison Yards Way, 4th Floor South
Madison, WI 53705

December 27, 2023

Telephone: (608) 266-1631
Facsimile (FAX): (608) 266-8459

NOTICE TO ALL CONTRACTORS:

Proposal #20: 1620-01-62, WISC 2024125
Marshfield - Abbotsford
STH 98 to South Junction CTH N
STH 13
Marathon County

1620-01-63, WISC 2024126
Regionwide Concrete Overlays
Marathon Co B-37-0184 & B-37-0185
STH 13
Marathon County

Letting of January 9, 2024

This is Addendum No. 01, which provides for the following:

Special Provisions:

Added Special Provisions	
Article No.	Description
41	Concrete Longitudinal Joint Repair, Item SPV.0180.02.

Schedule of Items:

Revised Bid Item Quantities					
Bid Item	Item Description	Unit	Proposal Total Prior to Addendum	Proposal Quantity Change (-)	Proposal Total After Addendum
416.1710	Concrete Pavement Repair	SY	22,230	-6,275	15,955

Added Bid Item Quantities					
Bid Item	Item Description	Unit	Proposal Total Prior to Addendum	Quantity Added	Proposal Total After Addendum
SPV.0180.01	Concrete Longitudinal Joint Repair	SY	0	6,275	6,275

Plan Sheets:

Revised Plan Sheets	
Plan Sheet	Plan Sheet Title (brief description of changes to sheet)
9-11 & 13	Updated finished typical sections to note that treatment for the existing concrete pavement includes concrete pavement repair, concrete pavement replacement and concrete longitudinal joint repair.
23	Updated the construction detail to define pay limits of concrete longitudinal joint repair vs. concrete pavement repair and concrete pavement replacement
28-48	The legend on the pavement plan details was modified to differentiate between the two bid items listed above.
121	Revised miscellaneous quantity sheet which includes the revised and added bid items.
123	Adjusted the column width on the 'Guardrail Items' table so the type of seed is visible.

The responsibility for notifying potential subcontractors and suppliers of these changes remains with the prime contractor.

Sincerely,

Mike Coleman

Proposal Development Specialist
Proposal Management Section

ADDENDUM NO. 1

1620-01-62

December 27, 2023

Special Provisions

41. Concrete Longitudinal Joint Repair, Item SPV.0180.02.

A Description

This special provision describes construction of Concrete Longitudinal Joint Repair to a 2-foot width according to standard spec 415, standard spec 416, and standard spec 710. QMP for these items shall be combined and covered under standard spec 716, as shown on the plans, and hereinafter provided. The repair work will be the final riding surface.

B Materials

B.1 Concrete Mixtures

Supplement standard spec 716.2 with the following:

Concrete mix design shall be the responsibility of the contractor. Provide the concrete mix designs necessary to accommodate the contractor's operations and contractor scheduling according to the traffic provisions and prosecution and progress provisions included in the plan.

Chloride based accelerators shall be allowed in any concrete mixes that are specifically designed to meet opening strength within six hours or less within the time of placement to accommodate lane restrictions as specified in the contract.

QC slump testing is not required for any concrete mixture that has been approved and has at least 700 lbs of cement per cubic yard.

Random 28-day compressive strength cylinders are not required.

Any chemical admixture(s) to be used, other than air-entraining agents or water reducers from the department's approved list, must be approved in advance by the engineer. The water-cement ratio of the concrete mixture shall not exceed 0.40.s

C Construction

C.1 General

Restrict lane operations as specified in the Traffic Section and the Prosecution and Progress Section. Perform work to cause the least possible inconvenience to traffic. The contractor will be allowed to close lanes as described in the plans and special provisions.

Prepare the base as specified in standard spec 211 using engineer-approved hand methods. Place the repair to the thickness of the contiguous pavement. In lieu of replacing base that was damaged or removed, the contractor will be allowed to place concrete to fill this area at no additional cost to the department.

C.2 Concrete Repair

Supplement standard spec 416.3.7 and standard spec 416.3.8.2:

Deposit concrete to require as little re-handling as possible, place and consolidate by hand with an immersion type vibrator and strike off and finish flush with adjoining surfaces. Any finished surface within the repair that is an 1/8 inch higher than the adjoining pavement shall be diamond ground to match elevation. Any individual repair that, within its defined boundaries, has any finished surface that is 1/8 inch lower than the adjoining pavement shall be paid at 50% of the bid price within the individual repair or shall be removed and replaced as directed by the engineer at no additional cost to the department. Repair

areas greater than 15 feet in length shall meet the Surface Testing and Correction parameters as defined in standard spec 415.3.10.

Unless the plans show or the engineer directs otherwise, the department will not require ties to the existing adjoining pavement within repairs that are 15 feet or less in length.

Construct, cure, and protect as specified for concrete pavement repairs in standard spec 416.

C.3 Opening to Traffic

Concrete Longitudinal Joint Repair must attain a minimum compressive strength of 3,000 psi before they can be opened to traffic. The opening strength shall be determined by Maturity Methods, standard spec 502.3.10.1.3.3 or other engineer approved methods. If cylinders are used, the compressive strength shall be measured by testing concrete cylinders cured in the field on top of the slab, under the curing blanket. At least two cylinders shall be tested in determining the attained strength of concrete repairs for the purpose of opening the pavement to traffic. The average of test results for the two cylinders shall be used to determine compliance, except that neither cylinder may be less than 10 percent below the required strength.

If opening is not controlled by maturity methods or cylinders, cores may be substituted.

C.4 Details

Details for the construction of these three items shall fall under SDD “Concrete Pavement Repair and Replacement” and plan details.

D Measurement

The department will measure Concrete Longitudinal Joint Repair by the square yard, acceptably completed.

E Payment

The department will pay for measured quantities at the contract unit price under the following bid item:

ITEM NUMBER	DESCRIPTION	UNIT
SPV.0180.02	Concrete Longitudinal Joint Repair	SY

Payment is full compensation for removing old pavement and disposing of removed materials; for preparing the base; for providing, curing, and protecting the concrete.

The department will pay separately for the following bid items: Sawing Concrete, Drilled Tie bars, and Drilled Dowel Bars that are anchored into existing pavement.

Schedule of Items

Attached, dated December 27, 2023, are the revised Schedule of Items Pages 3 and 11.

Plan Sheets

The following 8½ x 11-inch sheets are attached and made part of the plans for this proposal:
Revised: 28-48, 121, and 123.

END OF ADDENDUM

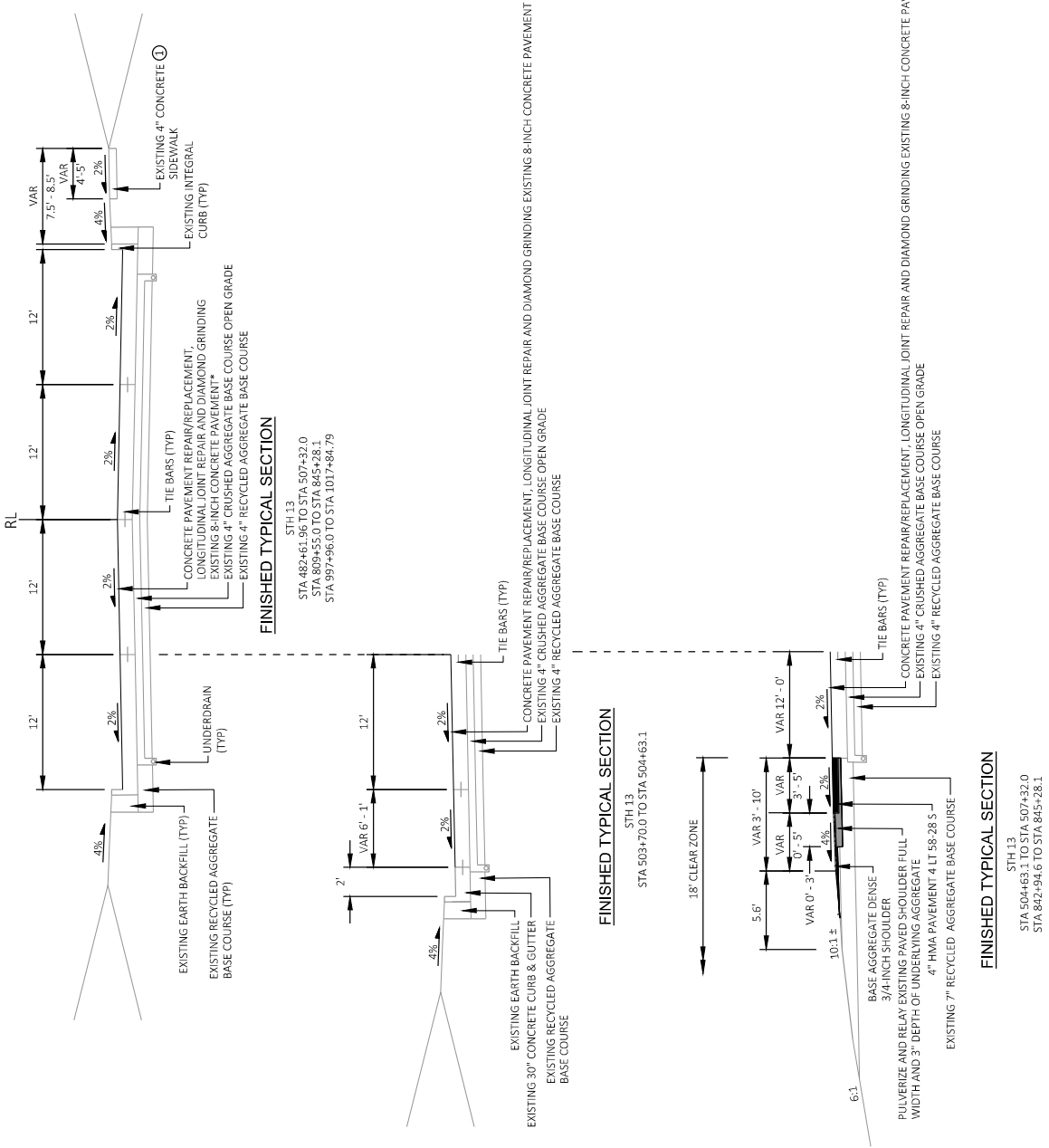

NOTES:
 ALL STATION VALUES LISTED IN THE TYPICALS WERE MEASURED FROM AERIALS AND AS-BUILTS AND MAY NEED TO BE ADJUSTED TO FIT FIELD CONDITIONS.
 PULVERIZE AND RELAY EXISTING ASPHALT SHOULDERS. SEE TRAFFIC CONTROL TYPICAL SECTIONS FOR INTERM REQUIREMENTS. REMOVING ASPHALTIC SURFACE AND 4" HMA PAVEMENT 4 FT 58-28 S REQUIRED FOR TURN LANES AND SIDEROADS.
 SEE PAVEMENT MARKING PLANS FOR LIMITS OF TWL/TL MARKINGS.
 (1) SIDEWALK IS LOCATED AT THE FOLLOWING LOCATIONS:
 STA 482+63.8 TO STA 490+93.0 RT
 STA 838+05.0 TO STA 832+82.0 RT
 *CONCRETE PAVEMENT 8 1/2 INCH RECD STA 501+91.5 TO STA 505+46.6 ON THE SB INSIDE LANE DUE TO THE LENGTH OF THE REPLACEMENT

Addendum No. 01
ID 1620-01-62
Revised Sheet 10
December 27, 2023

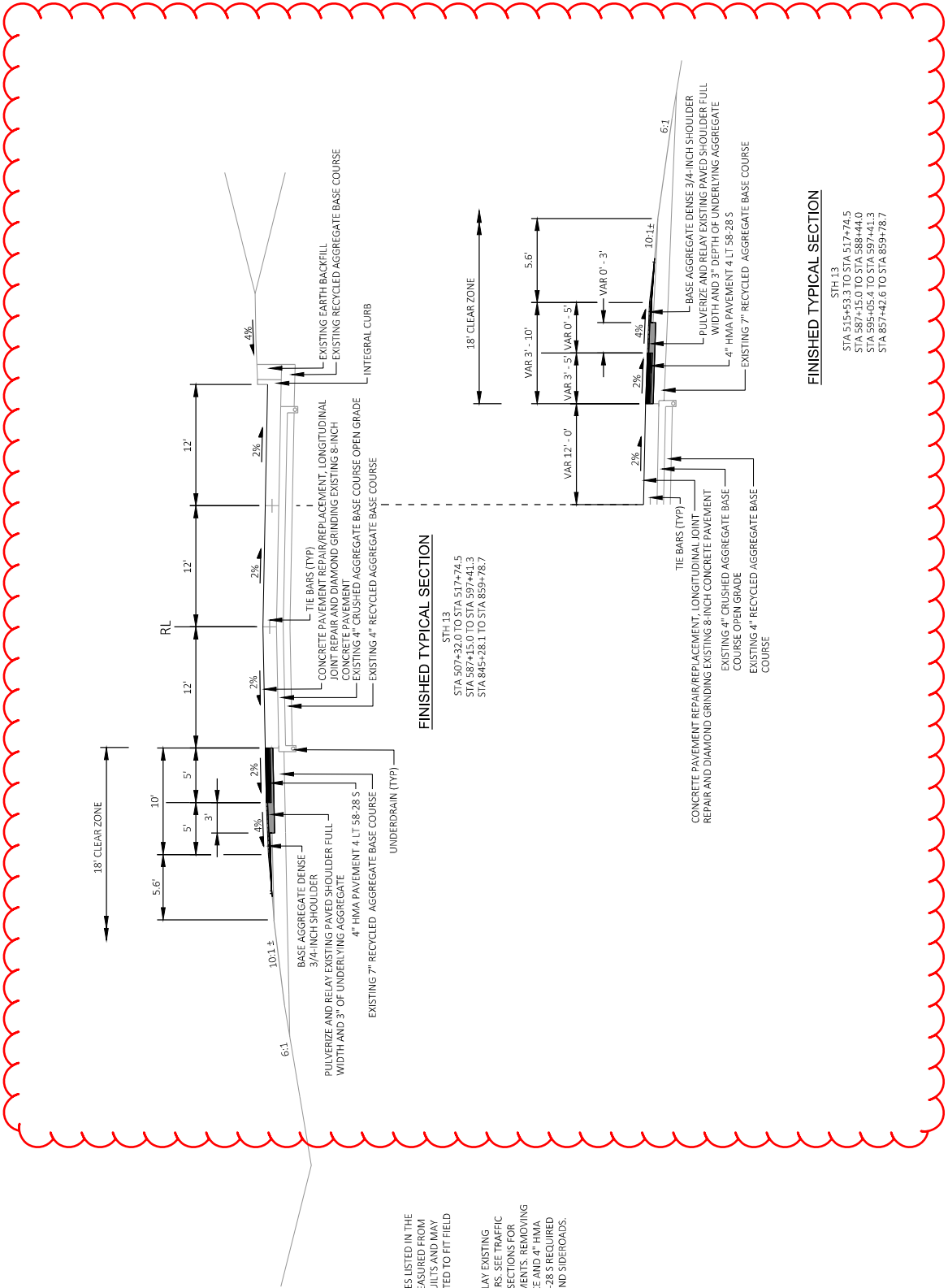

NOTES:
 ALL STATION VALUES LISTED IN THE TYPICALS WERE MEASURED FROM AERIALS AND AS-BUILTS AND MAY NEED TO BE ADJUSTED TO FIT FIELD CONDITIONS.
 PULVERIZE AND RELAY EXISTING ASPHALT SHOULDERS. SEE TRAFFIC CONTROL TYPICAL SECTIONS FOR INTERIM REQUIREMENTS. REMOVING ASPHALT SURFACES TO 4" HMA PAVEMENT 4 LT 58-28 S REQUIRED FOR TURN LANES AND SIDEROADS.

FINISHED TYPICAL SECTION

STH 13
 STA 515+53.3 TO STA 517+74.5
 STA 587+15.0 TO STA 588+44.0
 STA 595+05.4 TO STA 597+41.3
 STA 857+42.6 TO STA 859+78.7

PROJECT NO: 1620-01-62	COUNTY: MARATHON	TYPICAL SECTIONS	SHEET 10	E
FILE NAME: X:\PROJECTS\MARATHON\1620-01-02_STH_13_STH_98 TO CTH\DESIGN\CD\SHSHEETS\PLAN\020280-1TS.DWG	PLOT DATE: 12/14/2023 2:43 PM	PLOT BY: ANDY BLOCK	PLOT SCALE: 1 IN=10 FT	WIS007CADD5 SHEET 42
HWY: STH 13				

Addendum No. 01
ID 1620-01-62
Revised Sheet 11
December 27, 2023

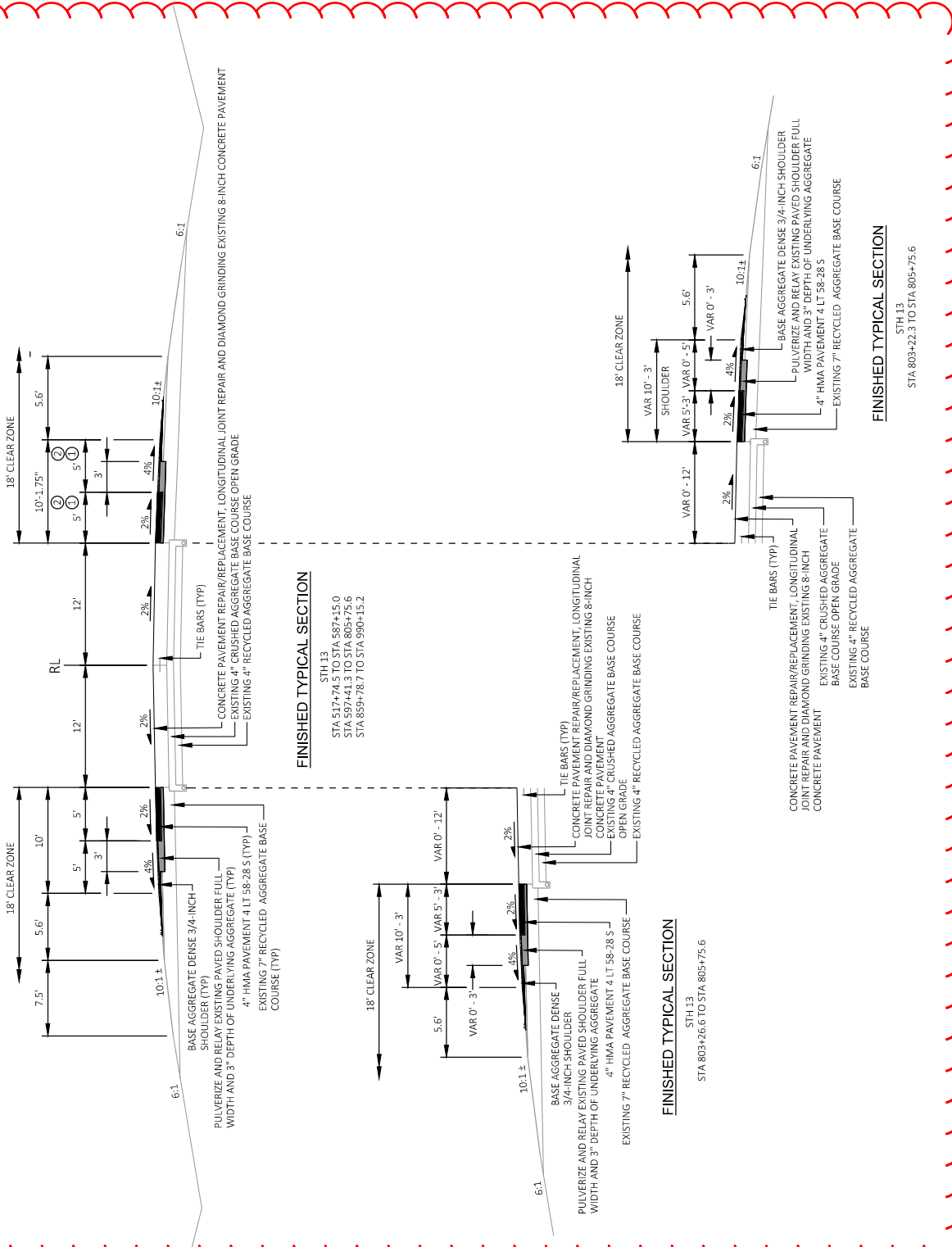

- NOTES:**
 ALL STATION VALUES LISTED IN THE TYPICALS WERE MEASURED FROM AERIALS AND AS-BUILTS, AND MAY NEED TO BE ADJUSTED TO FIT FIELD CONDITIONS.
 PULVERIZE AND RELAY EXISTING ASPHALT SHOULDERS. SEE TRAFFIC CONTROL TYPICAL SECTIONS FOR INTERIM REQUIREMENTS. REMOVING ASPHALTIC SURFACE AND 4" HMA PAVEMENT 4' LT 58-28.5 REQUIRED FOR TURN LANES AND SIDEROADS.
- ① 5' SHOULDER WIDENS TO 8' FROM: STA 640+41.0 TO STA 640+71.0, RT. STA 644+80.0 TO 645+10.0, RT.
 - 8' SHOULDER NARROWS TO 5' FROM: STA 644+80.0 TO 645+10.0, RT.
 - NO SHOULDER REMOVAL/ REPLACEMENT REQUIRED FROM STA 640+71.0 TO STA 644+80.0, RT AND STA 633+70 TO STA 645+00, LT.
 - ② PAVE SHOULDER FULL WIDTH STA 550+02.3 TO STA 551+02.3, RT (TAPER BEGINS STA 549+39.8)
 - PAVE SHOULDER FULL WIDTH STA 581+42.5 TO STA 582+73.9, RT
- SEE PLANS AND PLAN DETAILS FOR SHOULDER WIDTHS ADJACENT TO GUARDRAIL INSTALLATIONS AT THE APPROACHES TO STRUCTURES B-37-0184 AND B-37-0185

FINISHED TYPICAL SECTION

STH 13
STA 517+74.5 TO STA 587+15.0
STA 597+41.3 TO STA 805+75.6
STA 859+78.7 TO STA 990+15.2

FINISHED TYPICAL SECTION

STH 13
STA 803+26.6 TO STA 805+75.6

FINISHED TYPICAL SECTION

STH 13
STA 803+22.3 TO STA 805+75.6

PROJECT NO: 1620-01-62

HWY: STH 13

COUNTY: MARATHON

TYPICAL SECTIONS

SHEET 11

E

FILE NAME: X:\PROJECTS\MARATHON\1620-01-62_STH_13_STH_98 TO CTH INDEX\GEN3\DRSHEETS\PLAN\02091-15.DWG LAYOUT NAME: Frisbee03
 PLOT DATE: 12/14/2023 2:44 PM
 PLOT BY: ANDY BLOK
 PLOT NAME: ANDY BLOK
 PLOT SCALE: 1 IN=10 FT
 WISDOT/CADDIS SHEET 42

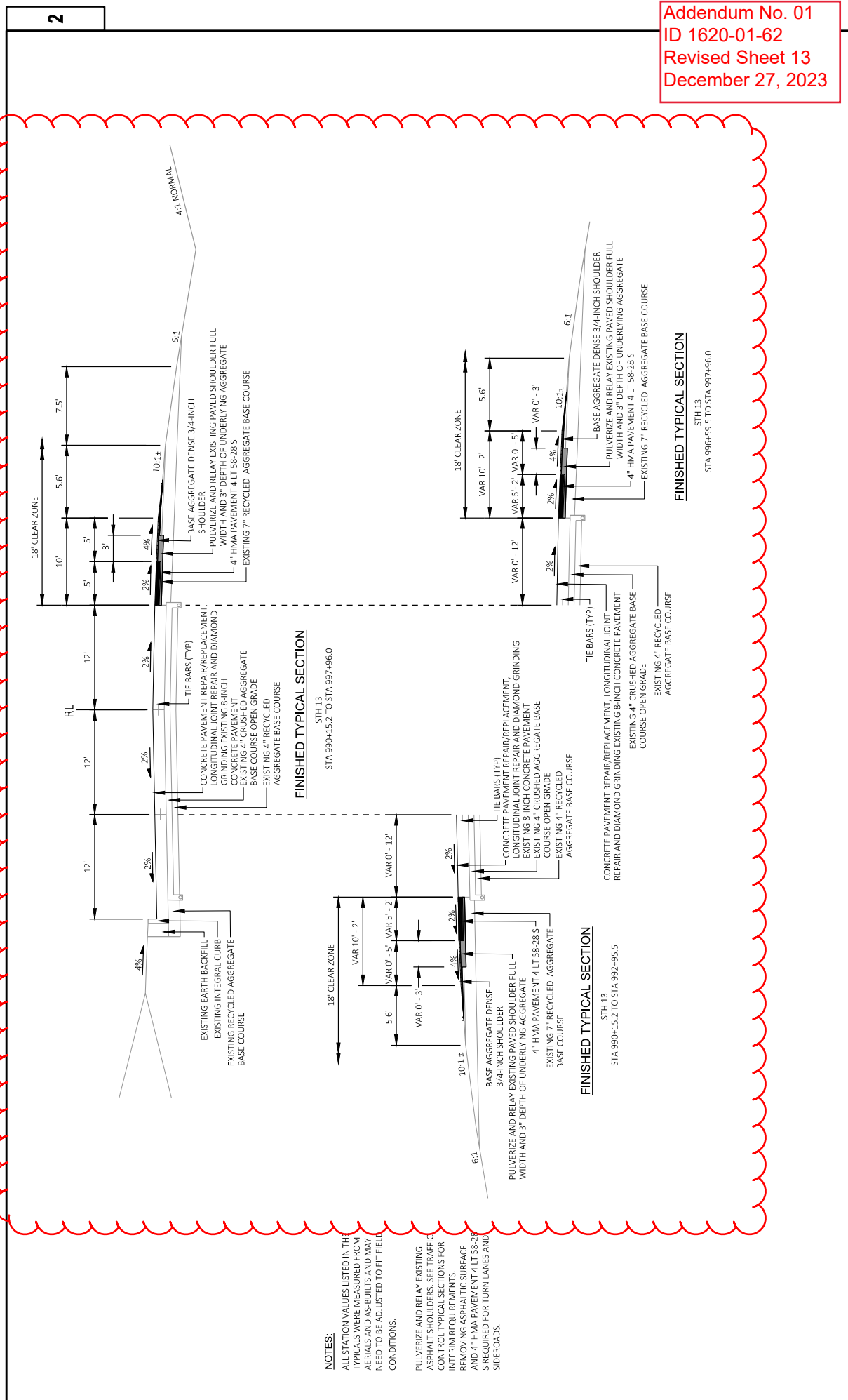

NOTES:

ALL STATION VALUES LISTED IN THE TYPICALS WERE MEASURED FROM AERIALS AND AS-BUILTS AND MAY NEED TO BE ADJUSTED TO FIT FIELD CONDITIONS.

PULVERIZE AND RELAY EXISTING ASPHALT SHOULDERS. SEE TRAFFIC CONTROL TYPICAL SECTIONS FOR INTERIM REQUIREMENTS.

REMOVING ASPHALTIC SURFACE AND 4" HMA PAVEMENT 4 LT 58-28 S REQUIRED FOR TURN LANES AND SIDEROADS.

PROJECT NO: 1620-01-62	COUNTY: MARATHON	TYPICAL SECTIONS	SHEET 13
FILE NAME: X:\PROJECTS\MARATHON\1620-01-02_STH_13_5TH_98 TO CTH INDESIGN\CDSDSHEETS\PLAN\020901-TS.DWG	HWY: STH 13	ANDY BLOCK	1 IN 10 FT
LAYOUT NAME: Final.dwg	STA 990+15.2 TO STA 992+95.5	PLT BY: 12/14/2023 2:47 PM	PLOT SCALE: 1 IN 10 FT

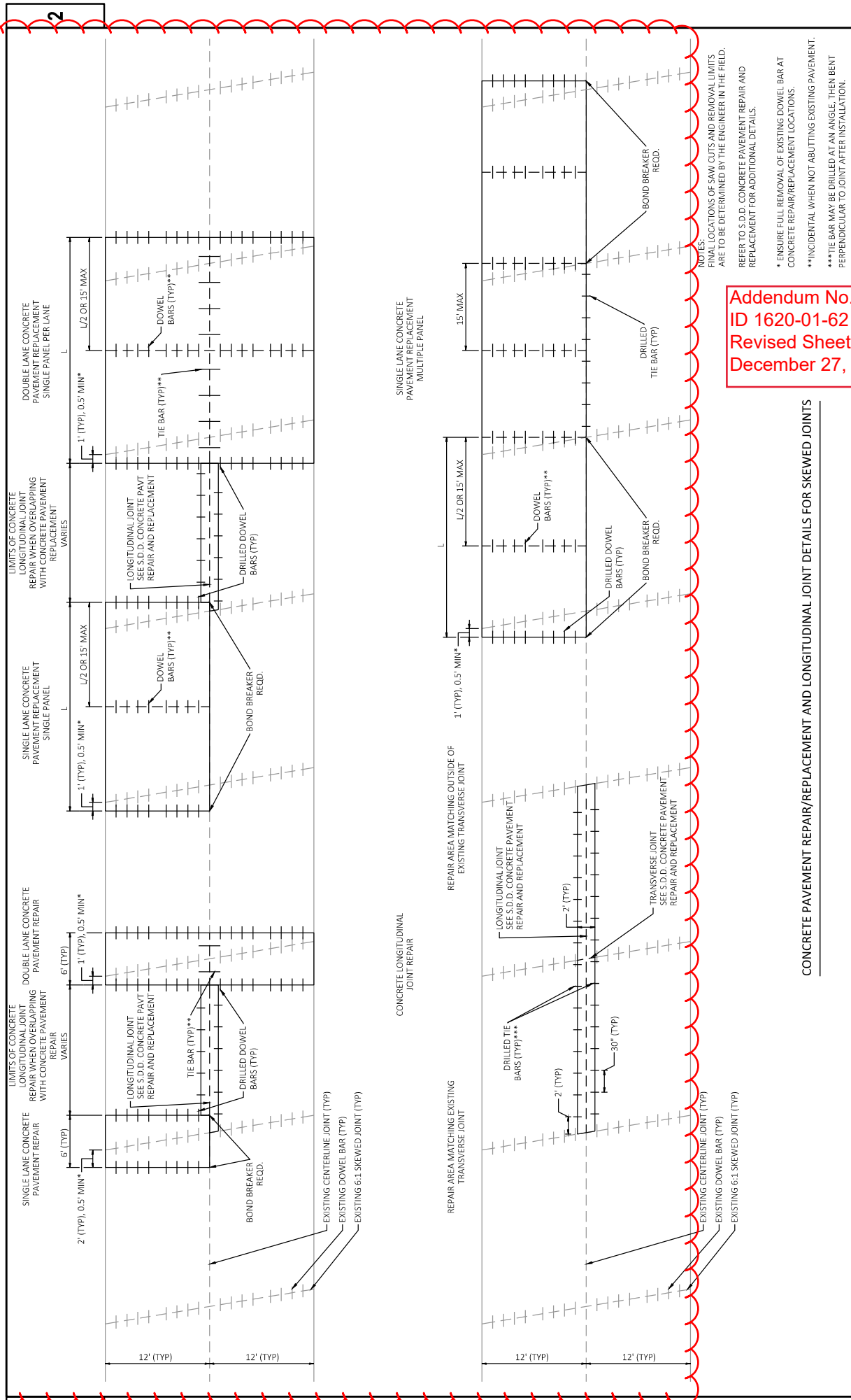

Addendum No. 01
ID 1620-01-62
Revised Sheet 23
December 27, 2023

NOTES:
 FINAL LOCATIONS OF SAW CUTS AND REMOVAL LIMITS ARE TO BE DETERMINED BY THE ENGINEER IN THE FIELD.
 REFER TO S.D.D. CONCRETE PAVEMENT REPAIR AND REPLACEMENT FOR ADDITIONAL DETAILS.
 * ENSURE FULL REMOVAL OF EXISTING DOWEL BAR AT CONCRETE REPAIR/REPLACEMENT LOCATIONS.
 ** INCIDENTAL WHEN NOT ABUTTING EXISTING PAVEMENT.
 *** TIE BAR MAY BE DRILLED AT AN ANGLE THEN BENT PERPENDICULAR TO JOINT AFTER INSTALLATION.

PROJECT NO: 1620-01-62	COUNTY: MARATHON	CONSTRUCTION DETAILS	SHEET 23	E
FILE NAME: X:\PROJECTS\MARATHON\1620-01-02_STH_13_STH_98 TO CTH INDESGN\CD3SHRETSPL\AW021001-CD.DWG	PLOT DATE: 12/14/2023 2:38 PM	PLOT NAME: ANDY BLOCK	#####	W65007\CD005 SHEET 42
LAYOUT NAME: EW CD 3D	HWY: STH 13			

Addendum No. 01
 ID 1620-01-62
 Revised Sheet 28
 December 27, 2023

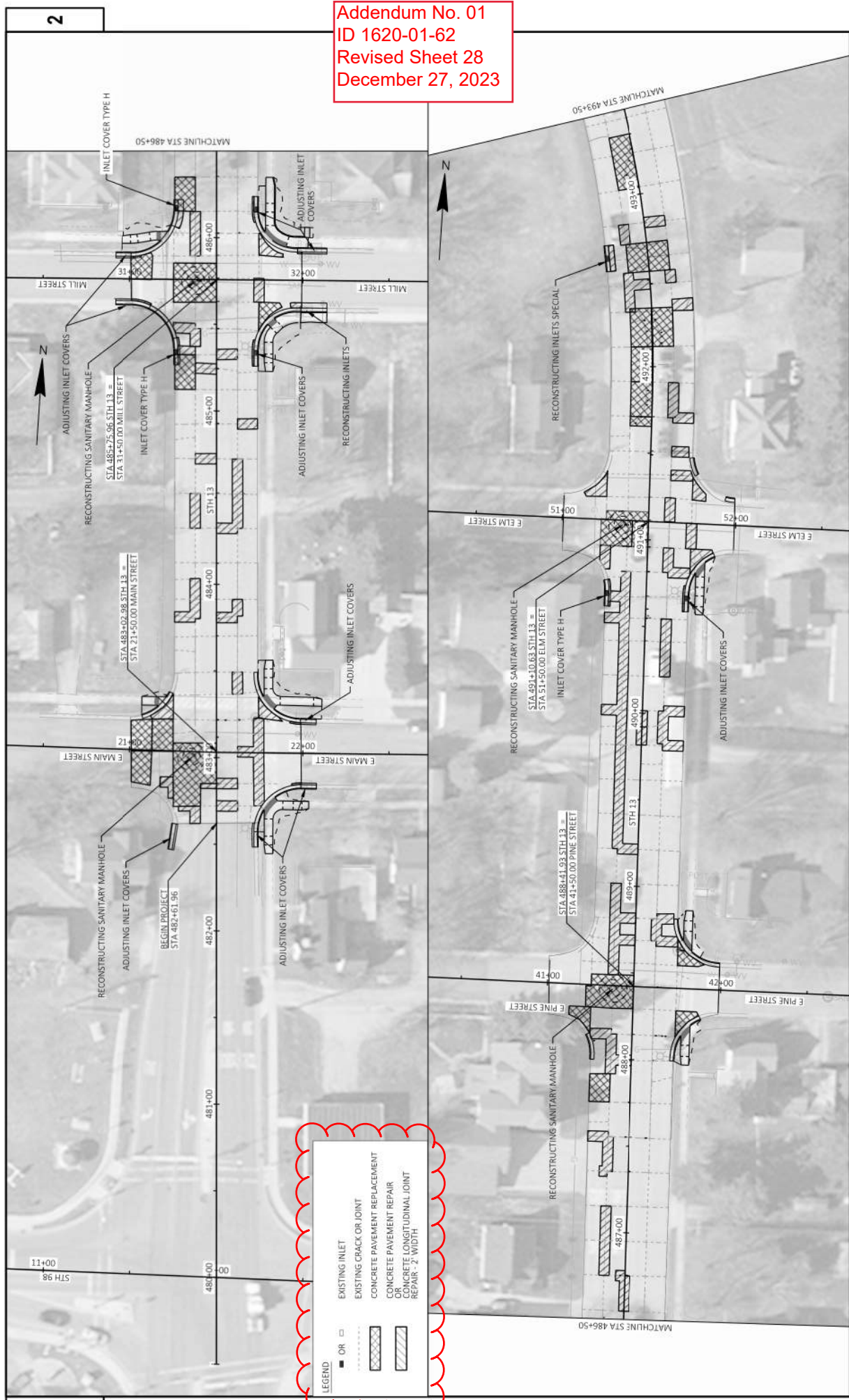

2

2

PROJECT NO: 1620-01-62
 HWY: STH 13
 COUNTY: MARATHON
 PLAN DETAILS - PAVEMENT
 SHEET 28
 E

Addendum No. 01
 ID 1620-01-62
 Revised Sheet 29
 December 27, 2023

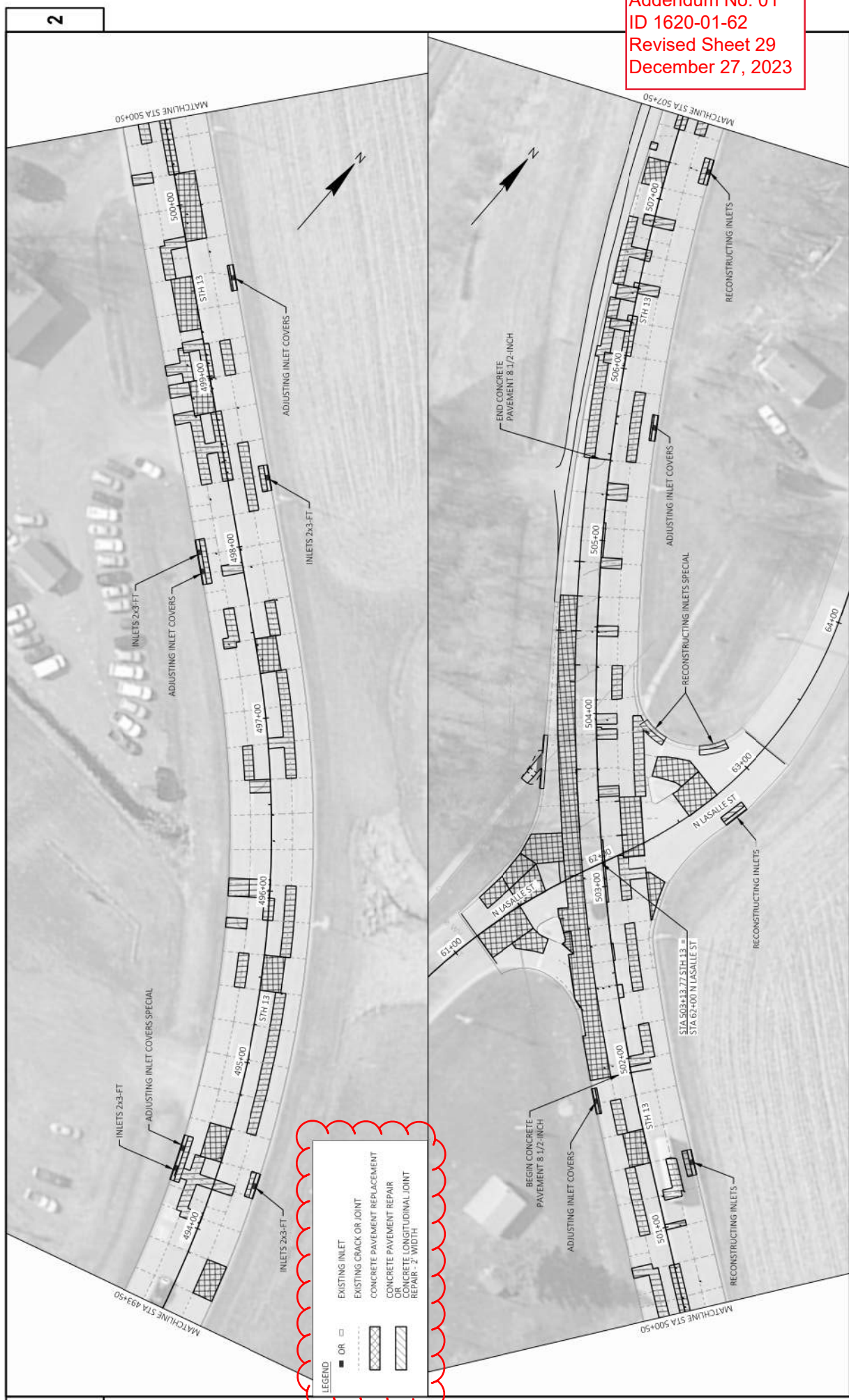

LEGEND

- OR □ EXISTING INLET
- EXISTING CRACK OR JOINT
- ▨ CONCRETE PAVEMENT REPLACEMENT
- ▧ CONCRETE PAVEMENT REPAIR
- ▩ OR ▪ CONCRETE LONGITUDINAL JOINT REPAIR - 2' WIDTH

2

2

December 15, 2023

Page 29

PROJECT NO: 1620-01-62
 HWY: STH 13
 COUNTY: MARATHON
 PLAN DETAILS - PAVEMENT
 SHEET 29
 E

FILE NAME: X:\PROJECTS\MARATHON\1620-01-62_STH_13_STH-98 TO CH-INDESIGN\CD\SHEETPLAN\01202_P01_PAVEMENT.DWG
 PLOT DATE: 12/14/2023 11:02 AM
 PLOT BY: ANDY BLOK
 PLOT NAME: ANDY BLOK
 PLOT SCALE: 1 IN=50 FT
 W:\007\CAD\09\SHEET 42

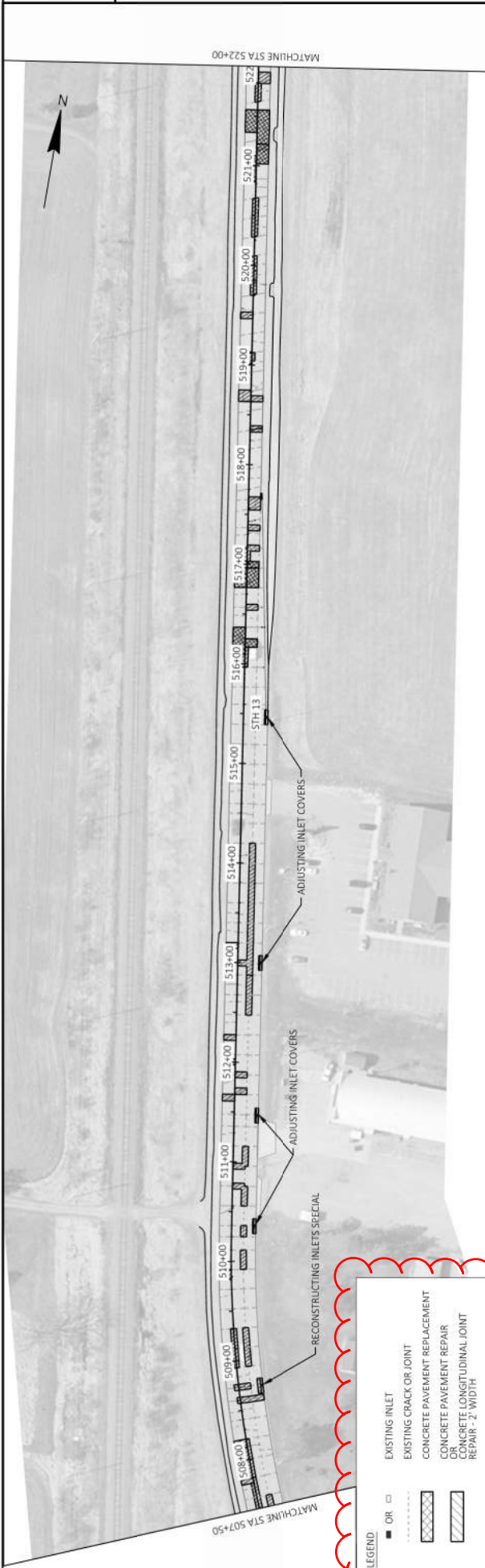

LEGEND

- OR □ EXISTING INLET
- ▨ EXISTING CRACK OR JOINT
- ▩ CONCRETE PAVEMENT REPLACEMENT
- ▧ CONCRETE PAVEMENT REPAIR
- ▦ OR ▤ ASPHALT PAVEMENT REPAIR - 2' WIDTH

December 15, 2023

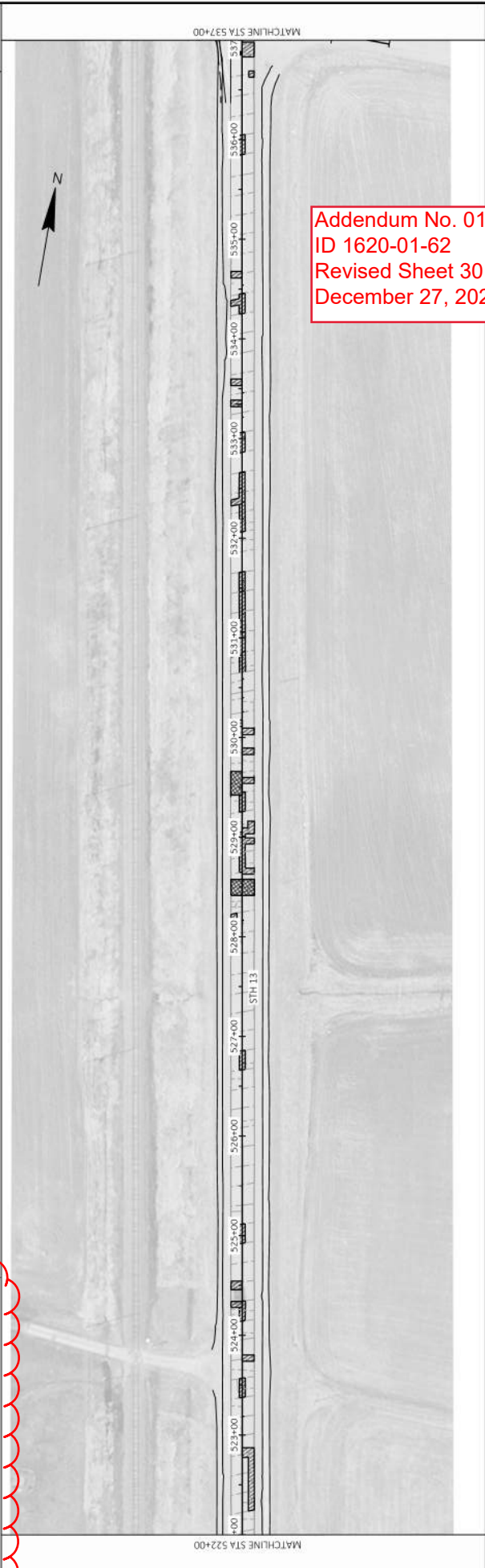

Addendum No. 01
 ID 1620-01-62
 Revised Sheet 30
 December 27, 2023

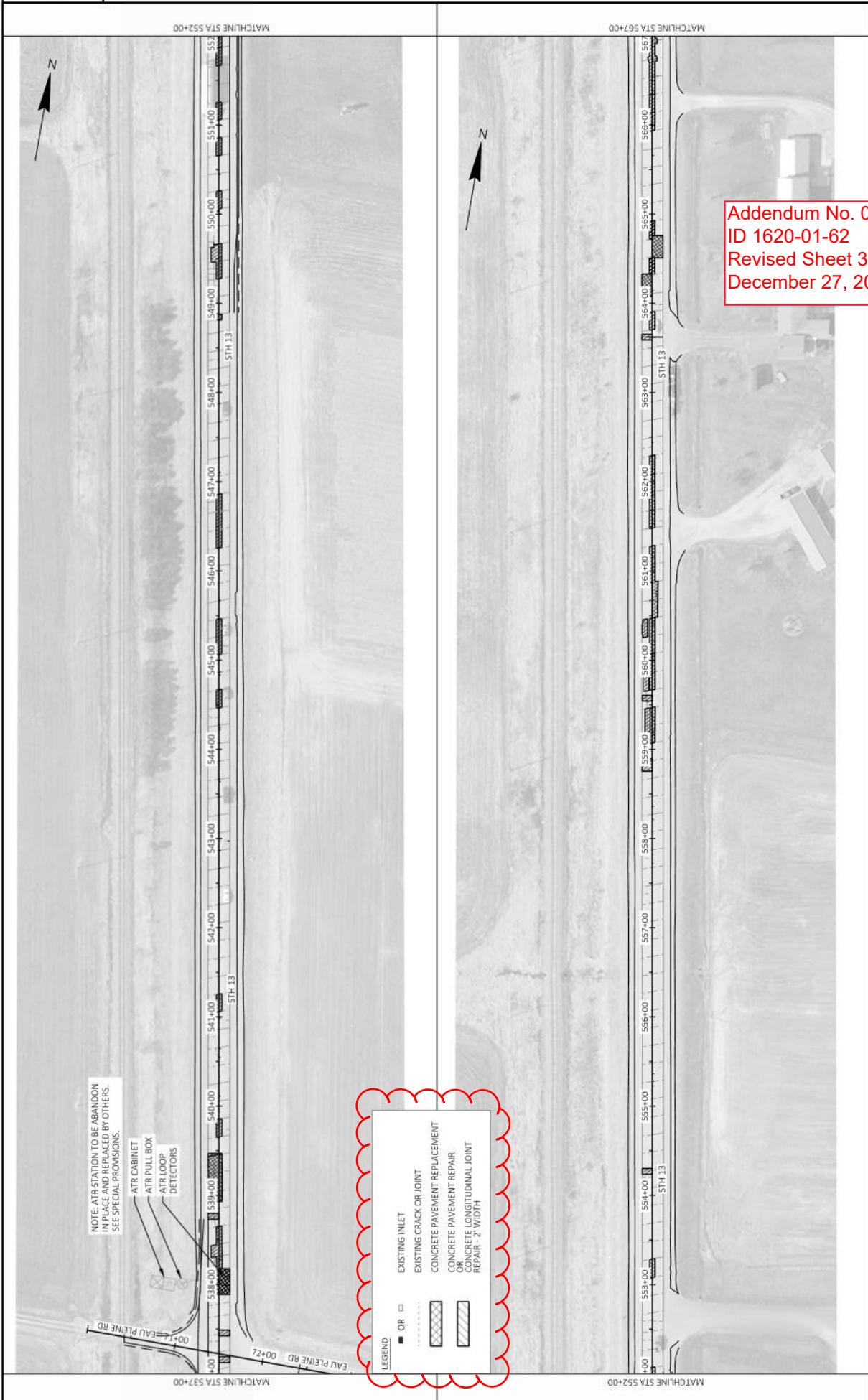

NOTE: ATR STATION TO BE ABANDON IN PLACE AND REPLACED BY OTHERS. SEE SPECIAL PROVISIONS.

ATR CABINET
ATR PULL BOX
ATR LOOP DETECTORS

LEGEND

- OR □ EXISTING INLET
- EXISTING CRACK OR JOINT
- ▨ CONCRETE PAVEMENT REPLACEMENT
- ▩ CONCRETE PAVEMENT REPAIR
- ▧ CONCRETE LONGITUDINAL JOINT REPAIR - 2' WIDTH

Addendum No. 01
ID 1620-01-62
Revised Sheet 31
December 27, 2023



MATCHLINE STA 582+00



MATCHLINE STA 567+00

LEGEND

- OR □ EXISTING INLET
- ▨ EXISTING CRACK OR JOINT
- ▤ CONCRETE PAVEMENT REPLACEMENT
- ▥ CONCRETE PAVEMENT REPAIR
- ▧ CONCRETE LONGITUDINAL JOINT REPAIR - Z WIDTH

MATCHLINE STA 597+00

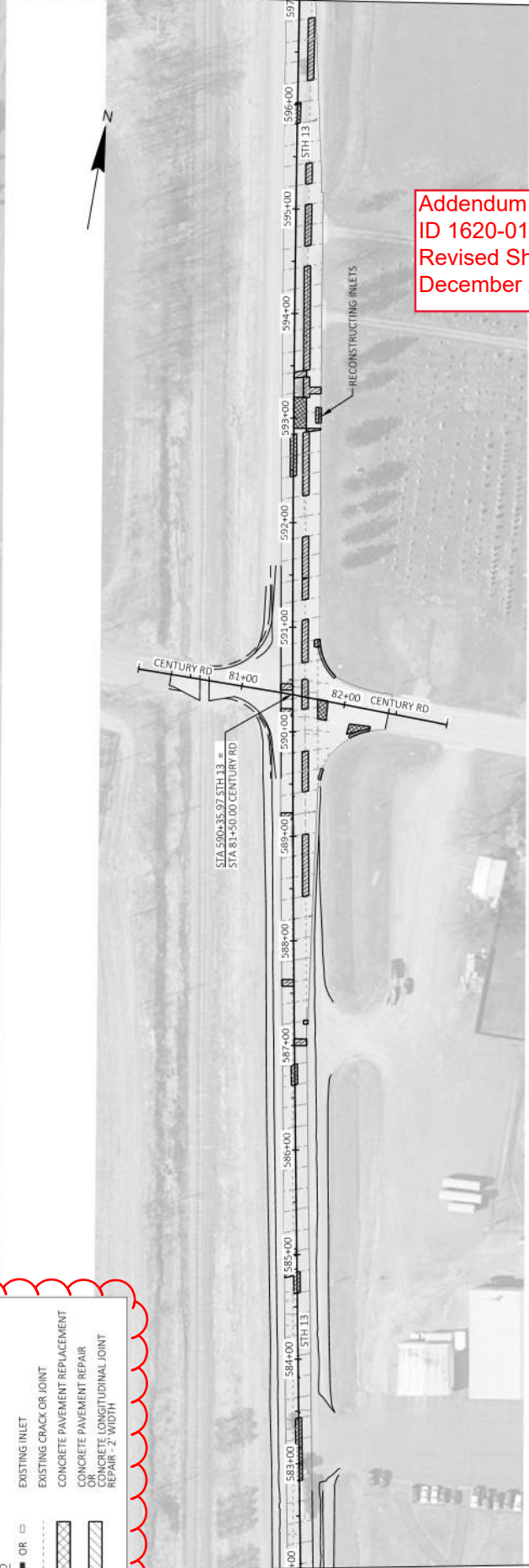

MATCHLINE STA 592+00

Addendum No. 01
 ID 1620-01-62
 Revised Sheet 32
 December 27, 2023



Addendum No. 01
 ID 1620-01-62
 Revised Sheet 33
 December 27, 2023

LEGEND

- OR □ EXISTING INLET
- EXISTING CRACK OR JOINT
- ▨ CONCRETE PAVEMENT REPLACEMENT
- ▩ CONCRETE PAVEMENT REPAIR
- ▧ CONCRETE LONGITUDINAL JOINT REPAIR - Z WIDTH

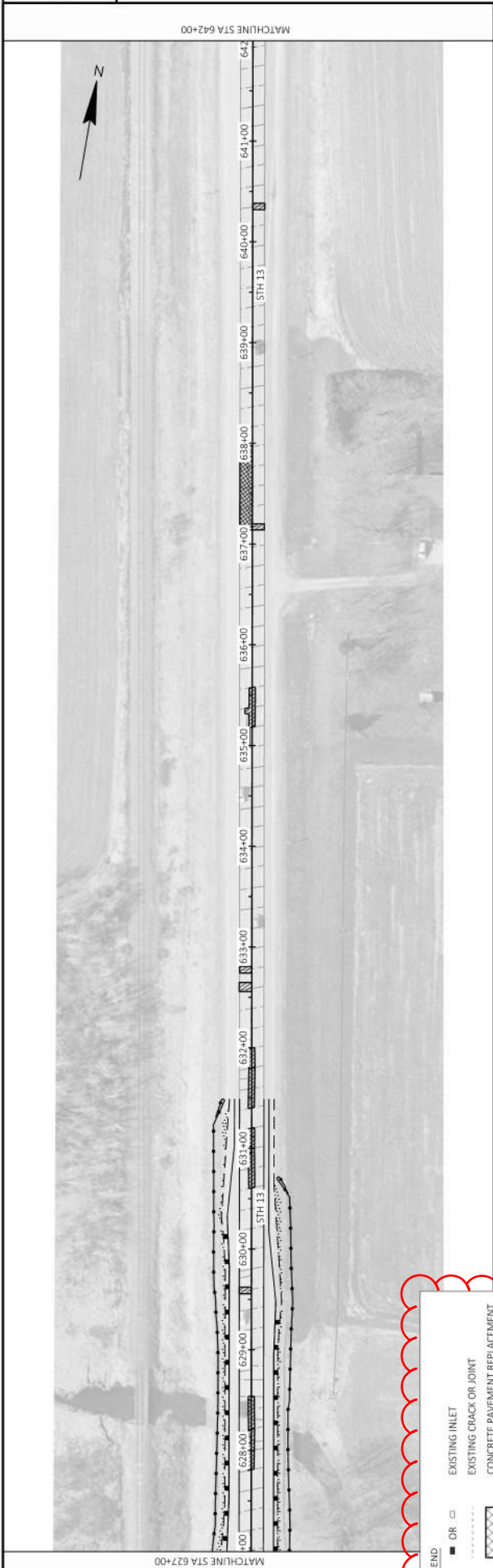

Addendum No. 01
 ID 1620-01-62
 Revised Sheet 34
 December 27, 2023

LEGEND

- OR □ EXISTING INLET
- EXISTING CRACK OR JOINT
- ▨ CONCRETE PAVEMENT REPLACEMENT
- ▩ CONCRETE PAVEMENT REPAIR
- ▧ CONCRETE LONGITUDINAL JOINT REPAIR - 2' WIDTH



MATCHLINE STA 672+00

STA 670+34.33 STH 13 =
STA 100+00.00 BUXTON ST

STH 13

STH 13

MATCHLINE STA 657+00

LEGEND

- OR □ EXISTING INLET
- EXISTING CRACK OR JOINT
- ▨ CONCRETE PAVEMENT REPLACEMENT
- ▩ CONCRETE PAVEMENT REPAIR
OR
CONCRETE LONGITUDINAL JOINT
REPAIR - 2' WIDTH



MATCHLINE STA 687+00

STH 13

MATCHLINE STA 672+00

Addendum No. 01
ID 1620-01-62
Revised Sheet 35
December 27, 2023



LEGEND

- OR □ EXISTING INLET
- EXISTING CRACK OR JOINT
- ▨ CONCRETE PAVEMENT REPLACEMENT
- ▩ CONCRETE PAVEMENT REPAIR OR ASPHALT CONCRETE LONGITUDINAL JOINT REPAIR - 2' WIDTH

Addendum No. 01
 ID 1620-01-62
 Revised Sheet 36
 December 27, 2023



Addendum No. 01
 ID 1620-01-62
 Revised Sheet 37
 December 27, 2023



Addendum No. 01
 ID 1620-01-62
 Revised Sheet 38
 December 27, 2023

■ OR □	EXISTING INLET
---	EXISTING CRACK OR JOINT
▨	CONCRETE PAVEMENT REPLACEMENT
▩	CONCRETE PAVEMENT REPAIR
▧	CONCRETE LONGITUDINAL JOINT REPAIR - 2' WIDTH

2

2

Addendum No. 01
 ID 1620-01-62
 Revised Sheet 39
 December 27, 2023

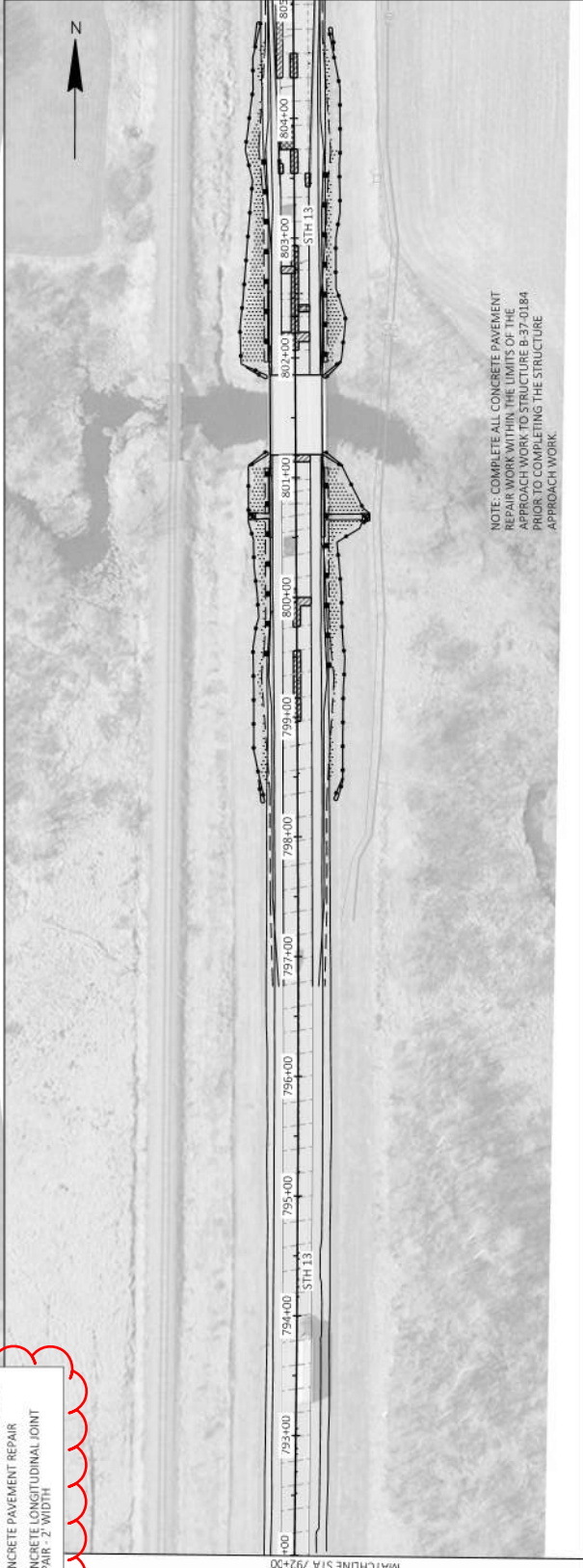
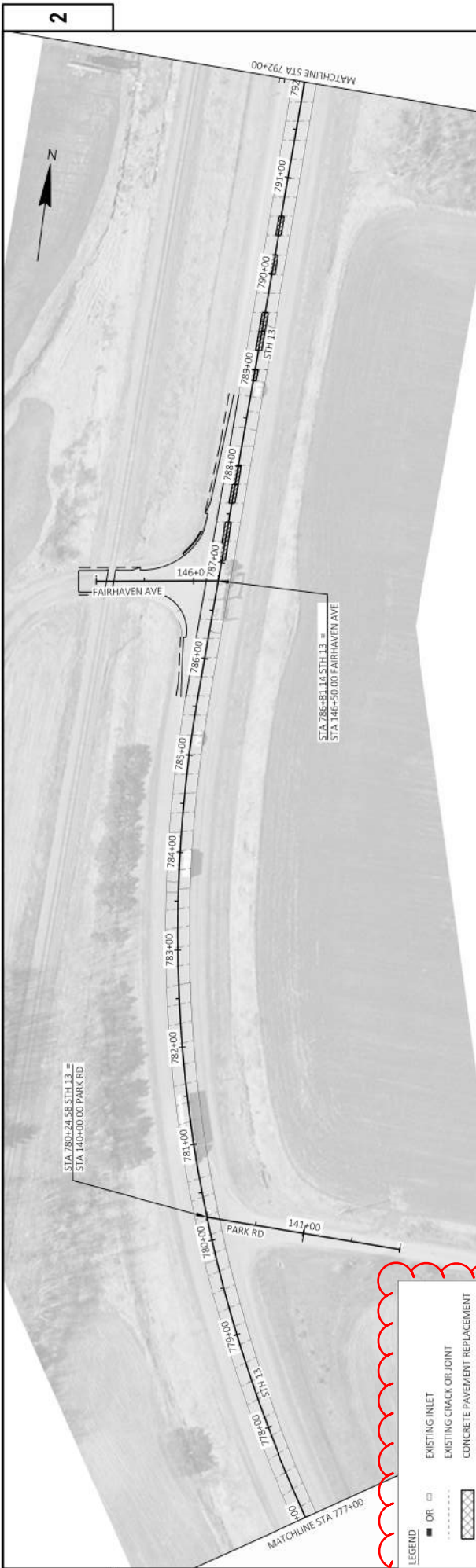

NOTE: COMPLETE ALL CONCRETE PAVEMENT REPAIR WORK WITHIN THE LIMITS OF THE APPROACH WORK TO STRUCTURE B-37-0184 PRIOR TO COMPLETING THE STRUCTURE APPROACH WORK.

LEGEND	
	EXISTING INLET
	EXISTING CRACK OR JOINT
	CONCRETE PAVEMENT REPLACEMENT
	CONCRETE PAVEMENT REPAIR
	CONCRETE LONGITUDINAL JOINT REPAIR - 2' WIDTH

PROJECT NO: 1620-01-62	COUNTY: MARATHON	PLAN DETAILS - PAVEMENT	SHEET 39
FILE NAME: X:\PROJECTS\MARATHON\1620-01-62_SPH_13_SPH_13_TO_CIV\DESIGN\CADD\SHEETPLAN\0202_P0_PAVEMENT.DWG	PLOT DATE: 12/14/2023 11:20 AM	PLOT BY: ANDY BLOCK	PLOT SCALE: 1"=100 FT
LAUNCH NAME: STH 13 (12)			WISDOT/CADD/SHEET 42

Addendum No. 01
 ID 1620-01-62
 Revised Sheet 40
 December 27, 2023

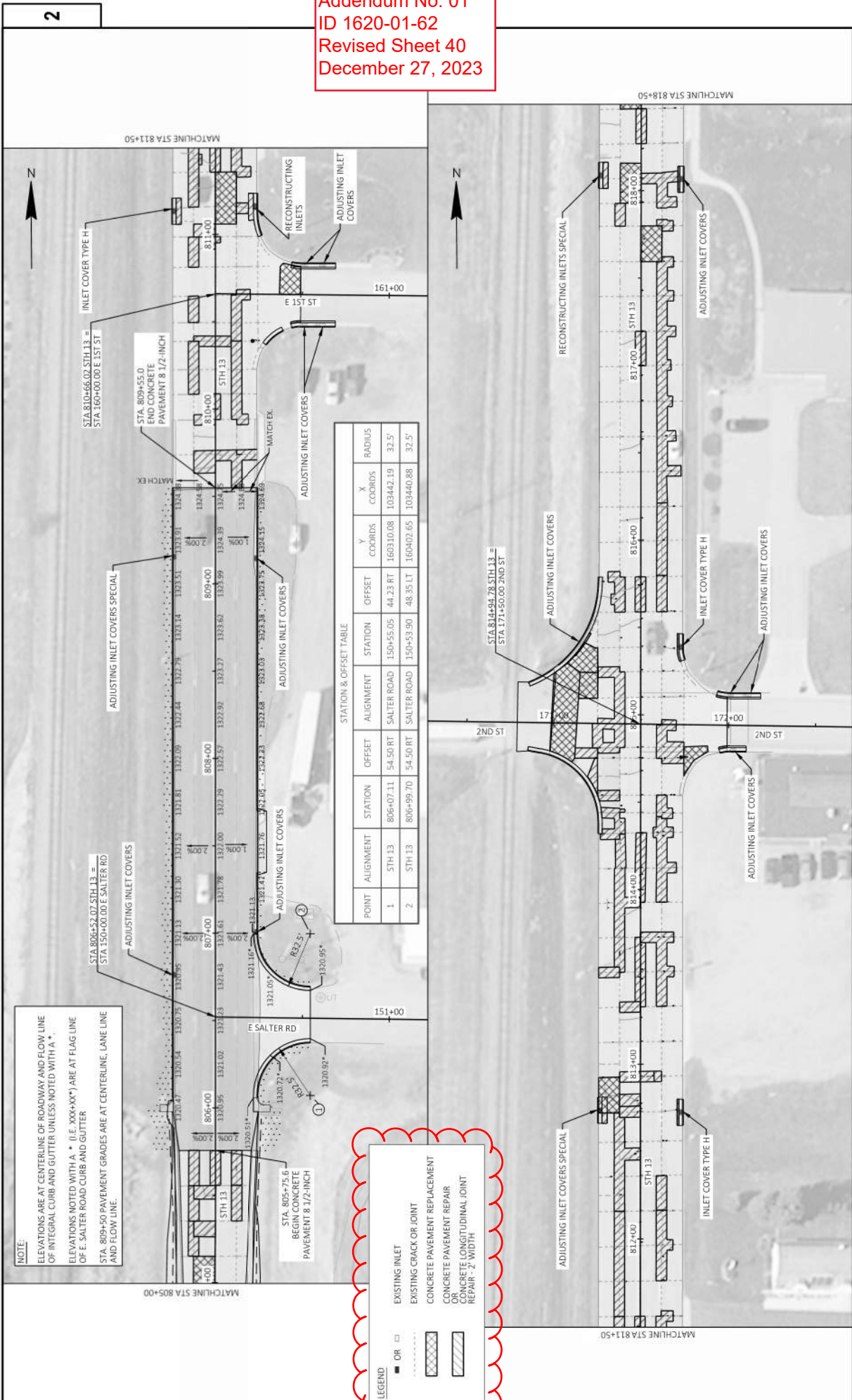

NOTE:
 ELEVATIONS ARE AT CENTERLINE OF ROADWAY AND FLOW LINE OF INTEGRAL CURB AND GUTTER UNLESS NOTED WITH A *.
 ELEVATIONS NOTED WITH A * (I.E. XXX+XX*) ARE AT FLAG LINE OF E. SALTER ROAD CURB AND GUTTER.
 STA. 809+50 PAVEMENT GRADES ARE AT CENTERLINE, LANE LINE AND FLOW LINE.

LEGEND

- OR □ EXISTING INLET
- ▨ EXISTING CRACK OR JOINT
- ▩ CONCRETE PAVEMENT REPLACEMENT
- ▧ CONCRETE PAVEMENT REPAIR
- ▦ OR ▤ ASPHALT CONCRETE LONGITUDINAL JOINT REPAIR - 2' WIDTH

PROJECT NO: 1620-01-62
 COUNTY: MARATHON
 HWY: STH 13
 PLAN DETAILS - PAVEMENT
 SHEET 40
 E

FILE NAME: X:\PROJECTS\MARATHON\1620-01-62_STH_13_STH_98 TO CTR\INSDGN\CD\SHEETPLAN\0202_PAVEMENT.DWG
 PLOT NAME: ANDY BLOCK
 PLOT DATE: 12/14/2023 11:22 AM
 PLOT SCALE: 1"=50.0 FT

Addendum No. 01
ID 1620-01-62
Revised Sheet 41
December 27, 2023

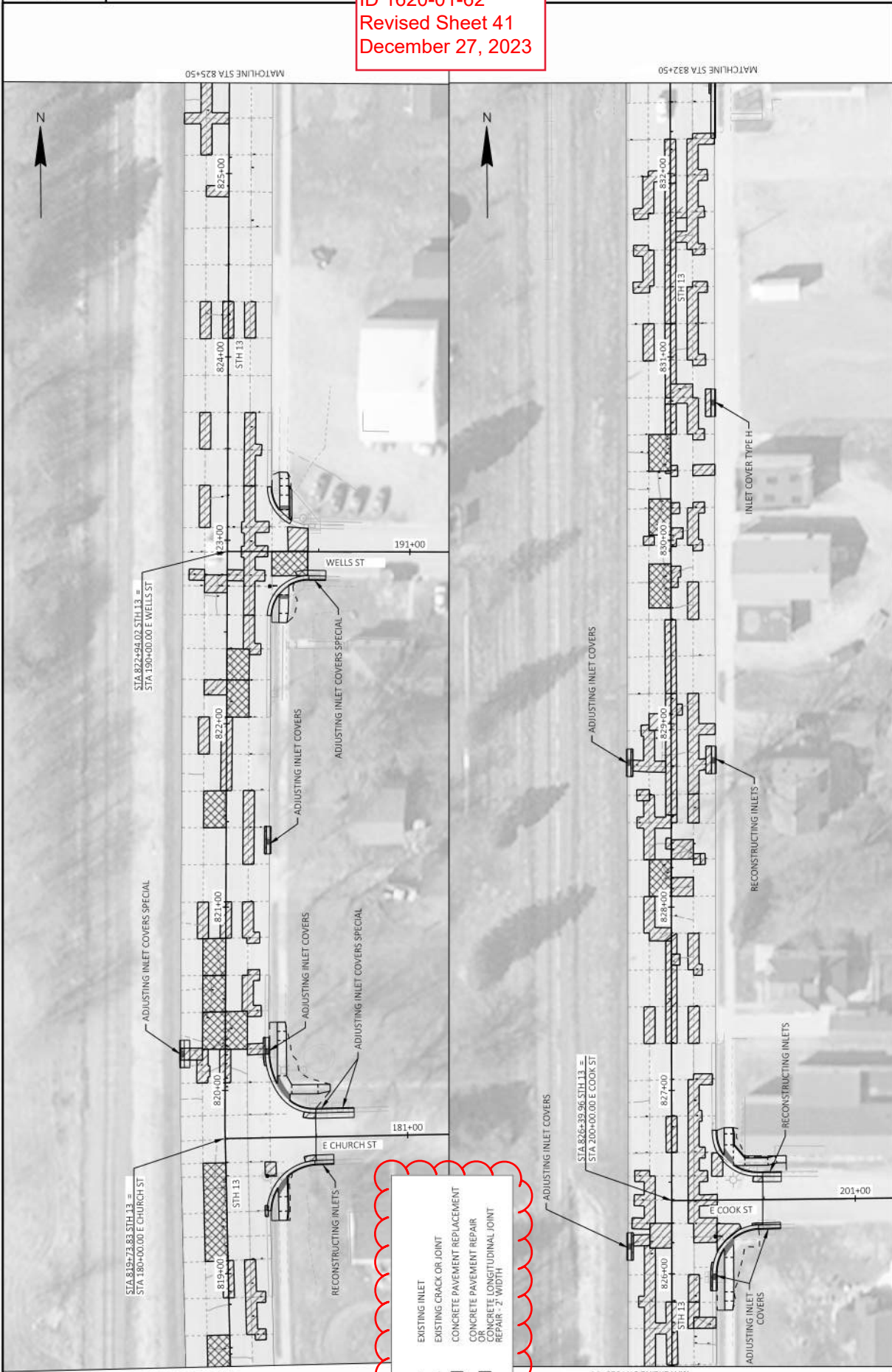

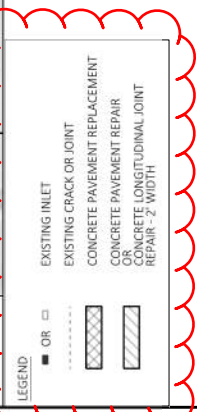
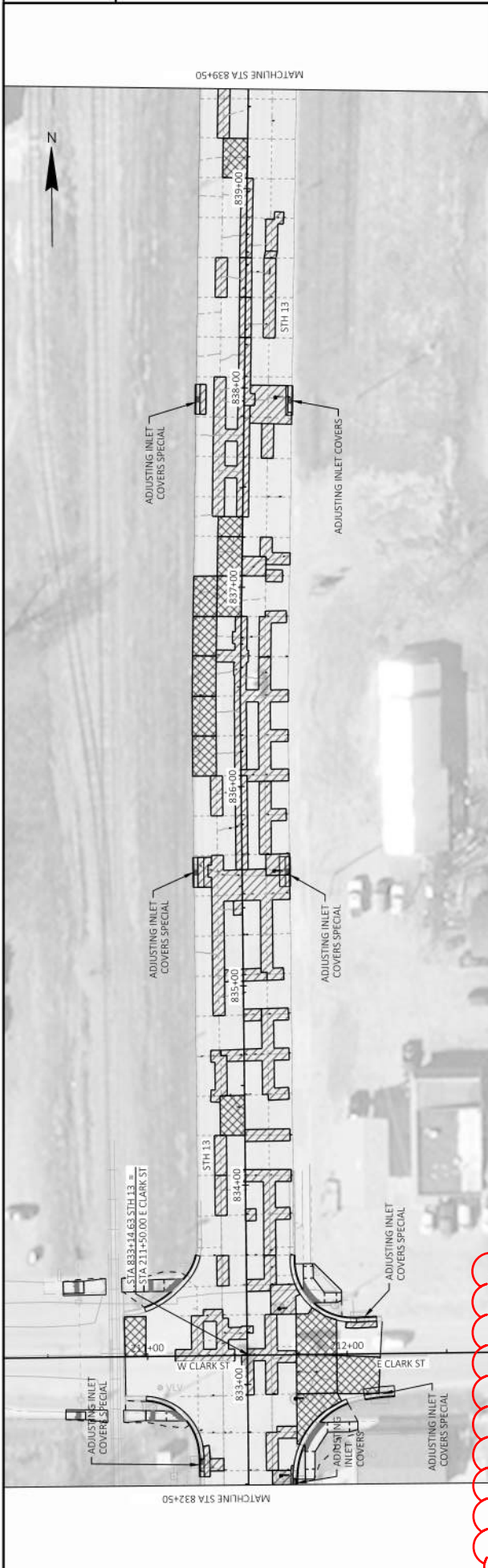

THIS FRAME INTENTIONALLY LEFT BLANK

Addendum No. 01
 ID 1620-01-62
 Revised Sheet 42
 December 27, 2023

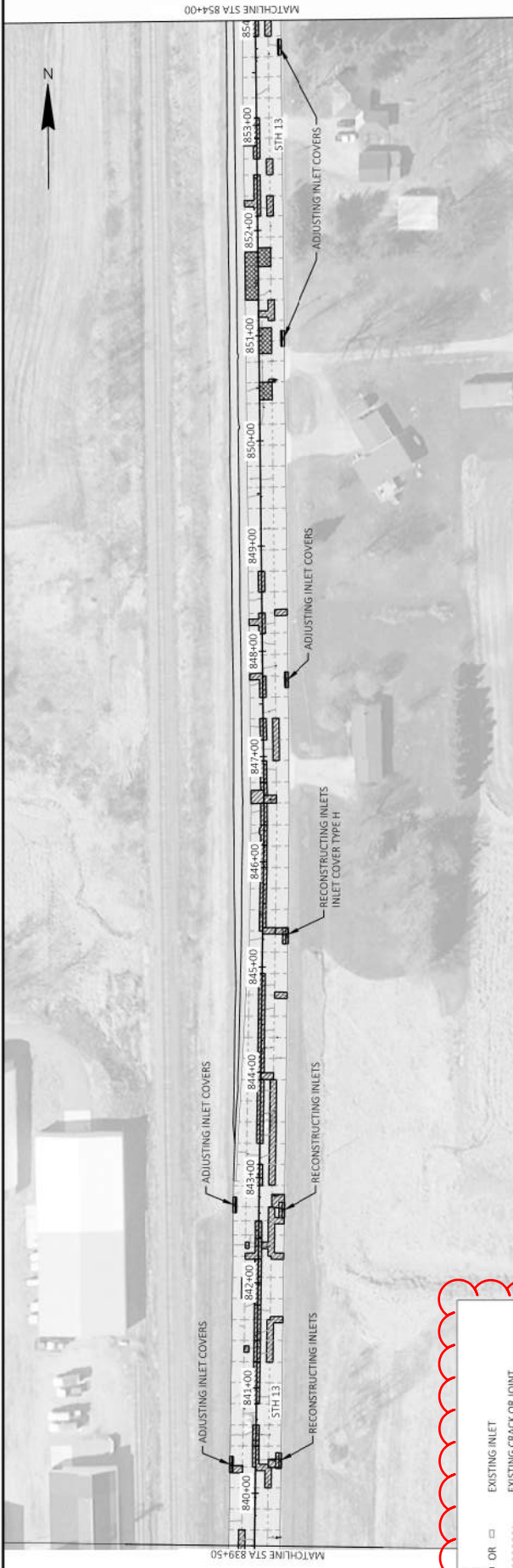

LEGEND

- OR □ EXISTING INLET
- ▨ EXISTING CRACK OR JOINT
- ▩ CONCRETE PAVEMENT REPLACEMENT
- ▧ CONCRETE PAVEMENT REPAIR
- ▦ OR ▤ ASPHALT CONCRETE (LONGITUDINAL JOINT REPAIR - 2' WIDTH)



Addendum No. 01
ID 1620-01-62
Revised Sheet 43
December 27, 2023





Addendum No. 01
 ID 1620-01-62
 Revised Sheet 45
 December 27, 2023



Addendum No. 01
 ID 1620-01-62
 Revised Sheet 46
 December 27, 2023

LEGEND

- OR □ EXISTING INLET
- EXISTING CRACK OR JOINT
- ▨ CONCRETE PAVEMENT REPLACEMENT
- ▧ CONCRETE PAVEMENT REPAIR OR CONCRETE LONGITUDINAL JOINT REPAIR - 2' WIDTH

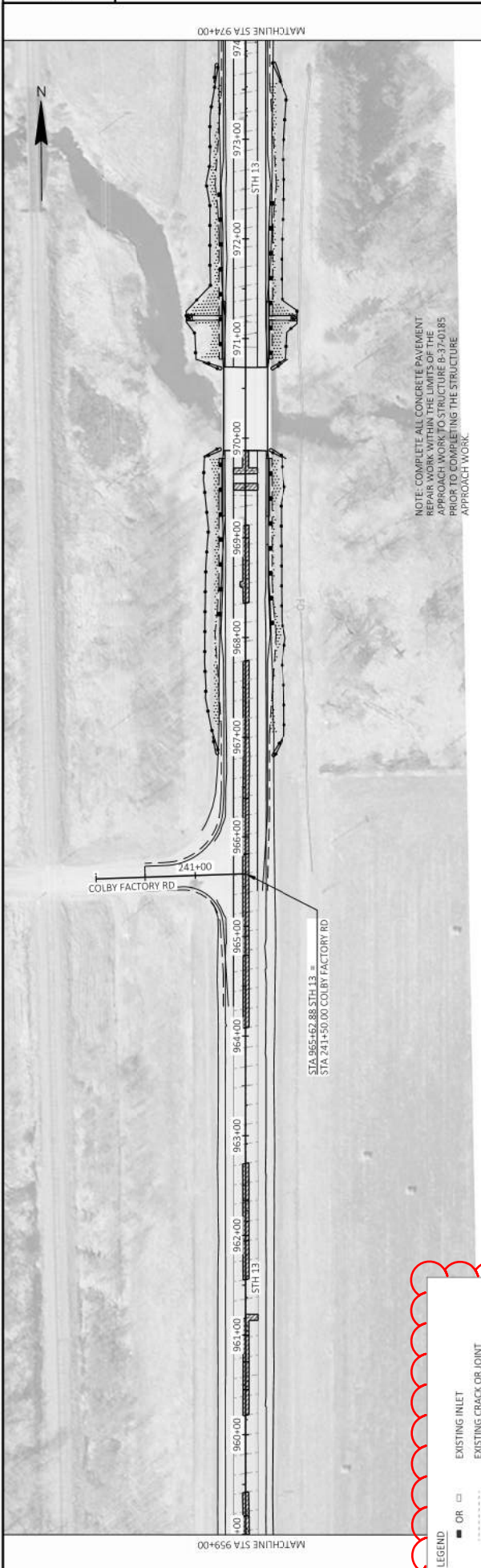

LEGEND

- OR □ EXISTING INLET
- EXISTING CRACK OR JOINT
- ▨ CONCRETE PAVEMENT REPLACEMENT
- ▩ CONCRETE PAVEMENT REPAIR OR CONCRETE LONGITUDINAL JOINT REPAIR - 2' WIDTH



Addendum No. 01
 ID 1620-01-62
 Revised Sheet 47
 December 27, 2023

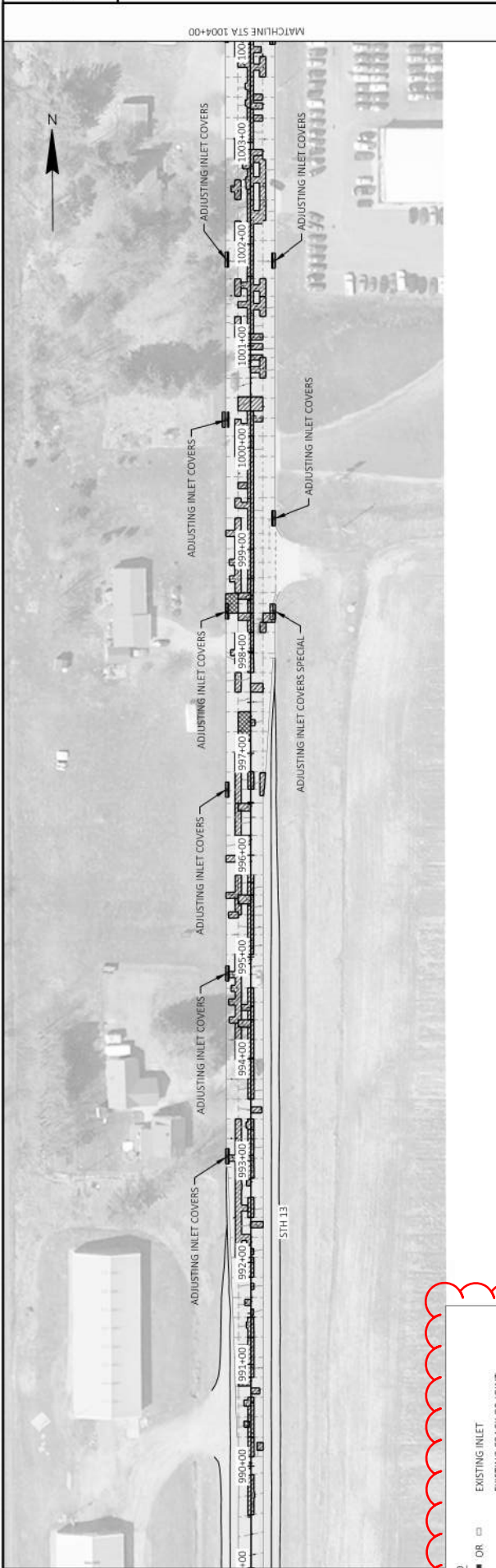

■	OR	□	EXISTING INLET
■	OR	□	EXISTING CRACK OR JOINT
▨	OR	▨	CONCRETE PAVEMENT REPLACEMENT
▨	OR	▨	CONCRETE PAVEMENT REPAIR
▨	OR	▨	CONCRETE LONGITUDINAL JOINT REPAIR - 2' WIDTH

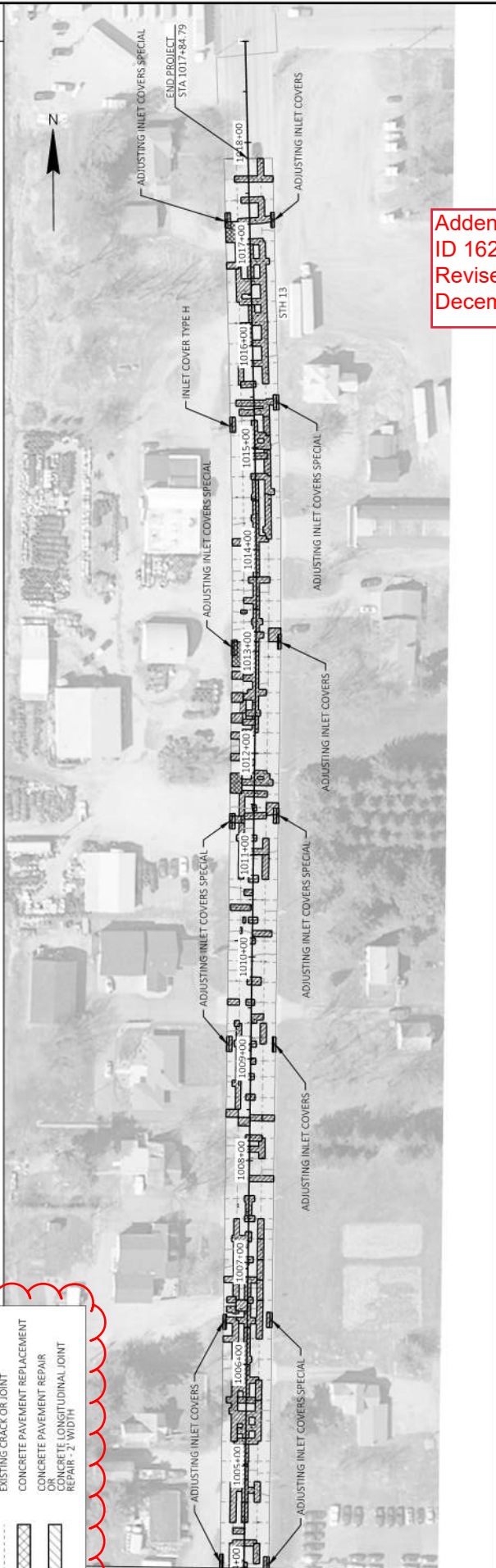

Addendum No. 01
 ID 1620-01-62
 Revised Sheet 48
 December 27, 2023

PROJECT NO: 1620-01-62	COUNTY: MARATHON	PLAN DETAILS - PAVEMENT	SHEET 48
FILE NAME: X:\PROJECTS\MARATHON\1620-01-62_S13_13_S13_98 TO CTR\DESIGN\CD\SHEETPLAN\01202_P0_PAVEMENT.DWG	HWY: STH 13	ANDY BLOK	WISDOT/CAD/05/SHEET 48
LAYOUT NAME: S13_13_121	12/14/2023 11:31 AM	PLOT NAME:	

Addendum No. 01
ID 1620-01-62
Revised Sheet 121
December 27, 2023

CONCRETE PAVEMENT REPAIR ITEMS (SHEET 1 OF 2)															CONCRETE PAVEMENT REPAIR ITEMS (SHEET 2 OF 2)														
STATION	TO	STATION	SY	6-1/2" PAVEMENT	8-1/2" PAVEMENT	CONCRETE DRIVEWAY	6-INCH CONCRETE DRIVEWAY	TIE	BARS EACH	DRILLED	416.0610	416.0610	416.0620	416.1710	416.1720	SPV.001.80.02	420.1000	CONCRETE CONTINUOUS	DIAMOND GRINDING	SAWING CONCRETE									
STAGE 1	STAGE 2	STAGE 3	SY	SY	SY	SY	SY	SY	SY	SY	SY	SY	SY	SY	SY	SY	SY	SY	SY	SY	SY	SY							
482+62	482+62	482+62	490	490	490	490	490	490	490	490	490	490	490	490	490	490	490	490	490	490	490	490							
480+00	480+00	480+00	490	490	490	490	490	490	490	490	490	490	490	490	490	490	490	490	490	490	490	490							
485+00	485+00	485+00	490	490	490	490	490	490	490	490	490	490	490	490	490	490	490	490	490	490	490	490							
809+55	809+55	809+55	490	490	490	490	490	490	490	490	490	490	490	490	490	490	490	490	490	490	490	490							
815+00	815+00	815+00	490	490	490	490	490	490	490	490	490	490	490	490	490	490	490	490	490	490	490	490							
820+00	820+00	820+00	490	490	490	490	490	490	490	490	490	490	490	490	490	490	490	490	490	490	490	490							
830+00	830+00	830+00	490	490	490	490	490	490	490	490	490	490	490	490	490	490	490	490	490	490	490	490							
835+00	835+00	835+00	490	490	490	490	490	490	490	490	490	490	490	490	490	490	490	490	490	490	490	490							
840+00	840+00	840+00	490	490	490	490	490	490	490	490	490	490	490	490	490	490	490	490	490	490	490	490							
997+96	997+96	997+96	490	490	490	490	490	490	490	490	490	490	490	490	490	490	490	490	490	490	490	490							
1000+00	1000+00	1000+00	490	490	490	490	490	490	490	490	490	490	490	490	490	490	490	490	490	490	490	490							
1005+00	1005+00	1005+00	490	490	490	490	490	490	490	490	490	490	490	490	490	490	490	490	490	490	490	490							
1010+00	1010+00	1010+00	490	490	490	490	490	490	490	490	490	490	490	490	490	490	490	490	490	490	490	490							
STAGE 1 TOTALS			490	0	7,340	6,930	3,490	2,911	1,781	41,755	36,500																		
STAGE 2																													
504+63	504+63	504+63	310	222	2,380	1,690	1,690	1,690	1,690	1,690	1,690	1,690	1,690	1,690	1,690	1,690	1,690	1,690	1,690	1,690	1,690	1,690							
510+00	510+00	510+00	100	56	2,380	1,690	1,690	1,690	1,690	1,690	1,690	1,690	1,690	1,690	1,690	1,690	1,690	1,690	1,690	1,690	1,690	1,690							
515+00	515+00	515+00	140	92	2,380	1,690	1,690	1,690	1,690	1,690	1,690	1,690	1,690	1,690	1,690	1,690	1,690	1,690	1,690	1,690	1,690	1,690							
520+00	520+00	520+00	100	112	1,559	745	745	745	745	745	745	745	745	745	745	745	745	745	745	745	745	745							
525+00	525+00	525+00	165	177	1,559	745	745	745	745	745	745	745	745	745	745	745	745	745	745	745	745	745							
530+00	530+00	530+00	85	75	1,559	745	745	745	745	745	745	745	745	745	745	745	745	745	745	745	745	745							
535+00	535+00	535+00	145	101	1,559	745	745	745	745	745	745	745	745	745	745	745	745	745	745	745	745	745							
540+00	540+00	540+00	110	72	1,559	745	745	745	745	745	745	745	745	745	745	745	745	745	745	745	745	745							
545+00	545+00	545+00	30	15	1,559	745	745	745	745	745	745	745	745	745	745	745	745	745	745	745	745	745							
550+00	550+00	550+00	85	22	1,559	745	745	745	745	745	745	745	745	745	745	745	745	745	745	745	745	745							
555+00	555+00	555+00	65	32	1,559	745	745	745	745	745	745	745	745	745	745	745	745	745	745	745	745	745							
560+00	560+00	560+00	85	27	1,559	745	745	745	745	745	745	745	745	745	745	745	745	745	745	745	745	745							
565+00	565+00	565+00	125	184	1,559	745	745	745	745	745	745	745	745	745	745	745	745	745	745	745	745	745							
570+00	570+00	570+00	70	22	1,559	745	745	745	745	745	745	745	745	745	745	745	745	745	745	745	745	745							
575+00	575+00	575+00	35	110	1,559	745	745	745	745	745	745	745	745	745	745	745	745	745	745	745	745	745							
580+00	580+00	580+00	15	9	1,559	745	745	745	745	745	745	745	745	745	745	745	745	745	745	745	745	745							
585+00	585+00	585+00	60	34	1,559	745	745	745	745	745	745	745	745	745	745	745	745	745	745	745	745	745							
589+00	589+00	589+00	90	80	1,559	745	745	745	745	745	745	745	745	745	745	745	745	745	745	745	745	745							
595+00	595+00	595+00	185	80	1,559	745	745	745	745	745	745	745	745	745	745	745	745	745	745	745	745	745							
600+00	600+00	600+00	125	90	1,559	745	745	745	745	745	745	745	745	745	745	745	745	745	745	745	745	745							
605+00	605+00	605+00	20	10	1,559	745	745	745	745	745	745	745	745	745	745	745	745	745	745	745	745	745							
610+00	610+00	610+00	65	105	1,559	745	745	745	745	745	745	745	745	745	745	745	745	745	745	745	745	745							
615+00	615+00	615+00	290	155	1,559	745	745	745	745	745	745	745	745	745	745	745	745	745	745	745	745	745							
620+00	620+00	620+00	75	70	1,559	745	745	745	745	745	745	745	745	745	745	745	745	745	745	745	745	745							
625+00	625+00	625+00	120	80	1,559	745	745	745	745	745	745	745	745	745	745	745	745	745	745	745	745	745							
630+00	630+00	630+00	65	95	1,559	745	745	745	745	745	745	745	745	745	745	745	745	745	745	745	745	745							
635+00	635+00	635+00	305	265	1,559	745	745	745	745	745	745	745	745	745	745	745	745	745	745	745	745	745							
842+95	842+95	842+95	61	167	1,559	745	745	745	745	745	745	745	745	745	745	745	745	745	745	745	745	745							
850+00	850+00	850+00	435	295	1,559	745	745	745	745	745	745	745	745	745	745	745	745	745	745	745	745	745							
992+96	992+96	992+96	380	271	1,559	745	745	745	745	745	745	745	745	745	745	745	745	745	745	745	745	745							
STAGE 2 TOTALS			0	0	4,675	3,640	2,054	1,015	1,261	48,800	20,227																		
ITEM SUBTOTALS			490	0	12,015	10,570	5,544	3,926	3,042	90,555	56,727																		
*ADDITIONAL QUANTITIES LISTED ELSEWHERE																													
UNDISTRIBUTED			0	0	2,825	2,020	1,851	586	725	11,998	6,275																		
ITEMS TOTALS			2,650	21	24,205	17,265	15,955	4,960	6,275	169,871	102,890																		
*ADDITIONAL QUANTITIES LISTED ELSEWHERE																													
MISCELLANEOUS QUANTITIES																													
COUNTY: MARATHON																													
HWY: STH 13																													
PROJECT NO: 1620-01-62																													
SHEET 121																													

SURFACE DRAIN ITEMS

STATION	TO	STATION	LOCATION	CONCRETE SURFACE DRAINS	ASPHALTIC FLUMES	CONCRETE CURB & GUTTER 4-INCH SLOPED 36-INCH TYPE TBT	601.0588	605.0200	645.0120
STATION	TO	STATION	LOCATION	CY	SY	LF	TYPE TBT	RIPRAP MEDIUM	GEOTEXTILE TYPE HR
800+50	-	801+19	LT	2	-	69		3	5
800+50	-	801+19	RI	3	-	69		3	5
801+86	-	802+55	LT	-	-	70		-	-
801+86	-	802+55	RT	-	-	70		-	-
805+94	-	806+05	LT	2	5	--		-	-
805+94	-	806+05	RT	2	5	--		-	-
969+22	-	969+87	LT	-	-	65		-	-
969+22	-	969+87	RT	-	-	65		-	-
970+71	-	971+37	LT	3	-	66		3	5
970+71	-	971+37	RT	3	-	66		3	5
ITEM TOTAL				15	10	540		12	20

GUARDRAIL ITEMS

STATION	TO	STATION	LOCATION	614.0010 BARRIERS SYSTEM GRADING SHAPING FINISHING EACH	614.2300 MGS GUARDRAIL 3 LF	614.2500 MGS THREE BEAM TRANSITION LF	614.2610 MGS GUARDRAIL TERMINAL LEAT EACH	EXCAVATION COMMON*	BORROW*	TOP SOIL*	EROSION MAT URBAN CLASSI TYPE B*	FERTILIZER TYPE B*	SEEDING MIXTURE NO. 20* LB	SEED WATER* MGAL
627+01.3	-	630+32.6	LT	1	225	--	2	1	44	144	144	0.1	3.9	3.3
626+16.4	-	629+47.6	RT	1	225	--	2	1	52	170	170	0.1	4.6	3.8
726+68.7	-	730+00.0	LT	1	225	--	2	1	43	169	169	0.1	4.6	3.8
726+03.9	-	729+35.1	RT	1	225	--	2	1	225	149	149	0.1	4.0	3.4
799+34.0	-	801+33.7	LT	1	88	39.4	1	5	54	146	146	0.1	4.0	3.4
801+94.5	-	803+74.5	LT	1	88	39.4	1	10	100	269	269	0.2	7.4	6.0
799+32.0	-	801+12.5	RT	1	88	39.4	1	7	74	201	201	0.1	5.4	4.4
801+92.1	-	803+72.0	RT	1	88	39.4	1	5	55	148	148	0.1	4.0	3.4
916+56.5	-	919+87.7	LT	1	225	--	2	5	23	237	237	0.2	6.4	5.3
916+22.5	-	919+53.7	RT	1	225	--	2	4	22	233	233	0.1	6.5	5.3
968+04.1	-	969+84.0	LT	1	88	39.4	1	1	67	117	117	0.1	3.1	2.7
970+74.9	-	972+55.0	LT	1	88	39.4	1	1	93	162	162	0.1	4.5	3.7
968+04.1	-	969+83.9	RT	1	88	39.4	1	1	58	101	101	0.1	2.7	2.3
970+75.1	-	972+55.1	RT	1	88	39.4	1	1	84	144	144	0.1	3.9	3.2
ITEM TOTAL				14	2,050	315.2	20	41	807	2390	2390	1.6	65.0	54.0

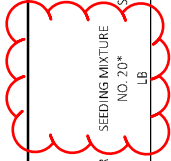

*QUANTITIES SHOWN ABOVE ARE FOR INFORMATION ONLY AND ARE INCIDENTAL TO ITEM 614.0010

Addendum No. 01
ID 1620-01-62
Revised Sheet 123
December 27, 2023

ALL ITEMS ARE CAT 0010
UNLESS NOTED OTHERWISE

PROJECT NO: 1620-01-62	COUNTY: MARATHON	MISCELLANEOUS QUANTITIES	SHEET 123	E
FILE NAME: X:\PROJECTS\MARATHON\1620-01-02_STH_13_STH_98 TO CTH INDEX\GCS\DRS\DRS\PLAN\030201-MQ.DWG	HWY: STH 13	FLY BY: ANY BLOCK	PLLOT SCALE: 1"=1'	WIS007CADD05 SHEET 42
LAYOUT NAME: 08	PLLOT DATE: 12/15/2023 11:37 AM	PLLOT NAME:		



Proposal Schedule of Items

Proposal ID: 20240109020 Project(s): 1620-01-62, 1620-01-63

Federal ID(s): WISC 2024125, WISC 2024126

SECTION: 0001 Contract Items

Alt Set ID: Alt Mbr ID:

Proposal Line Number	Item ID Description	Approximate Quantity and Units	Unit Price	Bid Amount
0056	325.0100 Pulverize and Relay	76,950.000 SY	_____.	_____.
0058	415.0085 Concrete Pavement 8 1/2-Inch	2,650.000 SY	_____.	_____.
0060	415.6000.S Rout and Seal	87,530.000 LF	_____.	_____.
0062	416.0610 Drilled Tie Bars	25,088.000 EACH	_____.	_____.
0064	416.0620 Drilled Dowel Bars	17,265.000 EACH	_____.	_____.
0066	416.1710 Concrete Pavement Repair	15,955.000 SY	_____.	_____.
0068	416.1720 Concrete Pavement Replacement	4,960.000 SY	_____.	_____.
0070	420.1000 Continuous Diamond Grinding Concrete Pavement	169,871.000 SY	_____.	_____.
0072	455.0605 Tack Coat	10.000 GAL	_____.	_____.
0074	460.2000 Incentive Density HMA Pavement	7,800.000 DOL	1.00000	7,800.00
0076	460.5224 HMA Pavement 4 LT 58-28 S	12,115.000 TON	_____.	_____.
0078	460.6225 HMA Pavement 5 MT 58-28 S	62.000 TON	_____.	_____.
0080	465.0105 Asphaltic Surface	37.000 TON	_____.	_____.
0082	465.0315 Asphaltic Flumes	10.000 SY	_____.	_____.
0084	465.0520 Asphaltic Rumble Strips, Shoulder	87,529.000 LF	_____.	_____.
0086	495.1000.S Cold Patch	20.000 TON	_____.	_____.



Proposal Schedule of Items

Proposal ID: 20240109020 Project(s): 1620-01-62, 1620-01-63

Federal ID(s): WISC 2024125, WISC 2024126

SECTION: 0001 Contract Items

Alt Set ID: Alt Mbr ID:

Proposal Line Number	Item ID Description	Approximate Quantity and Units	Unit Price	Bid Amount
0302	ASP.1T0G On-the-Job Training Graduate at \$5.00/HR	2,880.000 HRS	5.00000	14,400.00
0304	SPV.0030 Special 01. Fertilizer for Lawn Type Turf	3.000 CWT	_____.	_____.
0306	SPV.0060 Special 01. Reconstructing Inlets Special	6.000 EACH	_____.	_____.
0308	SPV.0060 Special 02. Adjusting Inlets Special	21.000 EACH	_____.	_____.
0310	SPV.0060 Special 03. Reconstructing Sanitary Sewer Manholes	4.000 EACH	_____.	_____.
0312	SPV.0060 Special 04. Research and Locate Existing Land Parcel Monuments	34.000 EACH	_____.	_____.
0314	SPV.0060 Special 05. Verify and Replace Existing Land Parcel Monuments	34.000 EACH	_____.	_____.
0316	SPV.0060 Special 06. Temporary Vehicle Detection B-37-184	1.000 EACH	_____.	_____.
0318	SPV.0060 Special 07. Temporary Vehicle Detection B-37-185	1.000 EACH	_____.	_____.
0320	SPV.0180 Special 01. Preparing Topsoil for Lawn Type Turf	1,280.000 SY	_____.	_____.
0322	SPV.0180 Special 02. Concrete Longitudinal Joint Repair	6,275.000 SY	_____.	_____.
Section: 0001			Total:	_____.
			Total Bid:	_____.